



# METRO Gold Line BRT Update Committee of the Whole

October 17, 2018

- Gold Line Overview
- Project Development Update

# Gold Line BRT Overview

- Serving the East Metro:
  - 2 counties, 5 municipalities
  - 301,000 jobs (2040)
  - 522,000 people (2040)
- 8,000 Est. Daily Riders (2040)
- \$420M Est. Capital Cost

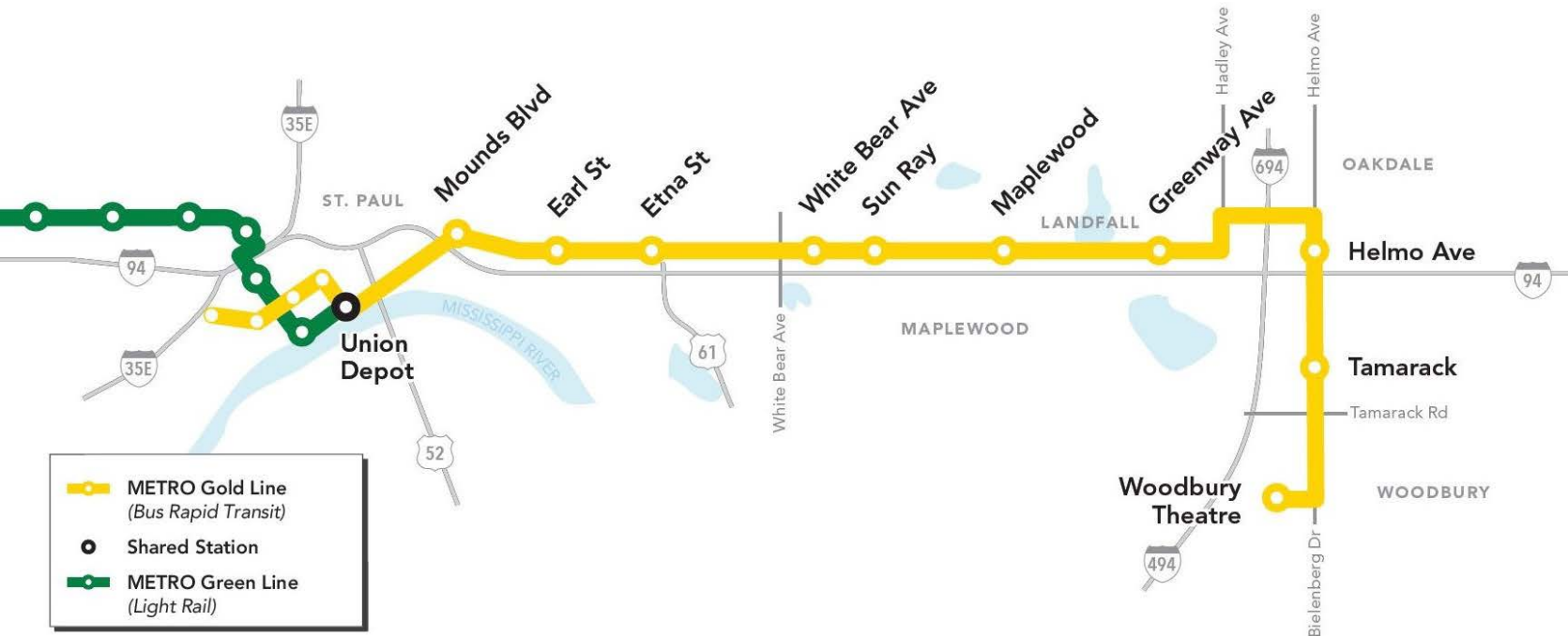

## Mixed Traffic

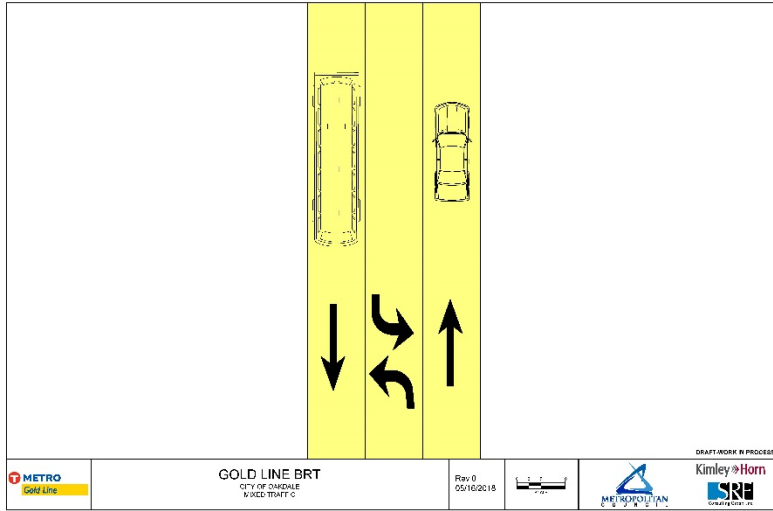

## Curbside Running

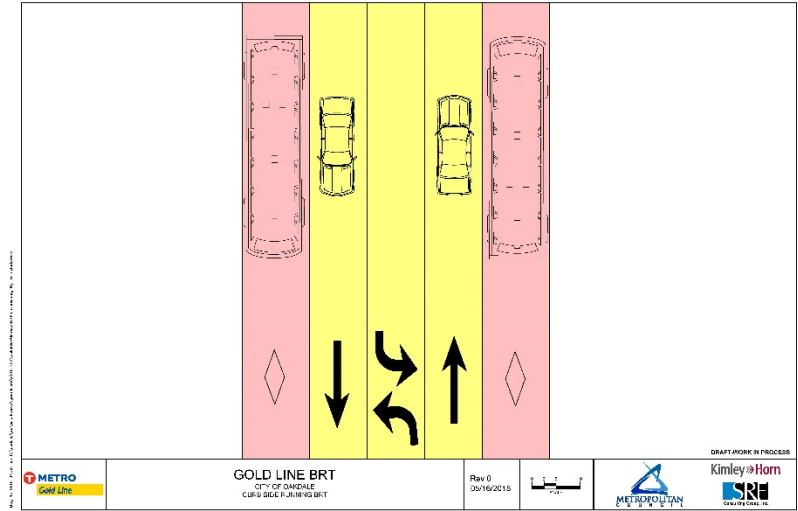

## Side Running

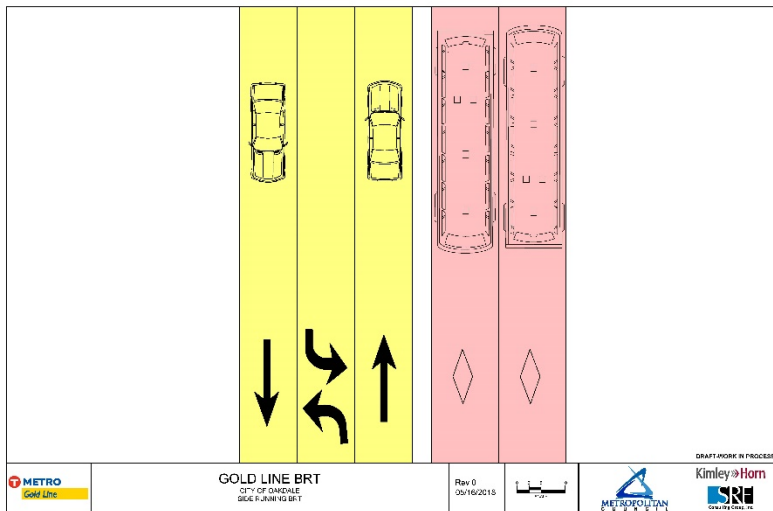

## Center Running

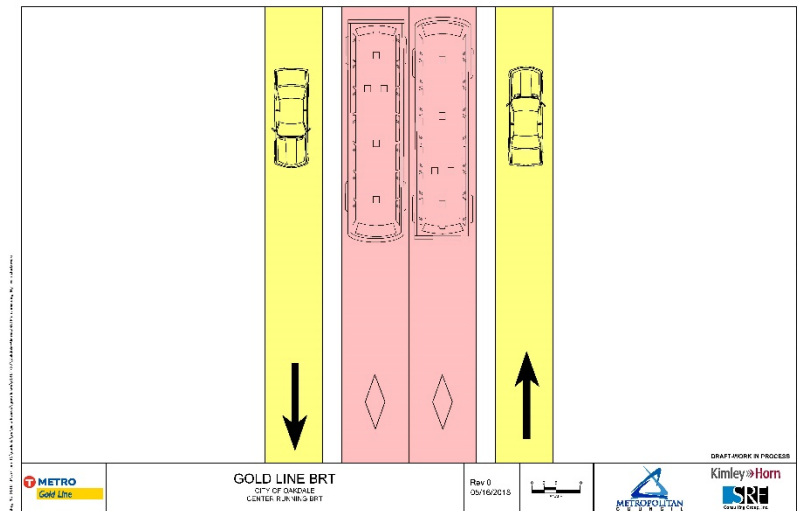

# Gold Line Bus Rapid Transit Project Timeline

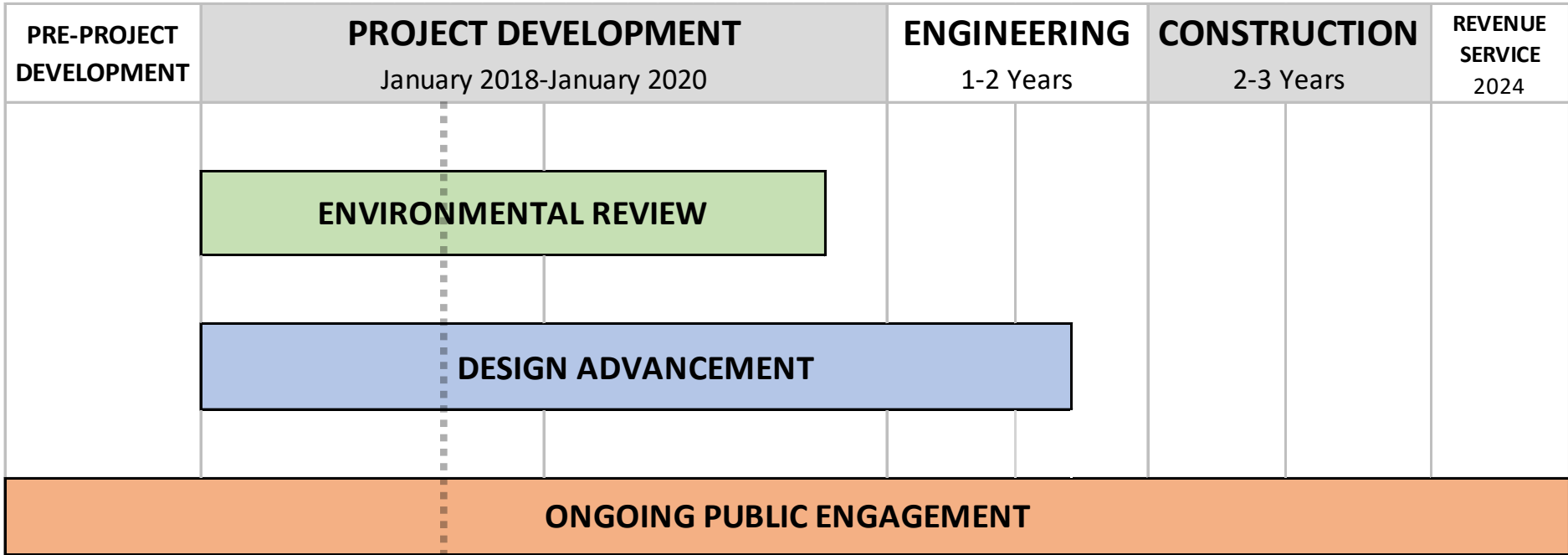

WE ARE  
HERE



### PD Funding (\$25M approved, authorized)

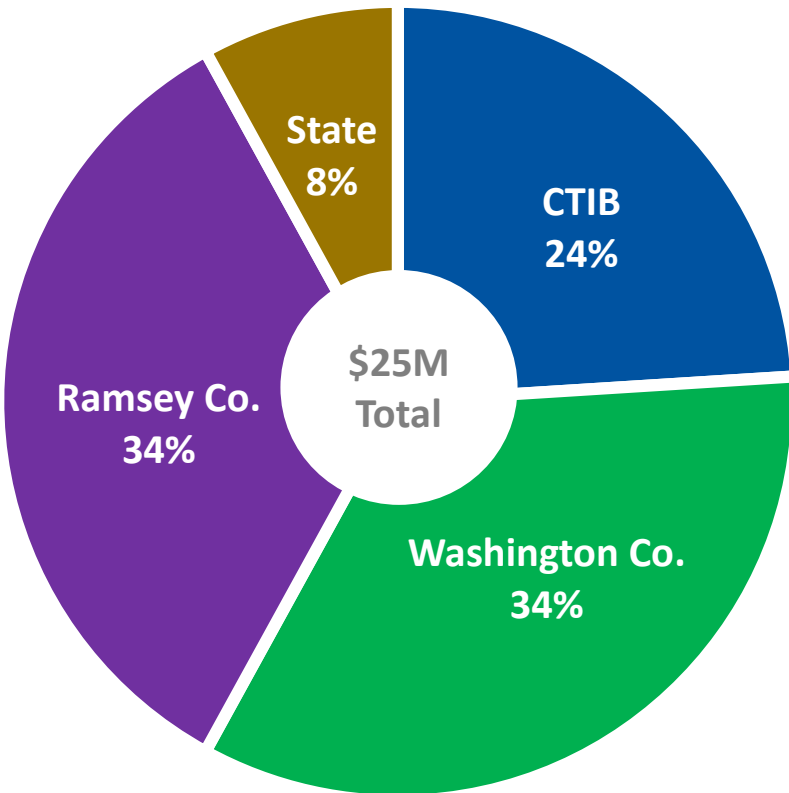

### Overall Funding (\$420M anticipated, YOY)

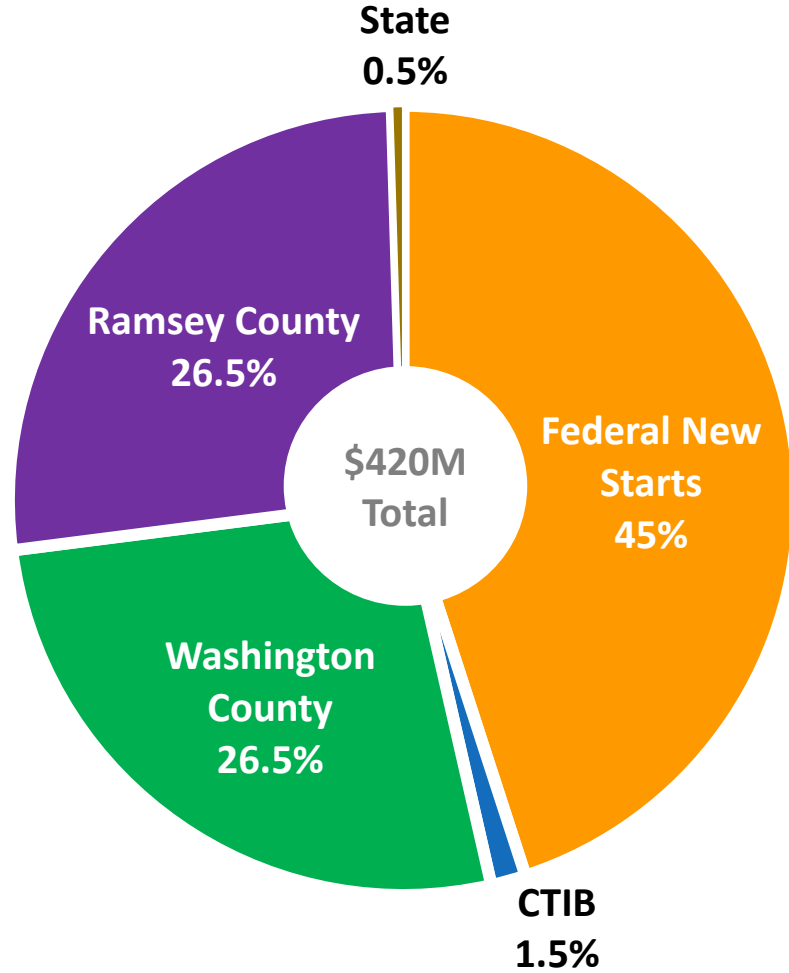

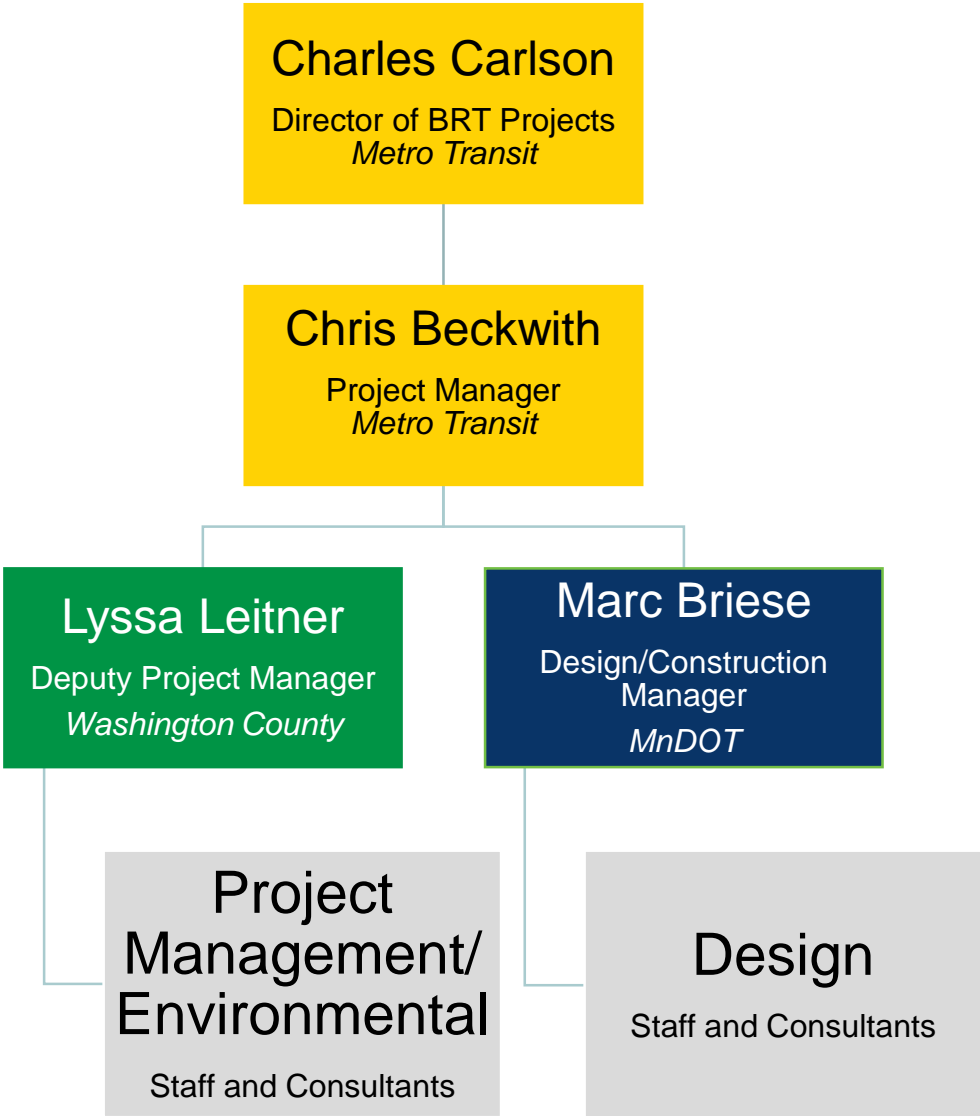

# Gold Line Committee Structure



*Follows LRT project precedents and Transitway Guidelines*

Issue Resolution Teams (IRTs)

Technical Advisory Committee (TAC)

Community and Business Advisory Committee (CBAC)

Corridor Management Committee (CMC)

Counties

Metropolitan Council







# Project Development Update

# Issue Resolution Teams



**Legend**

- Optional Station Location
- METRO Gold Line Stations
- METRO Gold Line
- Technical Issues
- Segments
- City Boundaries
- Counties

**Segments**

- SP Saint Paul
- M Maplewood
- L Landfall
- O Oakdale
- W Woodbury

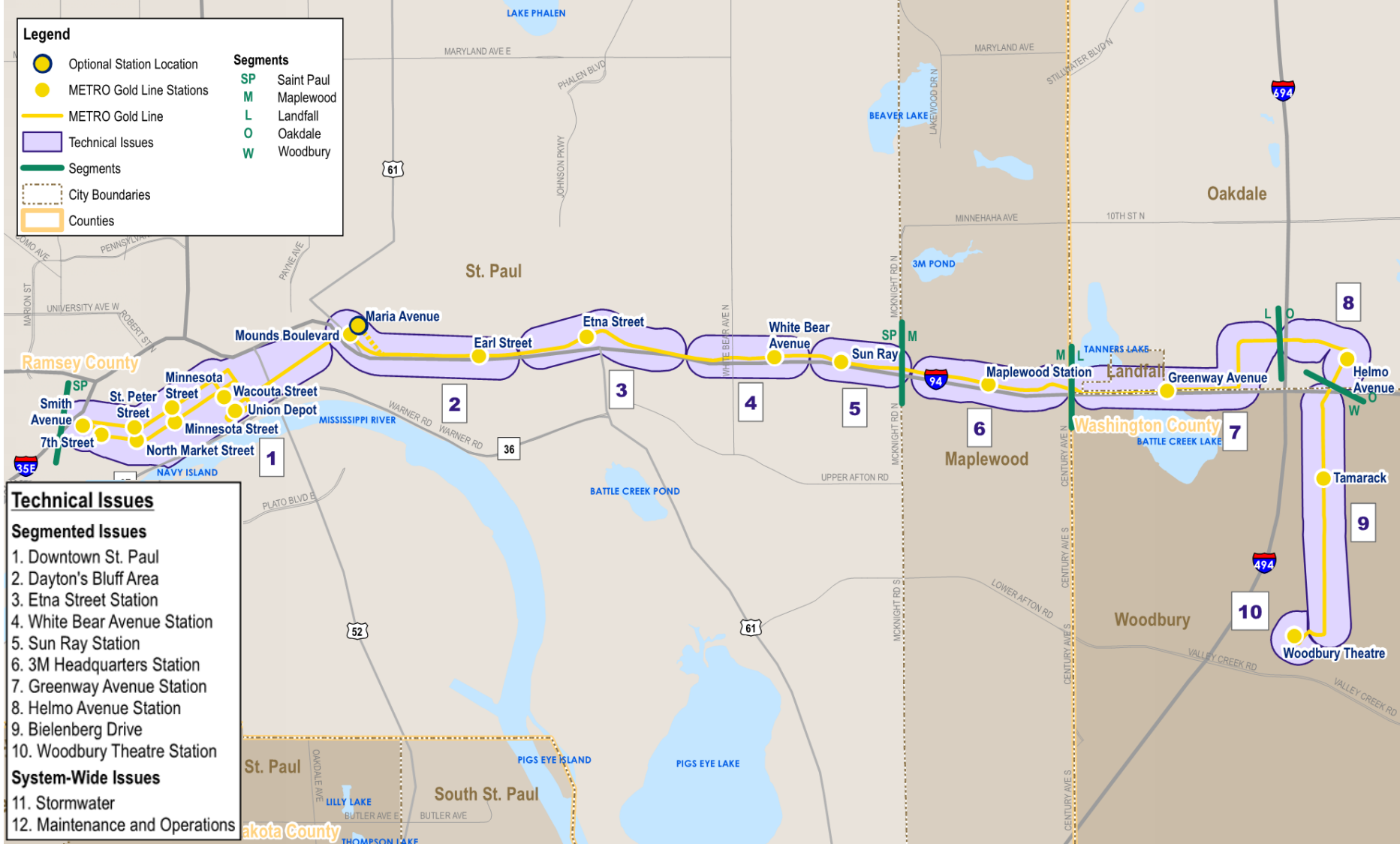

- Technical Issues**
- Segmented Issues**
1. Downtown St. Paul
  2. Dayton's Bluff Area
  3. Etna Street Station
  4. White Bear Avenue Station
  5. Sun Ray Station
  6. 3M Headquarters Station
  7. Greenway Avenue Station
  8. Helmo Avenue Station
  9. Bielenberg Drive
  10. Woodbury Theatre Station
- System-Wide Issues**
11. Stormwater
  12. Maintenance and Operations



*Issue Resolution Teams started meeting in March 2018*



- Open Houses
  - Corridor-wide events to review design updates and options



July 17 and 18 Open Houses

- Neighborhood Meetings
  - Specific locations where input was needed on design options



*July 31 Neighborhood Meeting*



# Summery Stakeholder Engagement



- Door Knocking
- One-on-One Meetings
- Community Events



July 31 East Metro Garage Open House

## Flyer Translation into Hmong Language



### ZEJ ZOG KEV SAB LAJ: Txog Chav Tos Nce Tsheb ntawm Mounds Boulevard los yog Maria Avenue

Xav tau koj li tswv yim. METRO Gold Line Bus Rapid Transit (BRT) thov los soj ntsuam ob qhov chaw xaiv lost sim chav tos nce tsheb rau ntawm txoj kev Mounds Boulevard thiab Maria Avenue. Koj puas xav kom lub chav to nce tsheb ntawm Mounds Boulevard ze rau txoj kev 3rd Street los yog Maria Avenue ze rau txoj kev Conway Street?

Koj li tswv yim yuav pab peb los txiav txim rau cov kev tseem ceeb no.

#### Mus koom zej zog kev sab laj:

- Pab tawm tswv yim txog qhov chaw tsim kho chav nce tsheb rau Gold Line BRT thiab cov kev ntawm Mounds Boulevard thiab Maria Avenue
- Kom paub txog txoj kev txhim kho no, ua tau mus li cas lawm, thiab cov kauj ruam tom ntej
- Tham nrog cov neeg ua hauj lwm thiab nug lawm
- Kom puaq saib yuav taug qab txog txoj kev txhim kho no tau li cas

#### ▼ Txoj kev Thov Txhim Kho Gold Line



**Hnub Tuesday, July 31  
5:00-7:00 p.m.**

Eastside Enterprise Center  
804 Margaret Street, Saint Paul  
Cov tsheb npav no tuaj txog 61, 74

Tsis tau npaj yuav nthuav dab tsi lawm  
raws sij hawm. Cov neeg yuaj koom  
thaum twg los tau.

**Yog tuaj tsis tau los yog xav  
tawm tswv yim ua ntej rooj  
sab laj?**

Mus luj hauv computer ntawm:  
[surveymonkey.com/fr/GoldLine4](http://surveymonkey.com/fr/GoldLine4)

Txoj kev METRO Gold Line yuav npaj txhim kho cuaj-mile Bus Rapid Transit (BRT) txov kev no yuav mus txog Saint Paul, Maplewood, Landfall, Oakdale thiab Woodbury generally along Interstate 94. Txoj kev Gold Line yuav yog Minnesota thawj txoj kev BRT uas siv feem ntau yog nrog txoj kev uas cov tsheb npav siv.

#### UA KOM PAUB TXOG

**Cuv npe kom xa email tuaj qhia:**  
[www.metrotransit.org/gold-line](http://www.metrotransit.org/gold-line)

**Xa Email tuaj rau peb ntawm:**  
[goldline@metrotransit.org](mailto:goldline@metrotransit.org)

**Hu xov tooj tuaj rau peb ntawm:**  
651-602-1955

**Saib peb ntawm:**  
@GoldLineBRT

**f** @MetroTransitMN

Upon request, the Gold Line project will provide reasonable accommodations for interpreters and persons with disabilities at community meetings. Submit requests seven business days prior to the meeting date. Liz Jones: 651-602-1977 • [elizabeth.jones@metrotransit.org](mailto:elizabeth.jones@metrotransit.org)

A petición, el Gold Line project proporcionará acomodaciones razonables para intérpretes y personas con discapacidades en las reuniones de la comunidad. Las solicitudes deben presentarse siete días hábiles antes de la fecha de la reunión. Liz Jones: 651-602-1977 • [elizabeth.jones@metrotransit.org](mailto:elizabeth.jones@metrotransit.org)

Haddi la codsawd, Gold Line project waka zy idiin heli karaan turjubaano iyo adeeg gaar ah loo fidiyo dadka naafada ah ee ka qeyb galaya shirkada dadweynaha. Codsigaada waa in la soo gudbiyaa todoba cisho ka hor oo ah maalmaha shaqada adinka oo codsigaana ku soo diraya Liz Jones: 651-602-1977 • [elizabeth.jones@metrotransit.org](mailto:elizabeth.jones@metrotransit.org)

Yog xav tau, Gold Line project mam li pab kom tsim nyog txog kev pab tshais lus los pab rau cov neeg xiam oob khab thuum tuaj koom rooj sab laj. Thov tuaj ua ntej li nxa hnub ua ntej hnub teem tuaj sab laj. Liz Jones: 651-602-1977 • [elizabeth.jones@metrotransit.org](mailto:elizabeth.jones@metrotransit.org)

ດ້ວຍການສະເໜີ, Gold Line project ຈະໃຫ້ການສະໜອງບໍລິການທີ່ເໝາະສົມ ແກ້ໄຂສຳລັບຕົວເມັດທີ່ມີຄວາມສາມາດຈຳກັດ ໃນການເຂົ້າຮ່ວມພິທີປະຕິບັດການທີ່ກ່ຽວຂ້ອງກັບການສ້າງສາລິເນີນການຂົນສົ່ງສູນກາງ. ຈົ່ງສະເໜີການສະໜອງເຫຼົ່ານີ້ເມື່ອກ່ອນສາມມື້ກ່ອນວັນປະຕິບັດການທີ່ກ່ຽວຂ້ອງ. Liz Jones: 651-602-1977 • [elizabeth.jones@metrotransit.org](mailto:elizabeth.jones@metrotransit.org)

- Summer public outreach helped inform technical recommendations
- The Corridor Management Committee (CMC) in September confirmed the scope to be studied in the Environmental Assessment
- The CMC also requested additional technical information on two downtown routing alternatives

# Review of Downtown Alternatives: DT Routing



## ALTERNATIVE: ROUTE THROUGH DOWNTOWN

The METRO Gold Line BRT will begin (eastbound) or end (westbound) at Smith Avenue Transit Center, providing a one-seat ride through downtown that will also have a stop in front of Union Depot on Wacouta and Sibley streets. Between the stops at Union Depot and Smith Avenue Transit Center, the Gold Line will route down 5th Street or 6th Street.

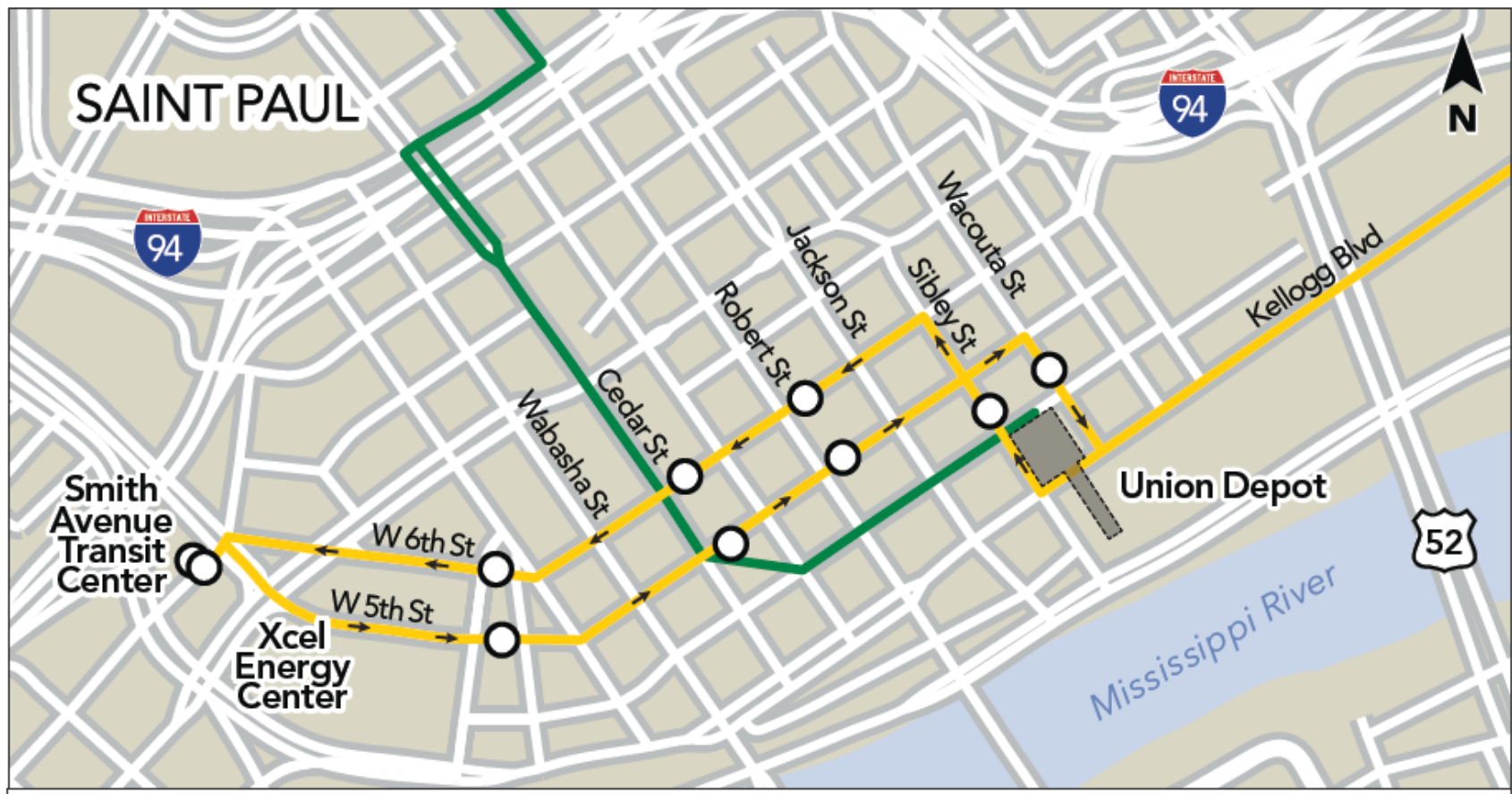

- Alternative Route
- Potential BRT Station Location
- METRO Green Line



Downtown Zone	Ridership Distribution
Union Depot Station (Front)/Lowertown	40%
Central Downtown	30%
Rice Park/Xcel Energy Center Area	30%



## ALTERNATIVE: BEGIN/END AT UNION DEPOT

The METRO Gold Line BRT will begin (eastbound) or end (westbound) on the bus deck at the Union Depot, a multimodal transportation hub that provides transfer connections to the METRO Green Line and local bus service throughout downtown Saint Paul, as well as Amtrak, Jefferson Lines, Greyhound and Megabus services. Union Depot is also the planned terminus for additional future transitways.

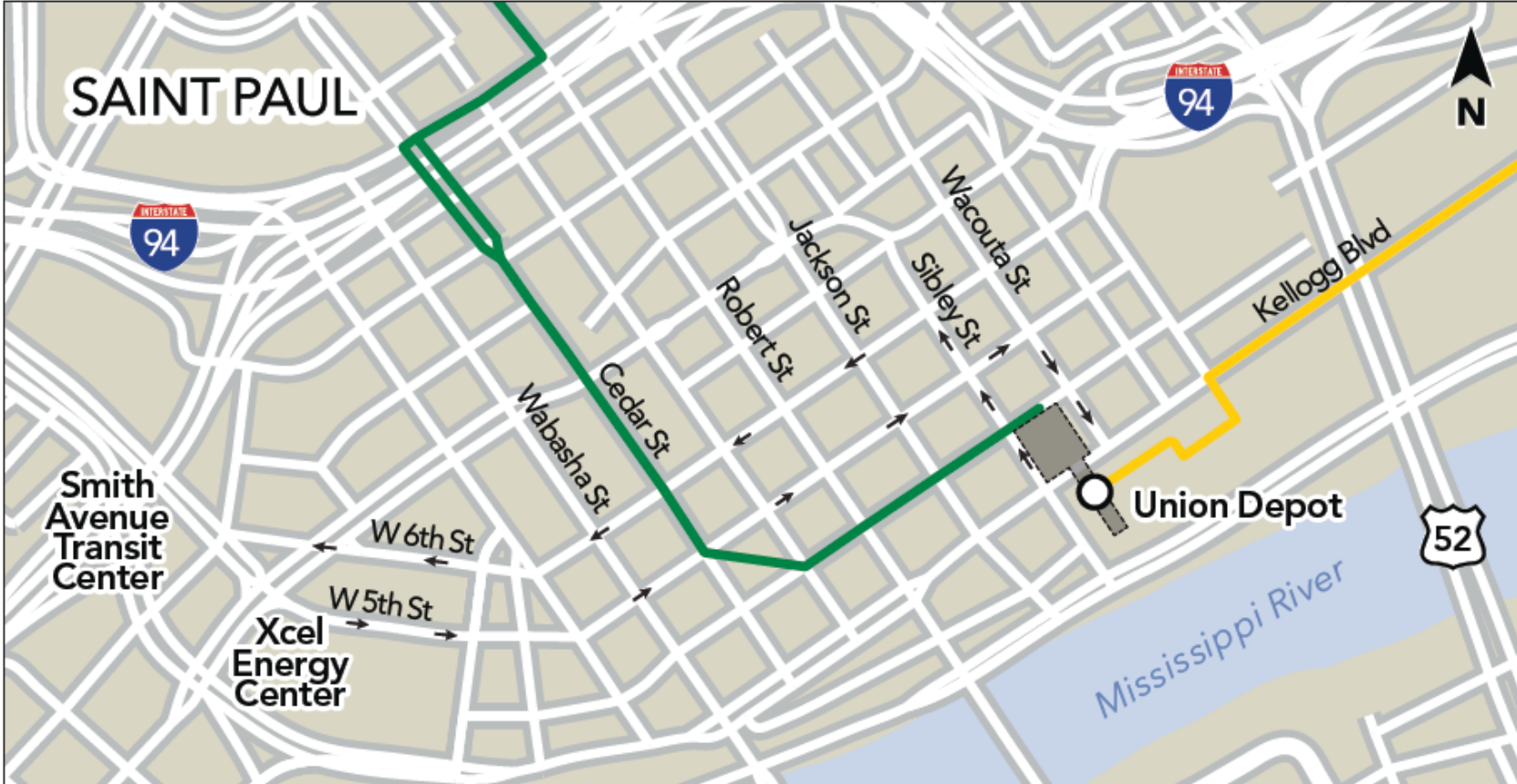

- Alternative Route
- Potential BRT Station Location
- METRO Green Line



Location	Routes*	Weekday Transit <u>Vehicle</u> Trips
Union Depot Bus Deck	3, 16, 21, 54, 94, 262, 417, 480, 484, 489	470 Trips
Green Line- Union Depot Station	Green Line LRT	230 Trips
Kellogg/Broadway	63, 70, 294, 350, 351, 353, 361, 364	209 Trips
<b>Total</b>	<b>19 Transit Routes</b>	<b>909 Total Trips</b>
Gold Line Proposed	Union Depot Station	~160 Trips

*\*Does not include Amtrak, Intercity Bus, and Private service connections*

# Transit Service to Union Depot

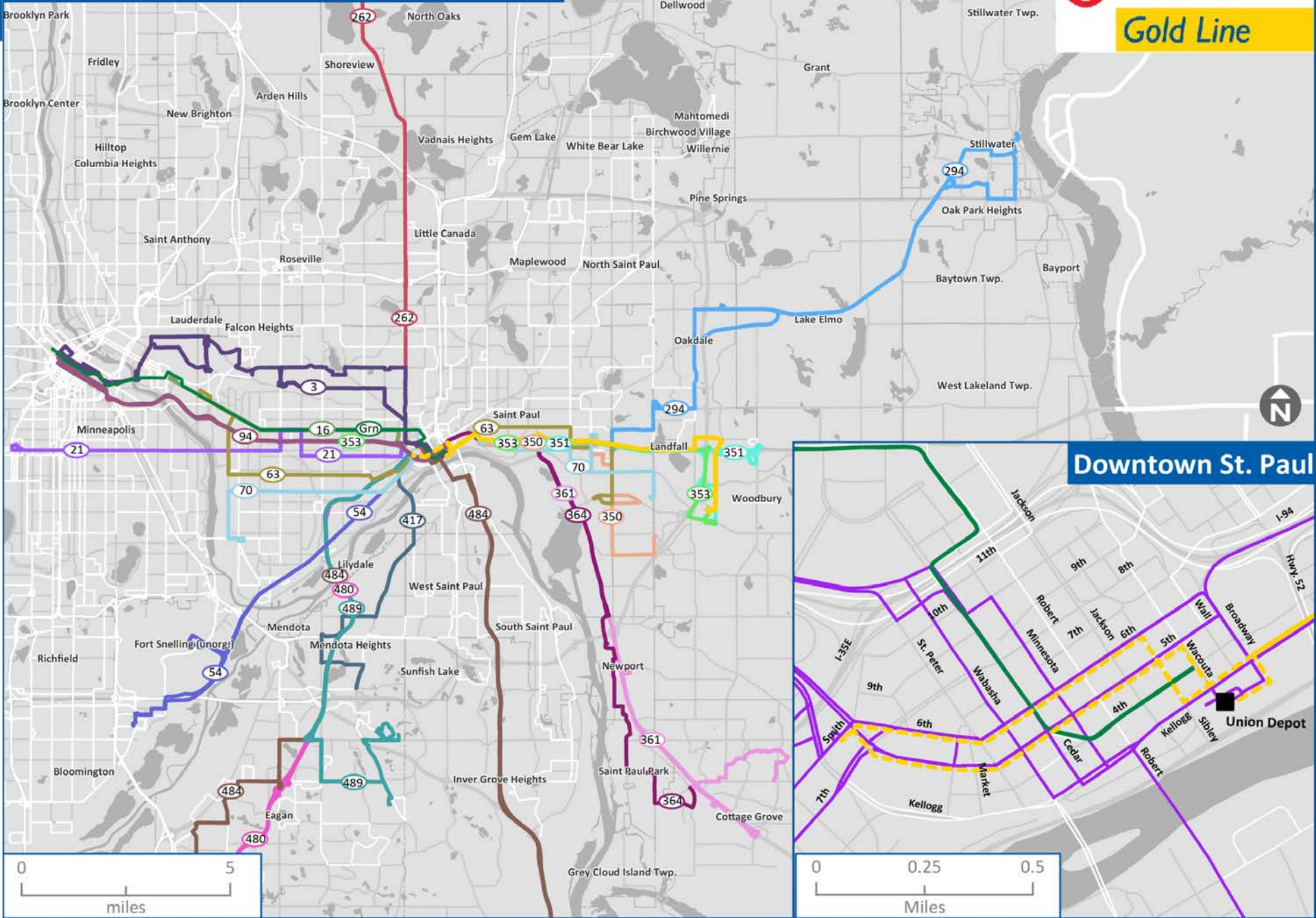

# Downtown Alternatives Summary Data



Alternative	Ridership Difference	Capital Cost Difference	Annual O&M Net Cost Difference	FTA Rating	Public Input Preference
Downtown Routing to Smith Ave	+ 950 daily riders	+ \$5.8M* from baseline	+ \$70K**	Medium-High	~ 80%****
Union Depot Bus Deck Terminus		- \$7.6M* from baseline		Medium-Low***	~ 20%****

\* Includes Upgraded Stations (like A Line)

\*\*\$450K in additional operating costs less \$380K in increased fare collection

\*\*\*5% more riders could move rating up to Medium-High

\*\*\*\*Public outreach input collected through 10/5



## Origin of 950 Lost Rides\* without Gold Line Downtown Routing

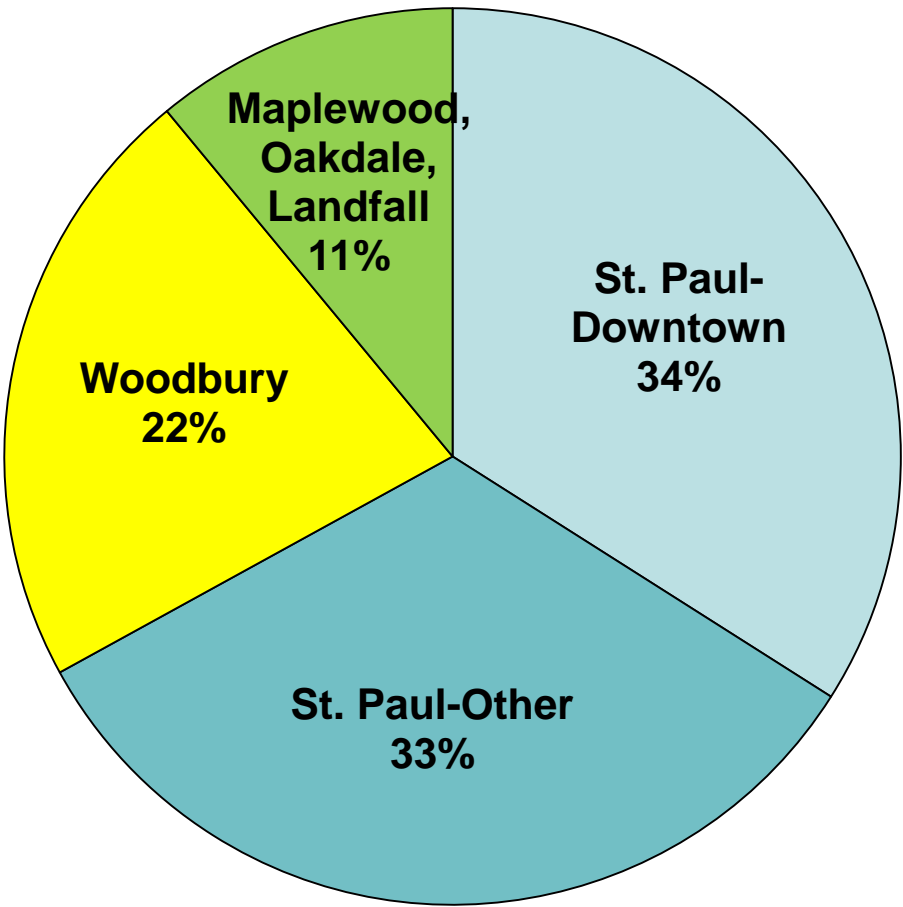

\*50% of the lost rides would chose to drive instead

- Gold Line Team continuing evaluation
  - Opportunities to maximize ridership
  - Opportunities to decrease travel time
  - Evaluate park and ride capacity and opportunities
  - Assess traffic congestion downtown
  - Evaluate competitiveness of alternatives
  - Re-assess risks
- Next CMC meeting is November 1
  - Confirmation of preferred alternative required in November to maintain schedule



For more information:

[www.metrotransit.org/gold-line-project](http://www.metrotransit.org/gold-line-project)

**Metro Transit**

Charles Carlson, Director BRT Projects

(612) 349-7639

[charles.carlson@metrotransit.org](mailto:charles.carlson@metrotransit.org)

**METRO Gold Line BRT Project Office**

Chris Beckwith, Project Manager

[christine.beckwith@metrotransit.org](mailto:christine.beckwith@metrotransit.org)

Hally Turner (for Lyssa Leitner)

Deputy Project Manager

[hally.turner@metrotransit.org](mailto:hally.turner@metrotransit.org)

Marc Brieese

Manager of Design & Construction

[marc.brieese@metrotransit.org](mailto:marc.brieese@metrotransit.org)