



## 2025 BRT Openings & Readiness Updates

Committee of the Whole  
February 19, 2025



1



## Introduction

2

2

## 2025: A historic year for bus rapid transit



3



3

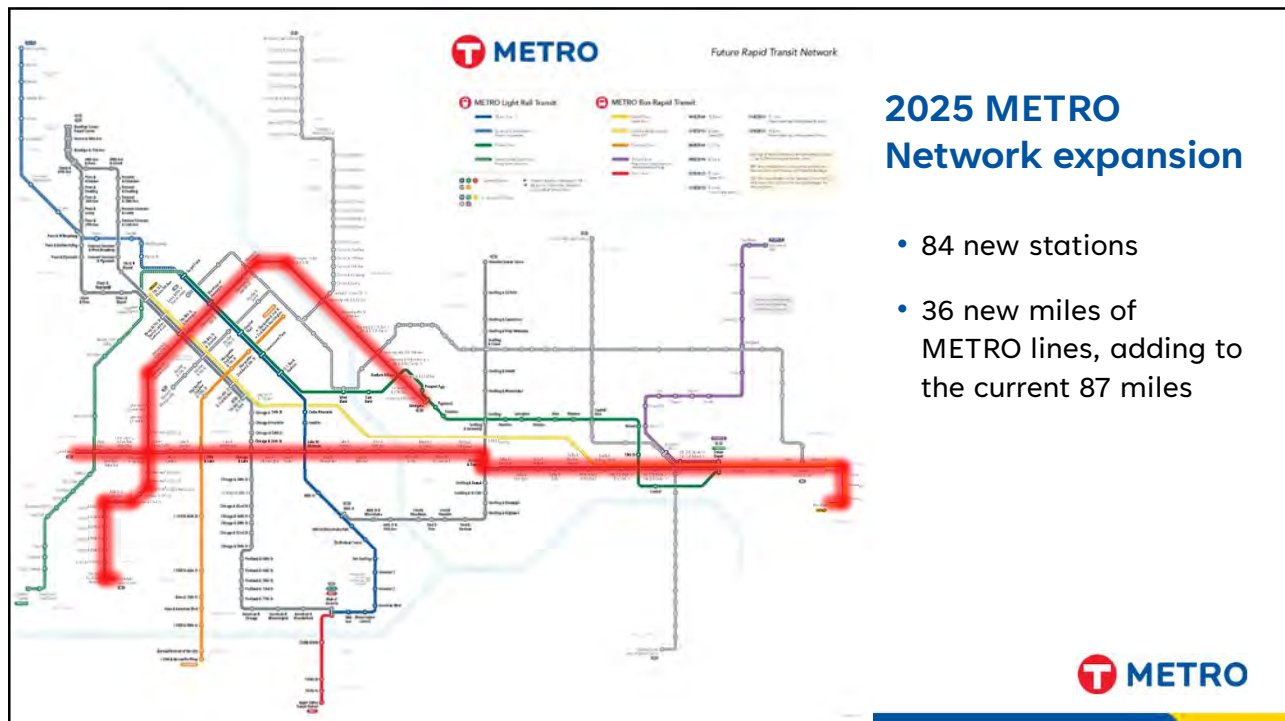

4



**Gold Line** 30 days until March 22



5

5

## Gold Line

- Project intro
- Funding and agreements
- Construction progress updates
- Operational readiness
  - Battery Electric Bus/Infrastructure (Aug. 2025)
  - System Safety
- Grand Opening Events

6



6



June 2024





Please note: METRO Gold Line will be on a long-term detour during Kellogg/3rd Street bridge construction. See inset for routing details.

**Downtown St. Paul**  
Kellogg/3rd Street Bridge Detour



	METRO Gold Line (bus rapid transit)
	METRO Gold Line detour
	Park & Ride Lot
<b>Current METRO line</b>	
	Green Line (Light Rail)
<b>METRO line opening June 2025</b>	
	B Line (bus rapid transit)



- Frequent service, operating primarily in bus-only lanes
- 10 miles & 16 new stations
- Budget: \$505.3 million
- 17 BRT-branded buses (12 diesel, 5 electric)
- BRT upgrades to East Metro Garage
- 2 new surface and 1 structured Park & Ride
- 8 grade-separated BRT crossings
- 34 bus operators
- Route 351 discontinued
- Kellogg Bridge closed until late 2026/early 2027

7

## Gold Line - Funding

- \$505.3M budget
  - Federal: \$259.57
  - State: \$5.89M
  - Local: \$239.84M
- Additional investment from local partners for utility replacements, trails, lighting, landscaping

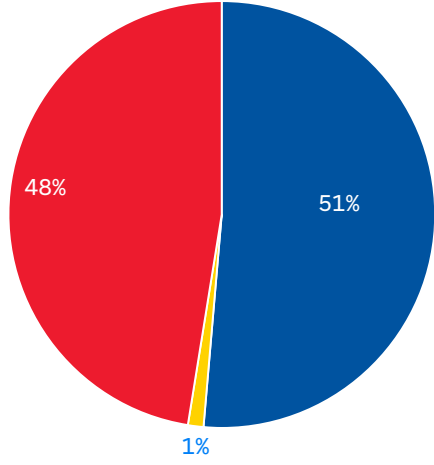

	Federal	51%
	Local	48%
	State	1%



8

## Gold Line - Construction Status

- Civil Construction
  - Substantially complete. Punch list, railings and fencing, systems integration testing ongoing
  - 2025 work (after revenue service): remaining landscaping, Helmo Park & Ride completion (MCES project)
- Woodlane Park & Ride
  - Substantially complete. Punch list, final building inspection and Occupancy Permit in February
- East Metro Garage
  - Electrification work on schedule for electric buses to begin service in August 2025
  - Interior bus maintenance hoist and extra storage in process

9



9

## Progress Photos – Maple Pedestrian Bridge



Accessible helix from north of I-94



Accessible access from south of I-94



10



10

## Progress Photos – Gold Line Guideway



BRT Guideway underpass at Ruth St



BRT Guideway on 4th Street at Hayward Ave



11



11

## Progress Photos – Gold Line Bridges



BRT Guideway at Etna



BRT Bridge at Bielenberg



12



12

BFO

### Progress Photos – Gold Line Stations



Earl Street Station



Sun Ray Station (cross over)



13



13

### Progress Photos – Gold Line Stations



Queens Avenue Station



Rice Park Station



14



14

## Progress Photos – Improved Access



New sidewalk on Wilson to access the Hazel St Station



New multi-use trail over McKnight Road



15



15

BFO

## Progress Photos – Woodlane Park & Ride



16



16



## Progress Photos – East Metro Garage



Battery-electric bus infrastructure



Maintenance hoists



17



17

## Gold Line - Operations and Maintenance Agreements

- General Infrastructure
  - Agreement with MnDOT nearing execution
  - Agreements with St. Paul, Maplewood, Oakdale, Woodbury underway
- Traffic Signals
  - Agreements with MnDOT, St. Paul, Washington County/Oakdale, Woodbury/Oakdale underway
- Bridges
  - Agreements with MnDOT, Oakdale, St. Paul, Maplewood, and Woodbury underway
- Guideway snow/ice control
  - Executed with Washington County
- Woodlane Park & Ride
  - Executed with Woodbury



Washington County plows at East Metro Garage

18



18

## Gold Line – Safety Certification

- What is it?
  - Processes that verify the safety and security readiness of a project for public use.
- Why do we do this?
  - Ensures employee, customer, and public safety
  - Required by FTA for projects >\$100 million in funding
- Timeline
  - Define project
  - Analyze hazards
  - Develop/implement controls
  - Perform verification activities
  - Final review

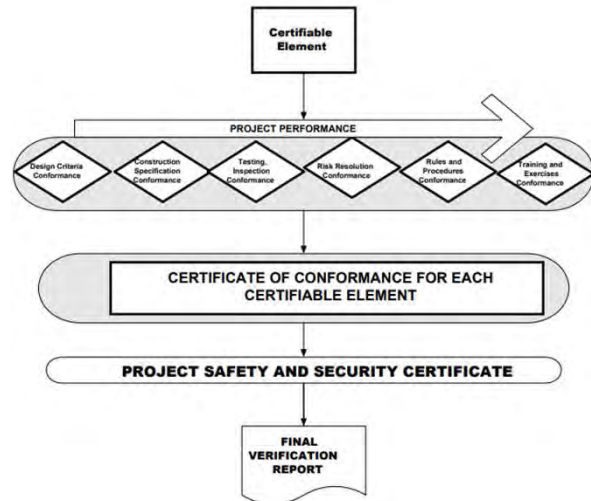

19

19

## Gold Line Emergency Drill – Helmo Ave. Station



Corridor cities learning about battery electric buses

20



20

## Gold Line – Operational Readiness

- Testing of various elements of the project ongoing to meet FTA requirements



Bar Signals



Gold Line Corridor Profile

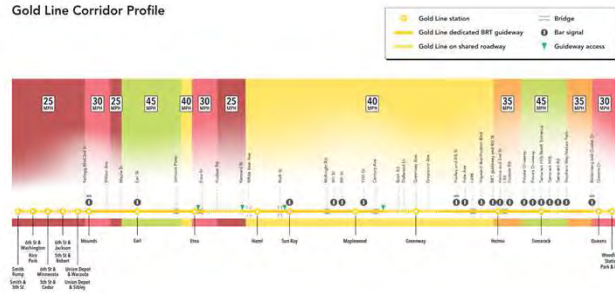

21



21

## Gold Line – Operational Readiness

- Gold Line will operate out of East Metro Garage
- Standard Operating Procedures (SOP), training PowerPoint, and training video in approval process

Designated Stops - Dtown StP	
<b>On 5th St:</b>	<b>On 6th St:</b>
Rice Park Station - Near-side	Jackson Station - Far-side
Cedar Station - Far-side	Minnesota Station - Far-side
Robert Station - Far-side	Washington Station - Near-side

**Metro Transit** SOP BUS RAPID TRANSIT - GOLD LINE  
Document No. 0053 Vers. 1.0  
Effective 3/15/2025  
Revised 03/06/20

**BUS RAPID TRANSIT - GOLD LINE**  
**Goal:** Safely and effectively navigate the BRT- Gold Line  
**When:** Operating a bus on the Gold Line

EASTBOUND	
<b>Actions:</b>	<b>Do This:</b>
1 Depart layover- Smith Ave Ramp	Get The Big Picture
2 Left Smith Avenue	Turn into the right lane



22



22

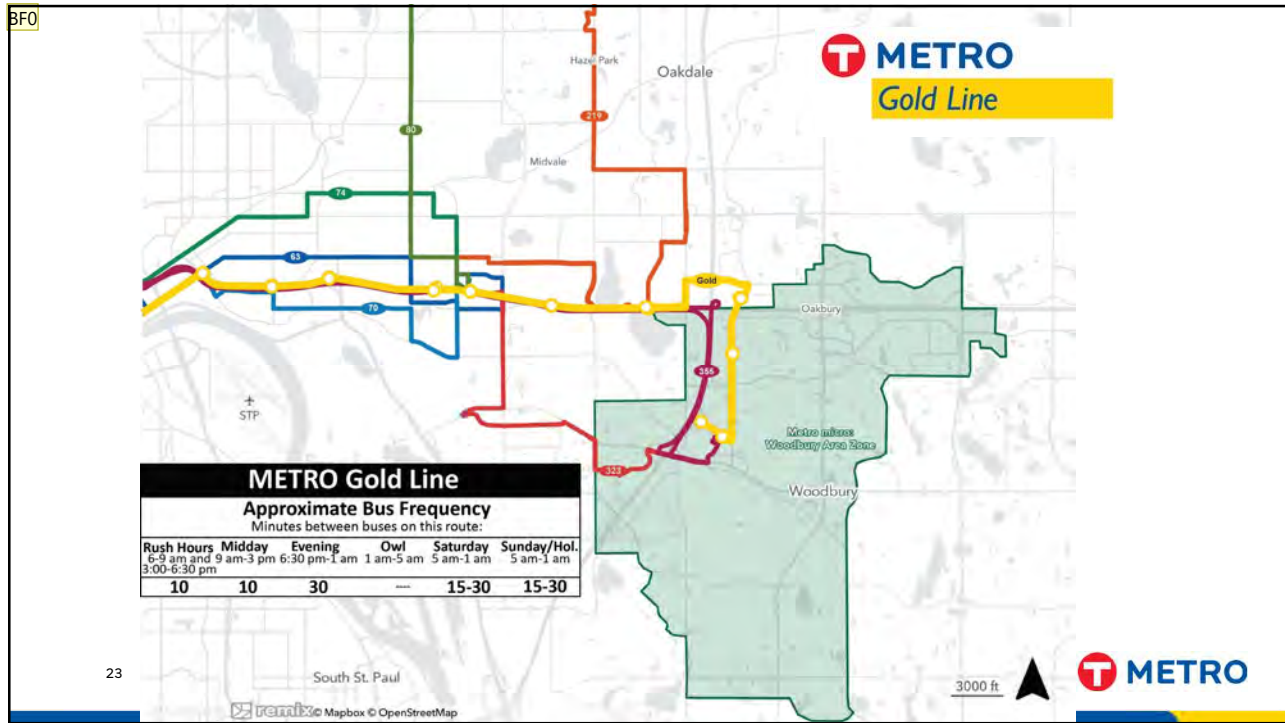

23

## Grand Opening Marketing, Communications, and Outreach

- Digital and Social Media
  - Website page with countdown clock
  - Organic and paid
  - Toolkit for Agency partners
- Community
  - Pop ups, community events and partnerships
  - Newsletters, mailer invitation
- Communications
  - Digital, newsletters, print, BIPOC media
  - Media pitches and tour March 18

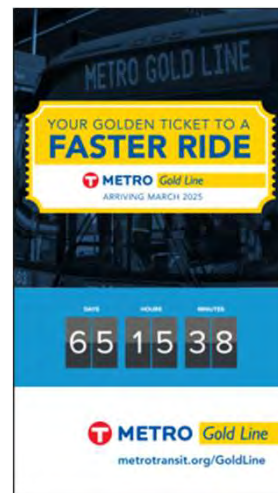

24



24

## Advertising - Pre-Launch & Post-Launch Campaigns



Pre-Launch: March 1 – 21, 2025



Post-Launch: March 22 – April 10, 2025

25



25

## Polymaker Tour and Reception – March 21

- Inaugural Gold Line tour
- City officials invited to speak during the tour
- Reception at Union Depot Red Cap Room



26



26

## Opening Day Events: Ribbon Cutting Ceremony on March 22



- Woodlane Park & Ride in Woodbury
- Program and remarks at 10 a.m.
- Ribbon cutting
- Photo op and media coverage
- VIP bus ride from Woodlane to Sun Ray Park & Ride

27



27

## Opening Day Events: Community Celebrations on March 22

- Two concurrent celebrations
  - Sun Ray Park & Ride, St. Paul
  - Woodlane Park & Ride, Woodbury
- Family friendly activities
  - Music, performing arts, food trucks and mascots!
- Free rides sponsored by Ramsey and Washington counties through March 28



28



28



**B Line 115 days until June 14**

**E Line 290 days until December 6**



29

29

## METRO B Line (Lake/Marshall/Selby)

- Upgrades Route 21, highest ridership local route
- 106,000 people live within a 10-minute walk or roll of the B Line, of whom 42% are BIPOC
- Planning & engagement began 2019
- Planned opening June 14, 2025



30

30

## B Line timeline



31



31

## B Line funding

- \$74 million authorized budget
  - Federal: \$16 million
  - State: \$43 million
  - Local/Regional: \$16 million
  - Updated budget reflects contingency shifts from D Line, December 2024 shifts of local scope into project budget
- Additional investment from local partners
  - Hennepin County/Minneapolis: Significant additional safety and accessibility improvements on Lake Street/Lagoon Avenue
  - Ramsey County/St. Paul: Additional Marshall Avenue improvements

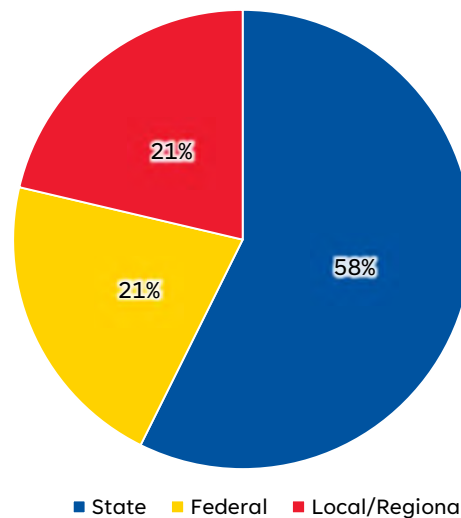

32



32



## Lake Street: Additional Needs

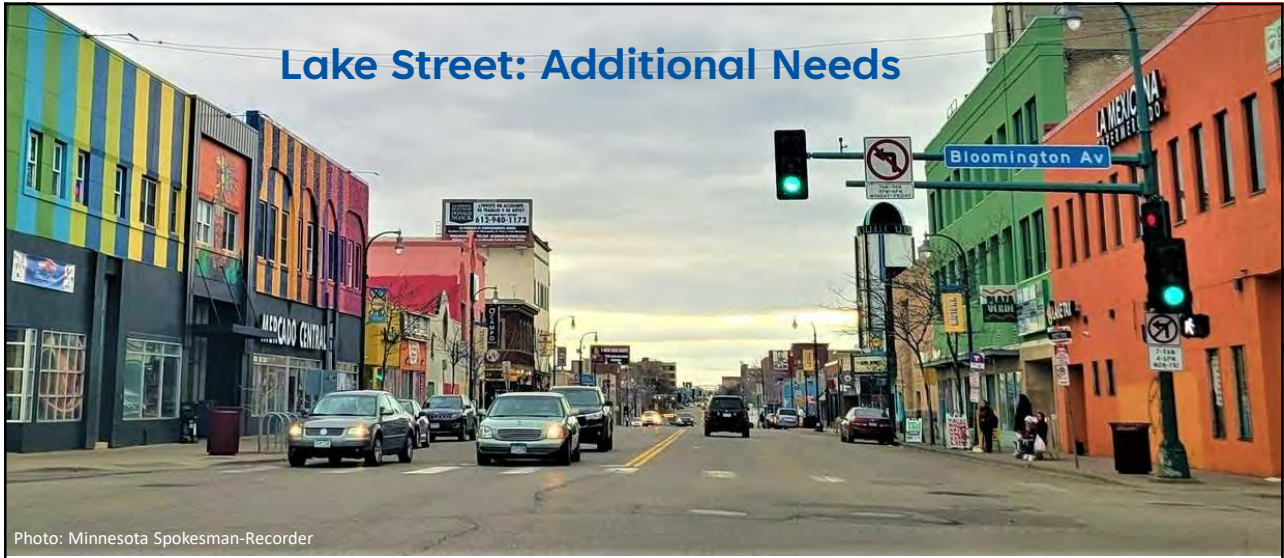

Photo: Minnesota Spokesman-Recorder

- Reconstructed 2006-2008
- Highest crash corridor in all of both Minneapolis & Hennepin County

33



33

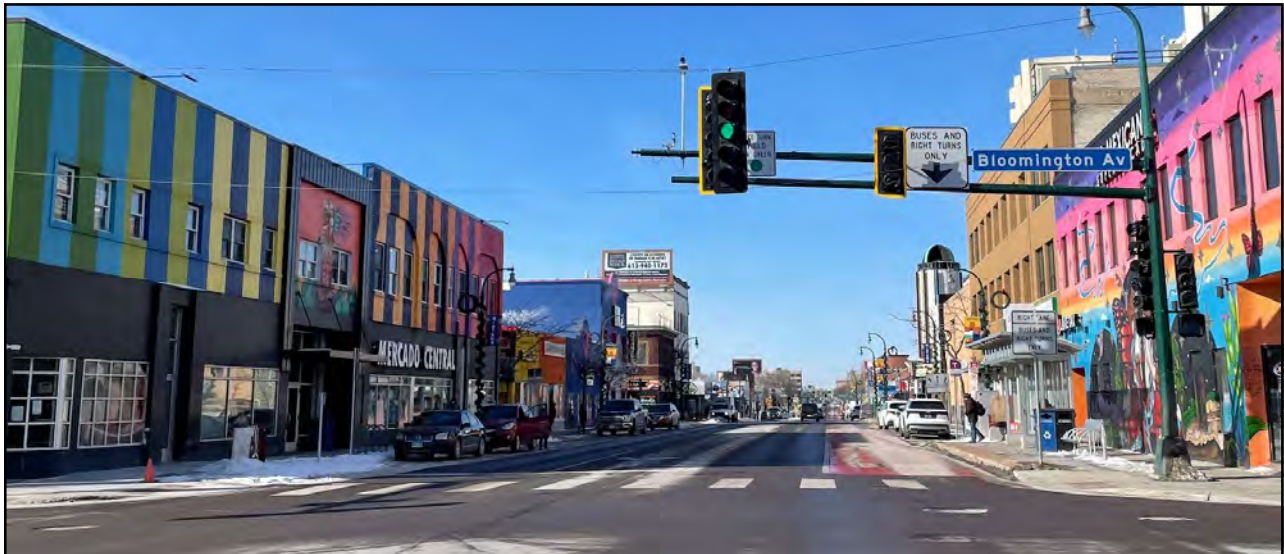

34



34

## City/County-funded Lake Street Improvements

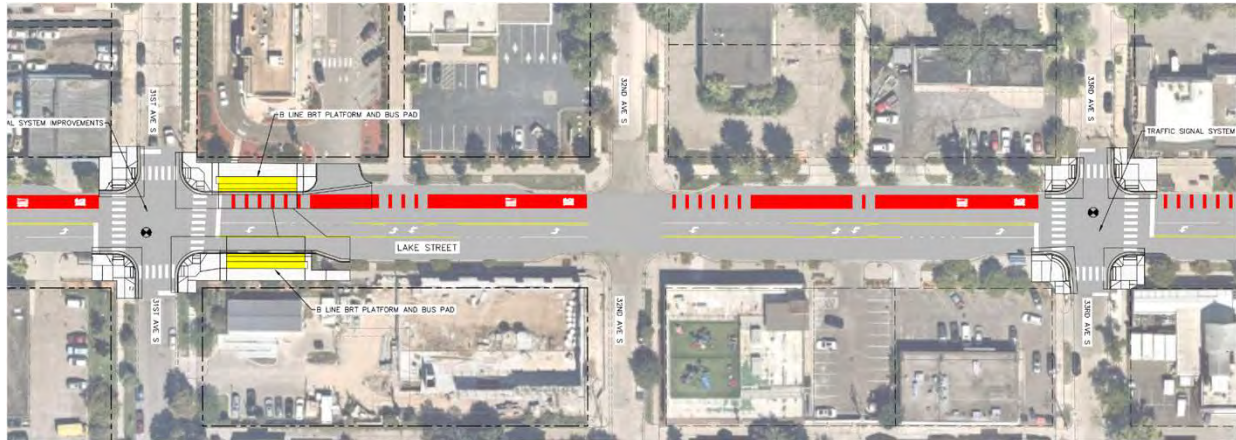

- Mill & overlay
- Accessible pedestrian ramps
- Traffic signal revisions
- 7 miles of bus lanes

35



35

## Construction phase engagement

- Engagement activities included:
  - Pre-construction postcard mailings
  - Door knocking adjacent properties before and during construction
  - Signage
  - Weekly drop-in office hours at corridor cafes
  - Weekly email newsletter updates
  - Construction hotline
  - Physical and digital rider alerts to Route 21 riders
- By the numbers:
  - **41,000** addresses received a postcard
  - **4,100** doors knocked
  - **63** office hour events
  - **51** email newsletters



36



36

## Phased completion of B Line improvements

- Winter 2023: 27 new shelters with heat and light ready for Route 21 customers
- Spring 2024: Completion of systems on East stations (real-time signs, emergency telephones, security cameras, etc.)
- October 2024: B Line stations at Lake & Chicago complete and ready to support transition of Route 21 operations from Chicago-Lake Transit Center
- December 2024: Completion of civil construction on Lake Street, and 15 additional new shelters with heat & light ready for customers
- Winter 2024-25: Completion of all systems installation, testing, & integration
- **June 14, 2025: METRO B Line service begins**

37



37



38



**John Ireland & Marshall – eastbound platform**  
September 2023

39



**Selby & Victoria – both platforms**  
September 2023

40



**Lake Street local improvements – mill & overlay**  
September 2023

41



**Lake Street/Midtown – westbound platform**  
July 2024

42



**Lake Street local improvements – pedestrian refuge**  
November 2024

43



**Lake & Bloomington – westbound platform**  
September 2024

44



**Lake & Chicago – westbound platform**  
September 2024

45



**Lake Street local improvements – Dupont intersection**  
September 2024

46



**Lagoon & Hennepin – westbound platform**  
**August 2024**

47



**Lagoon Avenue local improvements**  
**September 2024**

48





**Lake Street local improvements – bikeway**  
**October 2024**

49



**Lake & France – operator restroom facility**  
**October 2024**

50



**Lake & France – operator restroom opening celebration  
December 2024**

51

## **METRO E Line (France/Hennepin/University/4th)**

- Upgrades Route 6, high ridership local route
- 113,000 people live within a 10-minute walk or roll of the E Line, of whom 26% are BIPOC
- Planning & engagement began 2018
- Planned opening December 6, 2025



52

## E Line timeline



53



53

## E Line funding

- \$64 million authorized budget
  - Federal: \$12 million
  - State: \$34 million
  - Local/Regional: \$18 million
  - Excludes fleet, accounted separately
- Additional \$11 million for local scope funded by Hennepin County and City of Minneapolis
  - Pedestrian safety and accessibility improvements
  - Shared fiber optic network

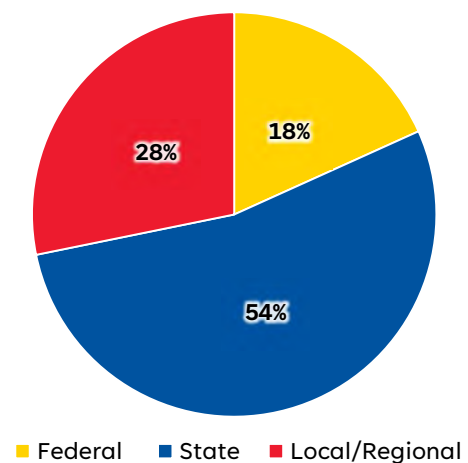

54



54

## Agency coordination: Partner-led projects

- 25 E Line platforms constructed through partner-led projects
- City of Minneapolis
  - Hennepin Avenue in Uptown
  - Hennepin Avenue Downtown
- Hennepin County
  - Hennepin and First Roadway Improvements
  - University and Fourth Roadway Improvements
- MnDOT
  - University Avenue and Fourth Street (future)

55



55

## Agency coordination: Partner-led projects

- 25 E Line platforms constructed through partner-led projects
- City of Minneapolis
  - Hennepin Avenue South
  - Hennepin Avenue Downtown
- Hennepin County
  - Hennepin and First Roadway Improvements
  - University and Fourth Roadway Improvements
- MnDOT
  - University Avenue and Fourth Street (future)

56



56

## Agency coordination: local scope

- Additional improvements funded by Hennepin County and City of Minneapolis
- At 12 intersections and fiber optic connections along the corridor
  - Pedestrian safety and accessibility improvements
    - Accessible curb ramps
    - Bumpouts and medians
    - Enhanced pedestrian crossings
  - Protected bike facilities
  - Traffic signal upgrades
  - Fiber optic connections



57

57

## Agency coordination: local scope

- Additional improvements funded by Hennepin County and City of Minneapolis
- At 12 intersections and fiber optic connections along the corridor
  - Pedestrian safety and accessibility improvements
    - Accessible curb ramps
    - Bumpouts and medians
    - Enhanced pedestrian crossings
  - Protected bike facilities
  - Traffic signal upgrades
  - Fiber optic connections



58

58

## E Line construction engagement by the numbers

- **80,000+** postcards mailed explaining upcoming construction
- **50+** hours of doorknocking reaching out to station neighbors
- **32** construction newsletters sent to **2,000** email subscribers
- **36** hours of in-community office hours
- **13** presentations at business/ neighborhood association meetings



59

59



France & 58th Street, January 2025

60



France & 50th Street, October 2024

61



France & 50th Street, October 2024

62



**France & 44th Street, November 2024**

63



**44th Street & Abbott, November 2024**

64



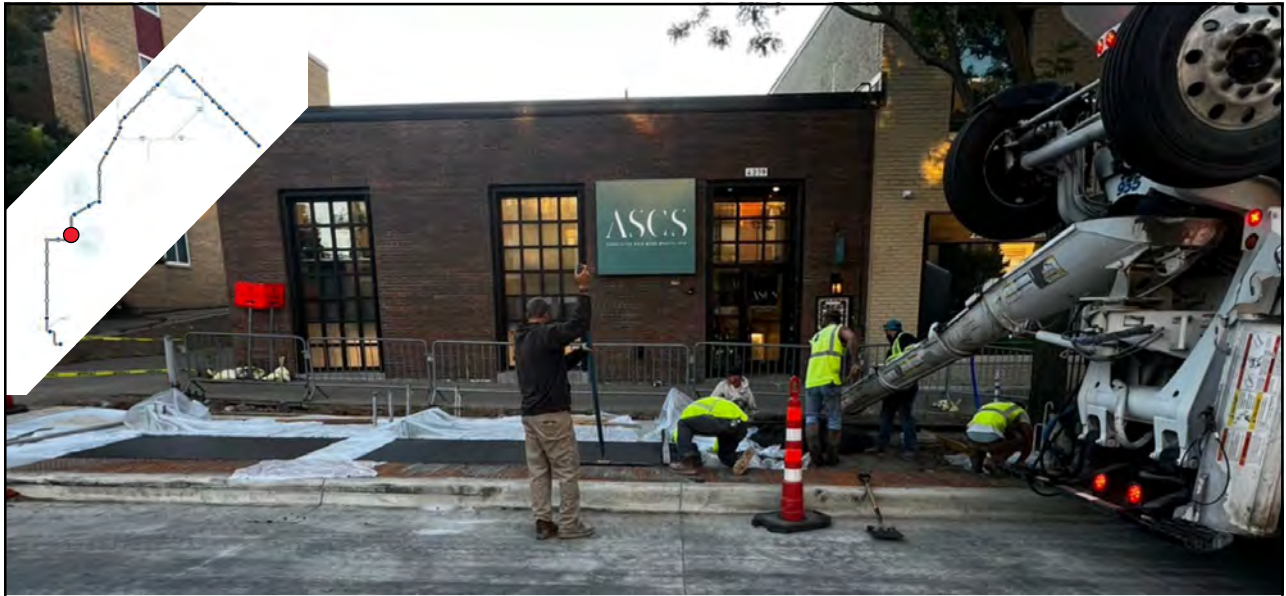

**Sheridan & 43rd Street, September 2024**

65



**Hennepin & 33rd Street, November 2024**

66



Westgate Station driver facility, January 2025

67

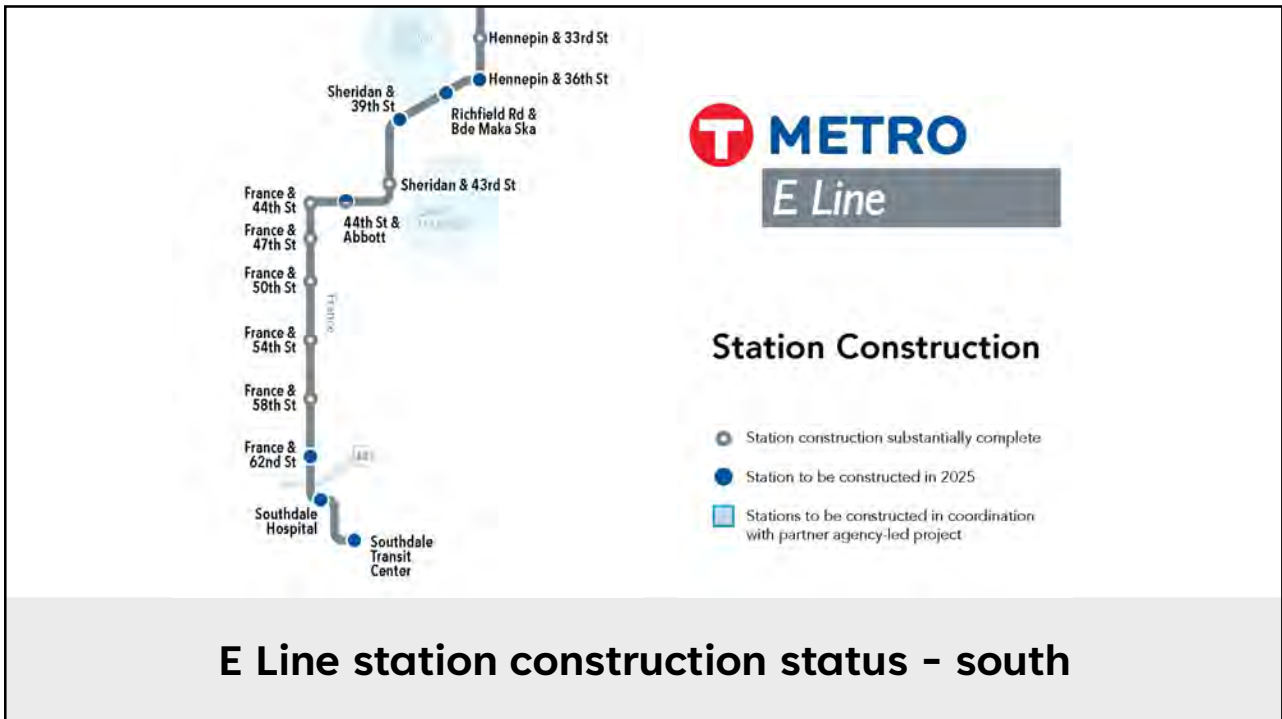

E Line station construction status - south

68

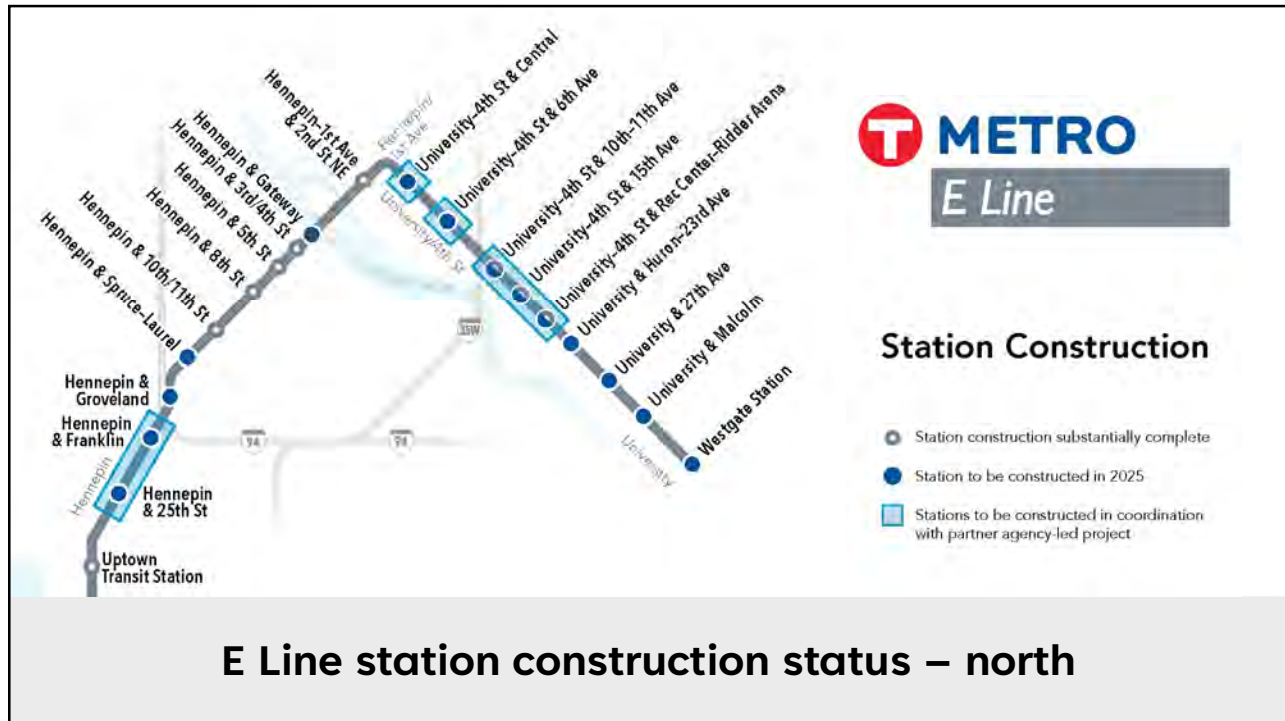

69

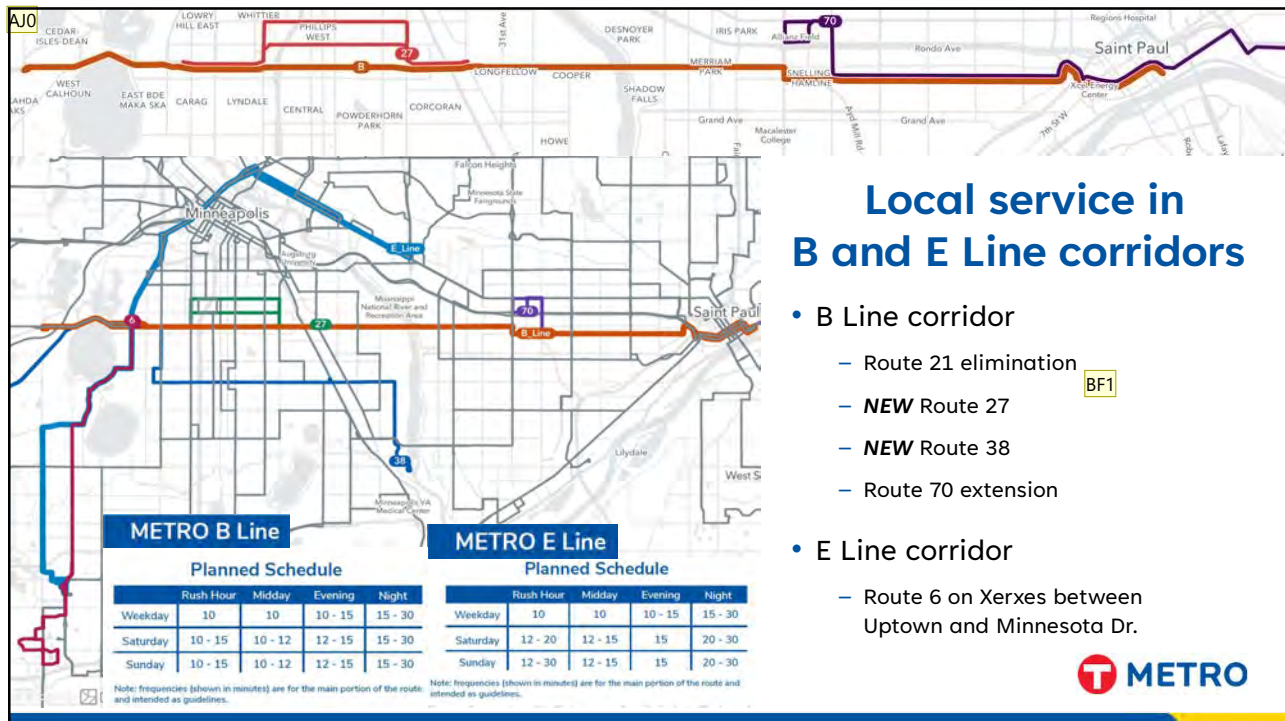

70



71

## Systemwide Preparations

71

## Bus Operator Workforce Readiness

- Bus Transportation projects full staffing for 2025 BRT openings
- Additional resources will support training & readiness preparations and system reliability

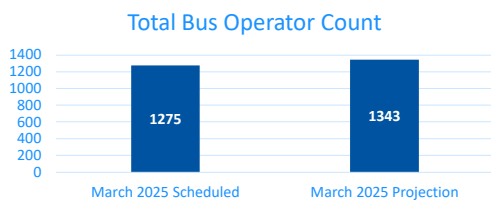

72



72

BF1

## Operational Readiness

- Facilities
  - Maintenance Staffing
    - Updated staffing forecast and route planning
  - Cleaning & Repair Standards
  - Space and Equipment
    - Lease of 345 Industrial Blvd.
  - O&M Agreements
    - Gold Line: agreements executed with various stakeholders detailing maintenance responsibilities, including snow removal



73

73

BF0

## Coordinated layers of official presence



Police Officers



TRIP Agents



Real Time Information Center



Community Service Officers



Supplemental Security



Community-based Partnerships

All stations equipped with emergency call buttons, security cameras, signage with Text for Safety information

All buses include security cameras and Text for Safety information



74

74

## BRT Awareness Campaign Milestones

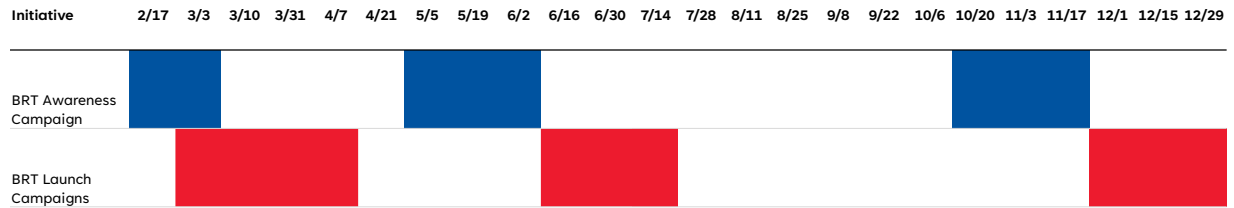

- Support Gold, B and E Lines in 2025
- Media will run approximately a month prior to specific launch campaigns to build awareness



75

## BRT Brand Awareness Campaign

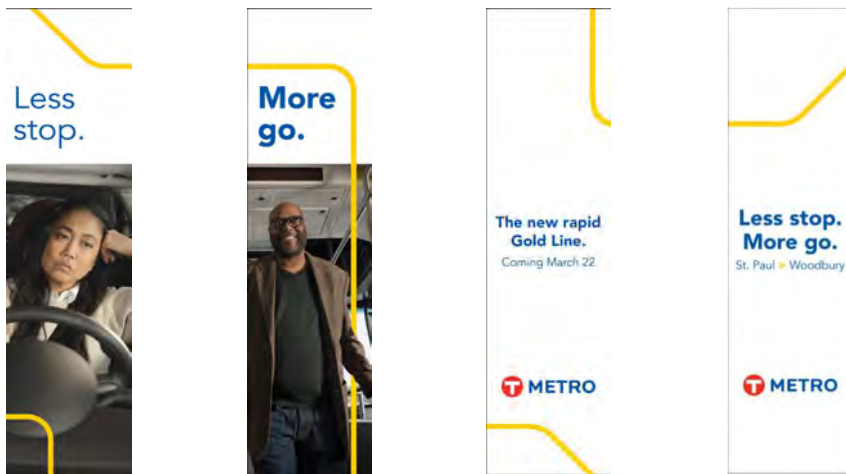

76



76

## Media - Videos

- Digital Campaign focused in and around the communities along each new BRT line
- Includes video, paid social media, digital OOH (Out of Home), and BIPOC partnerships and media



77



77



**Thank You!**

Any questions?

78

78