

Livable Communities Act

Livable Communities Demonstration Account

Transit-Oriented Development (LCDA-TOD) Grant Category

# 2020 Spring Round LCDA-TOD Pre-Development Funding Recommendation

June 15, 2020

Community Development Committee



# Livable Communities Demonstration Account Transit Oriented Development Purpose

The Council's Livable Communities Demonstration Account - Transit Oriented Development (LCDA-TOD) grants promote *moderate to high density development* projects located within *walking distance of a major transit stop* that typically include *a mix of uses* such as housing, jobs, restaurants, shops, and entertainment.

# 2020 Funding Availability

The Council approved:

- Up to \$500,000 for LCDA-TOD Pre-Development and Zoning Implementation grants to be awarded in two application rounds with \$250,000 available in each Spring and Fall funding opportunity



# Review Process

May 1, 2020: the Council received two LCDA-TOD Pre-Development applications

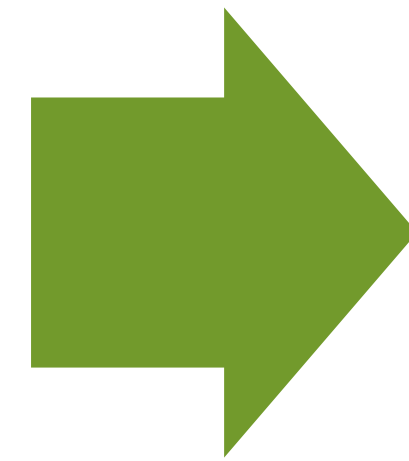

Applications undergo an evaluation by a staff team from the Community Development division

# 2020 Spring Funding Recommendation

## That the Metropolitan Council:

1. Award two Livable Communities Demonstration Account Transit-Oriented Development Pre-Development grants for \$200,000.
2. Authorize its Community Development Division Director to execute the grant agreements on behalf of the Council.

# 2020 Spring Funding Recommendation

## LCDA-TOD Pre-Development

Development Project	Applicant	Score (39 point minimum)	Amount Requested	Amount Recommended
<b>Towerside District Stormwater</b>	Minneapolis	51.5	\$100,000	\$100,000
<b>Keystone Community Food Site</b>	Saint Paul	40	\$100,000	\$100,000
<b>Total Recommended</b>				<b>\$200,000</b>
<b>Total Available</b>				\$250,000
<b>Total Remaining</b>				\$50,000



Recommended Award:  
**\$100,000**

# Towerside District Stormwater



- Multi-phase development project bringing housing options, commercial, and retail to vacant land in the Prospect Park Station Area
- Pursuing stacked infrastructure with a district-scale stormwater system and green space
- Example of public private partnership



Recommended Award:  
**\$100,000**

# Keystone Community Food Site

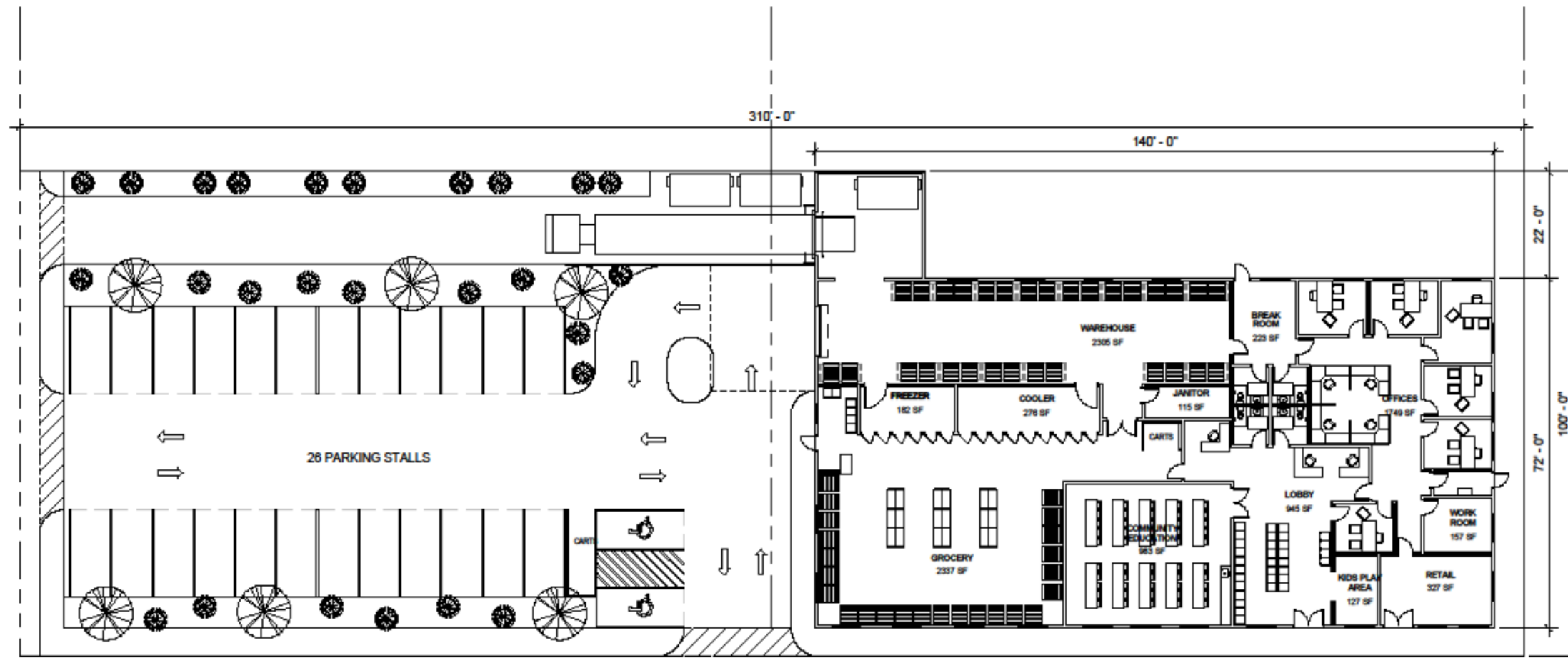

1 LEVEL 1 PLAN  
A802 1" = 20'-0"

GROSS SQUARE FOOTAGE: 10,600 ft<sup>2</sup>

- Creates a more walkable and transit friendly community by providing greater access to essential daily need
- Project incorporates mix of uses in a TOD area
- Example of strong community engagement process



# 2020 Spring Funding Recommendation

## That the Metropolitan Council:

1. Award two Livable Communities Demonstration Account Transit-Oriented Development Pre-Development grants for \$200,000.
2. Authorize its Community Development Division Director to execute the grant agreements on behalf of the Council.



**METROPOLITAN**  
C O U N C I L