

City of Birchwood Village – District 12

2040 Comprehensive Plan

July 6, 2021

Community Development Committee



Regional Systems



Regional Systems

Transportation

Transitways

2040 Transportation System Policy - adopted January 2015

- Existing
- Planned Current Revenue Scenario
- Planned Current Revenue Scenario - CTIB* Phase 1 Projects
- Potential Increased Revenue Scenario

Regional Highway System

- Existing Principal Arterials
- Planned Principal Arterials
- Existing Minor Arterials
- Planned Minor Arterials
- Existing Other Arterials
- Planned Other Arterials

Recreation Open Space

Regional Parks

- Existing (Open to Public)
- In Master Plan (Not Open to Public)
- Planned Units

Regional Trails

- Existing (Open to Public)
- Existing (Not Open to Public)
- Planned

Wastewater

- Meters
- Lift Stations
- MCES Interceptors
- MCES Treatment Plants

Regional Park Search Areas and Regional Trail Search Corridors

- Boundary Adjustment
- Search Area
- Regional Trail Search Corridors

- Local Streets
- Existing State Trails
- Other Parks, Preserves, Refuges and Natural Areas

* Counties Transit Improvement Board (CTIB)



Source: NCompass Technologies Street Centerline



Community Designation

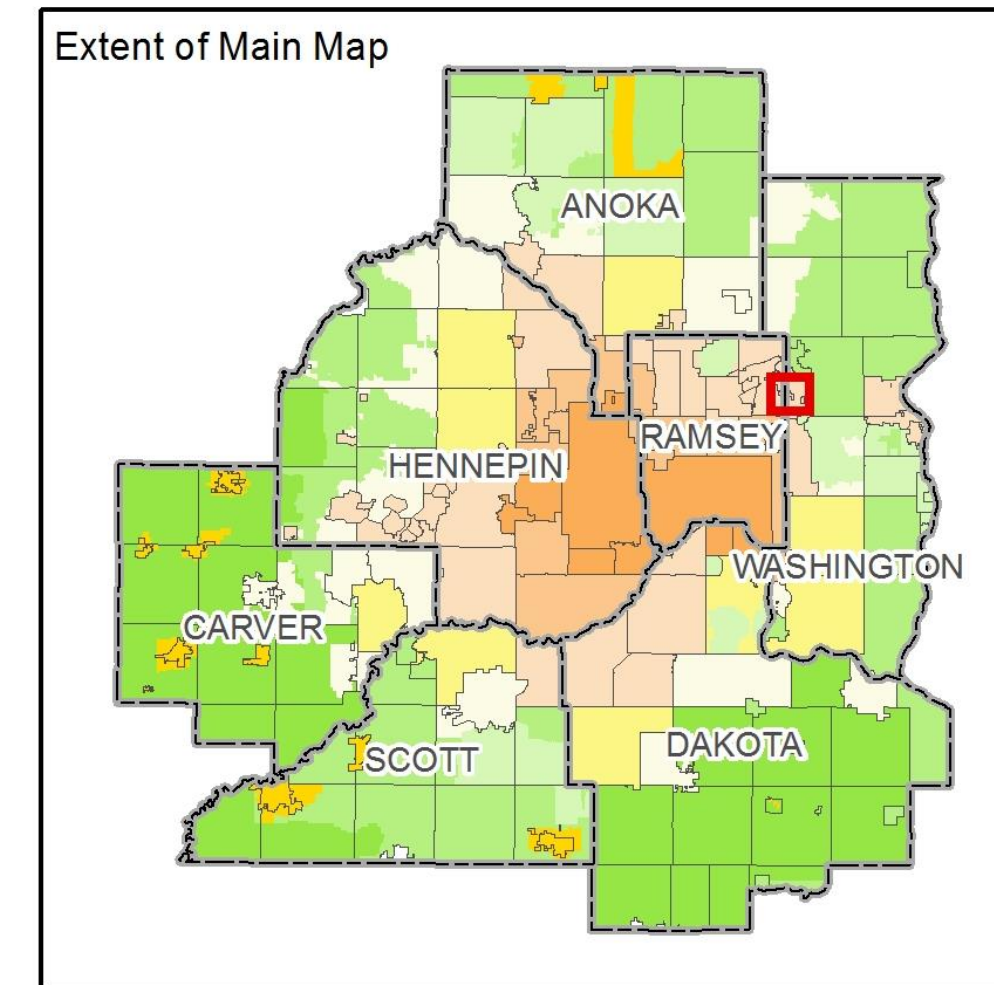
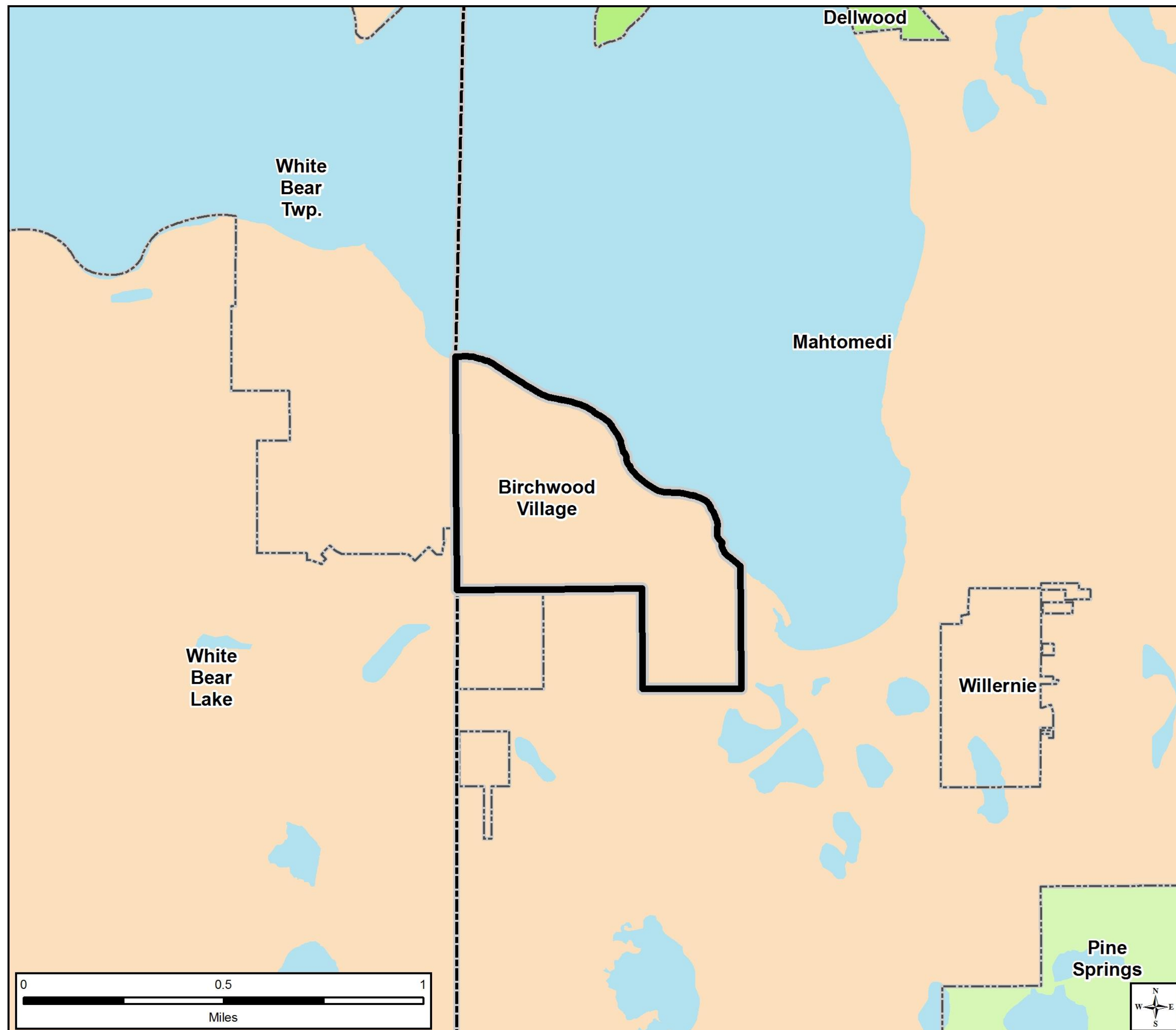

Community Designations

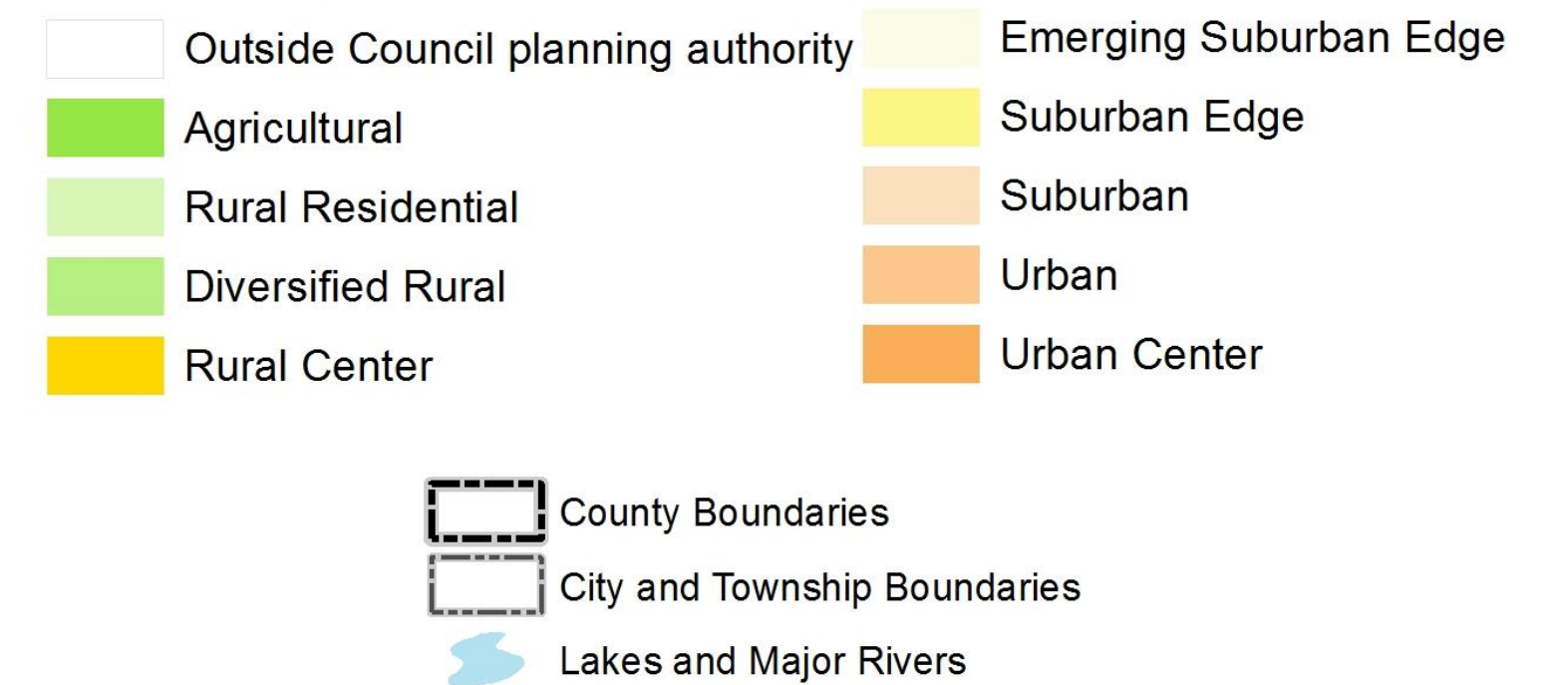

Forecasted Growth

Table 1. City of Birchwood Forecasts

	Census	Estimated	Council Forecasts		
	2010	2017	2020	2030	2040
Population	870	873	850	830	800
Households	351	357	360	360	360
Employment	25	34	30	30	30

Existing Land Use

Existing Generalized Land Use (Metropolitan Council 2016)

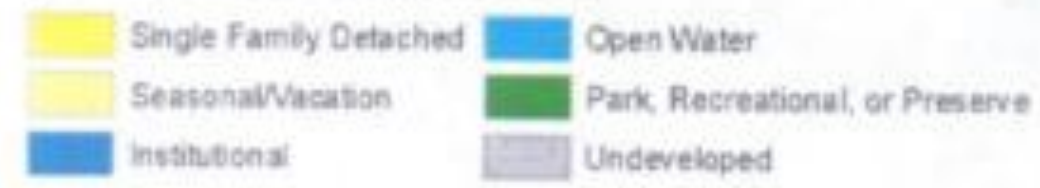

DRAFT

Source: Metropolitan Council,
MnDNR, Birchwood Village,
Washington County

Rev. Date: 4.1.2019
Date: 9.20.2017
Prepared by: SHC, LLC



2040 Planned Land Use

Planned Land Use & Zoning

- Residential (Low Density 3-5d.u./acre)
- Institutional
- Parks/Open Space
- ROW

DRAFT



Source: Metropolitan Council,
MnDNR, Birchwood Village,
Washington County

Rev. Date: 4.1.2019
Date: 9.20.2017
Prepared by: SHC, LLC



Proposed Findings

That the Plan:

- Conforms to Metropolitan system plans
- Consistent with Council policies
- Compatible with the plans of adjacent local governmental units and affected jurisdictions

Meeting Schedule

- Environment Committee on Tuesday, July 13
- Metropolitan Council on Wednesday, July 28

Proposed Action

Recommendations of the Community Development Committee

- Authorize the City of Birchwood Village to place its 2040 Comprehensive Plan into effect.
- Advise the City to implement the advisory comments in the Review Record for Transportation and Wastewater.

Questions

