

ACTION TRANSMITTAL No. 2021-57

DATE: December 2, 2021
TO: Transportation Advisory Board
FROM: Technical Advisory Committee
PREPARED BY: Joe Barbeau, Senior Planner (651-602-1705)
SUBJECT: Streamlined 2022-2025 TIP amendment for Woodbury: HSIP Project Expansion
REQUESTED ACTION: Woodbury requests an amendment to 2022-2025 TIP to extend the length of its Lake Road 4-lane-to-3-lane conversion and add mill and overlay, signals, and ADA improvements (SP # 192-108-028).
RECOMMENDED MOTION: That the Transportation Advisory Board recommend adoption of an amendment to the 2022-2025 TIP to extend the length of Woodbury's Lake Road 4-lane-to-3-lane conversion and add mill and overlay, signals, and ADA improvements (SP # 192-108-028).

BACKGROUND AND PURPOSE OF ACTION: This request is to expand the project footprint and increase the project cost in adding adjacent locally funded mill and overlay, signals, and ADA improvements to the contract.

This project was funded through the Highway Safety Improvement Program (HSIP) Solicitation. The elements of that project will remain intact while additional elements added to the contract will not be eligible for the awarded HSIP funds. The purpose of adding this local work to the project is to create efficiency in letting the projects together.

Woodbury requested the addition of this new work to the project contract. Council staff and MnDOT determined that the request could be approved as an informal scope change.

RELATIONSHIP TO REGIONAL POLICY: Federal law requires that all TIP amendments meet the following four tests: fiscal constraint; consistency with the adopted regional transportation plan; air quality conformity; and opportunity for public input. It is the TAB's responsibility to recommend TIP amendments to the Council for adoption, provided these four requirements are met.

The streamlined TIP amendment process allows projects that meet certain conditions to be streamlined, which entails forgoing the TAC Funding & Programming Committee review and results in saving a month of process time.

STAFF ANALYSIS: The TIP amendment meets fiscal constraint because the state funds are sufficient to fully fund the project. This amendment is consistent with the Metropolitan Council Transportation Policy Plan, adopted by the Metropolitan Council on November 18, 2020 with FHWA/FTA conformity determination established on December 4, 2020. Public input opportunity for this amendment is provided through the TAB's and the Council's regular meetings. The Minnesota Interagency Air Quality and

Transportation Planning Committee determined that the project is exempt from air quality conformity analysis.

COMMITTEE COMMENTS AND ACTION: At its December 1, 2021, meeting, the Technical Advisory Committee voted unanimously to recommend adoption of an amendment to the 2022-2025 Transportation Improvement Program to extend the length of Woodbury's Lake Road 4-lane-to-3-lane conversion and add mill and overlay, signals, and ADA improvements.

ROUTING

TO	ACTION REQUESTED	DATE SCHEDULED / COMPLETED
Technical Advisory Committee	Review & Recommend	12/1/2021
Transportation Advisory Board	Review & Recommend	12/15/2021
Metropolitan Council Transportation Committee	Review & Recommend	12/20/2021
Metropolitan Council	Review & Adopt	12/22/2021

Please amend the 2022-2025 Transportation Improvement Program (TIP) to include this adjust this project in program year 2022. This project is being submitted with the following information:

PROJECT IDENTIFICATION:

Seq #	State Fiscal Year	ATP/ Dist	Route System	Project Number	Agency	Description
1482	2022	M	MSAS 108	192-108-028	Woodbury	**AC**PRS** : Lake Rd, Woodlane Dr <u>Courtly Rd.</u> to Pioneer Dr in Woodbury - Convert 4-lane section to 3-lane section, <u>mill and overlay, signal, ADA</u> (AC project, payback in FY24)

Miles	Prog	Type of Work	Prop Funds	Total \$	AC \$	Other \$
1.8	SH	Pavement Markings	HSIP	1,944,000	1,620,000	324,000-
<u>2.5</u>				<u>2,100,000</u>		<u>480,000</u>

PROJECT BACKGROUND:

1. Briefly describe why amendment is needed (e.g., project in previous TIP but not completed; illustrative project and funds now available; discretionary funds received; inadvertently not included in TIP).

This amendment is needed to revise the termini and project cost due to an Administrative Scope Change to add an adjacent locally funded mill and overlay project to the contract.

2. How is Fiscal Constraint Maintained as required by 23 CFR 450.216 (check all that apply)?

- New Money
- Anticipated Advance Construction
- ATP or MPO or MnDOT Adjustment by deferral of other projects
- Earmark or HPP not affecting fiscal constraint
- Other X

No additional federal funds are being added to the project, therefore fiscal constraint is maintained.

CONSISTENCY WITH MPO LONG RANGE PLAN:

This amendment is consistent with the Metropolitan Council Transportation Policy Plan, adopted by the Metropolitan Council on November 18, 2020 with FHWA/FTA conformity determination established on December 4, 2020.

AIR QUALITY CONFORMITY:

- Subject to conformity determination
- Exempt from regional level analysis
- N/A (not in a nonattainment or maintenance area)

* The project is coded A-30; Regionally significant but is exempt from air quality review, as additional work does not create new, or impact existing, regionally significant project elements.

ADMINISTRATIVE SCOPE CHANGE REQUEST FORM

SP # 192-108-028
Regional Solicitation Year: 2020
Funding Application ID # R26
Current Fiscal Year: 2022
Current STIP Description: **AC** LAKE RD, WOODLANE DR TO PIONEER DR IN WOODBURY - CONVERT 4-LANE SECTION TO 3-LANE SECTION (PAYBACK IN FY 2024)
STIP Federal Funding: \$1,620,000
STIP Total Cost: \$1,944,000
To be filled out by Project Sponsor
Proposed New STIP Description: **AC** LAKE RD, COURTLY RD TO PIONEER DR IN WOODBURY - CONVERT 4-LANE SECTION TO 3-LANE SECTION, MILL AND OVERLAY, ADA (PAYBACK IN FY 2024)
Federal Funding: \$1,620,000
New Total Cost:
Short write up with reason for scope change (i.e.; contractor coordination, better bids, etc.): Intersection improvements at Lake Road and Courtly Avenue including improvements to pedestrian ramps, signals, and full pavement replacement. Drain tile added on north side of Lake Rd east of Courtly Ave due to drainage issue. Mill and overlay on Lake Road from east of Courtly Rd to Tahoe Rd. Curb improvements on north side of Lake Rd at Jordan Dr, Cornelia Tr, and Lake Terrace W for future trail project. Reason for adding work is due to pavement condition, safety issues, and future trail project. Work will be funded by Municipal State Aid Roadway Construction Fund.

ATTACHMENTS:

Colored Map – include original project in one color and any changes/additions in another color



STIP Amendment required? **Y**

Formal Amendment _____ STIP Modification **__X__**

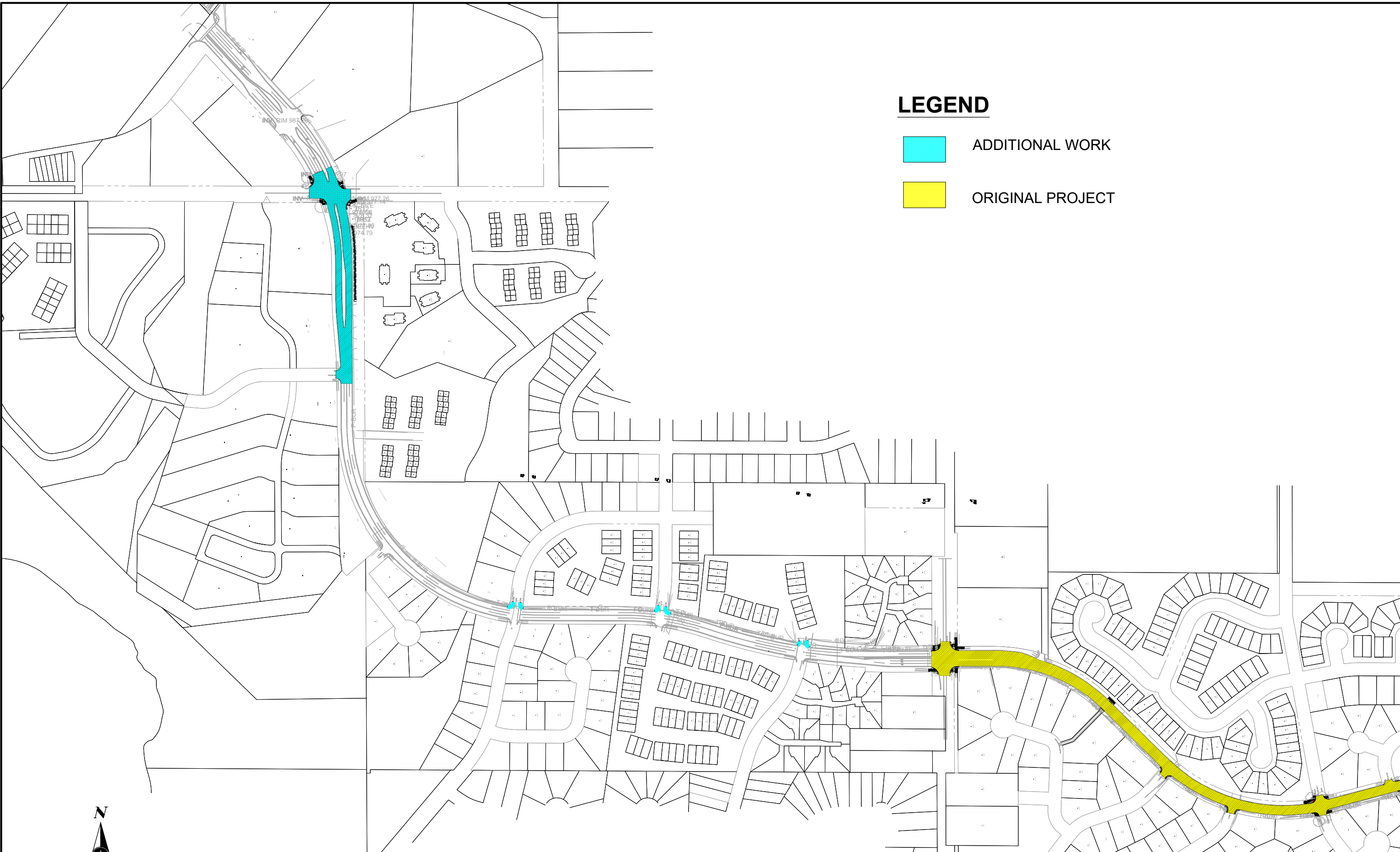
Save: 10/27/2021 1:42 PM zstafellen Plct: 10/27/2021 1:43 PM X:\UZIW\WOODB\158112\5-final-dsgn\63-dsgn\63-state aid_federal_submittal\STIP Mod\STIP Mod Exhibit.dwg



LEGEND

-  ADDITIONAL WORK
-  ORIGINAL PROJECT



FILE NO.
158112
DATE:
10/29/2021

STIP MODIFICATION EXHIBIT
4-3 LANE CONVERSION
WOODBURY, MN
SP 192-08-028

EXHIBIT
NO. 1

ENGINEER'S ESTIMATE

WOODBURY, MINNESOTA
 LAKE ROAD FOUR TO THREE LANE COVERSION
 SEH NO. WOODB 158112
 SP 192-108-028

LINE	ITEM NO.	ITEM	UNIT	UNIT PRICE	TOTAL		LAKE ROAD					
					ESTIMATED QUANTITY	ESTIMATED COST	SP 192-108-028 PARTICIPATING		SAP 192-108-028 PARTICIPATING		NON - PARTICIPATING	
							ESTIMATED QUANTITY	ESTIMATED COST	ESTIMATED QUANTITY	ESTIMATED COST	ESTIMATED QUANTITY	ESTIMATED COST
1	2021.501	MOBILIZATION	LS	\$79,000.00	1.00	\$79,000.00	0.67	\$52,930.00	0.31	\$24,490.00	0.02	\$1,580.00
2	2102.503	PAVEMENT MARKING REMOVAL	LF	\$2.00	130.00	\$260.00	0	\$0.00	130	\$260.00	0	\$0.00
3	2104.502	SALVAGE SIGN TYPE C	EACH	\$60.00	99.00	\$5,940.00	68	\$4,080.00	31	\$1,860.00	0	\$0.00
4	2104.502	SALVAGE SIGN TYPE SPECIAL (STREET NAME SIGN)	EACH	\$75.00	20.00	\$1,500.00	12	\$900.00	8	\$600.00	0	\$0.00
5	2104.502	REMOVE SIGN TYPE C	EACH	\$50.00	16.00	\$800.00	12	\$600.00	4	\$200.00	0	\$0.00
6	2104.502	REMOVE CATCH BASIN CASTING	EACH	\$200.00	1.00	\$200.00	1	\$200.00	0	\$0.00	0	\$0.00
7	2104.503	REMOVE CURB & GUTTER	LF	\$7.50	2,109.00	\$15,817.50	1729	\$12,967.50	380	\$2,850.00	0	\$0.00
8	2104.503	SAWING BIT PAVEMENT (FULL DEPTH)	LF	\$3.00	596.00	\$1,788.00	428	\$1,284.00	168	\$504.00	0	\$0.00
9	2104.504	REMOVE BITUMINOUS PAVEMENT	SY	\$6.00	3,156.00	\$18,936.00	0	\$0.00	3,156	\$18,936.00	0	\$0.00
10	2104.518	REMOVE CONCRETE SIDEWALK	SF	\$3.50	2,122.00	\$7,427.00	1425	\$4,987.50	697	\$2,439.50	0	\$0.00
11	2104.518	REMOVE BITUMINOUS WALK	SF	\$2.50	1,958.00	\$4,895.00	1352	\$3,380.00	606	\$1,515.00	0	\$0.00
12	2112.604	SUBGRADE PREPARATION	SY	\$2.00	3,156.00	\$6,312.00	0	\$0.00	3,156	\$6,312.00	0	\$0.00
13	2232.504	MILL BITUMINOUS SURFACE (2.00")	SY	\$1.75	55,617.00	\$97,329.75	51365	\$89,888.75	4,252	\$7,441.00	0	\$0.00
14	2357.506	BITUMINOUS MATERIAL FOR TACK COAT	GAL	\$3.00	5,107.00	\$15,321.00	4466	\$13,398.00	641	\$1,923.00	0	\$0.00
15	2360.504	TYPE SP 9.5 WEARING COURSE MIXTURE (3,C) (TRAIL/PATCHING)	SY	\$20.00	158.00	\$3,160.00	138	\$2,760.00	20	\$400.00	0	\$0.00
16	2360.509	TYPE SP 12.5 WEARING COURSE MIXTURE (4,E)	TON	\$80.00	8,269.00	\$661,520.00	6523	\$521,840.00	1,746	\$139,680.00	0	\$0.00
17	2360.509	TYPE SP 12.5 NON-WEARING COURSE MIXTURE (3,B)	TON	\$80.00	804.00	\$64,320.00	0	\$0.00	804	\$64,320.00	0	\$0.00
18	2502.503	6" PERF PE PIPE DRAIN	LF	\$100.00	323.00	\$32,300.00	0	\$0.00	0	\$0.00	323	\$32,300.00
19	2502.602	6" PE PIPE DRAIN CLEANOUT W/ CAP	EACH	\$500.00	1.00	\$500.00	0	\$0.00	0	\$0.00	1	\$500.00
20	2503.602	CONNECT INTO EXISTING DRAINAGE STRUCTURE	EACH	\$2,000.00	1.00	\$2,000.00	0	\$0.00	0	\$0.00	1	\$2,000.00
21	2504.602	ADJUST GATE VALVE & BOX	EACH	\$750.00	13.00	\$9,750.00	13	\$9,750.00	0	\$0.00	0	\$0.00
22	2506.502	CASTING ASSEMBLY (ADA SAFE GRATE)	EACH	\$1,000.00	1.00	\$1,000.00	1	\$1,000.00	0	\$0.00	0	\$0.00
23	2506.502	ADJUST FRAME RING AND CASTING	EACH	\$1,000.00	73.00	\$73,000.00	56	\$56,000.00	17	\$17,000.00	0	\$0.00
24	2521.518	6" CONCRETE WALK	SF	\$15.00	3,060.00	\$45,900.00	2077	\$31,155.00	983	\$14,745.00	0	\$0.00
25	2531.503	CONCRETE CURB & GUTTER DESIGN B618	LF	\$30.00	845.00	\$25,350.00	465	\$13,950.00	380	\$11,400.00	0	\$0.00
26	2531.503	CONCRETE CURB & GUTTER DESIGN D412	LF	\$27.50	1,264.00	\$34,760.00	1264	\$34,760.00	0	\$0.00	0	\$0.00
27	2531.618	TRUNCATED DOMES	SF	\$60.00	424.00	\$25,440.00	288	\$17,280.00	136	\$8,160.00	0	\$0.00
28	2563.601	TRAFFIC CONTROL	LS	\$30,000.00	1.00	\$30,000.00	0.67	\$20,100.00	0.31	\$9,300.00	0.02	\$600.00
29	2564.502	INSTALL SIGN PANEL TYPE C	EACH	\$250.00	99.00	\$24,750.00	68	\$17,000.00	31	\$7,750.00	0	\$0.00
30	2564.518	SIGN PANELS TYPE C	SF	\$75.00	205.00	\$15,375.00	205	\$15,375.00	0	\$0.00	0	\$0.00
31	2564.602	INSTALL SIGN TYPE SPECIAL (STREET NAME SIGN)	EACH	\$250.00	20.00	\$5,000.00	12	\$3,000.00	8	\$2,000.00	0	\$0.00
32	2565.616	REVISE SIGNAL SYSTEM A	SYS	\$145,000.00	1.00	\$145,000.00	0	\$0.00	1	\$145,000.00	0	\$0.00
33	2565.616	REVISE SIGNAL SYSTEM B	SYS	\$74,000.00	1.00	\$74,000.00	1	\$74,000.00	0	\$0.00	0	\$0.00
34	2565.616	REVISE FLASHER SYSTEM	SYS	\$5,000.00	1.00	\$5,000.00	1	\$5,000.00	0	\$0.00	0	\$0.00
35	2573.502	STORM DRAIN INLET PROTECTION	EACH	\$250.00	84.00	\$21,000.00	55	\$13,750.00	29	\$7,250.00	0	\$0.00
36	2574.507	ORGANIC TOPSOIL BORROW (LV)	CY	\$50.00	222.00	\$11,100.00	185	\$9,250.00	10	\$500.00	27	\$1,350.00
37	2575.508	TURF ESTABLISHMENT	LS	\$7,500.00	1.00	\$7,500.00	0.67	\$5,025.00	0.31	\$2,325.00	0.02	\$150.00
38	2575.523	WATER	MGAL	\$50.00	75.00	\$3,750.00	50	\$2,500.00	10	\$500.00	15	\$750.00
39	2582.503	4" SOLID LINE MULTI COMP	LF	\$1.50	10,012.00	\$15,018.00	10012	\$15,018.00	0	\$0.00	0	\$0.00
40	2582.503	4" DOUBLE SOLID MULTI COMP	LF	\$2.00	3,730.00	\$7,460.00	3280	\$6,560.00	450	\$900.00	0	\$0.00
41	2582.503	4" BROKEN LINE MULTI COMP	LF	\$1.50	1,646.00	\$2,469.00	1646	\$2,469.00	0	\$0.00	0	\$0.00
42	2582.503	6" SOLID LINE MULTI COMP	LF	\$1.75	15,307.00	\$26,787.25	14997	\$26,244.75	310	\$542.50	0	\$0.00
43	2582.503	6" BROKEN LINE MULTI COMP	LF	\$2.25	1,112.00	\$2,502.00	782	\$1,759.50	330	\$742.50	0	\$0.00
44	2582.503	12" SOLID LINE MULTI COMP	LF	\$10.00	601.00	\$6,010.00	553	\$5,530.00	48	\$480.00	0	\$0.00
45	2582.518	CROSSWALK PREF THERMO GR IN	SF	\$15.00	612.00	\$9,180.00	612	\$9,180.00	0	\$0.00	0	\$0.00
TOTAL ESTIMATED PROJECT COST						\$1,646,427.50		\$1,104,872.00		\$502,325.50		\$39,230.00
10% CONTIGIENCIES						\$164,642.75		\$110,487.20				
TOTAL ESTIMATED CONSTRUCTION COST						\$1,811,070.25		\$1,215,359.20				
27% INDIRECT COSTS						\$488,988.97		\$328,146.98				
TOTAL PROJECT COST						\$2,135,416.47		\$1,433,018.98				