

**ACTION TRANSMITTAL – 2020-40**

**DATE:** November 25, 2020

**TO:** Technical Advisory Committee

**PREPARED BY:** Joe Barbeau, Senior Planner (651-414-0875)

**SUBJECT:** 2021-2024 Streamlined TIP Amendment for MnDOT: MN 316 Reconstruction

**REQUESTED ACTION:** MnDOT requests an amendment to the 2021-2024 TIP to reduce the length, increase the cost, and change the scope of its mill-and-overlay project on Minnesota Highway 316 (Red Wing Blvd) in Dakota County (SP# 1926-22).

**RECOMMENDED MOTION:** That the Technical Advisory Committee recommend that the Transportation Advisory Board recommend adoption of an amendment to the 2021-2024 TIP to reduce the length, increase the cost, and change the scope of MnDOT’s mill-and-overlay project on Minnesota Highway 316 (Red Wing Blvd) in Dakota County (SP# 1926-22).

**BACKGROUND AND PURPOSE OF ACTION:** This amendment is needed to change the project’s scope from a mill-and-overlay to a reconstruction, reduce the project length from 9.65 miles to 1.1 miles, and increase the total project cost.

The project is funded through the National Highway Performance Program (NHPP) and the cost increase is being paid for by GO bonds from the recent bonding bill. Neither of these funds are programmed by TAB.

**RELATIONSHIP TO REGIONAL POLICY:** Federal law requires that all transportation projects that will be funded with federal funds must be in an approved TIP and meet the following four tests: fiscal constraint; consistency with the adopted regional transportation plan; air quality conformity; and opportunity for public input. It is the TAB’s responsibility to recommend TIP amendments to the Council for adoption. The streamlined TIP amendment process allows projects that meet certain conditions to be streamlined, which entails forgoing TAC Funding & Programming Committee Review and results in saving a month of Process time.

**STAFF ANALYSIS:** The TIP amendment meets fiscal constraint because the federal and state funds are sufficient to fully fund the project. The amendment is consistent with the Transportation Policy Plan, adopted by the Metropolitan Council on October 24, 2018, as amended on April 24, 2019, with FHWA/FTA conformity determination established on May 9, 2019. Public input opportunity for this amendment is provided through the TAB’s and Council’s regular meetings. The Minnesota Interagency Air Quality and Transportation Planning Committee determined that the project is exempt from air quality conformity analysis.

---

**ROUTING**

<b>TO</b>	<b>ACTION REQUESTED</b>	<b>DATE SCHEDULED / COMPLETED</b>
Technical Advisory Committee	Review & Recommend	12/2/2020
Transportation Advisory Board	Review & Recommend	12/16/2020
Metropolitan Council Transportation Committee	Review & Recommend	1/11/2020
Metropolitan Council	Review & Adopt	1/13/2021

Please amend the 2021-2024 Transportation Improvement Program (TIP) to amend this project. This action is being submitted with the following information:

**PROJECT IDENTIFICATION:**

State Fiscal Year	ATP/ Dist	Route System	Project Number (S.P. #)	Agency	Description include location, description of all work, & city (if applicable)	Miles
2021	M	MN 316	1926-22	MnDOT	<del>**CHAP3**SEC164**LPP**</del> MN316, from S Jct US61 in Goodhue County <del>625'</del> south of Tuttle Dr to Jct N US61 in Dakota County – Reconstruction, <del>MILL AND OVERLAY</del> , roundabouts, pond construction, ADA updates, lighting, signing and trail installation (Associate to 1926-22L, 1926-22S)	<del>9.65</del> <u>1.10</u>

Prog	Type of Work	Prop Funds	21-24 Total \$	FHWA \$	GO Bonds \$	TH \$	Other \$
RC	Reconstruct	NHPP, GO Bonds	<del>3,399,000</del> <u>4,899,000</u>	4,420,000	<u>1,500,000</u>	655,000	834,000

Note: The overall project is shown as three project lines in the TIP, to reflect three federal funding sources/mechanisms. The total project cost increases from \$5,909,000 to \$7,409,000, with the entire increase reflected in the GO bonds. 1926-22L is part of the Local Partnership Program, while 1926-22S is funded through the Highway Safety Improvement Program (HSIP)

**PROJECT BACKGROUND:**

- Briefly describe why amendment is needed (e.g., project in previous TIP but not completed; illustrative project and funds now available; discretionary funds received; inadvertently not included in TIP).

This formal amendment is needed to revise the project scope (changed to reconstruction from mill and overlay), update the termini (reduced to 1.1 miles from 9.65 miles) and correct the total project cost (increased by \$1,500,000).

- How is Fiscal Constraint Maintained as required by 23 CFR 450.216 (check all that apply)?
  - New Money X
  - Anticipated Advance Construction
  - ATP or MPO or MnDOT Adjustment by deferral of other projects
  - Earmark or HPP not affecting fiscal constraint
  - Other

This project received GO bonds from the Bonding Bill in the amount of \$1.5M. No additional federal funds are needed. Therefore, fiscal constraint is maintained.

**CONSISTENCY WITH MPO LONG RANGE PLAN:**

This amendment is consistent with the Metropolitan Council Transportation Policy Plan, adopted by the Metropolitan Council on October 24, 2018, as amended on April 24, 2019 with FHWA/FTA conformity determination established on May 9, 2019.

**AIR QUALITY CONFORMITY:**

- Subject to conformity determination
- Exempt from regional level analysis X\*
- N/A (not in a nonattainment or maintenance area)

\*Exempt Project Category S-10. Pavement Resurfacing/Rehabilitation per Section 93.126 of the Conformity Rules.

# MINNESOTA DEPARTMENT OF TRANSPORTATION

## CONSTRUCTION PLAN FOR GRADING, BITUMINOUS & CONCRETE PAVING, ROUNDABOUTS, ADA IMPROVEMENTS, AND LIGHTING

LOCATED ON TH 316 FROM 625' SOUTH OF TUTTLE DR. TO TH 61

STATE PROJ. NO. 1926-22 (T.H. 316)	STATE AID PROJ. NO. 130-010-013
GROSS LENGTH..... 5813.28 FEET 1.101 MILES	GROSS LENGTH..... 5813.28 FEET 1.101 MILES
BRIDGES-LENGTH..... FEET..... MILES	BRIDGES-LENGTH..... FEET..... MILES
EXCEPTIONS-LENGTH..... FEET..... MILES	EXCEPTIONS-LENGTH..... FEET..... MILES
NET LENGTH..... 5813.28 FEET 1.101 MILES	NET LENGTH..... 5813.28 FEET 1.101 MILES
REF. POINT 8+00.704 TO REF. POINT 9+00.803	REF. POINT 8+00.704 TO REF. POINT 9+00.803

NOTE: LENGTH AND DESCRIPTION  
BASED ON 316 NB ALIGNMENTS.

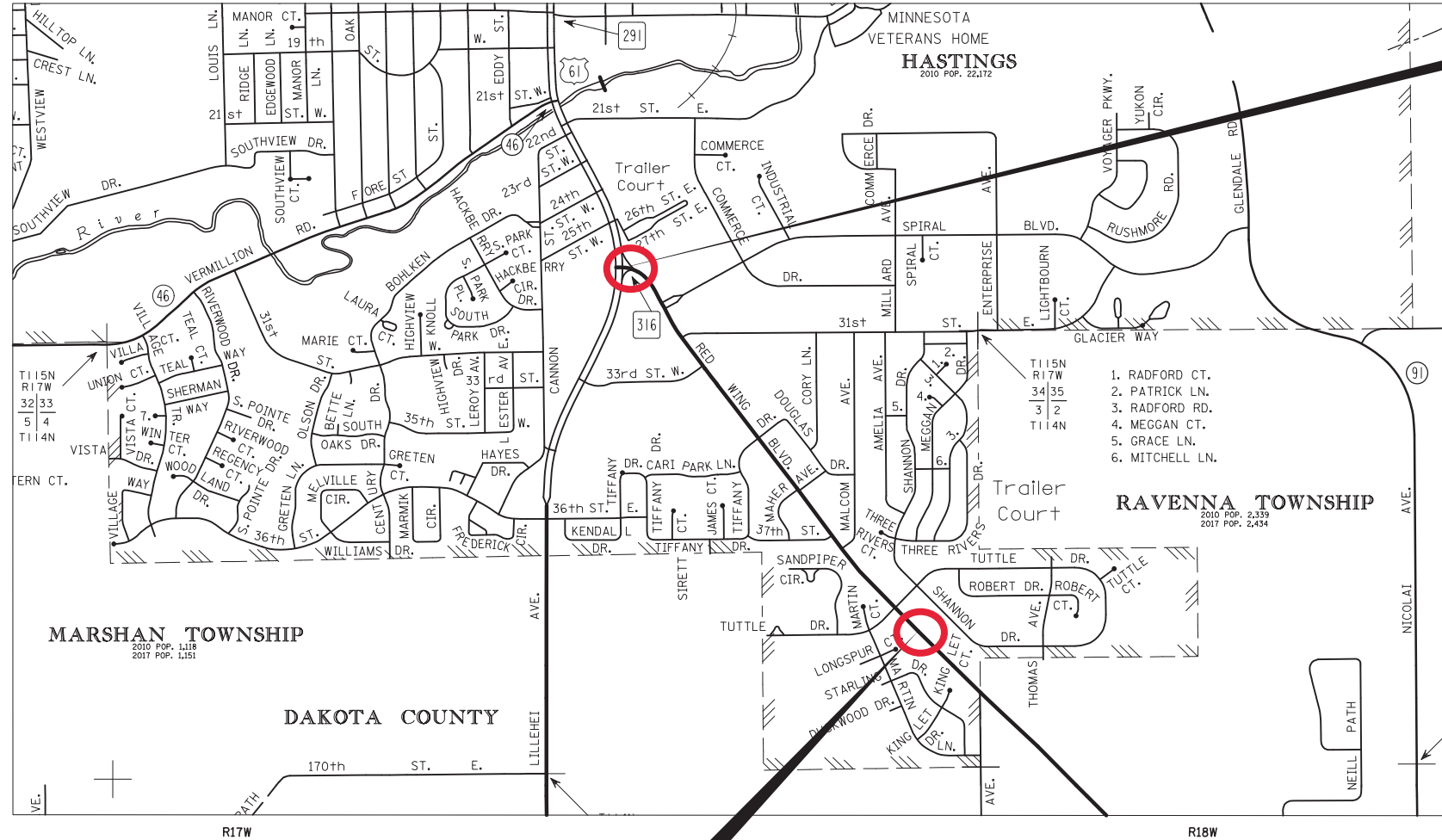

316NB4 STA 70+74.55  
END S.P. 1926-22 TH 316  
END S.A.P. 130-010-013

BEGIN S.P. 1926-22 TH 316  
BEGIN S.A.P. 130-010-013  
316NB1 STA 10+00.00

AGREEMENT NO. XXXXXX  
CITY OF HASTINGS  
SP 1926-22 (TH 316=316)  
XXXXX FUNDS  
METRO DISTRICT

**WARNING:**  
HIGH PRESSURE PIPELINE(S)  
EXCAVATION AND/OR CONSTRUCTION PROHIBITED  
WITHOUT COMPLIANCE WITH GOPHER STATE ONE- CALL

### SCALES

PLAN	50'
INDEX MAP	2000'
GENERAL LAYOUT	400'
HORIZONTAL	
PROFILES	100'
VERTICAL	
GUTTERLINE PROFILES	20'
VERTICAL	
	1'

### DESIGN DESIGNATION

Design ESALS 20\_YR = 2,934,000

ADT (Current Year) 2019 = 14900	Design Speed . 35 MPH
ADT (Future Year) 2040 = 24300	Based on STOPPING Sight Distance
DHV (Design Hr. Vol.) =	Height of eye 3.5', Height of object 2.0'
D (Directional Distr.) =	Design Speed not achieved at:
T (Heavy Commercial) =	% STA. TO STA. MPH
	STA. TO STA. MPH

PROJECT LOCATION  
COUNTY : DAKOTA  
DISTRICT : METRO

FED. PROJ. NO. NHPP-HSIP

### GOVERNING SPECIFICATIONS

THE 2018 EDITION OF THE MINNESOTA DEPARTMENT OF TRANSPORTATION  
'STANDARD SPECIFICATIONS FOR CONSTRUCTION' SHALL GOVERN.

### INDEX

SHEET NO.	DESCRIPTION
1	TITLE SHEET
2	GENERAL LAYOUT
3 - 6	STATEMENT OF ESTIMATED QUANTITIES
7	SOILS & CONSTRUCTION NOTES AND STANDARD PLATES
8 - 10	EARTHWORK SUMMARY AND TABULATIONS
11 - 25	TABULATIONS
26 - 30	INPLACE UTILITY TABULATION
31 - 36	TYPICAL SECTIONS
37 - 64	STANDARD PLAN SHEETS
65 - 72	ALIGNMENT PLAN
73 - 82	ALIGNMENT TABULATION
83 - 91	INPLACE TOPOGRAPHY AND UTILITY PLAN
92 - 100	REMOVAL PLAN
101 - 102	TEMPORARY CONSTRUCTION PLAN
103 - 111	CONSTRUCTION PLAN
112 - 113	MISCELLANEOUS DETAILS
114 - 132	PROFILES
133 - 144	INTERSECTION DETAILS
145 - 153	PAVING PLAN
154 - 162	DRAINAGE PLAN
163 - 188	DRAINAGE PROFILES AND TABULATIONS
189 - 192	DRAINAGE DETAILS
193 - 194	DRAINAGE SUMMARY
195 - 197	STORM WATER POLLUTION PREVENTION PLAN
198 - 206	EROSION CONTROL AND TURF ESTABLISHMENT PLAN
UT1 - UT9	CITY UTILITY PLAN AND PROFILE
TC1 - TC28	TRAFFIC CONTROL PLAN
PM1 - PM7	PERMANENT PAVEMENT MARKING PLAN
ST1 - ST53	SIGNING PLAN
SL1 - SL5	LIGHTING PLAN
XL1 - XL9	CROSS SECTION MATCHLINE LAYOUT
X1 - X62	CROSS SECTIONS

THIS PLAN CONTAINS 379 SHEETS

I HEREBY CERTIFY THAT THIS PLAN WAS PREPARED BY ME OR UNDER MY DIRECT  
SUPERVISION AND THAT I AM A DULY LICENSED PROFESSIONAL ENGINEER UNDER THE  
LAWS OF THE STATE OF MINNESOTA.

PRINT NAME: JOHN CHOCK LICENSE # 55985

DATE: SIGNATURE:

DESIGN SQUAD M. CHRISTENSEN, L. DANDL, M. SELL, B. GEURKINK

DISTRICT STATE AID ENGINEER; REVIEWED FOR COMPLIANCE WITH STATE AID RULES/POLICY 20

APPROVED FOR STATE AID FUNDING; STATE AID ENGINEER 20

APPROVED 20 CITY OF HASTINGS ENGINEER

OFFICE OF LAND MANAGEMENT APPROVAL DIRECTOR, LAND MANAGEMENT 20

APPROVED 20 STATE DESIGN ENGINEER

I HEREBY CERTIFY THAT THE FINAL FIELD REVISIONS, IF ANY, WERE PREPARED BY ME  
OR UNDER MY DIRECT SUPERVISION AND THAT I AM A DULY LICENSED PROFESSIONAL  
ENGINEER UNDER THE LAWS OF THE STATE OF MINNESOTA.

PRINT NAME: LICENSE #

DATE: SIGNATURE:

FOR PLANS AND UTILITIES SYMBOLS SEE TECHNICAL MANUAL  
STATE PROJ. NO. CHARGE IDENTIFIER  
1926-22

STATE AID PROJ. NO. 130-010-013  
STATE PROJ. NO. 1926-22 (T.H. 316 = 316) SHEET NO. 1 OF 206 SHEETS

PLOTTED/REVISED: 27-OCT-2020

DISTRICT #: Metro  
PLOT NAME: d192622.tshdgn  
PATH & FILENAME: Projects\DM ROS\316\1926\022\Design\Plan\Sheets\Title Sheet\192622.tshdgn