



Improving mobility

Easing congestion

Strengthening our communities

Central Corridor **Light Rail Transit**



Transportation Committee Non-Consent Item 2013-107

April 8, 2013

Background

- Metro Park East requesting release of Met Council easements for construction of Fountain Residential
- Property located at 4th Street and 27th Avenue, Minneapolis
- Property is immediately adjacent to LRT guideway



Location



Existing Building



Rendering of Fountain Residential

4TH STREET SE
Minneapolis, MN



Aerial Perspective

08/20/2012

380 Merrimack Street Building 5 / Floor 3 Lawrence, MA
978.989.9900 www.cube3studio.com

CUBE3
STUDIO
architecture interiors planning

FOUNTAIN RESIDENTIAL
PARTNERS

Central Corridor Light Rail Transit

METROPOLITAN
COUNCIL

Rendering of Fountain Residential



Perspective looking West along North Elevation

08/20/2012

360 Merrimack Street Building 5 / Floor 3 Lawrence, MA
978.989.9900 www.cube3studio.com



Easements

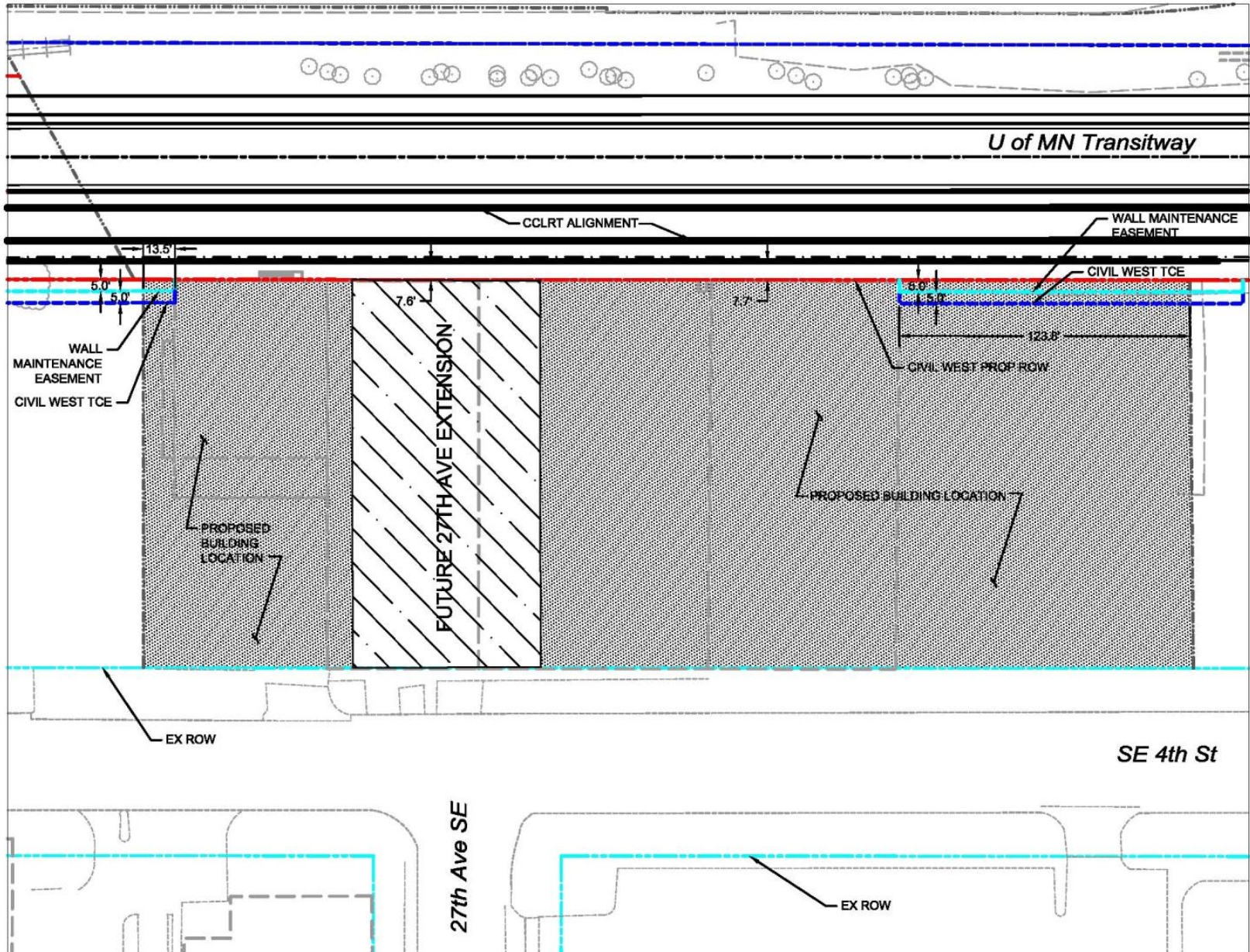

Recommendation

- Authorize Regional Administrator to execute an agreement with Metro Park East Property Owner, LLC for release of Metropolitan Council easements on areas adjacent to the Green Line.



More Information

website: www.centralcorridor.org

Contact the Central Corridor Project Office:

- 540 Fairview Avenue North
St. Paul, MN 55104
- Construction Hotline: 651-602-1404
- Comment Line: 651-602-1645
- Email: centralcorridor@metc.state.mn.us

