



Transportation Committee

July 24, 2017



Advanced Utility Work: Bassett Creek Storm Sewer Relocation



Bassett Creek Storm Water Overview

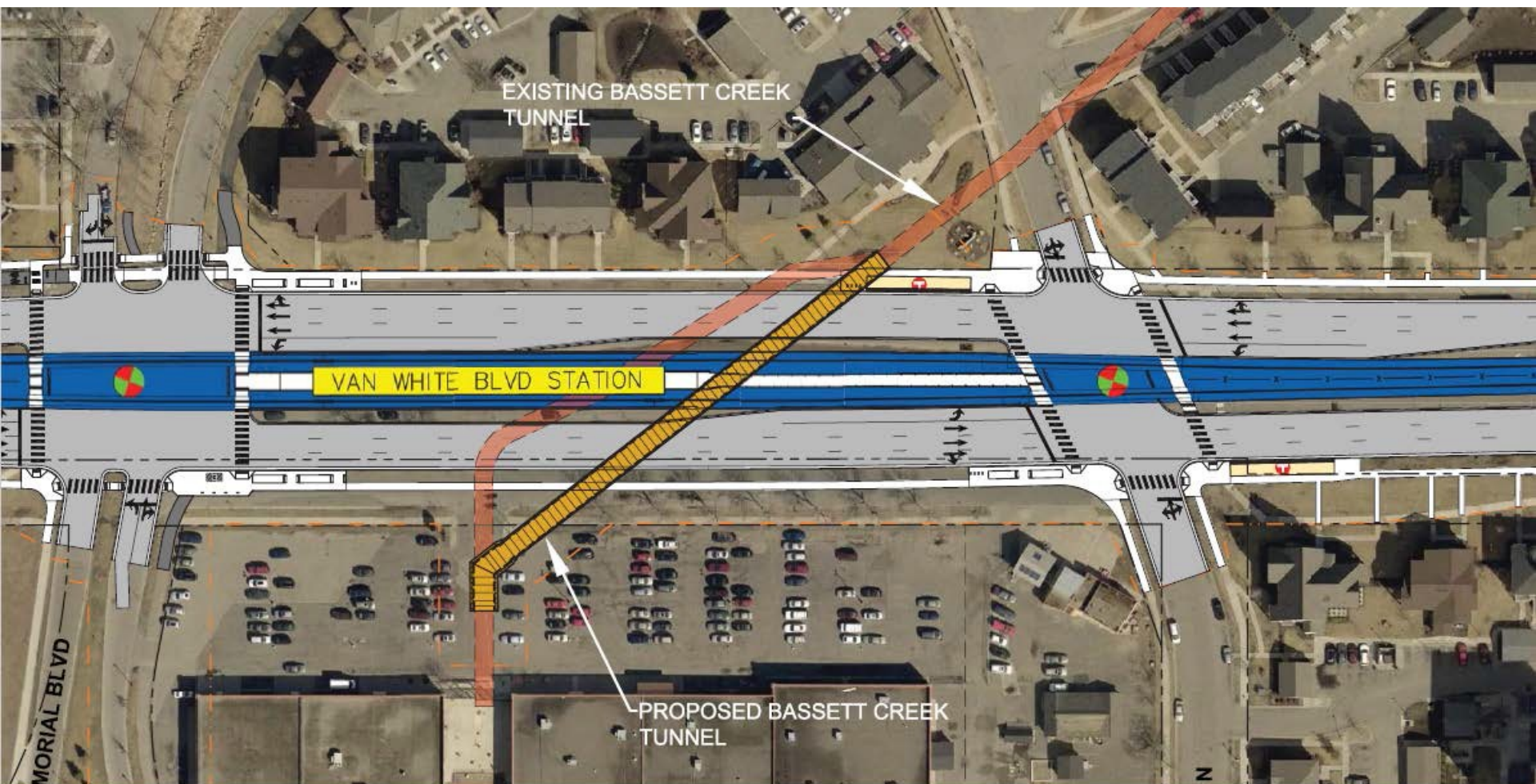

Bassett Creek Storm Sewer Relocation: Funding

- Total project costs: \$4.4M
 - MnDOT: \$3.25M
 - CTIB: \$690K
 - HCRRA: \$460K



Bassett Creek Storm Sewer Material Procurement

- Bids issued: June 13, 2017
- Bids opened: July 13, 2017
 - Council received one bid from Max Steinger, Inc.
 - Council's Procurement Department determined the solicitation was adequate and the bid was responsive and responsible
- Project finds bid fair and reasonable



Recommendation

- Authorize Regional Administrator to award and execute a contract with Max Steinger, Inc. in the amount of \$550,000 for the Bassett Creek Tunnel Box Culvert



More Information

The screenshot shows the Metropolitan Council website with a navigation menu at the top: About Us | News & Events | Data & Maps | Publications | Doing Business | Council Meetings | Contact Us | Employment. Below the navigation is the Metropolitan Council logo and a menu with categories: COMMUNITIES, PARKS, TRANSPORTATION (highlighted), WASTEWATER & WATER, HOUSING, and PLANNING. The main content area features a photograph of a blue and yellow METRO bus at a station with passengers. Below the photo is a sidebar with a dropdown menu for 'METRO BLUE LINE EXTENSION' and links for Route, Stations, Environmental, Timeline, and Project Partners. The main text area is titled 'METRO BLUE LINE EXTENSION' and 'Bottineau Transitway – Minneapolis & Northwestern Communities'. It contains a paragraph describing the LRT route from downtown Minneapolis through north Minneapolis, Golden Valley, Robbinsdale, Crystal, and Brooklyn Park. Below the text are sections for 'Latest News' (Feds: Met Council can begin designing METRO Blue Line Extension) and 'Route' (Click on the map below for more information).

Website: BlueLineExt.org

Email: BlueLineExt@metrotransit.org

Twitter: [@BlueLineExt](https://twitter.com/BlueLineExt)

