



# Transportation Committee

August 13, 2018



# Major Milestones Completed

FTA Grants Entry to Project Development	Aug 22, 2014
Record of Decision	Sept 19, 2016
FTA Scope, Schedule and Budget Workshop	Nov 16/17, 2016
FTA Grants Entry to Engineering	Jan 19, 2017
Complete 60% Civil & OMF Design	March 3, 2017
Complete 60% Systems Design	May 10, 2017
Begin Advanced Utility Work	October 30, 2017
Complete 90% Civil Design	November 17, 2017
Complete 90% OMF & Systems Design	December 15, 2017



# Look Ahead - Major Milestones

- Complete Critical 3<sup>rd</sup> Party Agreements
- FTA Financial Capacity Assessment
- FTA Risk Assessment
- Complete 100% Civil Design
- Submit Advanced Construction LONP request to FTA
- Application for Full Funding Grant Agreement



# **Bassett Creek Storm Sewer Construction Request for Additional Change Order Authority**



# Bassett Creek Storm Sewer Overview

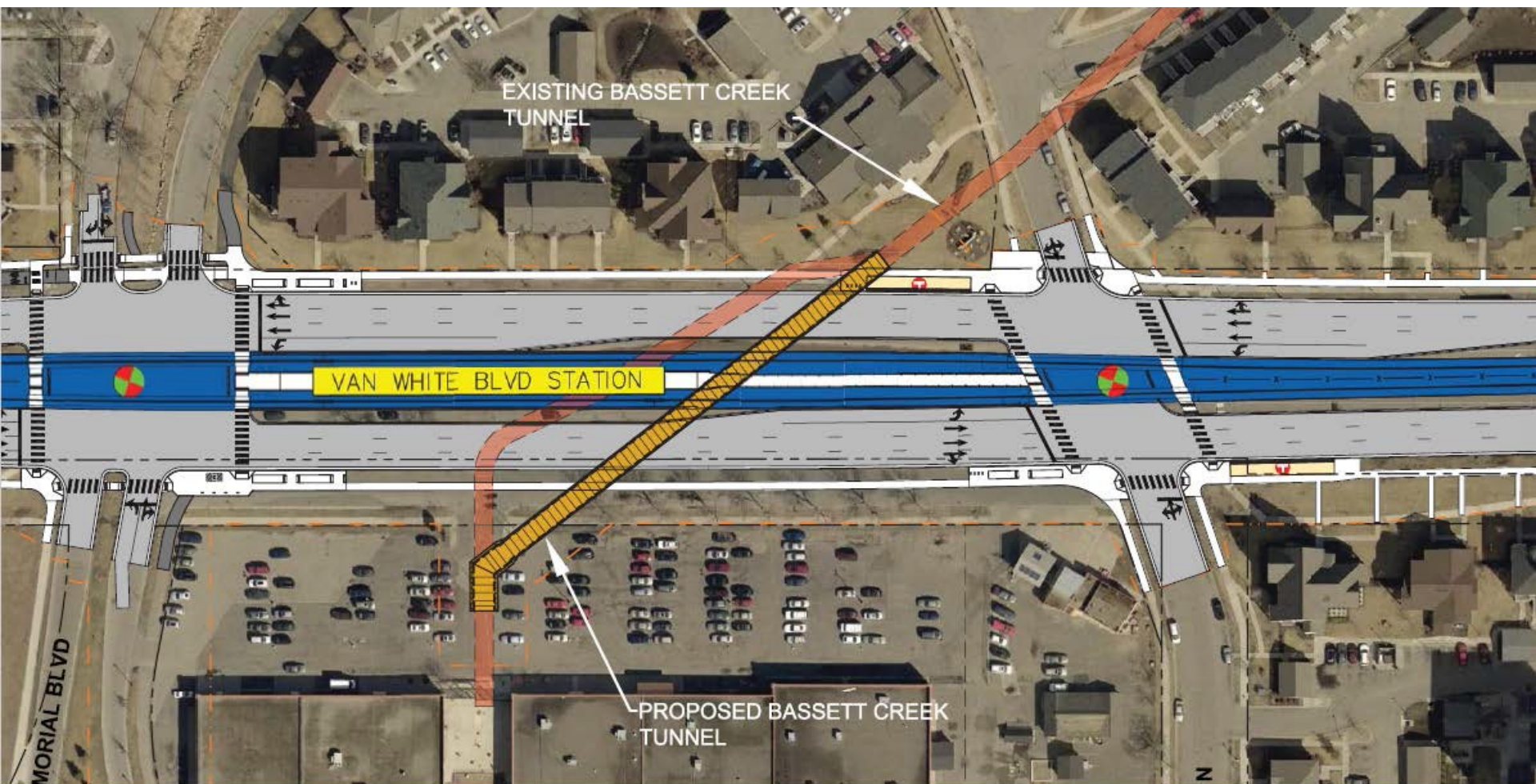

# Installed Pipe Sections



# New Tunnel (Lt) / Old Tunnel (Rt)



# Pouring Slab for closure





# Restoring Parking Lot



# Bassett Creek Storm Sewer Construction Change Order Authority

- 10% Change Order Authority currently
  - \$242,157 authorized in change order authority
  - Over 8% used on contaminated materials
- 2% Additional Change Order Authority requested
  - \$48,431 additional change order authority requested
  - Required to complete project
  - Utility work change orders need to be finalized
    - Watermain reconnection
    - Manhole fitting modifications
- 12% Total Change Order Authority
  - \$290,588 total change order authority
  - Funding available in BLRT project budget



# Recommendation

- That the Metropolitan Council authorize an additional 2% (\$48,431) above the currently authorized construction contract change order authority of 10% (\$242,157) to a revised change order authority of \$290,588 for the Bassett Creek Tunnel Realignment (Bassett Creek) construction contract.



# More Information

About Us | News & Events | Data & Maps | Publications | Doing Business | Council Meetings | Contact Us | Employment

METROPOLITAN  
D E U W O L L

COMMUNITIES | PARKS | **TRANSPORTATION** | WASTEWATER & WATER | HOUSING | PLANNING

## METRO BLUE LINE EXTENSION

**METRO BLUE LINE EXTENSION**

- Route
- Stations
- Environmental
- Timeline
- Project Partners

### METRO BLUE LINE EXTENSION

#### Bottineau Transitway – Minneapolis & Northwestern Communities

The METRO Blue Line Extension (LRT) will operate northwest from downtown Minneapolis through north Minneapolis, Golden Valley, Robbinsdale, Crystal and Brooklyn Park, drawing riders northwest of Brooklyn Park. The proposed alignment is primarily at-grade and will have up to 11 new stations in addition to Target Field Station and about 13 miles of double track. The line will interline with the METRO Blue Line and connect Minneapolis and the region's northwest suburbs with existing LRT on the METRO Green Line, future LRT on the METRO Green Line Extension, bus rapid transit on the METRO Red Line, the Northstar commuter rail line and local and express bus routes.

**Latest News**  
Feds: Met Council can begin designing METRO Blue Line Extension

**Route**  
Click on the map below for more information

Website: [BlueLineExt.org](http://BlueLineExt.org)

Email: [BlueLineExt@metrotransit.org](mailto:BlueLineExt@metrotransit.org)

Twitter: [@BlueLineExt](https://twitter.com/BlueLineExt)

