

Transportation Committee

Meeting date: January 28, 2019

For the Metropolitan Council meeting of February 13, 2019

Subject: Controlled Access Approval: US 212 at County Road 44, Carver County

District(s), Member(s): Districts 4, Deb Barber

Policy/Legal Reference: Mn. Statute 473.166

Staff Prepared/Presented: Nick Thompson, Director, MTS, 651-602-1754

Amy Vennewitz, Deputy Director, Finance and Planning, MTS, 651-602-1508

Steve Peterson, Manager of Highway Planning and TAB/TAC Process, MTS, 651-602-1819

Tony Fischer, Planning Analyst, MTS, 651-602-1703

Division/Department: Metropolitan Transportation Services (Review #22148-1)

Proposed Action

That the Metropolitan Council approve a request by the City of Chaska, Carver County and the Minnesota Department of Transportation to add ramps to and from the north at an existing overpass to create a partial interchange on US 212 at County Road 44, subject to further review and approval by the Metropolitan Council if there are any significant changes in the design of the proposed project.

Background

Minnesota state law (MS. 473.166) requires that the Council approve any controlled access highway in the metropolitan area before construction or right-of-way acquisition begins. This is to ensure that proposed highway projects are consistent with regional policies and plans.

US 212 and County Road (CR) 44 currently cross with a grade separated overpass with no ramp connections between them. US 212 is generally an east-west roadway however at this location its alignment is north-south. The existing access to US 212 is inadequate to serve forecast travel demand, contributing to congestion and poor operations at the CR 10 (Engler Boulevard) interchange approximately one mile to the north.

The proposed project will construct ramp connections of CR 44 to and from the north along US 212. The existing bridge will remain in place. A new multi-use trail bridge will be constructed on the north side of the existing CR 44 bridge over US 212. The project proposes construction of roundabouts at the interchange ramp intersections and reconstruction of CR 44 from US 212 to east of Founders Way as a two-lane, divided roadway. Additional project elements include drainage improvements, stormwater basins, multi-use trails and sidewalks.

The proposed project will improve access to US 212 and accommodate planned growth and development of approximately 1,800 acres in southwest Chaska.

A state Environmental Assessment Worksheet was prepared for the project. This was approved by the Minnesota Department of Transportation (MnDOT) on August 3, 2018. The Findings of Fact and Conclusion and negative declaration order, concluding the state environmental review process, was approved by MnDOT on October 24, 2018. MnDOT determined that this project does not have the potential to result in significant environmental impacts, that the project does not require the preparation of an Environmental Impact Statement and has issued a Negative Declaration Order for the project.

This project is part of the region's ongoing efforts to improve mobility on the regions highways in order to support economic development and quality of life.

Rationale and Consistency with Regional Policy

This project is anticipated to be amended into the region's 2019-2022 Transportation Improvement Program as part of the Metropolitan Council's consent agenda on January 23, 2019. It is consistent with regional policy as it advances the Transportation Policy Plan's goal of Leveraging Transportation Investments to Guide Land Use and Access to Destinations. It also supports the Thrive MSP 2040 outcomes of Prosperity and Livability.

Funding

This project is estimated to cost \$19.4 million and is funded through the \$10.5 million that the 2017 Minnesota Legislature appropriated to this project through the Local Road Improvement Program and \$8.9 million of local funds.

Known Support / Opposition

Project partners include the City of Chaska, Carver County and MnDOT. There is no known opposition to this project.

Figure 1: Context of Project Area

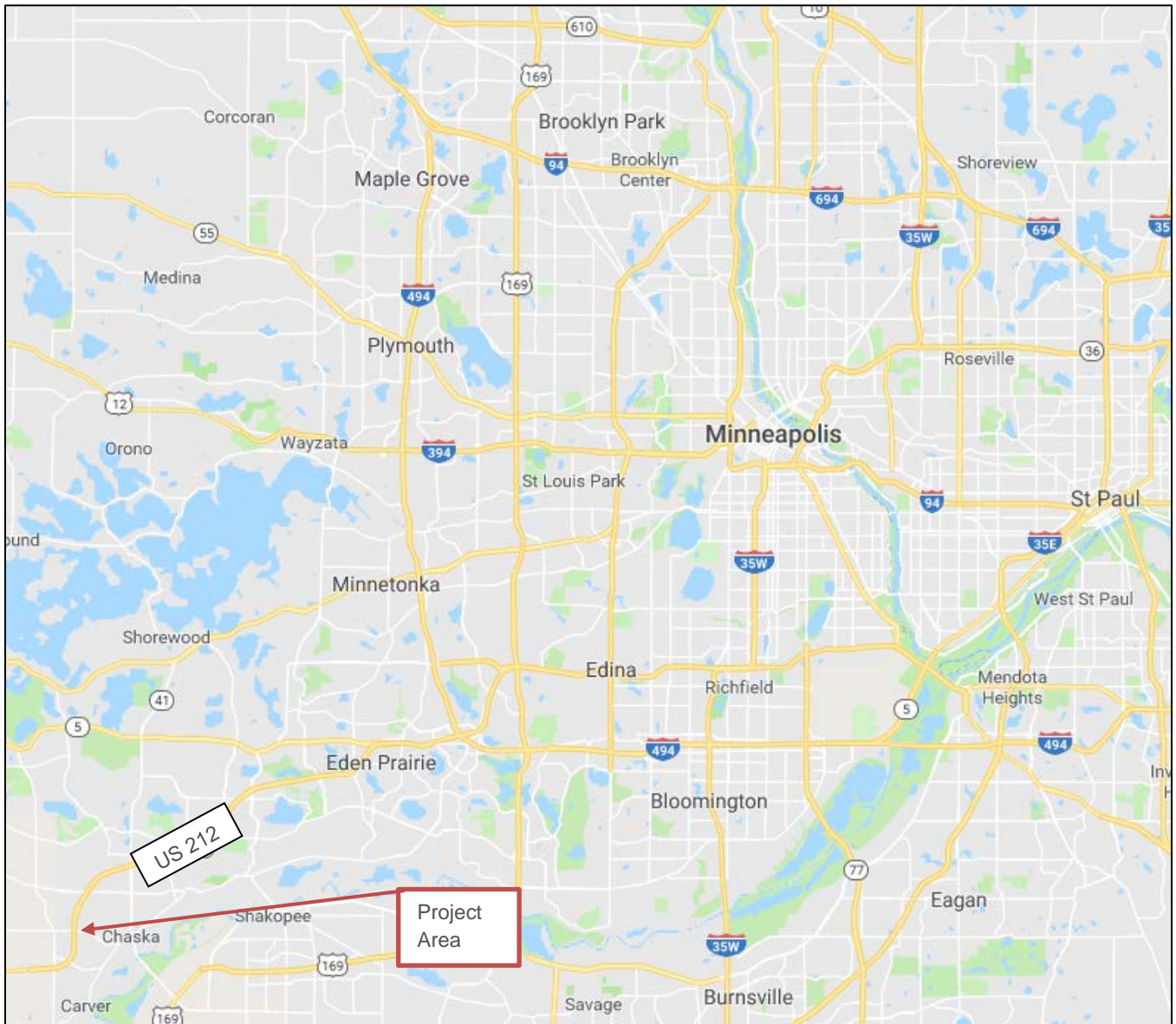

Source: Google Maps

Figure 2: Detailed Project Area and Local Context

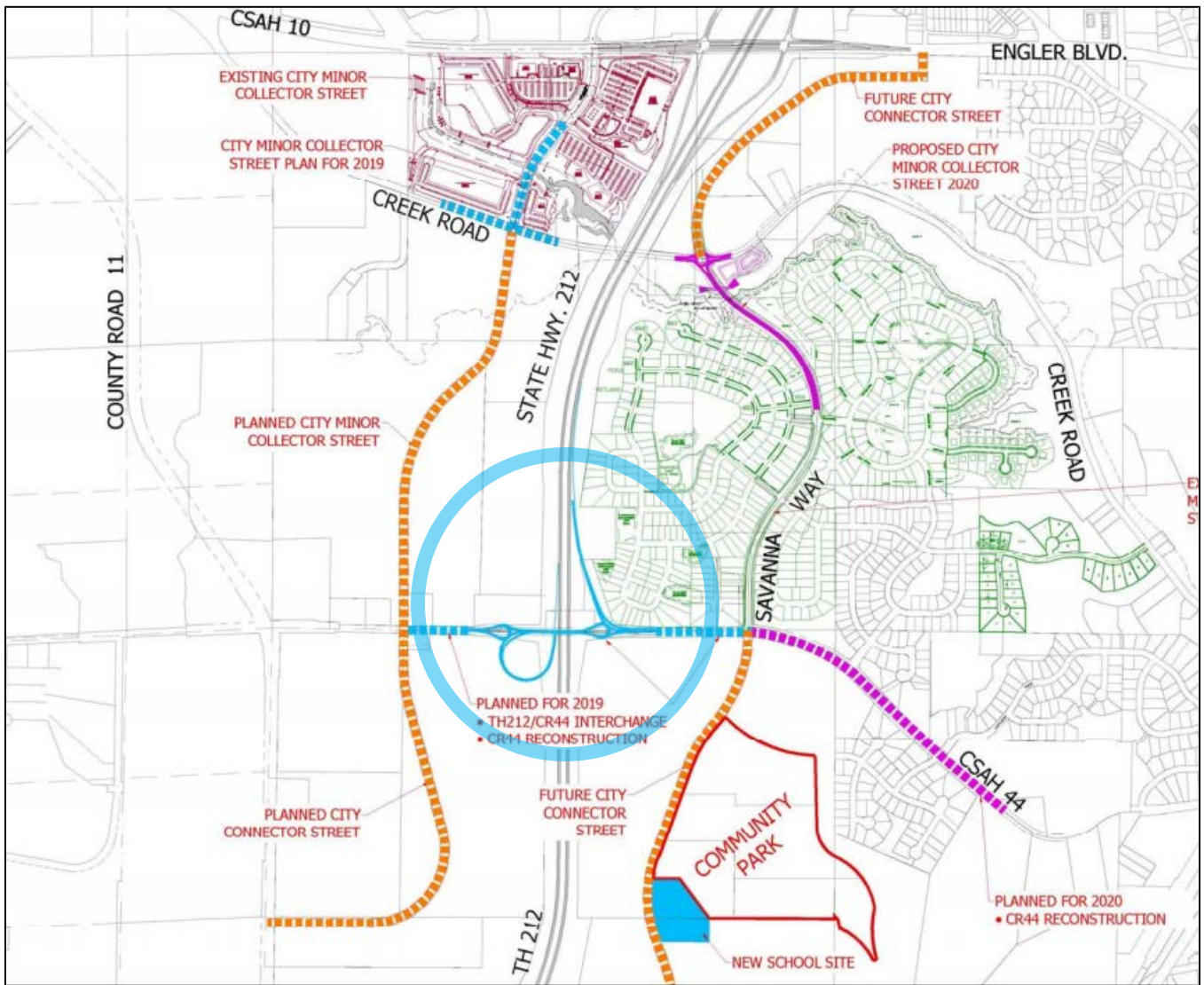

Source: www.hwy212interchange.com