



# METRO Gold Line BRT Project Update

Christine Beckwith, Gold Line Project Manager

Transportation Committee

September 23, 2019





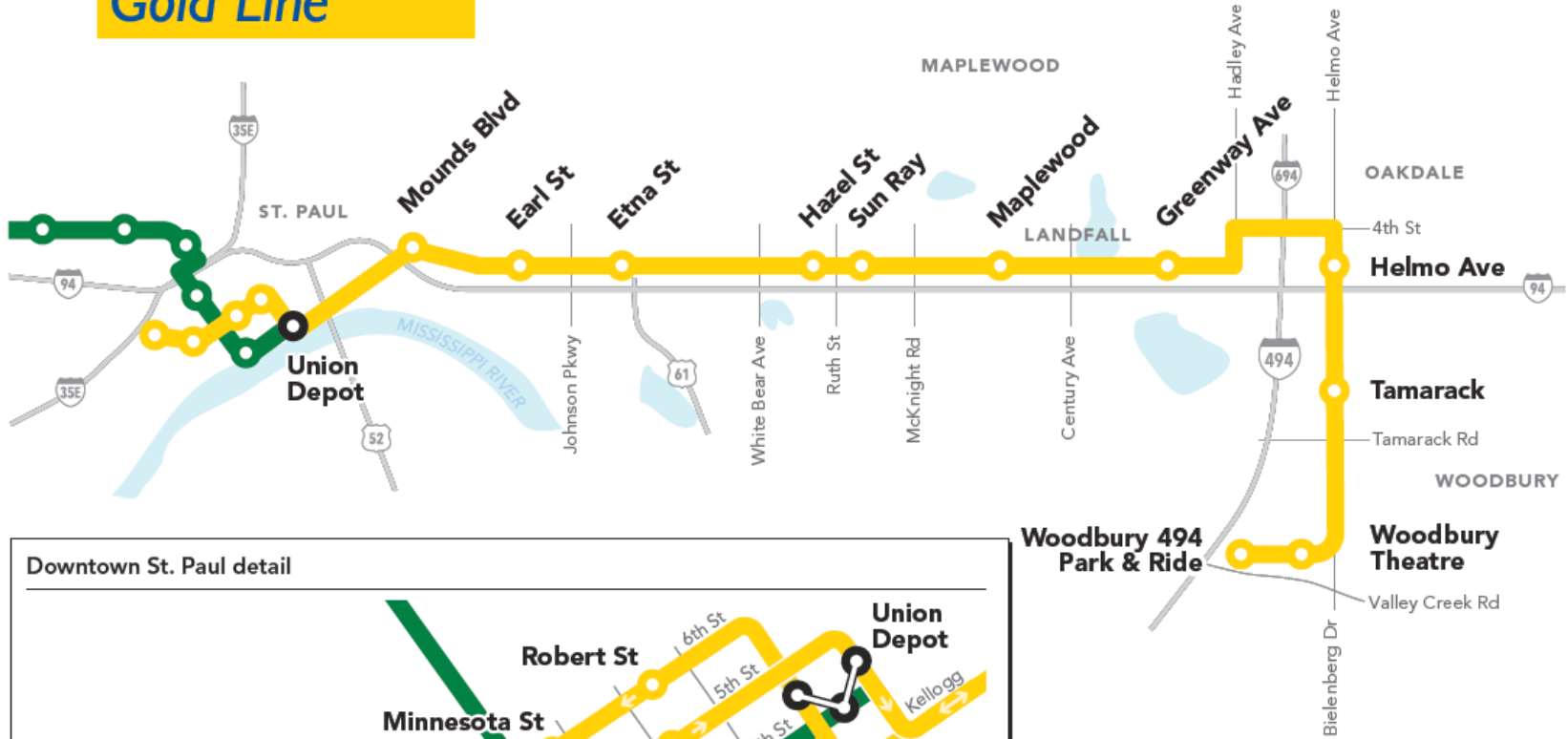

# Gold Line

# Gold Line Project Map



Downtown St. Paul detail



-  METRO Gold Line (Bus Rapid Transit)
-  METRO Green Line (Light Rail)
-  Transfer Station

# Types of Dedicated Guideway (BRT-only lanes)

## Mixed Traffic

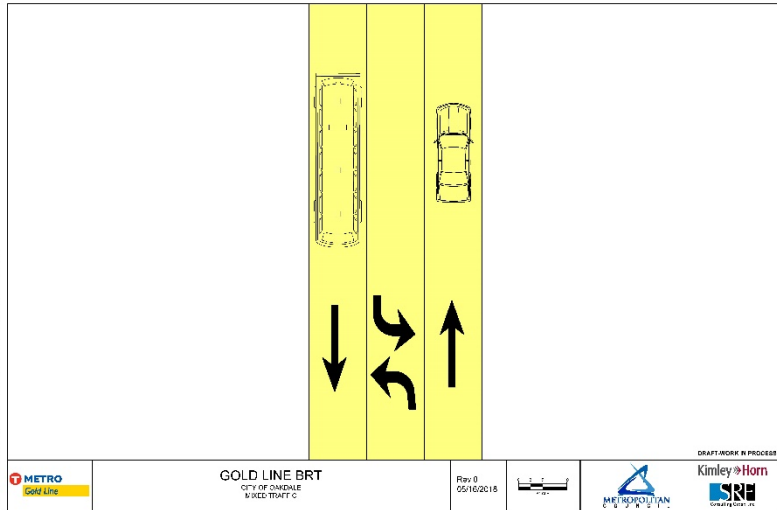

## Dedicated Curbside Running

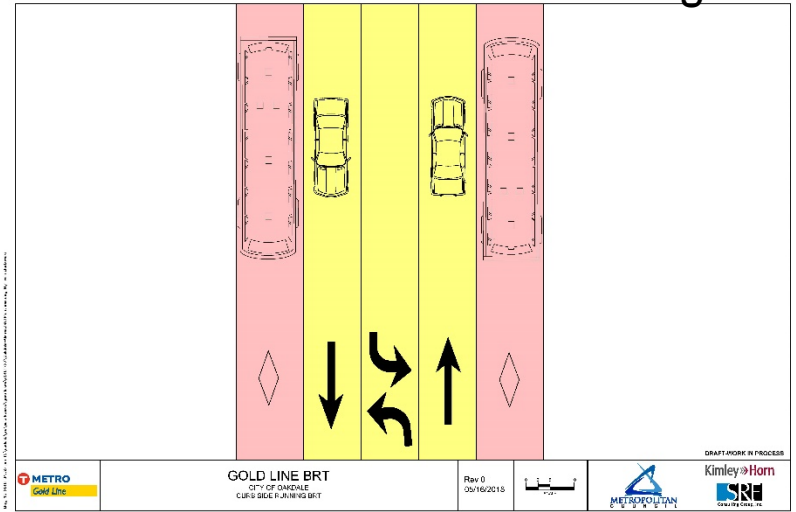

## Dedicated Side Running

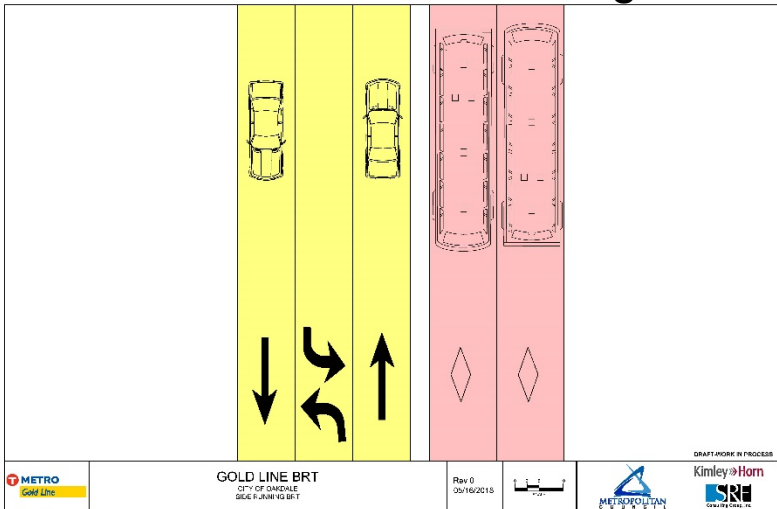

## Dedicated Center Running

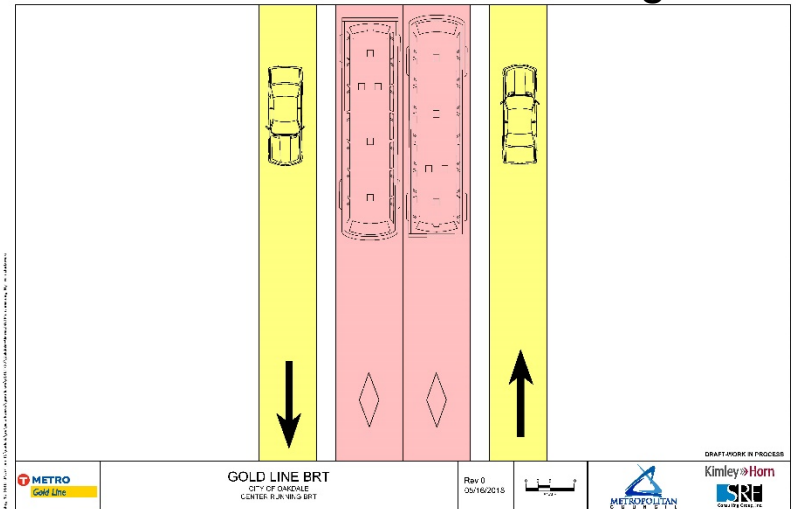

## Gold Line Overall Funding (up to \$460.9 million)

Funding Source	\$25M Project Development	\$75M Engineering	~\$360.9M Construction	Up to \$460.9M Total (Estimate)
Federal FTA New Starts	-	-	~\$207.4M	~\$207.4M
Federal Regional Solicitation Grant	-	-	\$4.4M	\$4.4M
Ramsey County	\$8.5M	\$37.5M	~\$74.7M	~\$120.7M
Washington County**	\$8.5M	\$37.5M	~\$74.5M	~\$120.5M
CTIB	\$6.0M	-	-	\$6M
State	\$1.87M*	-	-	\$1.87M*

\*An additional \$133,395 in state bonds was spent Pre-Project Development

\*\*Includes \$1.1 million match for Federal Regional Solicitation Grant



# Gold Line Project Timeline

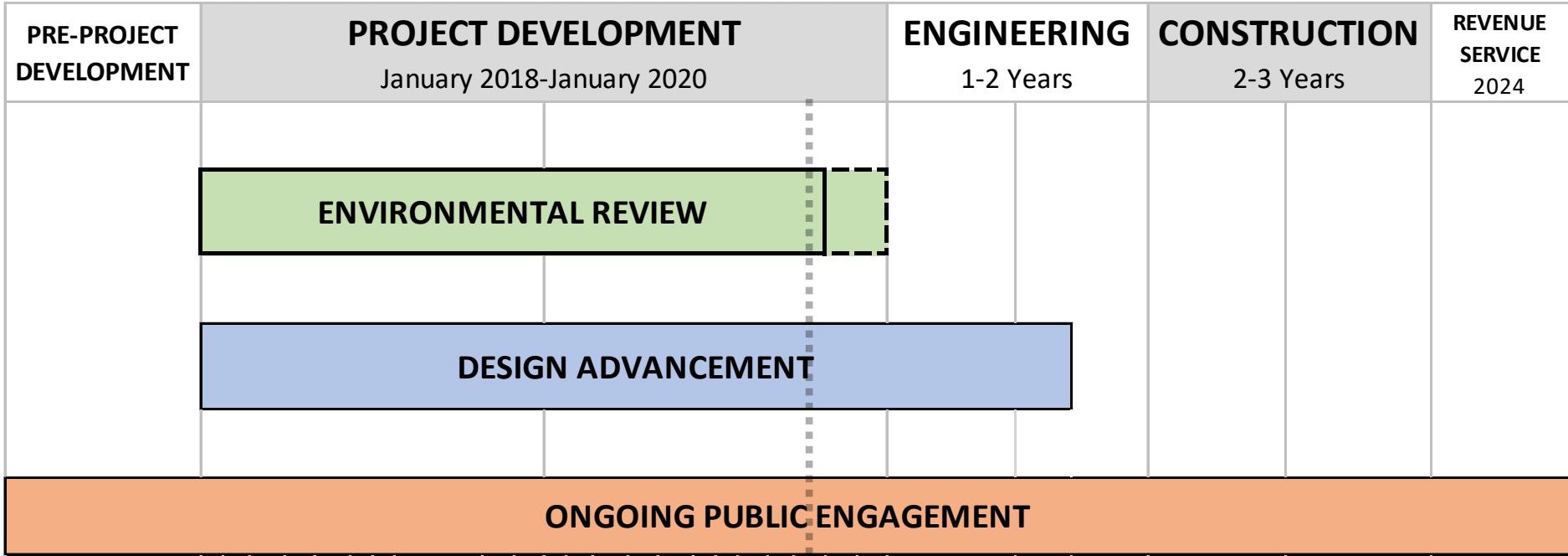

WE ARE  
HERE



# Project Development Stakeholder Engagement

- Open Houses and Neighborhood Meetings
  - Corridor-wide events to review design updates and options







# Gold Line in the Community

- 2018-2019 Outcomes\*
  - More than 130 outreach & engagement events, meetings and activities
  - Over 3,300 individual connections
  - Mailings to over 2,600 residents
  - Nearly 800 survey respondents
  - Contact with nearly 200 residents while door-knocking

*\*as of Sept. 19, 2019*





# Design Refinements

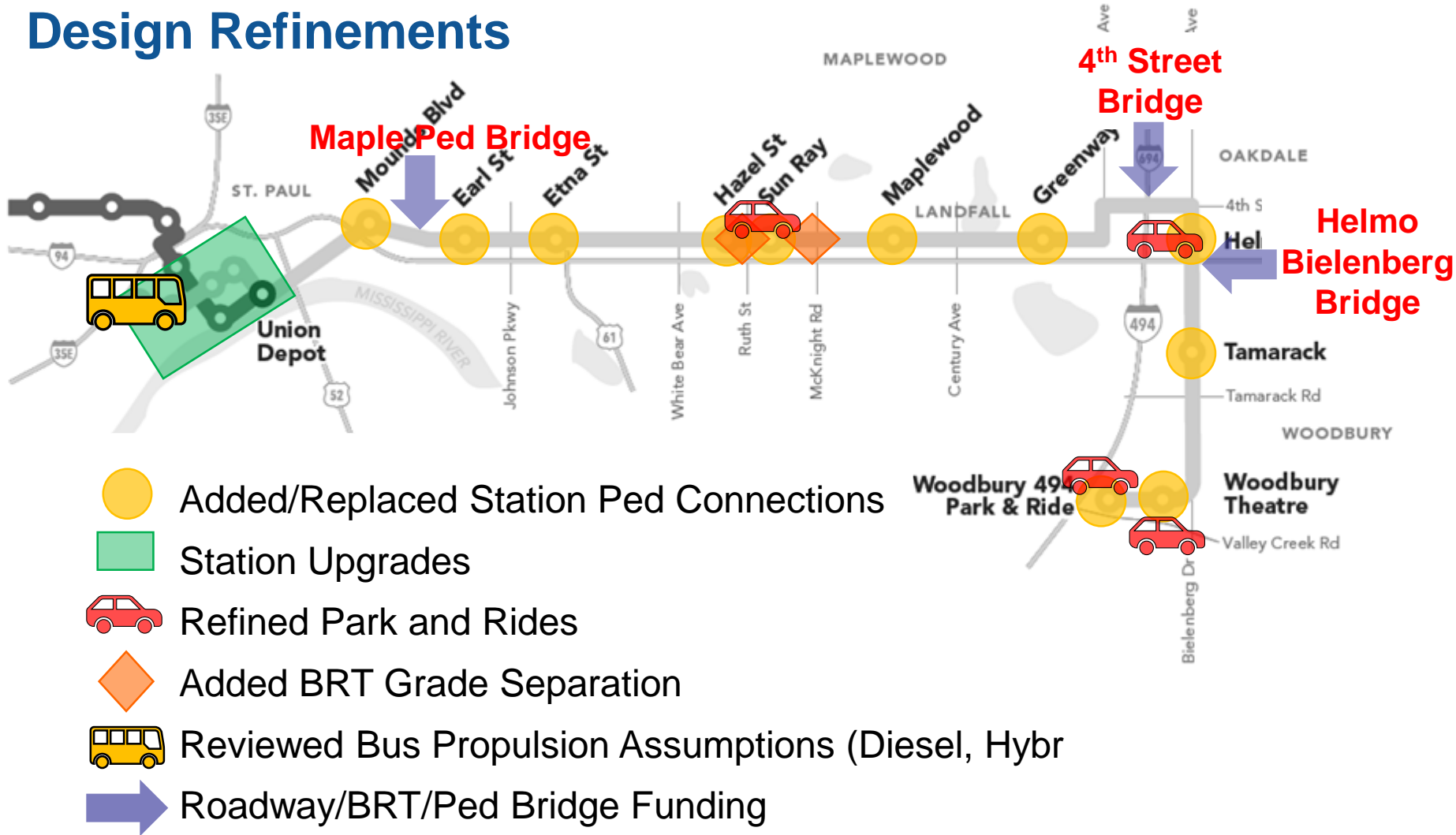

# Environmental Assessment Resource Areas

 Air quality	 Contaminated sites	 Parks	 Transportation
 Businesses	 Historic properties	 Protected and endangered species	 Visual impacts
 Community character + facilities	 Land use	 Public + private properties	 Water
 Construction	 Noise	 Safety	 Wildlife habitat

- Evaluated by Build Alternative: No Build, Alternative 1, Alternative 2
- Short-term (construction phase) and long-term (operating phase) activities are evaluated for all resource areas.

# EA Comment Period

- EA Publication on October 7
- 30-day Comment Period (October 7 to November 5)
- Open Houses:

East Side Community Room  
at Conway Rec Center  
October 22nd  
5-7 PM

Landfall Community  
Center  
October 23rd  
5-7 PM

Gold Line Project Office  
Drop-in hours  
October 28th  
11 AM -1 PM

- The FTA and Metropolitan Council will review all comments
- Substantive comments will be responded to in the EA
- Outcome of comment period: Finding of No Significant Impact (FONSI) determination or complete additional analysis
- Anticipated FONSI January 2020



# Gold Line Project Development Phase

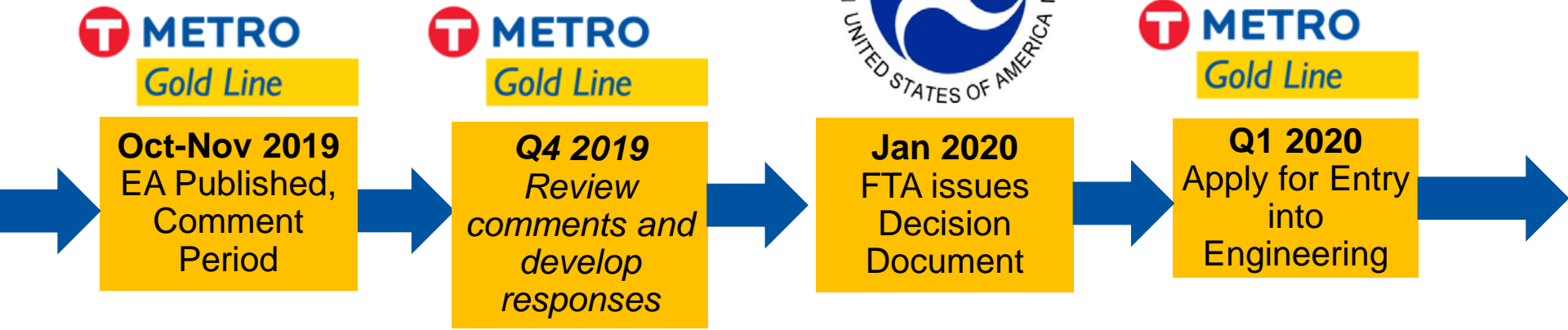
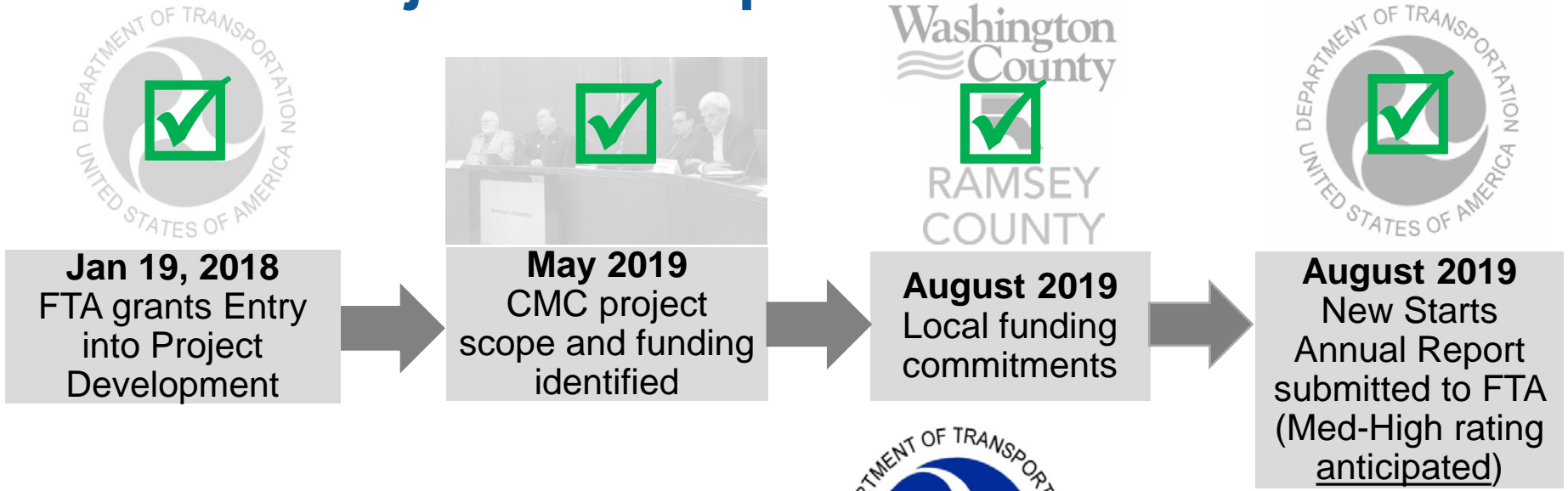



To submit comments on the Environmental Assessment:

By email: [goldline@metrotransit.org](mailto:goldline@metrotransit.org)

Online: [www.metrotransit.org/gold-line-environmental](http://www.metrotransit.org/gold-line-environmental)

By regular mail: ATTN: Chelsa Johnson, METRO Gold Line Project Office

For more information:

[www.metrotransit.org/gold-line-project](http://www.metrotransit.org/gold-line-project)

Metro Transit BRT Projects

Charles Carlson

Director of BRT Projects

(612) 349-7639

[charles.carlson@metrotransit.org](mailto:charles.carlson@metrotransit.org)

METRO Gold Line BRT Project Office

Chris Beckwith

Senior Project Manager

(651) 602-1994

[christine.beckwith@metrotransit.org](mailto:christine.beckwith@metrotransit.org)