

SOUTHWEST

Green Line LRT Extension



# Transportation Committee

February 24, 2020



# Today's Topics

- Eden Prairie Town Center Station Background
- Business Item 2020-62 Change Order
- Business Item 2020-73 Amendment #1 Subrecipient Agreement with Eden Prairie



# Eden Prairie Town Center Station Background

- 2015 Eden Prairie Town Center (EPTC) Station was deferred from the SWLRT Project due to budget reductions
- 2016 Eden Prairie applied for federal funding
- 2017 Transportation Advisory Board awarded CMAQ funding to the city to build out the EPTC Station as part of the SWLRT Project
- 2018 Council executed a subrecipient agreement with the City, for construction of EPTC Station as part of SWLRT Project
- Dec 2018 Council awarded Civil Construction contract to Lunda McCrossan Joint Venture
  - Contract scope did not include the EPTC station at the time of contract award

# Eden Prairie Town Center Station



# Eden Prairie Town Center Station: Looking North



# Eden Prairie Town Center Station: Looking East

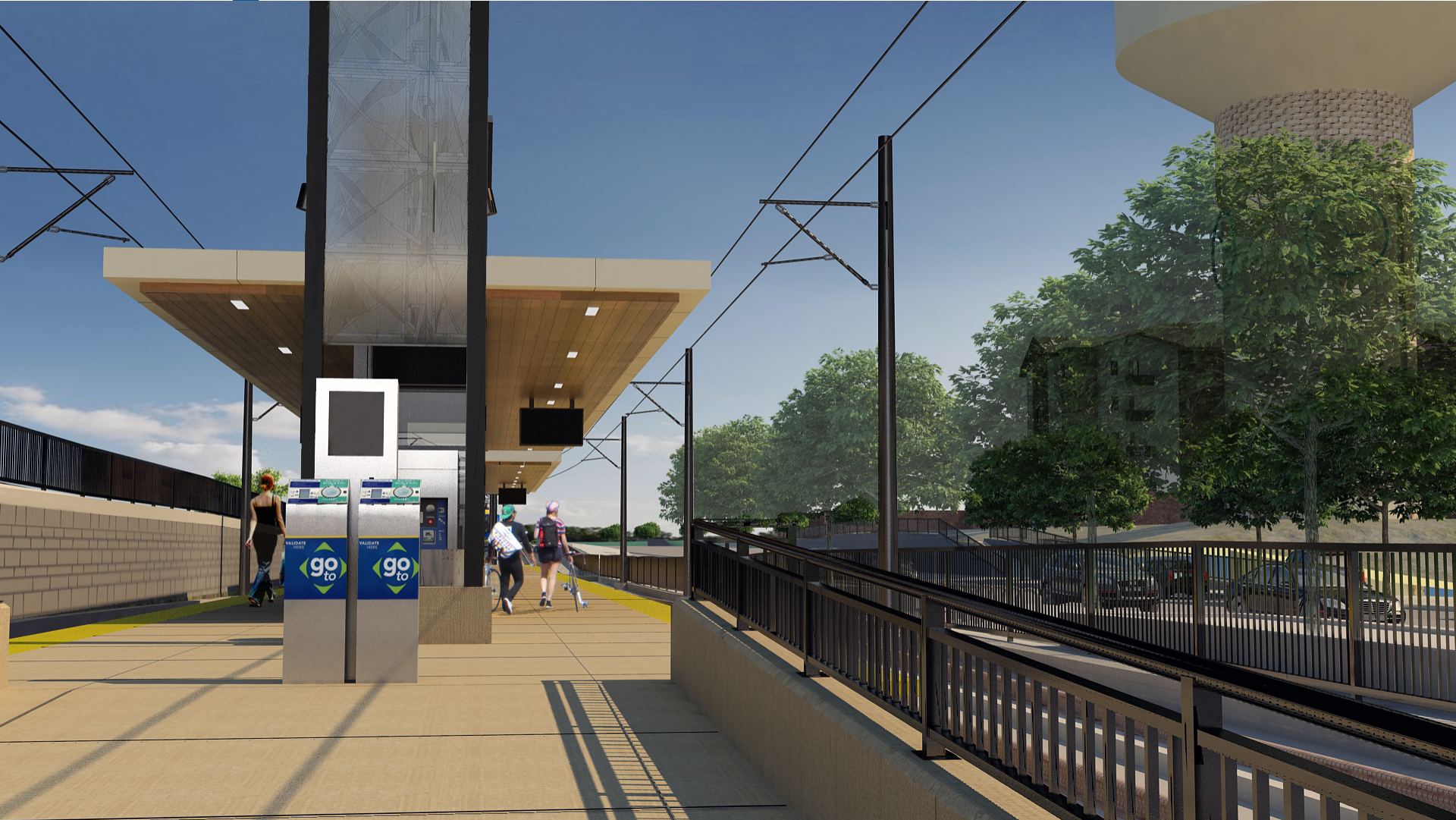

# **EPTC Change Order**

## ***Business Item 2020-62***

# Change Order Overview

- Change order scope includes
  - Foundation and concrete platform
  - Steel canopy
  - Pedestrian walkways
  - Drainage
  - Electrical power and lighting
  - Roadway including passenger pick up, drop off area and vehicles turnaround
  - Retaining walls
- Anticipate 18% of change order work will be performed by DBE subcontractors



# Recommendation

- That the Metropolitan Council authorize the Southwest LRT Council Authorized Representative to negotiate and execute a change order with Lunda McCrossan Join Venture in the amount not to exceed \$11,413,550 to construct the Eden Prairie Town Center Station.

# **Subrecipient Agreement with Eden Prairie EPTC Amendment #1**

## ***Business Item 2020-73***

# Recommendation

- That the Metropolitan Council authorize the Regional Administrator to negotiate and execute the first Amendment to Subrecipient Agreement with the City of Eden Prairie, the grant subrecipient, to address costs above the grant amount to be funded by the SWLRT Project.

# Stay Updated!

Online:

[SWLRT.org](http://SWLRT.org)

Twitter:

@SouthwestLRT

Flickr:

[flickr.com/photos/metcouncil/albums](https://www.flickr.com/photos/metcouncil/albums)

Facebook:

@MetropolitanCouncil

Instagram:

@southwest\_lrt

