



Application

01968 - 2014 Roadway Reconstruction/Modernization

02157 - CSAH 86 from TH 3 to CSAH 47 in Dakota County MN

Regional Solicitation - Roadways Including Multimodal Elements

Status: Submitted
Submitted Date: 12/01/2014 1:57 PM

Primary Contact

Name:* Holly Jo Anderson
Salutation First Name Middle Name Last Name

Title: P.E.S.

Department: Dakota County Transportation Dept

Email: Holly.Anderson@co.dakota.mn.us

Address: 14955 Galaxie Avenue

***** Apple Valley Minnesota 5514
City State/Province Postal Code/Zip

Phone:* 952-891-7090
Phone Ext.

Fax:

What Grant Programs are you most interested in? Regional Solicitation - Roadways Including Multimodal Elements

Organization Information

Name: DAKOTA COUNTY

Jurisdictional Agency (if different):

Organization Type:

County Government

Organization Website:

Address:

TRANSPORTATION DEPT
14955 GALAXIE AVE

*

APPLE VALLEY Minnesota 55124
City State/Province Postal Code/Zip

County:

Dakota

Phone:*

952-891-7100

Ext.

Fax:

PeopleSoft Vendor Number

0000002621A15

Project Information

Project Name

CSAH 86 from TH 3 to CSAH 47 in Dakota County MN

Primary County where the Project is Located

Dakota

Jurisdictional Agency (If Different than the Applicant):

Brief Project Description (Limit 2,800 characters; approximately 400 words)

Reconstruction of CSAH 86 (280th Street A-Minor Arterial) from TH 3 (Chippendale Ave) to CSAH 47 (Northfield Blvd) in Castle Rock, Waterford & Sciota Townships. This project will address roadway safety concerns and geometric deficiencies by: reducing the number & severity of run off roadway type crashes with the addition of an 8 bituminous shoulder; provide increased safety for pedestrians/bicyclists; and adding turn lanes at intersections to improve roadway operations/safety through the area. This east/west A-Minor Arterial route begins at the western edge of Scott County connecting the growing communities of New Prague, Elko/New Market to the rural township areas of eastern Dakota County. This route is approximately 46 miles in length from TH 169 to TH 52 in Dakota County.

The specific improvements proposed as part of this project fit well with the overall transportation system in the area. The improvements include reconstructing the existing 2-lane roadway, adding 8 bituminous shoulders, flattening out side slopes/ditches, adding turn lanes at major intersections and by-pass lanes at T intersections from TH 3 to CSAH 47 in Dakota County. This project includes intersection modification to address safety. Aligning, consolidating and removing access along the corridor will increase safety along the corridor. Bridge L3182 (built in 1940) will be replaced as part of this project.

CSAH 86 is a cross county route that is used by the freight industry as a parallel northerly route to TH 19 in Rice & Goodhue Counties.

Include location, road name/functional class, type of improvement, etc.

Project Length (Miles)

3.85

Connection to Local Planning:

Reference the name of the appropriate comprehensive plan, regional/statewide plan, capital improvement program, corridor study document [studies on trunk highway must be approved by MnDOT and the Metropolitan Council], or other official plan or program of the applicant agency [includes Safe Routes to School Plans] that the project is included in and/or a transportation problem/need that the project addresses. List the applicable documents and pages.

Dakota County 2030 Transportation Plan

Chapter 8, Goal 5: Replace Deficient Elements of the System p. 8.1 to 8.7

Chapter 9, Future Studies: East/West Principal Arterial Assessment and 10-Ton Route System Implementation p. 9-16

Future Studies - Figure 46

Dakota County 2014-2018 Capital Improvement Program (online version)

Future Studies - Figure 2, P. Trans 8

2014-2018 CIP Map between p. Trans 10-11

5-Year Summary p. Trans 12-14

Individual Project Sheet p. Trans 84

Dakota County Rural Collaborative Comprehensive Plan (i.e. Townships of Castle Rock & Waterford)

Sciota Township Comprehensive Plan

Connection to Local Planning

Project Funding

Are you applying for funds from another source(s) to implement this project? No

If yes, please identify the source(s)

Federal Amount \$5,500,000.00

Match Amount \$1,375,000.00

Minimum of 20% of project total

Project Total \$6,875,000.00

Match Percentage 20.0%

Minimum of 20%

Compute the match percentage by dividing the match amount by the project total

Source of Match Funds Dakota County
 Preferred Program Year
 Select one: 2018

MnDOT State Aid Project Information: Roadway Projects

County, City, or Lead Agency Dakota County
 Functional Class of Road A-Minor Arterial Connector
 Road System CSAH 86
TH, CSAH, MSAS, CO. RD., TWP. RD., CITY STREET
 Name of Road 280th Street
Example; 1st ST., MAIN AVE
 Zip Code where Majority of Work is Being Performed 55065
 (Approximate) Begin Construction Date 04/01/2018
 (Approximate) End Construction Date 12/31/2018

LOCATION

From:
 (Intersection or Address) Trunk Highway 3
*Do not include legal description;
 Include name of roadway if majority of facility
 runs adjacent to a single corridor.*

To:
 (Intersection or Address) CSAH 47 (Northfield Blvd)

Type of Work Grading, aggregate base, bituminous base, bituminous surface, bituminous shoulders & bridge replacement
Examples: grading, aggregate base, bituminous base, bituminous surface, sidewalk, signals, lighting, guardrail, bicycle path, ped ramps, bridge, Park & Ride, etc.)

Old Bridge/Culvert? Yes
 New Bridge/Culvert? Yes
 Structure is Over/Under
 (Bridge or culvert name): N Branch Chub Creek Replace L3182 Conc Box Culvert

Specific Roadway Elements

CONSTRUCTION PROJECT ELEMENTS/COST ESTIMATES	Cost
Mobilization (approx. 5% of total cost)	\$340,000.00
Removals (approx. 5% of total cost)	\$340,000.00
Roadway (grading, borrow, etc.)	\$1,700,000.00

Roadway (aggregates and paving)	\$3,400,000.00
Subgrade Correction (muck)	\$0.00
Storm Sewer	\$205,000.00
Ponds	\$0.00
Concrete Items (curb & gutter, sidewalks, median barriers)	\$0.00
Traffic Control	\$35,000.00
Striping	\$50,000.00
Signing	\$35,000.00
Lighting	\$5,000.00
Turf - Erosion & Landscaping	\$240,000.00
Bridge	\$400,000.00
Retaining Walls	\$0.00
Noise Wall	\$0.00
Traffic Signals	\$0.00
Wetland Mitigation	\$0.00
Other Natural and Cultural Resource Protection	\$0.00
RR Crossing	\$0.00
Roadway Contingencies	\$0.00
Other Roadway Elements	\$0.00
Totals	\$6,750,000.00

Specific Bicycle and Pedestrian Elements

CONSTRUCTION PROJECT ELEMENTS/COST ESTIMATES	Cost
Path/Trail Construction	\$0.00
Sidewalk Construction	\$0.00
On-Street Bicycle Facility Construction	\$125,000.00
Right-of-Way	\$0.00
Pedestrian Curb Ramps (ADA)	\$0.00
Crossing Aids (e.g., Audible Pedestrian Signals, HAWK)	\$0.00
Pedestrian-scale Lighting	\$0.00
Streetscaping	\$0.00
Wayfinding	\$0.00
Bicycle and Pedestrian Contingencies	\$0.00
Other Bicycle and Pedestrian Elements	\$0.00

Totals

\$125,000.00

Specific Transit and TDM Elements

CONSTRUCTION PROJECT ELEMENTS/COST ESTIMATES	Cost
Fixed Guideway Elements	\$0.00
Stations, Stops, and Terminals	\$0.00
Support Facilities	\$0.00
Transit Systems (e.g. communications, signals, controls, fare collection, etc.)	\$0.00
Vehicles	\$0.00
Transit and TDM Contingencies	\$0.00
Other Transit and TDM Elements	\$0.00
Totals	\$0.00

Transit Operating Costs

OPERATING COSTS	Cost
Transit Operating Costs	\$0.00
Totals	\$0.00

Totals

Total Cost	\$6,875,000.00
Construction Cost Total	\$6,875,000.00
Transit Operating Cost Total	\$0.00

Requirements - All Projects

All Projects

1. The project must be consistent with the goals and policies in these adopted regional plans: Thrive MSP 2040 (2014), the 2030 Transportation Policy Plan (amended 2013), the 2030 Regional Parks Policy Plan (amended 2013), and the 2030 Water Resources Management Policy Plan (2005).

Check the box to indicate that the project meets this requirement. Yes

2. Applicants that are not cities or counties in the seven-county metro area with populations over 5,000 must contact the MnDOT Metro State Aid Office prior to submitting their application to determine if a public agency sponsor is required.

Check the box to indicate that the project meets this requirement. Yes

3. Applicants must not submit an application for the same project in more than one funding sub-category.

Check the box to indicate that the project meets this requirement. Yes

4. The requested funding amount must be more than or equal to the minimum award and less than or equal to the maximum award. The cost of preparing a project for funding authorization can be substantial. For that reason, minimum federal amounts apply. Other federal funds may be combined with the requested funds for projects exceeding the maximum award, but the source(s) must be identified in the application. Expansion, reconstruction/modernization, and bridges must be between \$1,000,000 and \$7,000,000. Roadway system management must be between \$250,000 and \$7,000,000.

Check the box to indicate that the project meets this requirement. Yes

5. The project must comply with the Americans with Disabilities Act.

Check the box to indicate that the project meets this requirement. Yes

6. The project must be accessible and open to the general public.

Check the box to indicate that the project meets this requirement. Yes

7. The owner/operator of the facility must operate and maintain the project for the useful life of the improvement.

Check the box to indicate that the project meets this requirement. Yes

8. The project must represent a permanent improvement with independent utility. The term independent utility means the project provides benefits described in the application by itself and does not depend on any construction elements of the project being funded from other sources outside the regional solicitation, excluding the required non-federal match. Projects that include traffic management or transit operating funds as part of a construction project are exempt from this policy.

Check the box to indicate that the project meets this requirement. Yes

9. The project must not be a temporary construction project. A temporary construction project is defined as work that must be replaced within five years and is ineligible for funding. The project must also not be staged construction where the project will be replaced as part of future stages. Staged construction is eligible for funding as long as future stages build on, rather than replace, previous work.

Check the box to indicate that the project meets this requirement. Yes

10. The project applicant must send written notification regarding the proposed project to all affected communities and other levels and units of government prior to submitting the application.

Check the box to indicate that the project meets this requirement. Yes

Requirements - Roadways Including Multimodal Elements

Expansion and Reconstruction/Modernization Projects Only

1. The project must be designed to meet 10-ton load limit standards.

Check the box to indicate that the project meets this requirement. Yes

2. Federal funds are available for roadway construction and reconstruction on new alignments or within existing right-of-way, including associated construction and excavation, bridges, or installation of traffic signals, signs, utilities, bikeway or walkway components and transit components.

The project must exclude costs for right-of-way, studies, preliminary engineering, design, or construction engineering. Noise barriers, drainage projects, fences, landscaping, etc., are not eligible for funding unless included as part of a larger project, which is otherwise eligible.

Check the box to indicate that the project meets this requirement. Yes

Bridge Projects Only

3. The bridge project must be identified as a Principal Arterial (Non-Freeway facilities only) or A Minor Arterial as shown on the latest TAB approved roadway functional classification map.

Check the box to indicate that the project meets this requirement.

4. Bridges selected in previous Bridge Improvement and Replacement solicitations (1994-2011) are not eligible. A previously selected project is not eligible unless it has been withdrawn or sunset prior to the deadline for proposals in this solicitation.

Check the box to indicate that the project meets this requirement.

5. Projects requiring a grade-separated crossing of a Principal Arterial of freeway design must be limited to the federal share of those project costs identified as local (non-MnDOT) cost responsibility using MnDOT's Cost Participation for Cooperative Construction Projects and Maintenance Responsibilities manual. In the case of a federally funded trunk highway project, the policy guidelines should be read as if the funded trunk highway route is under local jurisdiction.

Check the box to indicate that the project meets this requirement.

6. The bridge must carry vehicular traffic. Bridges can carry traffic from multiple modes. However, bridges that are exclusively for bicycle or pedestrian traffic must apply under one of the Bicycle and Pedestrian Facilities sub-categories. Rail-only bridges are ineligible for funding.

Check the box to indicate that the project meets this requirement.

7. The length of the bridge must equal or exceed 20 feet.

Check the box to indicate that the project meets this requirement.

8. Project limits for bridge projects are limited from abutment to abutment.

Check the box to indicate that the project meets this requirement.

9. The project must exclude costs for studies, preliminary engineering, design, construction engineering, and right-of-way.

Check the box to indicate that the project meets this requirement.

Bridge Replacement Projects Only

10. The bridge must have a sufficiency rating less than 50. Additionally, it must also be classified as structurally deficient or functionally obsolete.

Check the box to indicate that the project meets this requirement.

Bridge Rehabilitation Projects Only

11. The bridge must have a sufficiency rating less than 80. Additionally, it must also be classified as structurally deficient or functionally obsolete.

Check the box to indicate that the project meets this requirement.

Other Attachments

File Name	Description	File Size
2014-2018CIPmap.pdf	CIP Project Map	472 KB
8632 CONCEPT.pdf	CSAH 86 Concept Layout	459 KB
86TruckCount-3to47.pdf	Truck/Heavy Commercial Count	267 KB
AdoptedCIP.pdf	Adopted2014-2018CIP	1.0 MB
CIPsheet86(3to47).pdf	CIP Project Sheet	41 KB
DC-FundMaintain.pdf	DakCo-FundMaintainLetter	298 KB
DC-Resolution.pdf	DakCoResolutionOfSupport	1.4 MB
DC-TranPlan-FutureStudies.pdf	DakCoTranPlan-FutureStudies	484 KB
DC-TranPlan.pdf	Dakota County Tran Plan 10 Ton	1.7 MB
MnDOT-SafetyPlan86.pdf	MnDOT Dak Co Safety Plan CSAH 86	266 KB
RdwayAreaDef.pdf	Roadway Area Definition	1.3 MB
Reconstruct CSAH 86 from Hwy 3 to CSAH 47.pdf	MnDOT Letter Support	38 KB
RegionalEcon.pdf	Regional Economy	418 KB
RoadAge.pdf	DakCoTranPlan-RoadAge	398 KB
Roadway Reconstruction.pdf	CSAH 86 Aerial Project Limits	221 KB
SocioEcon.pdf	Socio Economic	420 KB
TransitCon.pdf	Transit Connections	448 KB

Reliever: Freeway Facility or

Facility being relieved

Number of hours per day volume exceeds capacity (based on the Congestion Report) 0

Reliever: Non-Freeway Facility or

Facility being relieved

Number of hours per day volume exceeds capacity (based on the table below) 0

Non-Freeway Facility Volume/Capacity Table

Hour	NB/EB Volume	SB/WB Volume	Capacity	Volume exceeds capacity
12:00am - 1:00am				

1:00am - 2:00am
2:00am - 3:00am
3:00am - 4:00am
4:00am - 5:00am
5:00am - 6:00am
6:00am - 7:00am
7:00am - 8:00am
8:00am - 9:00am
9:00am - 10:00am
10:00am - 11:00am
11:00am - 12:00pm
12:00pm - 1:00pm
1:00pm - 2:00pm
2:00pm - 3:00pm
3:00pm - 4:00pm
4:00pm - 5:00pm
5:00pm - 6:00pm
6:00pm - 7:00pm
7:00pm - 8:00pm
8:00pm - 9:00pm
9:00pm - 10:00pm
10:00pm - 11:00pm
11:00pm - 12:00am

Expander/Connector/Augmentor/Non-Freeway Principal Arterial

Select one:	Connector
Area	32.209
Project Length	3.89
Average Distance	8.2799
Upload Map	CH86-E-RAD.pdf

Measure B: Current Heavy Commercial Traffic

Location	Along CSAH 86, approx. 2 miles east of TH 3 in Castle Rock & Waterford Twps
----------	---

Current daily heavy commercial traffic volume

559.0

Measure C: Project Location Relative to Jobs, Manufacturing, and Education

Select all that apply

Direct connection to or within a mile of a Job Concentration

Direct connection to or within a mile of a Manufacturing/Distribution Location

Direct connection to or within a mile of an Educational Institution

Project provides a direct connection to or within a mile of an existing local activity center identified in an adopted county or city plan Yes

County or City Plan Reference (Limit 700 characters; approximately 100 words)

Dakota County Rural Collaborative Comp Plan-Land Use Map (p.33) identifies commercial area with direct connection to the CSAH 86 project. This area is located on the north side of CSAH 86 at the intersection of TH 3. This identified area is made up of agri-business or service industries. Refer to attached Dakota County GIS map that shows locations for Prairie Creek Community School and other commercial establishments in the area of the project.

Upload Map

CH86-RE-etc.pdf

Measure A: Current Daily Person Throughput

Location	CSAH 86 - 1/2 mile east of TH 3
Current AADT Volume	2350.0
Existing Transit Routes on the Project	N/A

Response: Current Daily Person Throughput

Average Annual Daily Transit Ridership	0
Current Daily Person Throughput	3055.0

Measure B: 2030 Forecast ADT

Use Metropolitan Council model to determine forecast (2030) ADT volume

METC Staff - Forecast (2030) ADT volume	0
---	---

OR

Approved county or city travel demand model to determine forecast (2030) ADT volume	Yes
Forecast (2030) ADT volume	4800.0

Measure A: Project Location and Impact to Disadvantaged Populations

Select one:

Project located in Racially Concentrated Area of Poverty

Project located in Concentrated Area of Poverty

Projects census tracts are above the regional average for population in poverty or population of color

Project located in a census tract that is below the regional average for population in poverty or populations of color or includes children, people with disabilities, or the elderly.

Yes

Response (Limit 1,400 characters; approximately 200 words)

The CSAH 86 project is located in southern townships of Dakota County. The Draft 2040 TPP (p.133) references that rural areas will invest in highways and streets that are flexible for a variety of uses and connect them with Rural Centers and the urban and suburban areas with the Urban Service Area. The emphasis will be on strengthening safe connections and less on large-scale transportation capacity. CSAH 86 connects to major north/south roadways (CH 23, CH 47, TH 3, TH 56, TH 52) that connect to the Urban Service Area. This project is in an area of that includes children, people with disabilities and the elderly; although not in concentrations recognized by Met Council. The CSAH 86 project will provide an 8 paved shoulder for ped/bike/wheelchair use along with 10-ton roadway designed for motorized traffic. Safety will be improved with the addition of turn lanes, pavement markings, rumble stripes, intersection lighting and removal of hazards in roadway clear zone.

Upload Map

CH86-E-SEC.pdf

Measure B: Affordable Housing

City/Township	Segment Length (Miles)
Castle Rock Township	1.924
Waterford Township	0.924
Sciota Township	1.0
	4

Total Project Length

Total Project Length	3.85
----------------------	------

Affordable Housing Scoring - To Be Completed By Metropolitan Council Staff

City/Township	Segment Length (Miles)	Total Length (Miles)	Score	Segment Length/Total Length	Housing Score Multiplied by Segment percent
		0	0	0	0

Affordable Housing Scoring - To Be Completed By Metropolitan Council Staff

Total Project Length (Miles)	3.848
Total Housing Score	0

Measure A: Year of Roadway Construction

Year of Original Roadway Construction or Most Recent Reconstruction	Roadway Segment Length (Miles)	Calculation	Calculation 2
1952.0	3.85	7515.2	1952.0
	4	7515	1952

Average Construction Year

Weighted Year	1952.0
---------------	--------

Total Segment Length (Miles)

Total Segment Length	3.85
----------------------	------

Measure B: Geometric, Structural, or Infrastructure Improvements

Improve roadway structural capacity to 10 Ton limit. Widen existing shoulders to 8 bituminous shoulders to improve safety for pedestrian/bicyclist/disabled. Flatten out side slopes/ditches strategic tree removal, fixed object modifications and roadside hardware improvements. Removal/consolidation/aligning access along the CSAH 86 roadway. Add turn lanes at major intersections & bypass lanes at T intersections. Lighting at major intersections. Improvement of highway signage and pavement markings. Improve vertical alignment to increase sight distance for motorized/non-motorized roadway users. Replace existing metal culverts (1952), guardrail, and signage with up to date materials. Include recommendations from Dakota County Roadway Safety Plan (MnDOT approved) p.10, segment ID 86.02 Center Line Rumble Strip & Rumble Stripe reduce injury/roadway departure crashes. Bridge L3182 (built in 1940) past it's useful life will be replaced as part of this project.

Response (Limit 1,400 characters; approximately 200 words)

Measure A: Cost Effectiveness of Vehicle Delay Reduction

Total Project Cost from Cost Sheet	\$6,875,000.00
Total Peak Hour Vehicle Delay Without The Project	0
Total Peak Hour Vehicle Delay With The Project	0
Total Peak Hour Vehicle Delay Reduced by Project	0
Cost Effectiveness	\$0.00
Synchro or HCM Reports	Synchro-HCM-Report.pdf

Measure B: Cost Effectiveness of Emissions Reduction

Total Project Cost from Cost Sheet	\$6,875,000.00
Total Peak Hour Kilograms Reduced by Project	0
Cost Effectiveness	\$0.00
Synchro or HCM Reports	Synchro-HCM-Report.pdf

Measure A: Benefit/Cost of Crash Reduction

Project Benefit/Cost Ratio	0.35
Worksheet Attachment	86(3to47)BeneCostWkst.pdf

Measure A: Transit Connections

Existing Routes Directly Connected to the Project	N/A
Planned Transitways directly connected to the project (alignment and mode determined and identified in the 2030 TPP)	N/A
Upload Map	CH86-E-TC.pdf

Response

Met Council Staff Data Entry Only

Route Ridership	0
Transitway Ridership	0

Measure B: Bicycle and Pedestrian Connections

Response (Limit 1,400 characters; approximately 200 words)

Townships in Dakota County depend upon the County Highway system to provide for bike/ped connections along paved roadway shoulders. The CSAH 86 project will replace the existing narrow shoulders with new construction of 8 bituminous shoulders to connect ped/bike/disabled with the village center and service industries along the corridor. (Refer to attachments 1C Regional Economy). The 8 bituminous shoulders will increase safety, improve the user experience with wider shoulders and provide increased security through roadway vertical grade improvements and ditch slope flattening. Lighting will be installed at major intersections. New Pavement markings & rumble strips will provide a perceived separation between motorized/non-motorized users. This project will provide east/west connectivity between convenience/gas store, beauty salon, repair shop, storage area, Co-op elevator, Prairie Creek School, post office, church & restaurant.

Measure C: Multimodal Facilities

Response (Limit 1,400 characters; approximately 200 words)

The CSAH 86 project is located in southern townships of Dakota County. The Draft 2040 TPP (p.133) references that rural areas will invest in highways and streets that are flexible for a variety of uses and connect them with Rural Centers and the urban and suburban areas with the Urban Service Area. The emphasis will be on strengthening safe connections and less on large-scale transportation capacity. CSAH 86 connects to major north/south roadways (CH 23, CH 47, TH 3, TH 56, TH 52) that connect to the Urban Service Area. This project is in an area of that includes children, people with disabilities and the elderly; although not in concentrations recognized by Met Council. The CSAH 86 project will provide an 8 paved shoulder for ped/bike/wheelchair use along with 10-ton roadway designed for motorized traffic. Safety will be improved with the addition of turn lanes, pavement markings, rumble stripes, intersection lighting and removal of hazards in roadway clear zone.

Transit Projects Not Requiring Construction

If the applicant is completing a transit or TDM application, only Park-and-Ride and other construction projects require completion of the Risk Assessment below. Check the box below if the project does not require the Risk Assessment fields, and do not complete the remainder of the form. These projects will receive full points for the Risk Assessment.

Check Here if Your Transit Project Does Not Require Construction

Measure A: Risk Assessment

1)Project Scope (5 Percent of Points)

Meetings or contacts with stakeholders have occurred

100%

Stakeholders have been identified

Yes

40%

Stakeholders have not been identified or contacted

0%

2)Layout or Preliminary Plan (5 Percent of Points)

Layout or Preliminary Plan completed

100%

Layout or Preliminary Plan started Yes

50%

Layout or Preliminary Plan has not been started

0%

Anticipated date or date of completion 08/31/2016

3)Environmental Documentation (10 Percent of Points)

EIS

EA

PM Yes

Document Status:

Document approved (include copy of signed cover sheet) 100%

Document submitted to State Aid for review 75%

Document in progress; environmental impacts identified

50%

Document not started Yes

0%

Anticipated date or date of completion/approval 12/01/2016

4)Review of Section 106 Historic Resources (15 Percent of Points)

No known potential for archaeological resources, no historic resources known to be eligible for/listed on the National Register of Historic Places located in the project area, and project is not located on an identified historic bridge

100%

Historic/archeological review under way; determination of no historic properties affected or no adverse effect anticipated

80%

Historic/archaeological review under way; determination of adverse effect anticipated

40%

Unknown impacts to historic/archaeological resources Yes

0%

Anticipated date or date of completion of historic/archeological review: 10/01/2016

Project is located on an identified historic bridge

5)Review of Section 4f/6f Resources (15 Percent of Points)

(4f is publicly owned parks, recreation areas, historic sites, wildlife or waterfowl refuges; 6f is outdoor recreation lands where Land and Water Conservation Funds were used for planning, acquisition, or development of the property)

No Section 4f/6f resources located in the project area

100%

Project is an independent bikeway/walkway project covered by the bikeway/walkway Negative Declaration statement; letter of support received

100%

Section 4f resources present within the project area, but no known adverse effects

80%

Adverse effects (land conversion) to Section 4f/6f resources likely

30%

Unknown impacts to Section 4f/6f resources in the project area Yes

0%

6)Right-of-Way (15 Percent of Points)

Right-of-way or easements not required

100%

Right-of-way or easements has/have been acquired

100%

Right-of-way or easements required, offers made

75%

Right-of-way or easements required, appraisals made

50%

Right-of-way or easements required, parcels identified

25%

Right-of-way or easements required, parcels not identified Yes

0%

Right-of-way or easements identification has not been completed

0%

Anticipated date or date of acquisition 12/14/2017

7)Railroad Involvement (25 Percent of Points)

No railroad involvement on project Yes

100%

Railroad Right-of-Way Agreement is executed (include signature page) 100%

Railroad Right-of-Way Agreement required; Agreement has been initiated

60%

Railroad Right-of-Way Agreement required; negotiations have begun

40%

Railroad Right-of-Way Agreement required; negotiations not begun

0%

Anticipated date or date of executed Agreement

8)Construction Documents/Plan (10 Percent of Points)

Construction plans completed/approved (include signed title sheet)

100%

Construction plans submitted to State Aid for review

75%

Construction plans in progress; at least 30% completion

50%

Construction plans have not been started

Yes

0%

Anticipated date or date of completion

01/15/2017

9)Letting

Anticipated Letting Date

01/15/2017

CIP 2014-2018



DAKOTA COUNTY
Minnesota

LEGEND

SYMBOL	TYPE OF PROJECT	COLOR	YEAR
	CONSTRUCTION		2014
	TRAFFIC SIGNAL		2015
	INTERSECTION IMPROVEMENT		2016
	INTERCHANGE		2017
	BRIDGE		2018
	PRELIMINARY OR DESIGN ENGINEERING AND/OR ROW ACQUISITION		

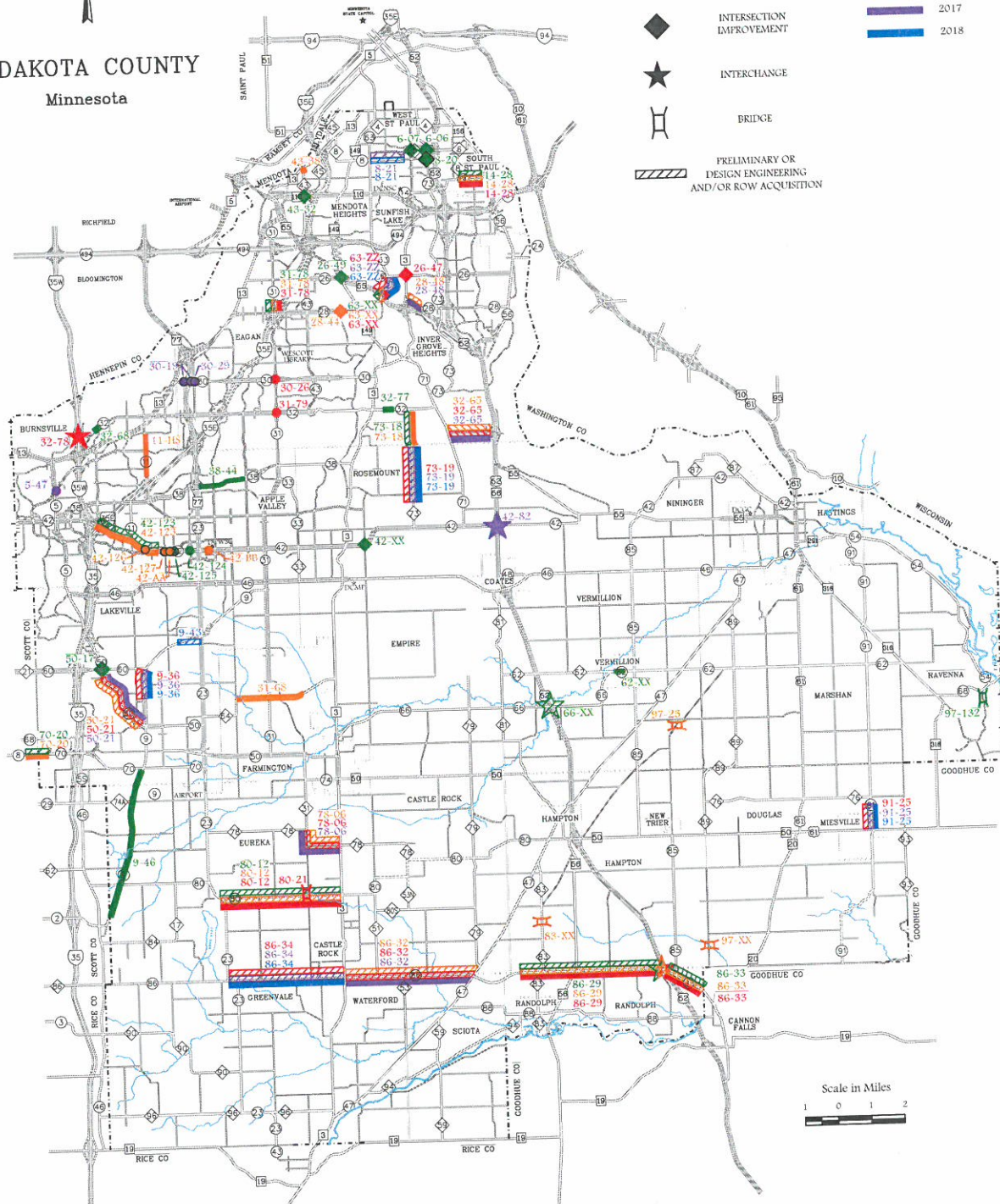

Scale in Miles
1 0 1 2



C.S.A.H. 86 (280TH ST. E.)
 STATE HIGHWAY 3 TO C.S.A.H. 47
 CONCEPT LAYOUT



Road Location Notes : CSAH 86 : From TH 3 to CSAH 47 : Classification Count

DAKOTA COUNTY TRANSPORTATION
TRAFFIC UNIT
TRAFFIC COUNT DATA

24 Hour Classification

Combined Channels

Site: Classification Count
10/27/2014
Monday

Interval Start	Total r Vehicles	Passenge	Single Trucks	Trucks & Trailers	Tailgating
11:00 AM	122	80	18	24	0
12:00 PM	111	66	20	25	0
1:00 PM	113	69	15	29	0
2:00 PM	135	100	10	25	0
3:00 PM	145	104	23	18	0
4:00 PM	190	156	17	17	0
5:00 PM	175	142	13	20	0
6:00 PM	126	104	8	14	0
7:00 PM	61	48	9	4	0
8:00 PM	46	41	5	0	0
9:00 PM	37	29	4	4	0
10:00 PM	9	7	0	2	0
11:00 PM	8	8	0	0	0
10/28/2014					
12:00 AM	4	4	0	0	0
1:00 AM	6	5	0	1	0
2:00 AM	3	3	0	0	0
3:00 AM	7	4	0	3	0
4:00 AM	22	21	1	0	0
5:00 AM	74	65	2	7	0
6:00 AM	115	93	13	9	0
7:00 AM	201	150	25	26	0
8:00 AM	131	79	26	26	0
9:00 AM	115	68	15	32	0
10:00 AM	131	82	16	33	0
Total	2087	1528	240	319	0
%		73.2	11.5	15.3	0.0

240 + 319 = 559

2014 - 2018 Transportation Capital Improvement Program

PROJECT NO.	ROAD/BUILDING	SEGMENT (FROM/TO)	PROJECT DESCRIPTION	PROJECT LOCATION	ANNUAL COST	CITY SHARE	FEDERAL	STATE	COUNTY STATE AID	GRAVEL TAX FOR CONST	OTHER	COUNTY COST	TOTAL LIFE PROJECT COST	LEAD AGENCY	
2015 Section															
2015 County Funds Dollars															
17	Highway Surface - Gravel		Spot Locations		700,000								700,000	Dakota Co	
18	Highway Surface - Gravel		Durable Pavement		50,000								50,000	Dakota Co	
19	Traffic Control Devices		Markings		350,000								350,000	Dakota Co	
20	Bike Trail				700,000								700,000	Dakota Co	
21	Transit Infrastructure				500,000								500,000	City	
22	Storm Sewer System Repair				500,000	200,000							300,000	Dakota Co	
23	Jurisdictional Classification				1,000,000								1,000,000	Dakota Co	
24	Safety and Management Projects				1,000,000								1,000,000	Dakota Co	
25	ROW Preservation & Management				1,056,600								1,056,600	Dakota Co	
29	CR 28		TH 3 to 0.62 mile east.		800,000								800,000	IGH	
30	CH31CR64		ROW Acquisition	Inver Grove Heights	876,670								876,670	Dakota Co	
31	new 32		Construction	Farmington	127,400								127,400	MnDOT	
36	CR 43		Design	Inver Grove Heights	1,566,800								1,566,800	Dakota County	
37	SAH 50		TH 1: Construction	Eureka/Castle Rock Twp	300,000								300,000	Dakota Co	
39	new 78		Design	Hampton Township	8,702,000								8,702,000	Dakota Co	
40	CR 83		Design	Hampton Township	500,000								500,000	Dakota Co	
42	CR 86		Design	Hampton Township	20,900								20,900	Dakota Co	
43	CR 86		Design	Hampton Township	218,004								218,004	Dakota Co	
44	CR 86		Design	Hampton Township	1,875,100								1,875,100	Dakota Co	
45	CR 86		Design	Hampton Township	27,528,874	5,174,150		1,702,000					20,652,724	Dakota Co	
46	CR 86		Design	Hampton Township											
47	CR 86		Design	Hampton Township											
2015 County State Aid Highway (CSAH)															
49	CR 20		ROW Acquisition	West St Paul	100,000	45,000							55,000	Dakota Co	
54	SAH 8		Commonwealth Dr to Parkway Lane Construction (4-lane to 3-lane)	Burnsville	846,450	34,628	769,500						846,450	Burnsville	
55	SAH 14		ROW Acquisition	South St Paul	800,000								800,000	Dakota Co	
58	SAH 31		ROW Acquisition	Eagan	500,000								500,000	Dakota Co	
59	SAH 28		Construction	Eagan	400,000								400,000	Eagan	
66	SAH 32		Slater Rd to CSAH 31	Eagan	472,000								472,000	Dakota Co	
68	SAH 42		W. Co. line to Chippendale Ave	Burnsville	1,049,000	23,600	377,600						1,049,000	Dakota Co	
69	SAH 42		Nicollet Ave to Elm Dr (N side)	Burnsville	2,194,575		839,200						2,194,575	Dakota Co	
72	SAH 42		Construction	Burnsville	37,500								37,500	Dakota Co	
73	SAH 42		Signal Reconstruction	Burnsville	1,755,660								1,755,660	Dakota Co	
74	SAH 42		Signal Reconstruction	Burnsville	250,000								250,000	Dakota Co	
75	SAH 42		Signal Reconstruction	Burnsville	250,000								250,000	Dakota Co	
78	SAH 42		Signal Reconstruction	Burnsville	125,000								125,000	Dakota Co	
80	SAH 63		Signal Reconstruction	Burnsville	125,000								125,000	Dakota Co	
81	SAH 70		Signal Reconstruction	Burnsville	125,000								125,000	Dakota Co	
83	SAH 86		Signal Reconstruction	Burnsville	360,000								360,000	Dakota Co	
86-29	SAH 86		Construction	Inver Grove Heights	800,000								800,000	Dakota Co	
87-25	SAH 86		Construction	Inver Grove Heights	1,700,600	765,300	360,000						2,765,900	Dakota Co	
97-xx	Township		Construction	CR Plan, Scotia, Hampton	2,040,500								2,040,500	Dakota Co	
97-xx	Township		Construction	CR, Waterford, Scotia	408,000								408,000	Dakota Co	
97-xx	Township		Construction	Vermillion Twp	180,000								180,000	Dakota Co	
97-xx	Township		Construction	Hampton/Douglas Twp	200,000						10,000		210,000	Dakota Co	
2015 County Fund & County State Aid Highway															
90	Highway Surface - Bituminous				13,151,125	2,503,540	4,101,960						17,756,625	Dakota Co	
91	Highway Surface - Bituminous				2,420,000				6,142,025		20,000		8,582,025	Dakota Co	
92	Intersection Control		CSAH Maintenance		1,364,000								1,364,000	Dakota Co	
94	CIP Reimbursement to Operations				1,200,000	587,500			1,364,000	170,000		2,250,000	Dakota Co		
					3,820,261	860,457			587,500				4,668,218	Dakota Co	
					8,804,261	1,427,957			1,298,889				10,531,107	Dakota Co	
					200,000				408,000				608,000	Dakota Co	
					13,151,125	2,503,540	4,101,960		6,142,025		10,000		20,902,650	Dakota Co	
2015 CSAH Subtotal															
					2,420,000								2,420,000	Dakota Co	
					1,200,000	587,500			1,364,000	170,000		2,250,000	6,930,000	Dakota Co	
					3,820,261	860,457			587,500				4,668,218	Dakota Co	
					8,804,261	1,427,957			1,298,889				10,531,107	Dakota Co	
					200,000				408,000				608,000	Dakota Co	
					13,151,125	2,503,540	4,101,960		6,142,025		10,000		20,902,650	Dakota Co	
2015 County Funds & CSAH Subtotal															
					49,484,260	9,105,647	4,101,960	2,085,600	9,392,414	170,000	20,000	24,608,639	121,000,000	Dakota Co	
													6,930,000	Dakota Co	
													7,484,160	Dakota Co	
													19,691,538	Dakota Co	

2014 - 2018 Transportation Capital Improvement Program

PAGE #	PROJECT NO.	ROAD/BUILDING	SEGMENT (FROM/TO)	PROJECT DESCRIPTION	PROJECT LOCATION	ANNUAL COST	CITY SHARE	FEDERAL	STATE	COUNTY STATE AID	GRAVEL TAX FOR CONST	OTHER	COUNTY COST	TOTAL LIFE PROJECT COST	LEAD AGENCY	
2016 Section																
2016 County Funds Dollars																
17			Highway Surface - Gravel	Spot Locations		350,000	-	-	-	-	-	-	350,000	2,800,000	Dakota Co	
18			Highway Surface - Gravel	Durable Pavement		50,000	-	-	-	-	-	-	50,000	250,000	Dakota Co	
19			Traffic Control Devices			350,000	-	-	-	-	-	-	350,000	1,750,000	Dakota Co	
20			Bike Trail			700,000	-	-	-	-	-	-	700,000	3,500,000	City	
21			Transit Infrastructure			60,000	-	-	-	-	-	-	60,000	300,000	City	
22			Storm Sewer System Repair			500,000	200,000	-	-	-	-	-	300,000	2,500,000	Dakota/City	
23			Jurisdictional Classification			600,000	-	-	-	-	-	-	600,000	2,800,000	Dakota Co	
24			Safety and Management Projects			1,000,000	-	-	-	-	-	-	1,000,000	5,000,000	Dakota Co	
25			ROW Preservation & Management			1,000,000	-	-	-	-	-	-	1,000,000	5,000,000	Dakota Co	
26	6-06	CR 6	At CSAH 73 (Oakdale Ave)	Construction (for turnlane)	West St Paul	200,000	-	-	-	-	-	-	200,000	2,000,000	Dakota Co	
31	32-65	new 32	At CSAH 71 to TH 52	ROW Acquisition	Inver Grove Heights	1,000,000	-	-	-	-	-	-	1,000,000	5,800,000	Dakota Co	
37	50-21	CSAH 50	South of CSAH 60 to CSAH 9	ROW Acquisition	Lakeville	4,224,640	-	-	-	-	-	-	4,224,640	15,614,470	Dakota County	
39	78-06	new 78	235th/Denmark to TH 3	ROW Acquisition	Eureka/Castle Rock Twp	612,150	-	-	-	-	-	-	612,150	2,469,300	Dakota Co	
40	80-12	CSAH 80	CSAH 23 to TH 3	Construction	Eureka/Castle Rock Twp	5,356,000	-	-	-	-	-	-	5,356,000	7,042,800	Dakota Co	
41	80-21	CSAH 80	Replace Bridge L3164	Over Un-named Creek	Eureka/Castle Rock Twp	300,000	-	-	-	-	-	-	300,000	3,000,000	Dakota Co	
44			Future Studies/Professional Services			500,000	-	-	-	-	-	-	500,000	2,500,000	Dakota Co	
45			Township Road Distribution			20,900	-	-	-	-	-	-	20,900	104,500	Dakota Co	
46			Attorney Reimbursement			226,724	-	-	-	-	-	-	226,724	1,135,365	Dakota Co	
2016 County Funds Subtotal						17,050,414	2,983,090						14,067,324			
2016 County State Aid Highway (CSAH)																
49	8-20	CSAH 8	At CSAH 73 - Roundabout	Construction	West St Paul	800,000	36,000	720,000	-	44,000	-	-	-	1,000,000	Dakota Co	
51	9-36	CSAH 9	Indiana Ave/194th St to CSAH 60	Design	Lakeville	352,600	158,700	-	-	193,900	-	-	-	6,159,900	Dakota Co	
53	86-34	CSAH 86	CSAH 23 to TH 3	Design	Eureka, CR, Green, Water	285,600	-	-	-	285,600	-	-	-	5,761,700	Dakota Co	
56	26-47	CSAH 26	At TH 3 - Roundabout	Construction	Inver Grove Heights	2,900,000	652,500	-	1,447,500	800,000	-	-	-	2,900,000	MnDOT	
58	31-76	CSAH 31	CSAH 28 to Central Parkway	Construction	Eagan	2,500,000	-	-	-	2,500,000	-	-	-	3,250,000	Eagan	
61	30-26	CSAH 30	At CSAH 31	Signal Reconstruction	Eagan	300,000	-	-	-	300,000	-	-	-	300,000	Dakota Co	
63	31-79	CSAH 31	At CSAH 32 (Cliff Rd)	Signal Reconstruction	Eagan	300,000	-	-	-	300,000	-	-	-	300,000	Dakota Co	
65	32-78	CSAH 32	At IBSW Interchange	Construction	Burnsville	300,000	-	-	-	300,000	-	-	-	300,000	Burnsville	
78	63-25	CSAH 63	At TH 55 Intersection Area	Construction	Inver Grove Heights	4,000,000	1,800,000	-	-	2,200,000	-	-	-	5,200,000	Dak Co/MnDOT	
79	63-22	CSAH 63	N of CSAH 28 to N of CSAH 26	Construction	Inver Grove Heights	285,700	128,600	-	-	157,100	-	-	-	5,091,700	Dakota County	
82	73-19	CR 73	Bonaire Path to Ramt/GH line	Design	Rosemount	142,900	64,300	-	-	78,600	-	-	-	4,038,300	Dakota Co	
86-32	CSAH 86		TH 3 to west of CSAH 47	ROW Acquisition	CR, Waterford, Sciota	2,040,500	-	-	-	2,040,500	-	-	-	9,323,500	Dakota Co	
91-25	CSAH 91		TH 61 (240th St) to 3/4 mile north	Design	Milesville/Douglas Township	158,800	-	-	-	158,800	-	-	-	2,966,600	Dakota Co	
2016 CSAH Subtotal						14,366,100	2,840,100	720,000	1,447,500	9,358,500						
2016 County Fund & County State Aid Highway																
55	14-28	CSAH 14	14th Ave to 3rd Ave	Construction	South St Paul	4,000,000	1,800,000	-	-	2,000,000	-	-	200,000	5,120,000	Dakota Co	
83	86-29	CSAH 86	East of CSAH 47 to TH 52	Construction	CR, Ran, Sciota, Hampton	6,875,000	-	-	-	3,875,000	-	-	3,000,000	9,323,500	Dakota Co	
90			Highway Surface - Bituminous			2,420,000	-	-	-	-	170,000	-	-	12,100,000	Dakota Co	
91			Intersection Control			1,391,000	-	-	-	1,391,000	-	-	-	6,930,000	Dakota Co	
92			CSAH Maintenance			1,900,000	1,087,500	-	-	787,500	-	-	25,000	7,484,160	Dakota Co	
94			CIP Reimbursement to Operations			3,954,869	865,671	-	-	1,337,856	-	-	1,731,342	19,691,538	Dakota Co	
2016 County Funds & CSAH Subtotal						20,520,869	3,753,171			9,391,356	170,000		7,206,342			
2016 Total						51,937,383	9,576,361	720,000	1,447,500	18,749,856	170,000			21,273,666		

2014 - 2018 Transportation Capital Improvement Program

PAGE #	PROJECT NO.	ROAD/BUILDING	SEGMENT (FROM/TO)	PROJECT DESCRIPTION	PROJECT LOCATION	ANNUAL COST	CITY SHARE	FEDERAL	STATE	COUNTY STATE AID	GRAVEL TAX FOR CONST	OTHER	COUNTY COST	TOTAL LIFE PROJECT COST	LEAD AGENCY
2017 Section															
2017 County Funds Dollars															
17				Highway Surface - Gravel		700,000							700,000	2,800,000	Dakota Co
18				Highway Surface - Gravel		50,000							50,000	250,000	Dakota Co
19				Traffic Control Devices		700,000							700,000	1,750,000	Dakota Co
20				Bike Trail		60,000							60,000	3,500,000	City
21				Transect Infrastructure		500,000	200,000						300,000	300,000	City
22				Storm Sewer System Repair		600,000							600,000	2,500,000	Dakota/County
23				Jurisdictional Classification		1,000,000							1,000,000	2,800,000	Dakota Co
24				Safety and Management Projects		1,000,000	450,000						550,000	5,000,000	Dakota Co
25				ROW Preservation & Management		600,000							600,000	883,000	Dakota Co
26	28-48	CR 28		TH 3 to 0.62 mile east		4,000,000							4,000,000	1,656,000	IGH
29	32-65	new 32		Construction	Inver Grove Heights	12,500,000	3,125,000						9,375,000	5,800,000	Dakota Co
31	42-82	CSAH 42		Construction	Inver Grove Heights	10,513,760	4,731,190						5,782,570	15,614,470	Dakota County
33	50-21	CSAH 50		Construction	Rosemount	1,734,750	225,000						1,509,750	2,469,300	Dakota County
37	78-06	new 78		Construction	Eureka/Castle Rock Twp	500,000							500,000	2,500,000	Dakota Co
39				Future Studies/Professional Services		20,900							20,900	104,500	Dakota Co
44				Township Road Distribution		235,793							235,793	1,135,365	Dakota Co
45				Attorney Reimbursement		35,065,203	8,848,190						26,217,013		
46					2017 County Funds Subtotal										
48	5-47	CSAH 5		Intersection/Signal Reconstruct	Burnsville	667,000	300,000			367,000				667,000	Dakota Co
51	9-36	CSAH 9		ROW Acquisition	Lakeville	1,574,700	708,600			866,100				6,159,900	Dakota Co
53	86-34	CSAH 86		ROW Acquisition	Eureka, Ct, Green, Water	1,428,300				1,428,300				5,761,700	Dakota Co
60	30-19	CSAH 30		Signal Reacquisition	Eagan	100,440				100,440				100,440	MnDOT
62	30-29	CSAH 30		Signal Reacquisition	Eagan	265,000				265,000				265,000	Dakota Co
79	63-22	CSAH 63		ROW Acquisition	Inver Grove Heights	1,377,600	619,900			757,700				5,091,700	Dakota County
82	73-19	CR 73		ROW Acquisition	Rosemount	771,200	347,000			424,200				4,038,300	Dakota County
85	91-25	CSAH 91		ROW Acquisition	Miesville/Douglas Township	557,800				557,800				2,966,600	Dakota Co
					2017 CSAH Subtotal	6,742,040	2,108,000			4,634,040					
50	8-21	CSAH 8		CSAH 62 (Delaware) to Humboldt A Design	West St Paul	272,200	122,500							1,578,200	Dakota Co
86-32	CSAH 86			TH 3 to west of CSAH 47 Construction	CR, Waterford, Sciota	6,875,000				3,875,000			149,700	9,323,500	Dakota Co
90				Highway Surface - Bituminous		2,420,000								12,100,000	Dakota Co
91				Highway Surface - Bituminous		1,419,000					170,000			2,250,000	Dakota Co
92				Intersection Control		1,167,560				1,419,000				6,930,000	Dakota Co
93				Highway - Replacement		5,000,000	655,000			487,560				7,484,160	Dakota Co
94				CIP Reimbursement to Operations		4,052,915	891,641			1,377,991			25,000	20,000,000	Dakota Co
					2017 County Funds & CSAH Subtotal	21,206,675	1,669,141			7,159,551	170,000			19,691,538	Dakota Co
					2017 Total	69,013,918	12,625,331			11,793,591	170,000			38,424,996	

2015 CAPITAL BUDGET

and 2015 - 2019 TRANSPORTATION CAPITAL IMPROVEMENT PROGRAM

I. Description and Location:
 REPLACEMENT: Roadway Replacement
 Reconstruction of CSAH 86 (280th St) from TH 3to west of CSAH 47 (Northfield Blvd) in Castle Rock,
 Waterford and Sciota Townships.
 2015 - Design
 2016 - Right of Way Acquisition
 2017 - Construction

Department: Transportation
Project Location: CR, Waterford, Sciota
Project Descr: Design/ROW Acquisition/Construction
Center No: T86032
Useful Life: 40 Years
Project Type: Replacement: - Roadway Reconstruction
Priority: High

III. Impact on Operating and Maintenance Costs:
 Additional shoulder and turn lane maintenance.

II. Purpose and Justification:

This project will improve CSAH 86 roadway operations, make safety improvements and provide for the increased traffic levels.

IV. Effect on County Revenues:
 Increase of \$6,526,405 State Aid.

Project Revenues	Prior to 2015 Revenues	2015	2016	2017	2018	2019	Beyond 2019	Total Project
Property Tax		\$122,400	\$612,150	\$2,062,500				\$2,797,050
Federal								
State/Metro		\$285,600	\$1,428,350	\$4,812,500				\$6,526,450
Other								
Total		\$408,000	\$2,040,500	\$6,875,000				\$9,323,500
Project Expenditures	Prior to 2015 Expenses	2015	2016	2017	2018	2019	Beyond 2019	Total Project
Land Acquisition			\$2,040,500					\$2,040,500
New Construction				\$6,875,000				\$6,875,000
Modifications/Repairs								
Consulting Services		\$408,000						\$408,000
Other								
Total		\$408,000	\$2,040,500	\$6,875,000				\$9,323,500



Physical Development Division

Dakota County
Western Service Center
14955 Galaxie Avenue
Apple Valley, MN 55124-8579

952.891.7000
Fax 952.891.7031
www.dakotacounty.us

Environmental Resources

*Land Conservation
Groundwater Protection
Surface Water
Waste Regulation
Environmental Initiatives*

Office of Planning

Operations Management

*Facilities Management
Fleet Management
Parks*

Transportation

*Highways
Surveyor's Office
Transit Office*

November 24, 2014

Elaine Koutsoukos, Transportation Coordinator
Transportation Advisory Board
Metropolitan Council
390 North Robert Street
St. Paul, MN 55101

RE: Federal STP Letter of Funding and Maintenance for
CSAH 86 Roadway Reconstruction/Modernization Project

Dear Ms. Koutsoukos:

The County Board of Commissioners has committed to contribute funds toward the construction of the proposed CSAH 86 (280th Street) construction project.

Dakota County is the agency with jurisdiction over the CSAH 86 roadway and is submitting the project for federal funds. Dakota County commits to operate and maintain CSAH 86 for its useful life and not change the use of any right-of-way acquired without prior approval from the Minnesota Department of Transportation and the Federal Highway Administration.

We will be happy to answer any questions you may have regarding this project.

Sincerely,

Mark J. Krebsbach, P.E.
Transportation Director/County Engineer

DAKOTA COUNTY PHYSICAL DEVELOPMENT COMMITTEE

Approval Of Grant Application Submittals For Transportation Advisory Board 2014 Federal Funding Solicitation Process

Meeting Date: 11/18/2014	Fiscal/FTE Impact:
Item Type: Regular-Action	<input type="checkbox"/> None <input checked="" type="checkbox"/> Other
Division: Physical Development	<input type="checkbox"/> Current budget <input type="checkbox"/> Amendment requested
Department: Physical Development Administration	<input type="checkbox"/> New FTE(s) requested
Contact: Stwora, Erin	Board Goal: Thriving People
Contact Phone: (952) 891-7153	
Prepared by: Mertens, John	

PURPOSE/ACTION REQUESTED

Approve projects to be submitted to the Transportation Advisory Board (TAB) for Federal Funding through Moving Ahead for Progress in the 21st Century Act (MAP-21).

SUMMARY

The TAB is requesting project submittals for MAP-21 funding through the Regional Solicitation process. MAP-21 funding provides up to 80 percent of the project construction cost. Agencies applying for funding must commit to providing local funds to match the federal funds and maintaining the constructed facilities for their useful life. Projects are being considered for federal fiscal years 2017, 2018 and 2019. Project submittals are due December 1, 2014.

This is the first Regional Solicitation since the adoption of Thrive MSP 2040. The solicitation and the criteria by which the applications will be scored have been modified by the TAB to more closely align with Thrive MSP 2040. In addition, the solicitation has been restructured so that projects will now be submitted and evaluated based on mode (Roadways, Bicycle and Pedestrian Facilities, and Transit) instead of federal funding categories.

Staff is proposing to submit fifteen applications through this process (Attachments A, C and D). This includes eleven Roadway projects and four Bicycle and Pedestrian Facilities projects. Staff will prepare these applications in partnership with affected cities and the Minnesota Department of Transportation (Mn/DOT). All proposed projects are consistent with the adopted Dakota County Comprehensive Plan. Project numbers 2 and 7 are not in the current 2014-2018 Capital Improvement Program (CIP), but they are included in the proposed 2015-2019 CIP. Project numbers 10, 11, 12, 13 and 14 are not in the current CIP or the proposed 2015-2019 CIP. Should the County be awarded funding for these projects, they will be included in the proposed 2016-2020 CIP for the Board's consideration.

Dakota County works with communities to submit projects that share common goals. The eight projects listed in Attachment B (County Supported 2014 Regional Solicitation Applications) and shown in Attachment E will be submitted by our partners. These applications include a Transit project to be submitted by the Minnesota Valley Transit Authority (MVTA) and seven Bicycle and Pedestrian Facilities projects to be submitted by cities. Dakota County will provide grant writing assistance and assume the 20% local match requirement for greenway projects. For non-greenway projects, Dakota County will provide matching funds consistent with the Dakota County transportation cost share policy.

RECOMMENDATION

Staff recommends submittal of fifteen project applications to the TAB for federal funding through the MAP-21 Regional Solicitation, and support for eight applications to be submitted by cities and MVTA.

EXPLANATION OF FISCAL/FTE IMPACTS

The applications for projects within cities will require a letter from the city indicating support for the project and a commitment to pay their share of the matching funds. Local match is at least 20% and will be provided out of the Transportation or Parks CIP consistent with County cost participation policies.

Supporting Documents:

Attachment A – County-Lead 2014 Regional Solicitation Applications
 Attachment B – City-Lead 2014 Regional Solicitation Applications
 Attachment C – Location Map: Roadway Applications
 Attachment D – Location Map: Trails and Pedestrian Facilities
 Attachment E – Location Map: County Supported 2014 Applications

Previous Board Action(s):**RESOLUTION**

WHEREAS, the Transportation Advisory Board (TAB) is requesting project submittals for federal funding under the Moving Ahead for Progress in the 21st Century Act (MAP-21); and

WHEREAS, these federal programs fund up to 80 percent of project construction costs; and

WHEREAS, federal funding of projects reduces the burden local taxpayers for regional improvements; and

WHEREAS, non-federal funds must be at least 20 percent of the project costs; and

WHEREAS, project submittals are due on December 1, 2014; and

WHEREAS, all projects proposed are consistent with the adopted Dakota County Comprehensive Plan.

NOW, THEREFORE, BE IT RESOLVED, That the Dakota County Board of Commissioners hereby approves the following County lead projects for submittal to the TAB for federal funding:

1. County State Aid Highway (CSAH) 9 (Dodd Boulevard) from Hayes Avenue to CSAH 23 (Cedar Avenue) in Lakeville
2. CSAH 26 (Lone Oak Road) at its intersection with CSAH 43 (Lexington Avenue) in Eagan
3. CSAH 26 (70th Street) at its intersection with Trunk Highway (TH) 3 in Inver Grove Heights
4. CSAH 28/63 (Yankee Doodle Road/Argenta Trail) from south of TH 55 to south of CSAH 26 (70th Street)
5. CSAH 31 (Pilot Knob Road) from I-35E to north of Central Parkway in Eagan
6. CSAH 42 (145th Street East) at its interchange with TH 52 in Rosemount
7. CSAH 23 (Foliage Avenue) from CSAH 86 (280th Street) to CR 96 (320th Street) in Greenvale Township
8. CSAH 86 (280th Street) from CSAH 23 (Galaxie Avenue) to TH 3 in Eureka, Greenvale, Castle Rock, and Waterford Townships
9. CSAH 86 (280th Street) from TH 3 to CSAH 47(Northfield Blvd) in Castle Rock, Waterford, and Sciota Townships
10. CSAH 31 and CSAH 46 Advanced Traffic Management System for 16 Signals
11. CSAH 26, CSAH 28, CSAH 31, and CSAH 43 Advanced Traffic Management System for 25 Signals
12. Mississippi River Regional Trail – Rosemount East
13. Minnesota River Greenway – Eagan South
14. North Creek Greenway – CSAH 42 Underpass east of Flagstaff in Apple Valley
15. CSAH 14 (Southview Boulevard) from 14th Avenue to 3rd Avenue in South St. Paul; and

BE IT FURTHER RESOLVED, That, subject to federal funding award, the Dakota County Board of Commissioners would be asked to consider authorization to execute the grant agreement at a future meeting; and

BE IT FURTHER RESOLVED, That the Dakota County Board of Commissioners hereby supports the following submittals by others:

16. Apple Valley Transit Station Parking Expansion – Lead Agency: Minnesota Valley Transit Authority
17. CSAH 73 (Oakdale Ave) Trail from CSAH 14 to CSAH 8 – Lead Agency: West St. Paul
18. River to River Greenway Robert Street Pedestrian Bridge – Lead Agency: West St. Paul
19. North Creek Greenway – Farmington Gap – Lead Agency: Farmington
20. Lake Marion Greenway – Sunset Park to Murphy Hanrehan Regional Park – Lead Agency: Burnsville
21. Lake Marion Greenway – Ritter Farm Park Connection – Lead Agency: Lakeville
22. Rosemount Greenway – Downtown Rosemount to Lebanon Hills – Lead Agency: Rosemount
23. Vermillion Highlands Greenway – CSAH 42 Underpass at Akron- Lead Agency : Rosemount; and

BE IT FURTHER RESOLVED, That, subject to federal funding award of the city lead projects, the Dakota County Board of Commissioners will provide the local match for regional greenway projects, and for non-greenway projects will provide Dakota County's share of the matching funds consistent with Dakota County transportation cost share policies.

County Manager's Comments:

- Recommend Action
- Do Not Recommend Action
- Reviewed---No Recommendation
- Reviewed---Information Only
- Submitted at Commissioner Request

Reviewed by (if required):

- County Attorney's Office
- Financial Services
- Risk Management
- Employee Relations
- Information Technology
- Facilities Management



County Manager

2014 Regional Solicitation Applications

Roadway Projects

Expansion Projects

- 1. CSAH 9 (Dodd Blvd)
- 2. CSAH 26 (Lone Oak Rd)
- 3. CSAH 26 (70th St.)
- 4. CSAH 28/CSAH 63
- 5. CSAH 31
- 6. CSAH 42

Reconstruction/Modernization

- 7. CSAH 23
- 8. CSAH 86 - West
- 9. CSAH - East

Roadway System Management

- 10. CSAH 31/CSAH 46
- 11. CSAH 26, 28, 31, 43

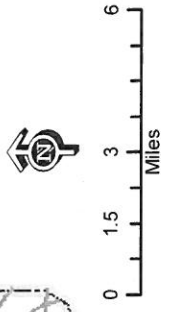
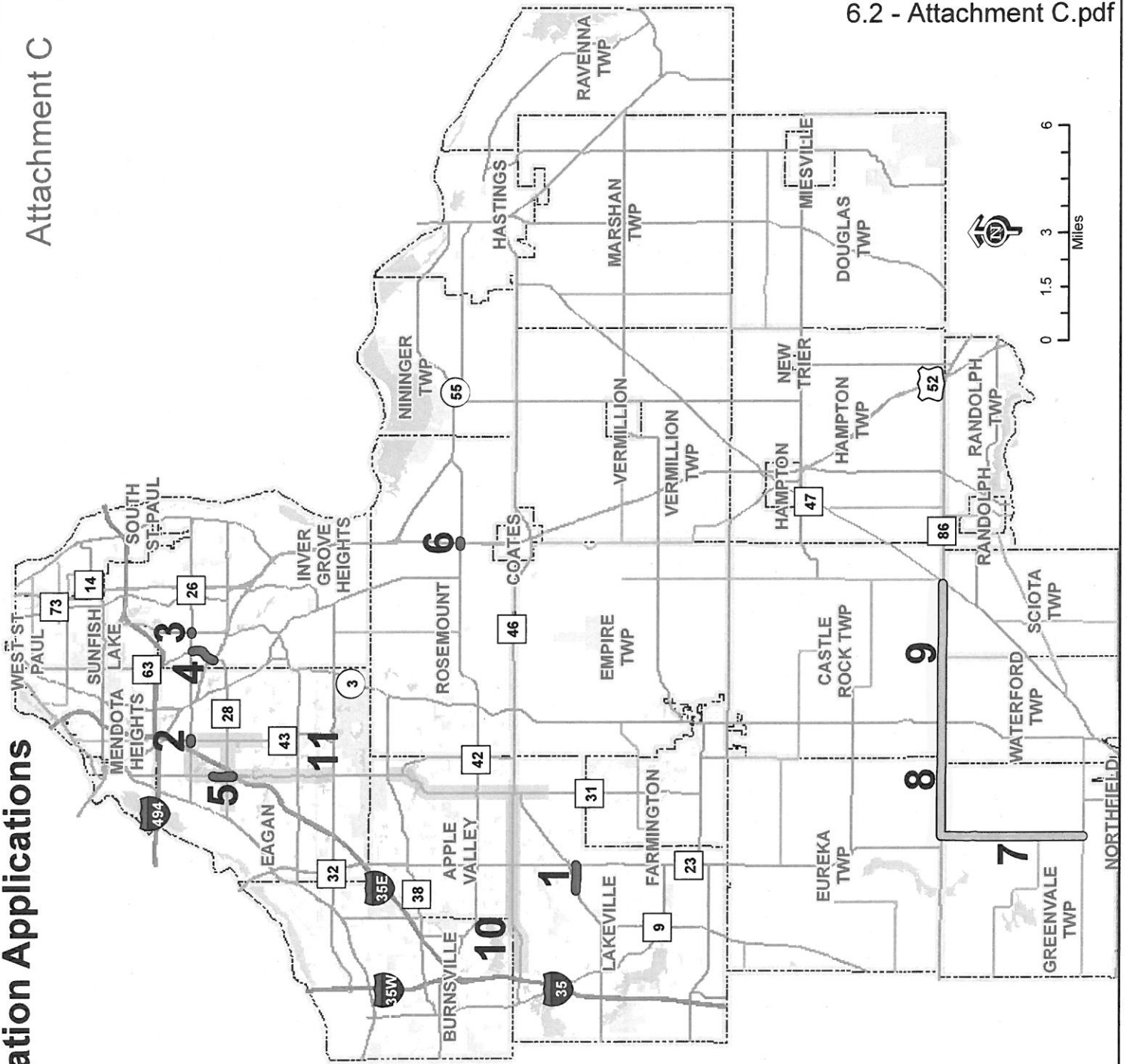

Future Studies

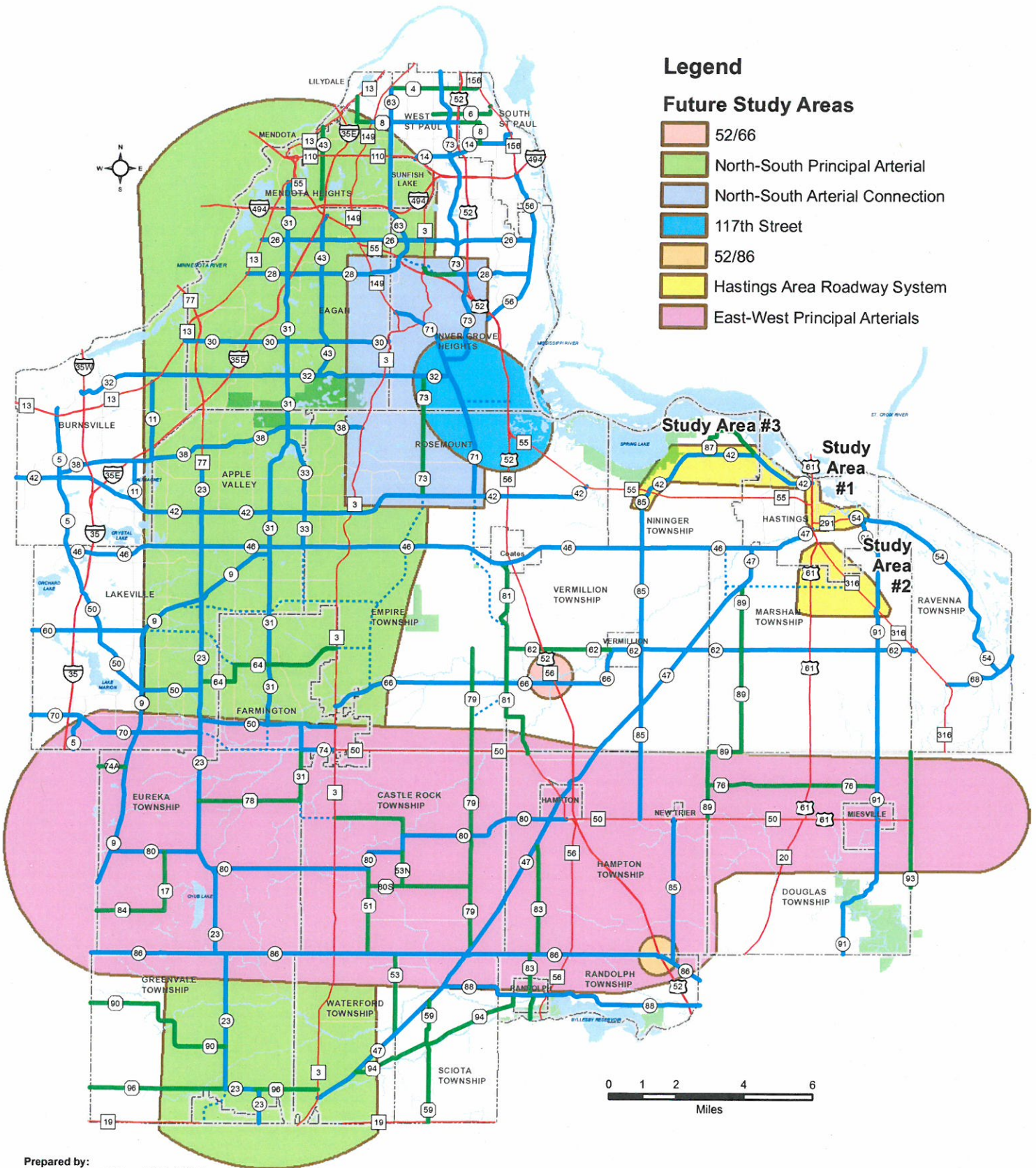

Dakota County 2030 Transportation Plan - Figure 46

10-Ton Highways

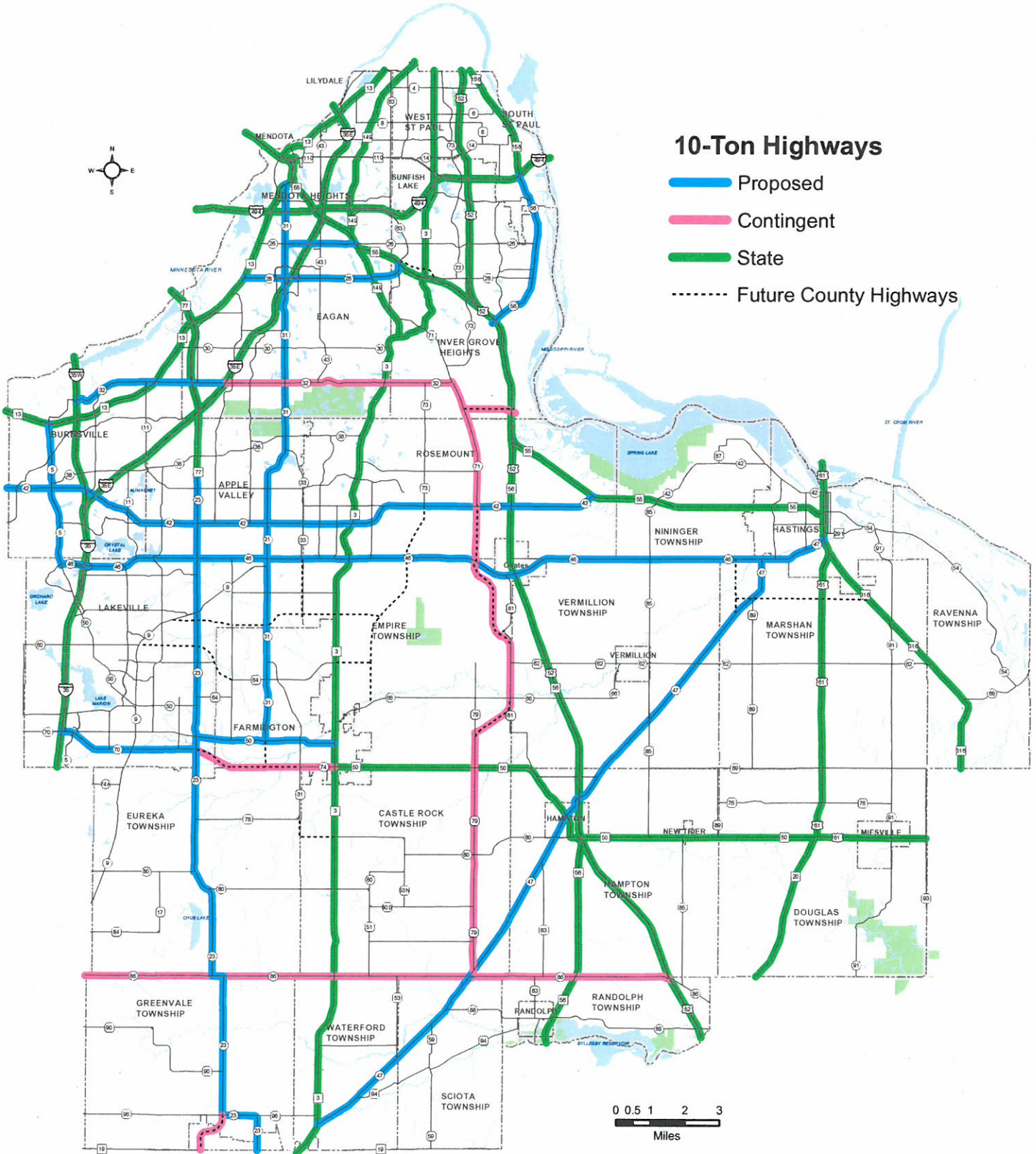

Prepared by:
Dakota County Office of GIS, 1/2012.

Addressing the Issues

The following are potential actions and revisions to the Plan to address these issues.

Gravel Roads Maintenance Costs

- The County now uses lime rock in place of gravel for gravel road surfaces. Lime rock has proven to last longer and can accommodate a greater number of vehicles than gravel without substantial maintenance needs.

Signal Age and Replacement Needs

- County staff will evaluate alternatives to address County signal system aging issues including full or partial replacements.

Highway Replacement and Reconstruction

The County highway system consists of County State Aid Highways (CSAH) and County Roads (CR). The County will reconstruct highways when they have exceeded their functional lives. The highway useful life is based on the adequacy of structural, operational or functional highway elements. Safety and operational improvements are also incorporated into reconstruction projects when appropriate. Even with proactive preservation, eventually highway replacement becomes the most cost-effective approach and introduces state of the art design, construction and operation. The County considers the general expected highway life to be 70 years. The current Dakota County highway system age is shown by highway segment in Figure 40.



Highway age will be one factor in considering reconstruction (replacement) needs of the highway. Additional analysis including assessment of safety and the structure of the individual highway segments will be conducted to better determine the actual replacement needs. Future prioritization and timing of projects will still be based on a number of factors per Plan policies.

The following are the estimated annual CIP investments for highway replacement over the plan period including estimated investments for County Roads:

- 2011-2015 = \$5.0 million (\$2.5 million for County Roads)*
- 2016-2020 = \$12.4 million (\$1.1 County Roads)*
- 2021-2030 = \$8.7 million (\$0.2 million for County Roads)*

*Figures based on existing information. Additional safety and structural analysis to be completed.

The following **policy** supports replacement and reconstruction of deficient highway elements of the system.

R.1 Highway Replacement

Reconstruct highways or highway elements that have exceeded their useful life based on structural, functional, operational or safety factors.

Dakota County Road Age

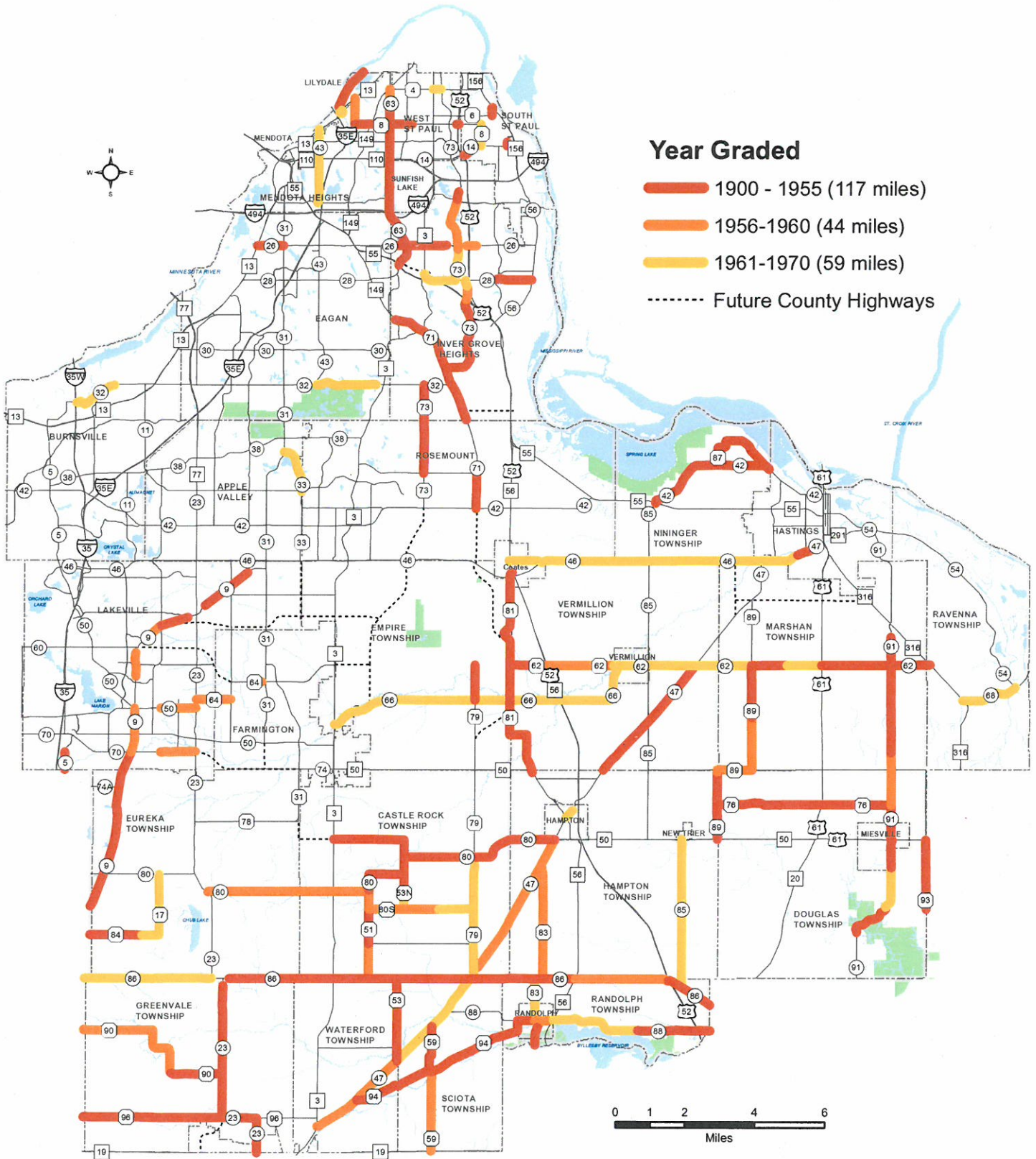

Prepared by:
Dakota County Office of GIS, 1/2012.

Future Studies

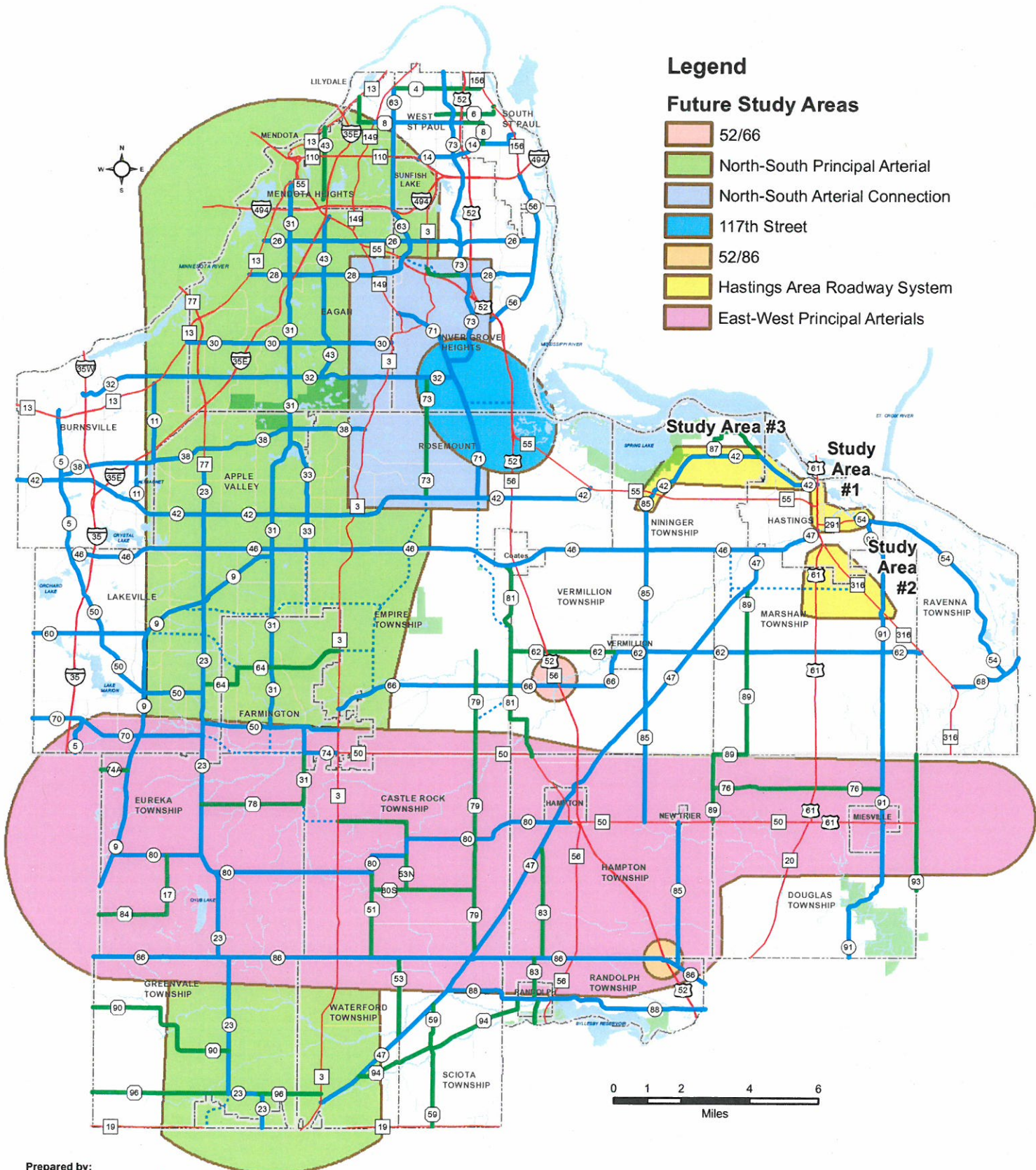

Legend

Future Study Areas

- 52/66
- North-South Principal Arterial
- North-South Arterial Connection
- 117th Street
- 52/86
- Hastings Area Roadway System
- East-West Principal Arterials

Prepared by:
Dakota County Office of GIS, 9/2011.

Dakota County 2030 Transportation Plan - Figure 46

Dakota County

COUNTY ROADWAY

July 2013

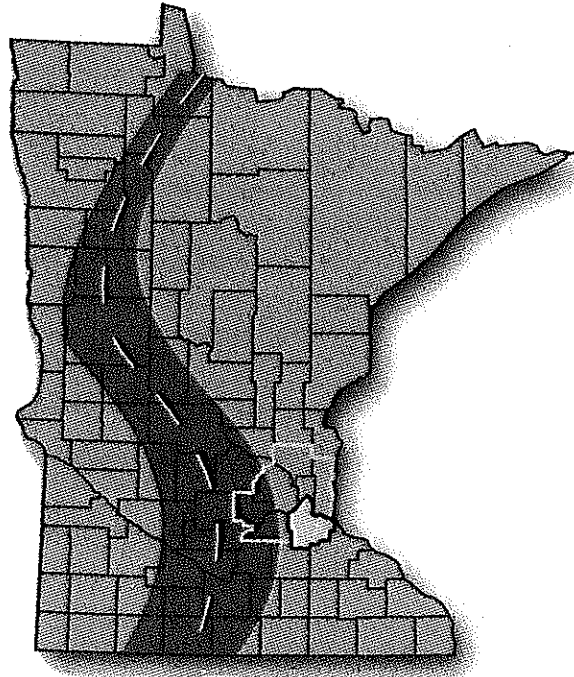

Dakota
COUNTY

Safety PLAN

Moving Toward **ZERO** Deaths

Prepared by:
CH2M HILL
SRF Consulting Group, Inc.

CSAH 86 from CSAH 23 (EAST) to CSAH-47 Project

Agency: Dakota County

Roadway Data

Type: CSAH
 Number: 86
Verbal
 Start: CSAH 23 (EAST)
 End: CSAH-47
 City/Rural: Rural
 County: Dakota
 ATP: Metro
 ADT: 3295
 Facility Type: 2-Lane
 Lane Width: 12'
 Speed Limit: 55
 Shoulder Width: 2'
 Shoulder Type: Aggregate
 Length (miles): 7.1
 Rumble Installed: No

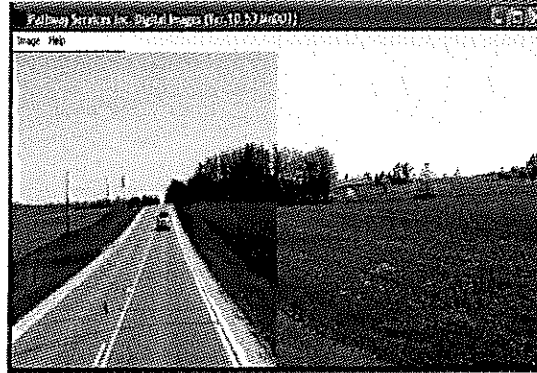

Crash Data

2007-2011 MnCMAT Crash Data

5 years

	Total	Lane Dept	Severe HO/SSO	K+A
Crashes	31	9	0	1
Density (per mile per year)	0.87	0.25	0.00	0.03
Rate (per MVM)	0.73	0.21	0.00	0.02

Ranking Criteria

	Value	Critical	Road Departure Risk Ranking
ADT Range	3,295	> 3,000	★
Lane Departure Density	0.25	0.55	
Access Density	18.7	14.90	★
Curve Critical Radius Density	0.14	0.32	
Edge Risk	2	2 or 3	★
			★★★

Short List of Strategies Considered

Description	Type	Cost per mi	Mileage	Cost	Notes -
2' Shoulder Pave+RS+Safety Wedge	Proactive	\$40,000	0.0	\$0	
Rumble Strip	Proactive	\$3,000	0.0	\$0	
Rumble StripE	Proactive	\$3,500	7.1	\$24,850	
6" Edge Lines	Proactive	\$650	0.0	\$0	
Ground In Wet-Reflective Markings	Proactive	\$8,500	0.0	\$0	
Center Line Rumble Strip	Proactive	\$3,000	7.1	\$21,300	
4' Buffer w/Centerline Rumble Strips	Proactive	\$150,000	0.0	\$0	
12' Painted Median w/Left Turn Lanes	Proactive	\$500,000	0.0	\$0	

Implementation Cost

Federal Funds	\$41,535
Local Match (10% of Total project cost)	\$4,615
Total Project Cost	\$46,150

Page: 10
 Segment ID: 86.02
 Date: 7/17/2013

Roadway Area Definition

Roadway Reconstruction/Modernization Project: Cсах86 TH3 to Cсах47 | Map ID: 1419954070337

Results

Project Length: 3.89 miles

Project Area: 32.209 sq mi

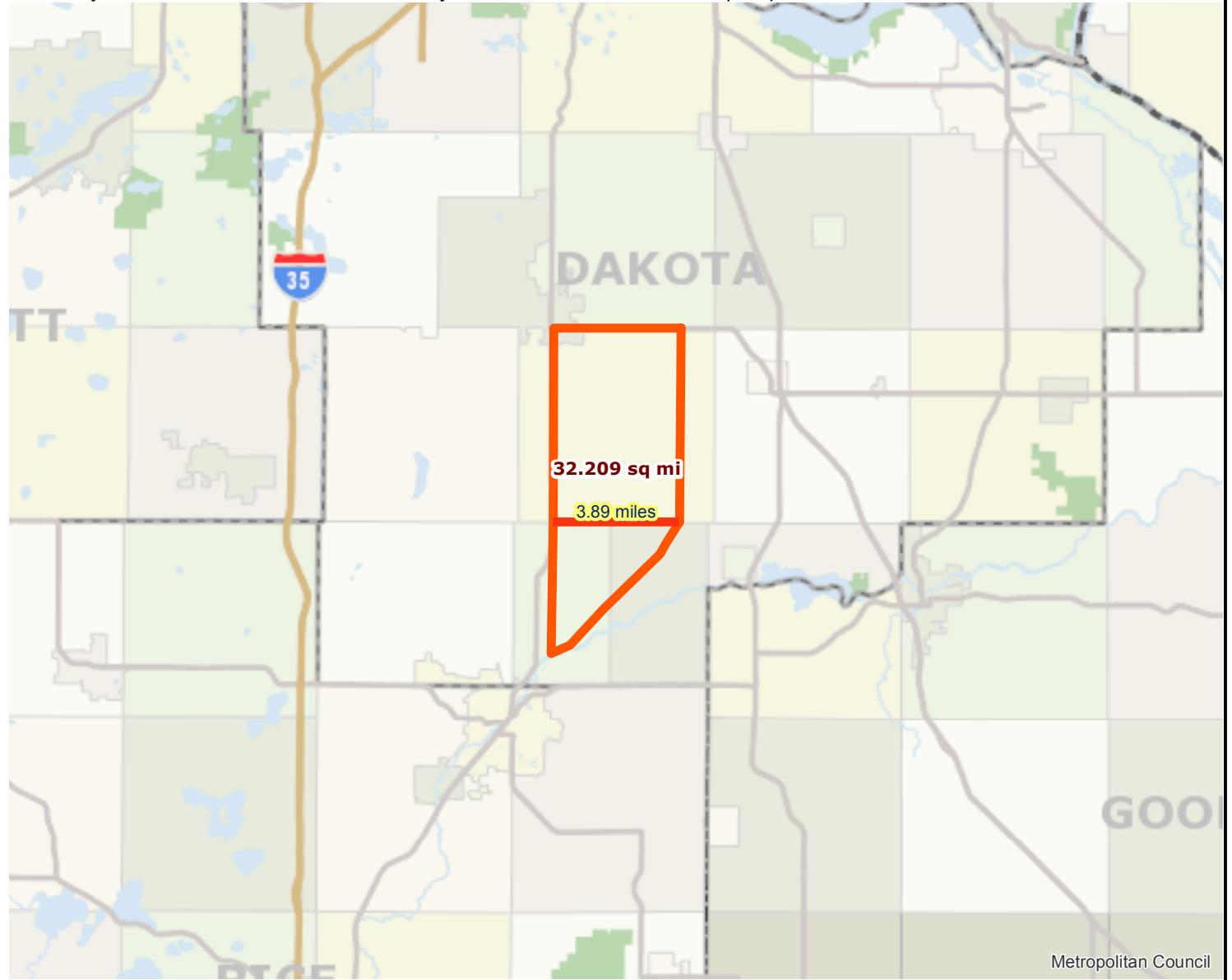

— Project

□ Project Area

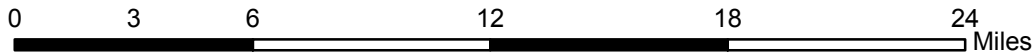

Created: 12/30/2014
LandscapeRSA1



For complete disclaimer of accuracy, please visit
<http://giswebsite.metc.state.mn.us/gissitenew/notice.aspx>





Minnesota Department of Transportation

Metro District

1500 West County Road B-2

Roseville, MN 55111

November 25, 2014

Brian K. Sorenson, PE
Assistant County Engineer
Dakota County Transportation Department
14955 Galaxie Avenue
Apple Valley, MN 55124

RE: Regional Solicitation Application to Reconstruct CSAH 86 from Hwy 3 to CSAH 47

Dear Mr. Sorenson:

Thank you for requesting a letter of support from MnDOT for the Metropolitan Council's 2014 Regional Solicitation. Your application to reconstruct CSAH 86 from Hwy 3 to CSAH 47 impacts MnDOT right of way on Hwy 3.

As the agency with jurisdiction over Hwy 3, MnDOT supports the application for reconstruction. Details of any future maintenance agreement with the county will be determined during project development.

This project currently has no funding from MnDOT.

Sincerely,

A handwritten signature in blue ink that reads "Scott McBride".

Scott McBride, P.E.
Metro District Engineer

Cc: Elaine Koustoukos, Metropolitan Council
Jon Solberg, MnDOT Metro District - South Area Manager

An Equal Opportunity Employer



Regional Economy

Roadway Reconstruction/Modernization Project: Cсах86 TH3 to Cсах47 | Map ID: 1419954070337



Results

Project **NOT IN** area of Job Concentration.

Project **NOT IN** to area of Manufacturing and Distribution.

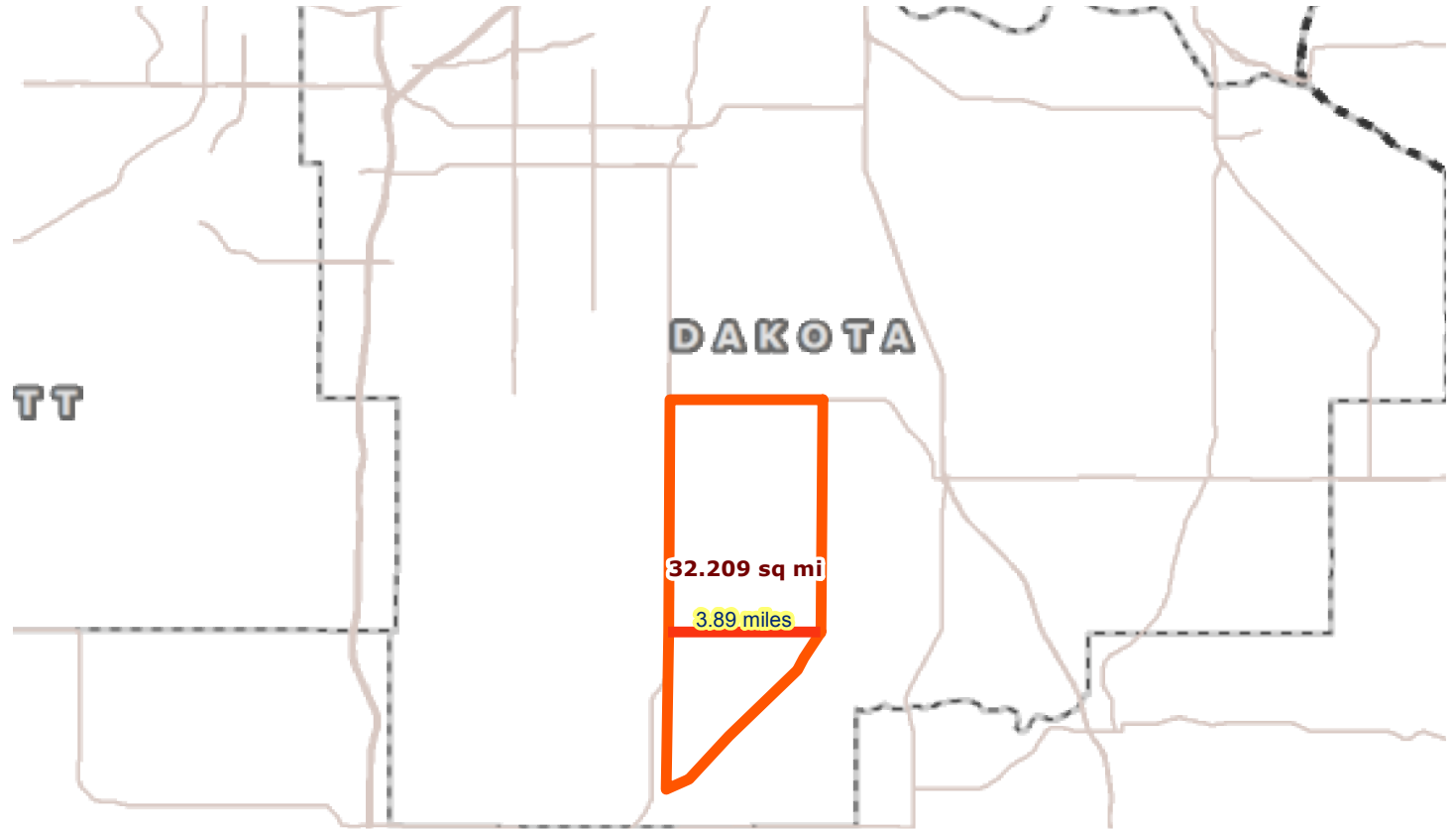
Project **NOT CONNECTED** to area of Education Institutions.



-  Project
-  Project Area

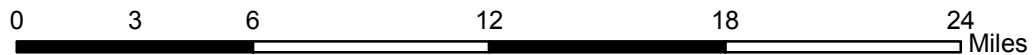

Created: 12/30/2014
LandscapeRSA5



For complete disclaimer of accuracy, please visit
<http://giswebsite.metc.state.mn.us/gissitenew/notice.aspx>



Dakota County Road Age

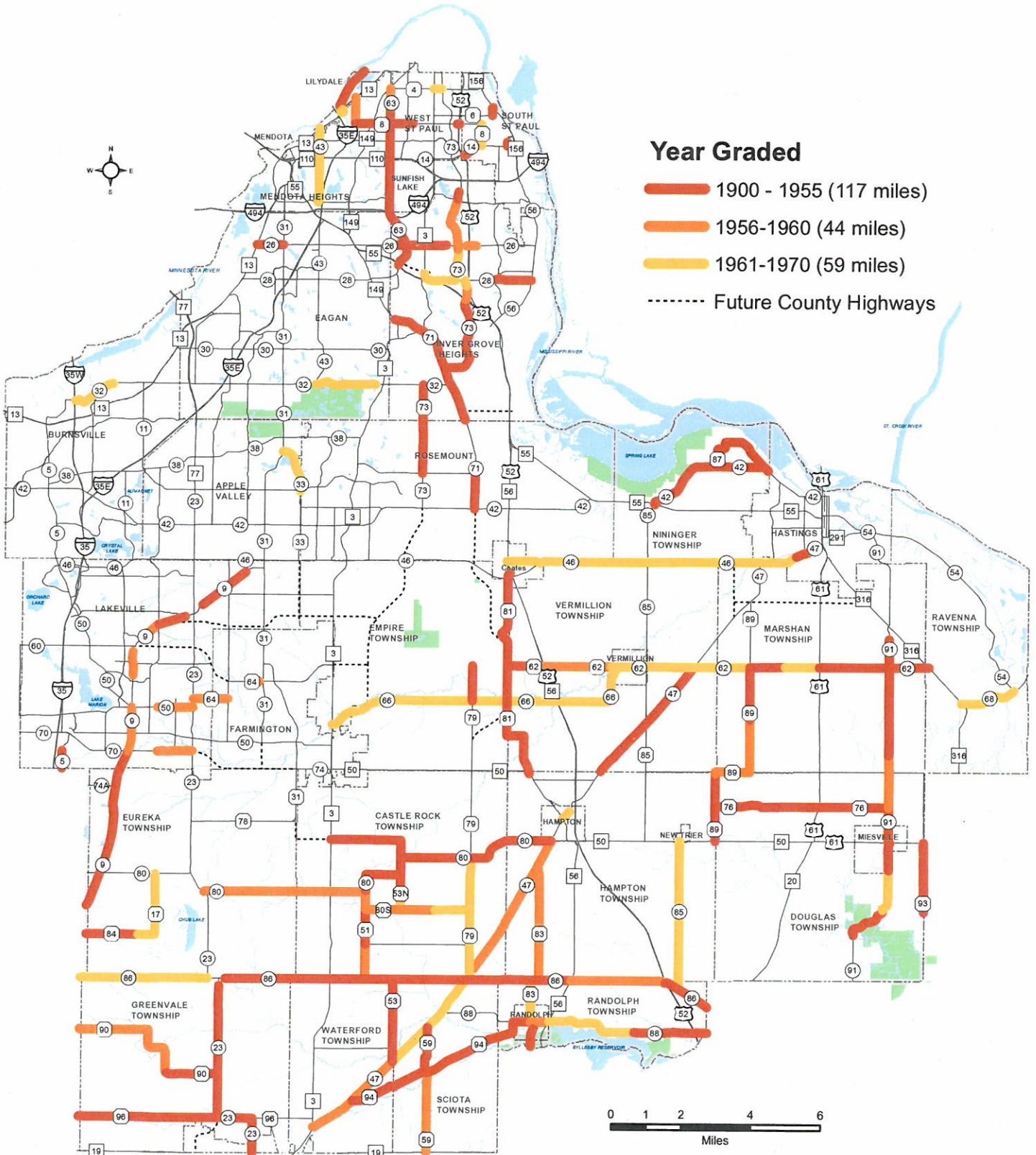

Prepared by:
Dakota County Office of GIS, 1/2012.

Roadway Reconstruction/Modernization:



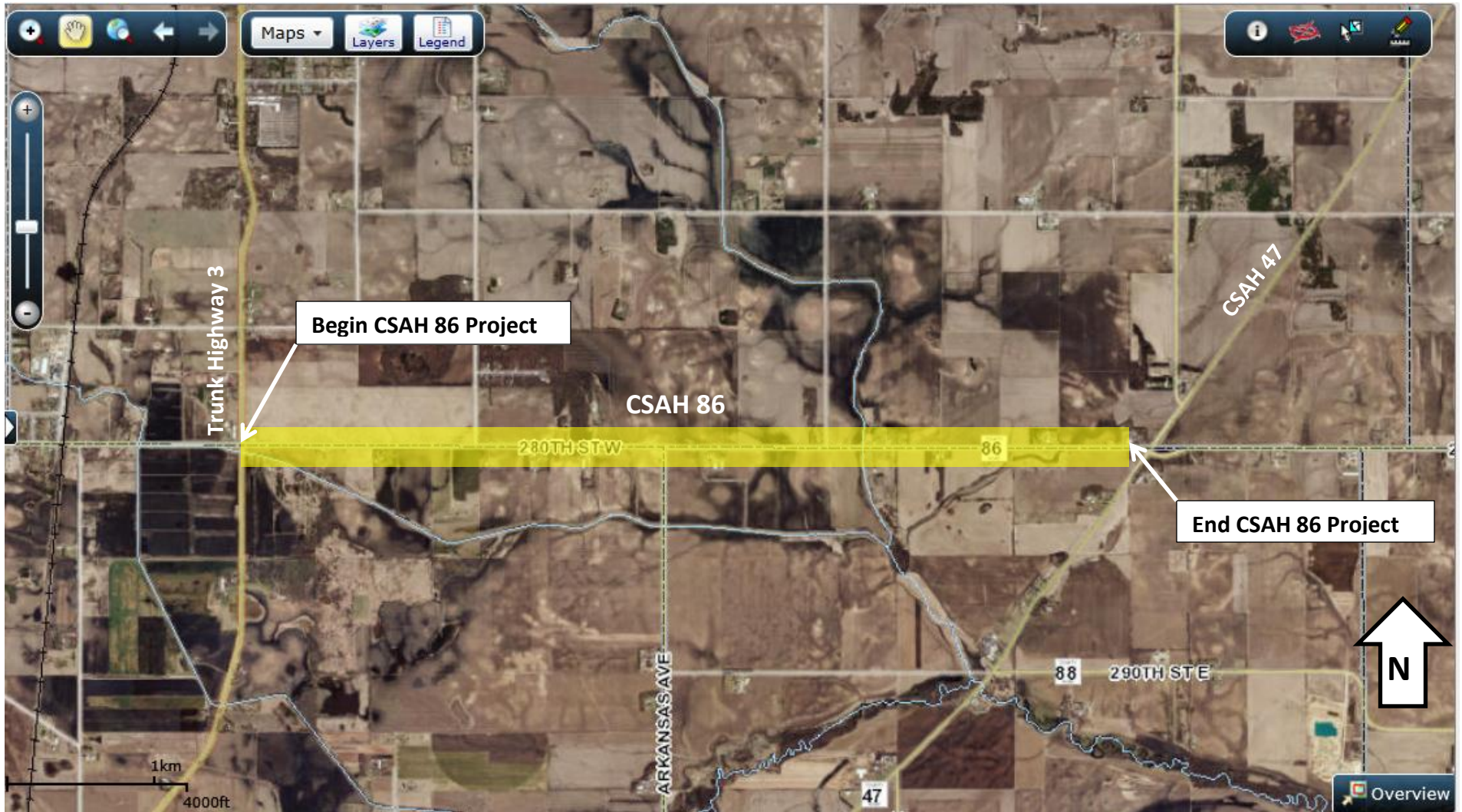

CSAH 86 Project Limits from east intersection of Trunk Highway 3 to CSAH 47 in Castle Rock, Waterford & Sciota Township

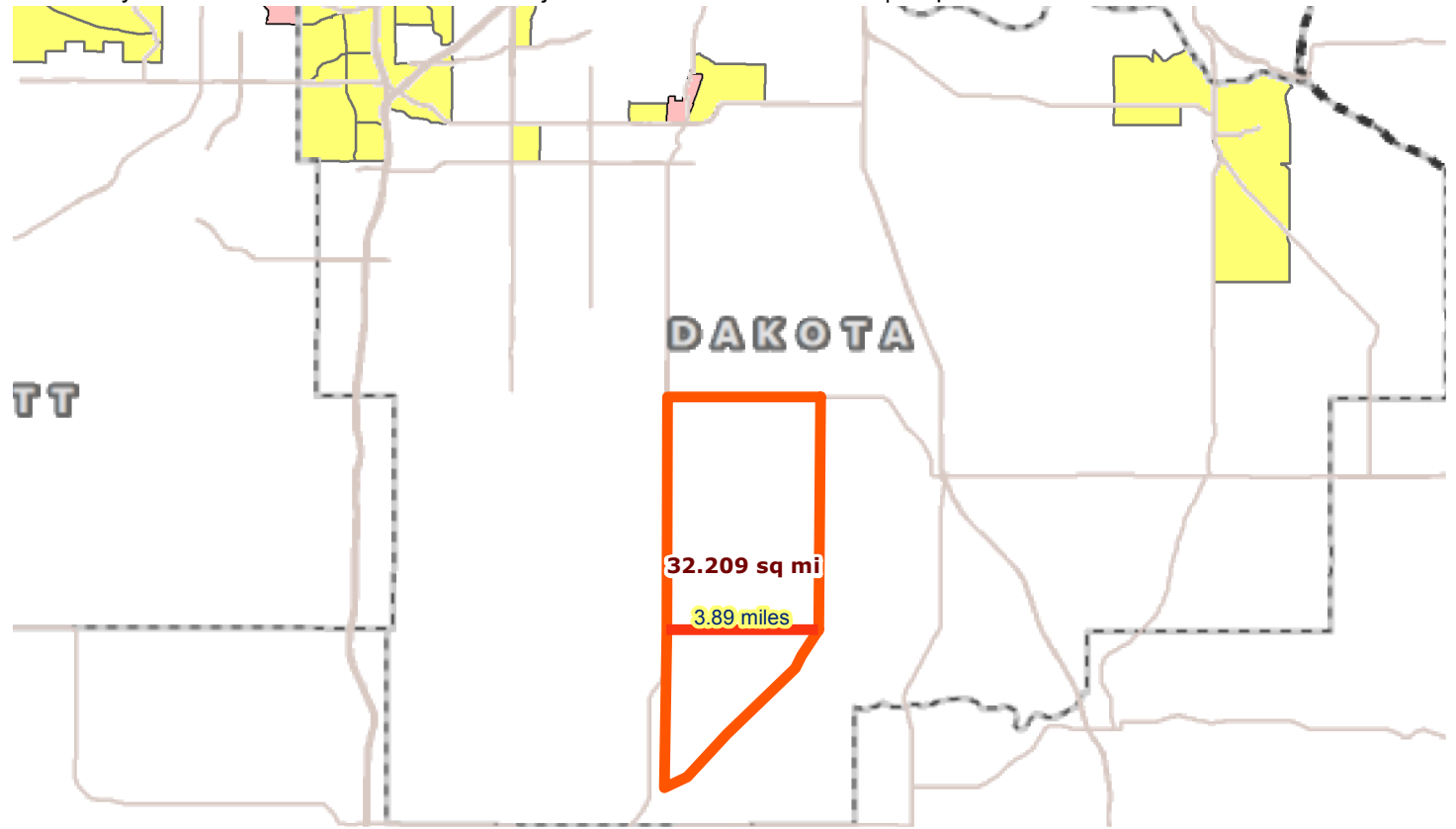

Results

Project **NOT IN** any area of concentrated poverty.



-  Project
-  Racially concentrated area of poverty
-  Above reg'l avg conc of race/poverty
-  Project Area
-  Concentrated area of poverty

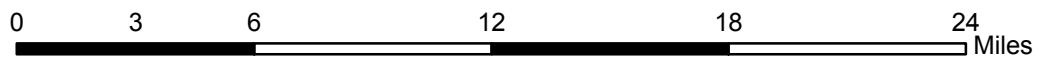

Created: 12/30/2014
LandscapeRSA2



For complete disclaimer of accuracy, please visit <http://giswebsite.metc.state.mn.us/gissitenew/notice.aspx>



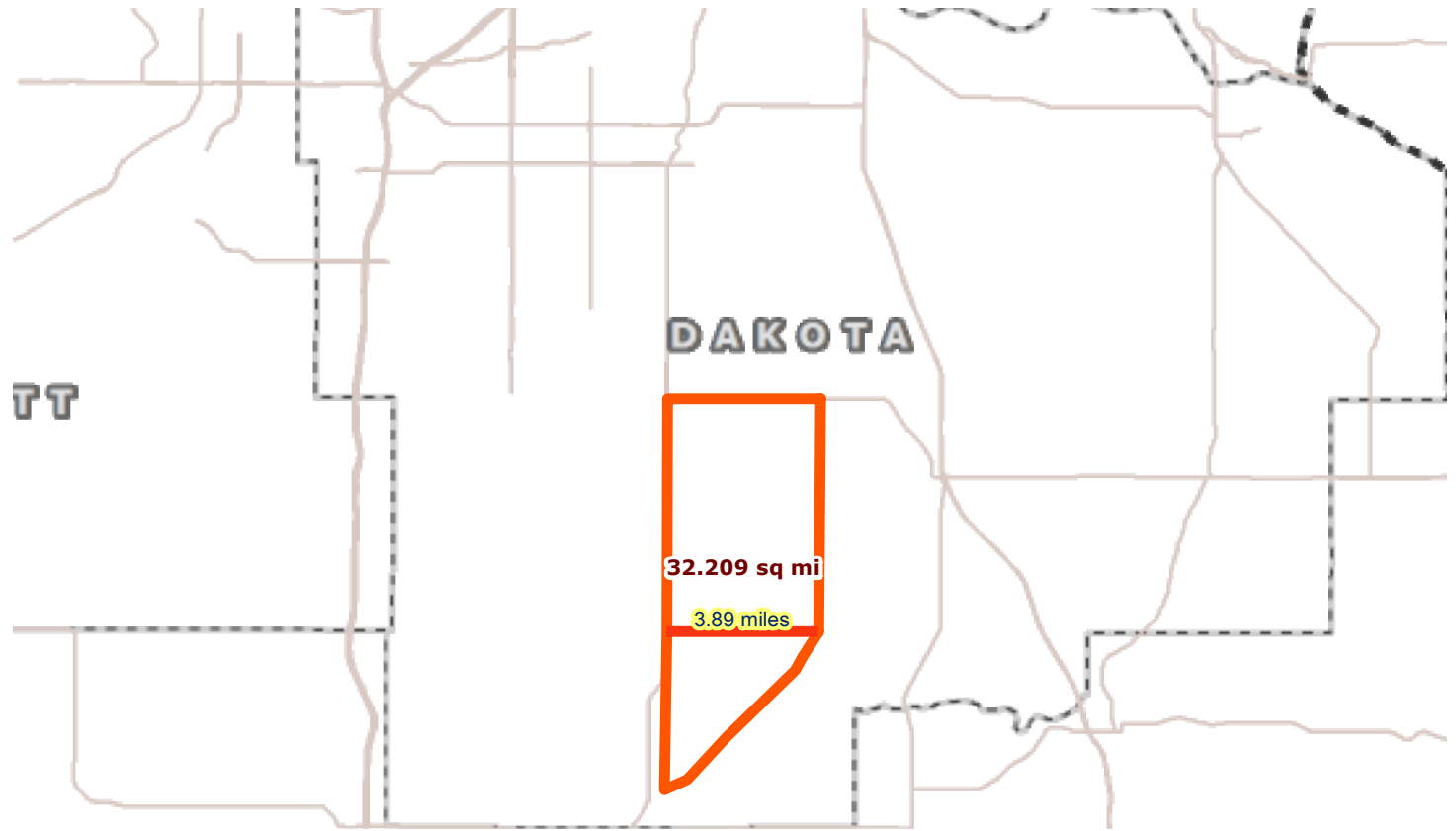



Results

Transit with a Direct Connection to project:
-- NONE --

**indicates Planned Alignments*

-  Project
-  Project Area



Created: 12/30/2014
LandscapeRSA3



For complete disclaimer of accuracy, please visit
<http://giswebsite.metc.state.mn.us/gissitenew/notice.aspx>



Roadway Area Definition

Roadway Reconstruction/Modernization Project: CSAH 86-TH 3 to CSAH 47 | Map ID: 1415136626932

Results

Project Length: 3.848 miles

Project Area: 43.012 sq mi

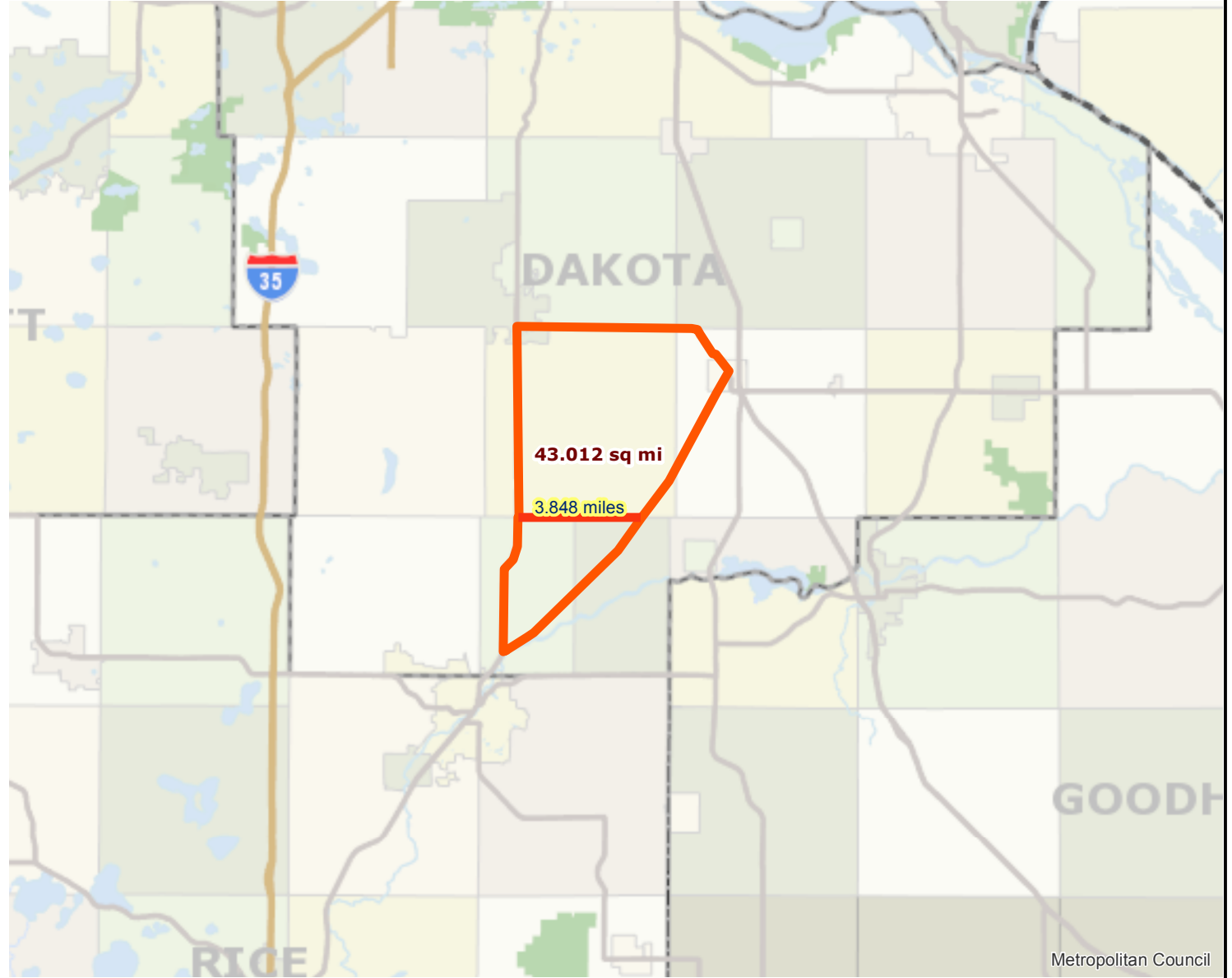

— Project

□ Project Area

0 3 6 12 18 24 Miles

Created: 11/4/2014
LandscapeRSA1



For complete disclaimer of accuracy, please visit
<http://giswebsite.metc.state.mn.us/gissitenew/notice.aspx>



Metropolitan Council

Regional Economy

Roadway Reconstruction/Modernization Project: CSAH 86-TH 3 to CSAH 47 | Map ID: 1415136626932

Results

Project **NOT IN** area of Job Concentration.

Project **NOT IN** to area of Manufacturing and Distribution.

Project **NOT CONNECTED** to area of Education Institutions.

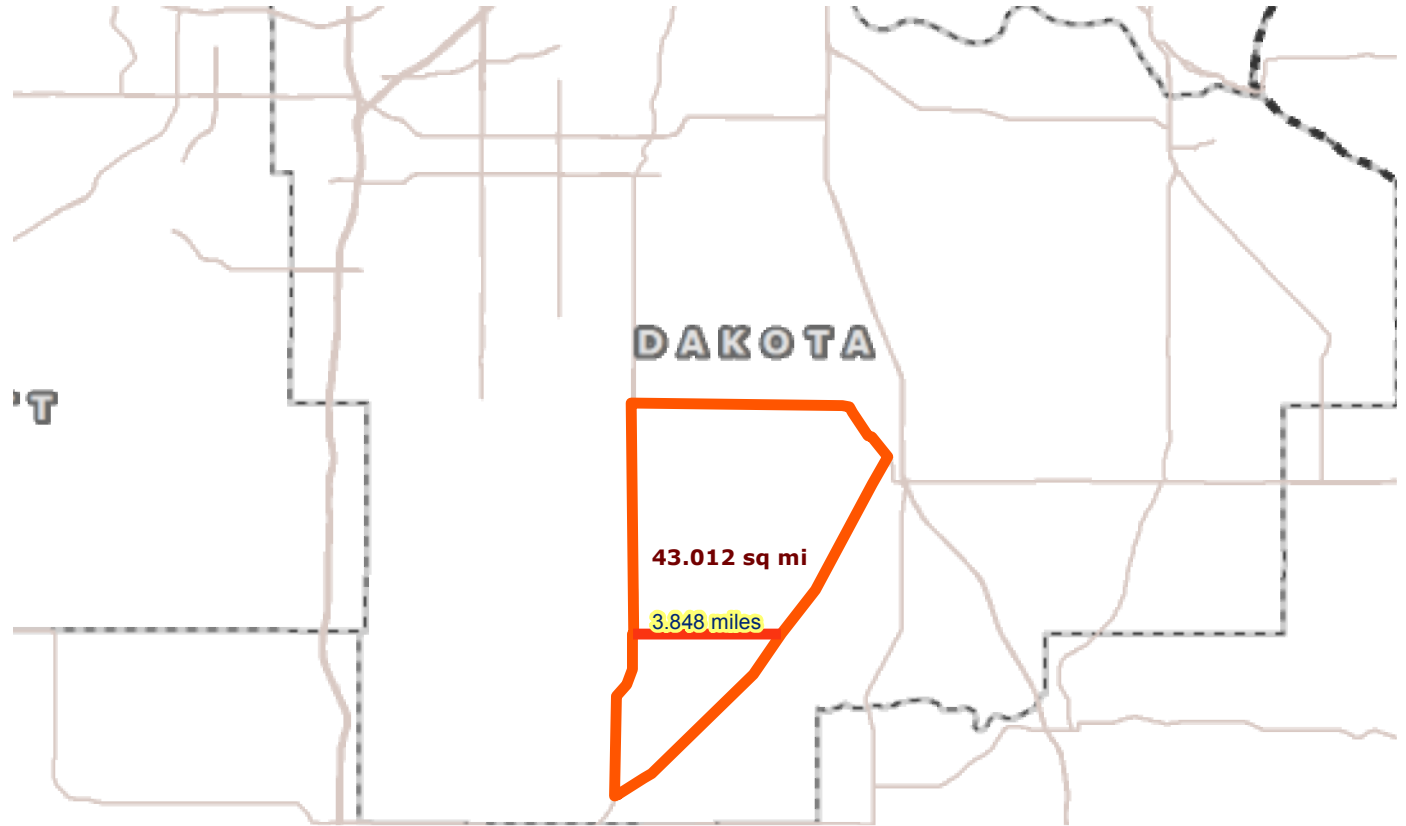

-  Project
-  Project Area











Created: 11/4/2014
LandscapeRSA5



For complete disclaimer of accuracy, please visit
<http://giswebsite.metc.state.mn.us/gissitenew/notice.aspx>



Legend

-  1 Mile Buffer
-  Bikeways
-  Licensed Day Care
-  Places of Worship
-  City / Township Hall
-  Fire Station
-  Park
-  Schools & School Offices

**A-Minor Connector
CSAH 86
Townships of Castle Rock,
Waterford, and Sciota**

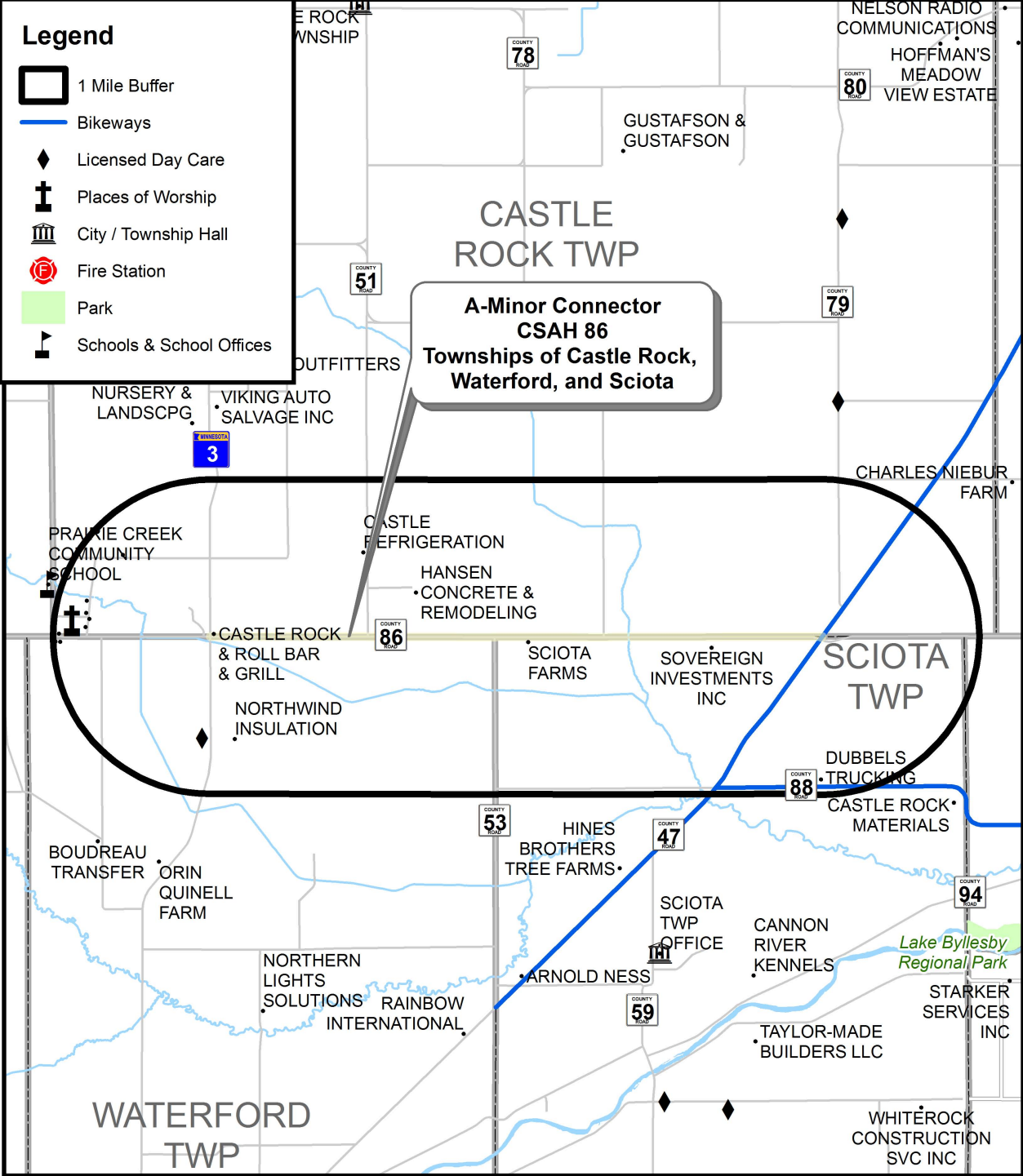

Results

Project **NOT IN** any area of concentrated poverty.

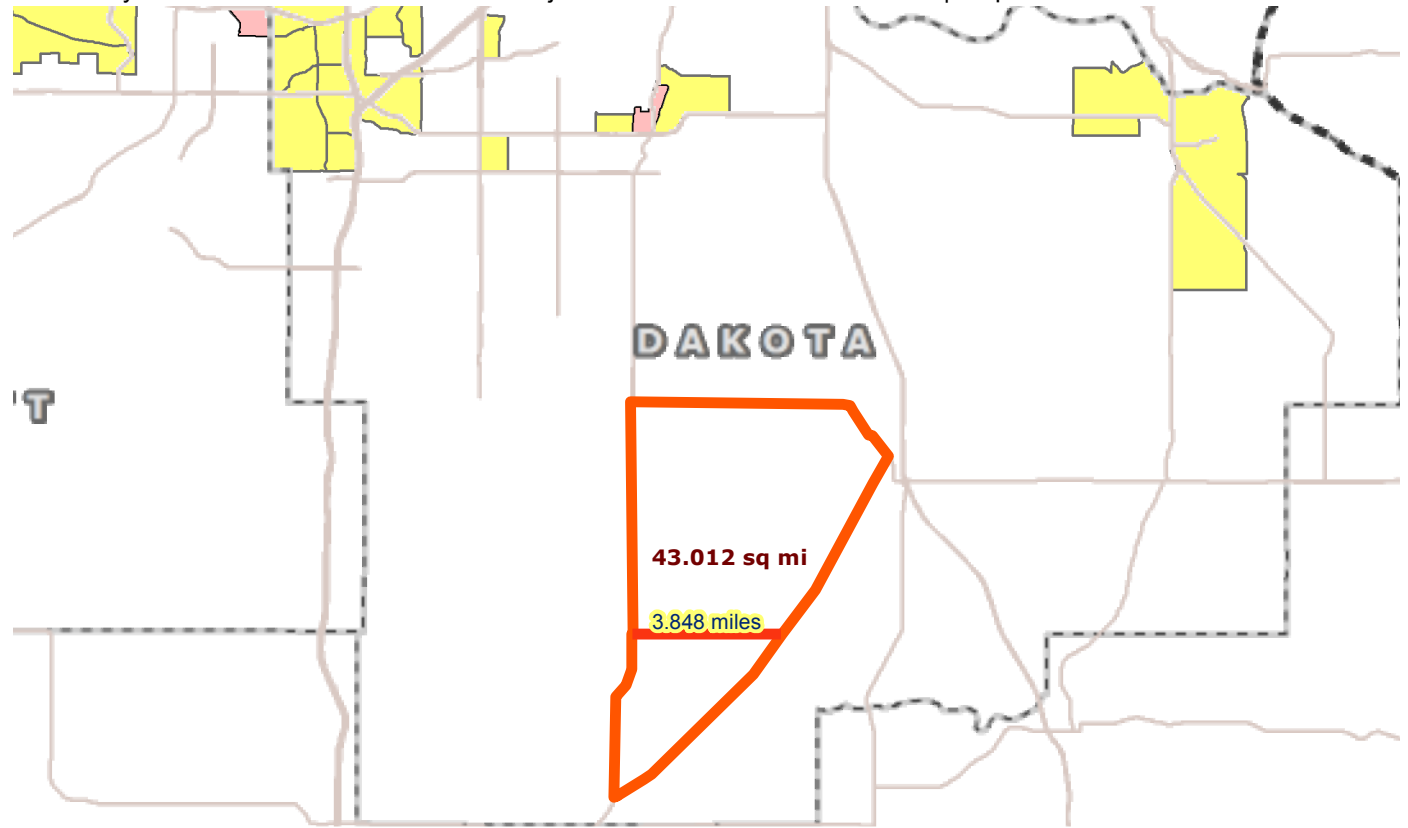

- Project
- Project Area
- Racially concentrated area of poverty
- Concentrated area of poverty
- Above reg'l avg conc of race/poverty

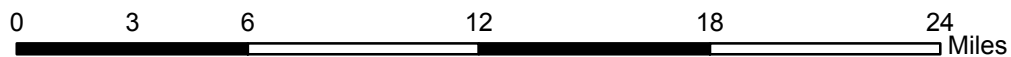

Created: 11/4/2014
LandscapeRSA2



For complete disclaimer of accuracy, please visit <http://giswebsite.metc.state.mn.us/gissitenew/notice.aspx>



No Synchro or HCM Reports to submit.

No Synchro or HCM Reports to submit.

B/C worksheet

Control Section	T.H. / Roadway	Location	Beginning Ref. Pt.	Ending Ref. Pt.	State, County, City or Township	Study Period Begins	Study Period Ends
	CSAH 86	Along CSAH 86 from TH 3 east 3.85 miles to its intersection with CSAH 47			Dakota Co.	1/1/2011	12/31/2013
Description of Proposed Work		TOTAL if all crash reduction treatments/ factors (see individual worksheets) - Install left and/ or right turn lanes at intersections, add by-pass lanes at T-intersections, and widen shoulders along CSAH 86					

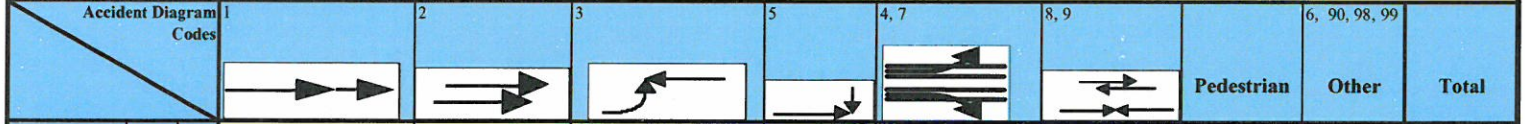

Study Period: Number of Crashes	Fatal	F							
	Personal Injury (PI)	A							1
		B				1			
		C				1		1	2
	Property Damage	PD			1		3		4

% Change in Crashes	Fatal	F						
	PI	A						
		B				-61%		
		C				-40%		
	Property Damage	PD				-40%		

**Use FHWA cmfclearingho use for Crash Reduction Factors*

Change in Crashes = No. of crashes X % change in crashes	Fatal	F						
	PI	A						
		B				-0.61		
		C				-0.40		
	Property Damage	PD				-0.40		

Year (Safety Improvement Construction) **2017**

Project Cost (exclude Right of Way)	Type of Crash	Study Period: Change in Crashes	Annual Change in Crashes	Cost per Crash	Annual Benefit	
\$ 6,875,000	F			\$ 10,300,000		
Right of Way Costs (optional)	A	-0.61	-0.20	\$ 550,000	\$ 111,833	
Traffic Growth Factor 3%	B			\$ 160,000		
Capital Recovery	C	-0.75	-0.25	\$ 81,000	\$ 20,250	
1. Discount Rate 4.5%	PD	-1.96	-0.65	\$ 7,400	\$ 4,835	
2. Project Service Life (n) 20	Total				\$ 136,918	

B/C = 0.35

Using present worth values,
B= \$ 2,395,232
C= \$ 6,875,000
See "Calculations" sheet for amortization.

B/C worksheet

Control Section	T.H. / Roadway	Location	Beginning Ref. Pt.	Ending Ref. Pt.	State, County, City or Township	Study Period Begins	Study Period Ends
	CSAH 86	Along CSAH 86 from TH 3 east 3.85 miles to its intersection with CSAH 47			Dakota Co.	1/1/2011	12/31/2013
Description of Proposed Work		Intersection of CSAH 86 and TH 3 - Install left and right turn lanes on CSAH 86					

Accident Diagram Codes	1	2	3	5	4, 7	8, 9	Pedestrian	Other	Total

Study Period: Number of Crashes	Fatal	F							
	Personal Injury (PI)	A			1				1
		B							
		C							
Property Damage	PD								

% Change in Crashes	Fatal	F							
	PI	A			-61%				
		B							
		C							
Property Damage	PD								

Change in Crashes <small>= No. of crashes X % change in crashes</small>	Fatal	F							
	PI	A			-0.61				-0.61
		B							
		C							
Property Damage	PD								

Year (Safety Improvement Construction) **2017**

	Project Cost (exclude Right of Way)	Right of Way Costs (optional)	Traffic Growth Factor	Capital Recovery	1. Discount Rate	2. Project Service Life (n)	Total
	\$ 6,875,000	F	3%	B	4.5%	20	
		\$ 10,300,000	A	\$ 160,000			
		\$ 550,000		\$ 81,000			
		\$ 111,833		\$ 7,400			
							\$ 111,833

B/C = 0.00

Using present worth values,
B = \$ 111,833
C = \$ -
 See "Calculations" sheet for amortization.

B/C worksheet

Control Section	T.H. / Roadway	Location	Beginning Ref. Pt.	Ending Ref. Pt.	State, County, City or Township	Study Period Begins	Study Period Ends
	CSAH 86	Along CSAH 86 from TH 3 east 3.85 miles to its intersection with CSAH 47			Dakota Co.	1/1/2011	12/31/2013
Description of Proposed Work		Intersection of CSAH 86 and CR 53 - Install right turn lane					

Accident Diagram Codes	1	2	3	5	4, 7	8, 9	Pedestrian	Other	Total

Study Period: Number of Crashes	Fatal	F							
	Personal Injury (PI)	A							
		B							
		C						1	1
	Property Damage	PD							

% Change in Crashes	Fatal	F							
	PI	A							
		B							
		C						-35%	
	Property Damage	PD							

Change in Crashes <small>= No. of crashes X % change in crashes</small>	Fatal	F							
	PI	A							
		B							
		C						-0.35	-0.35
	Property Damage	PD							

Year (Safety Improvement Construction) **2017**

Project Cost (exclude Right of Way)	Type of Crash	Study Period: Change in Crashes	Annual Change in Crashes	Cost per Crash	Annual Benefit
\$ 6,875,000	F			\$ 10,300,000	
Right of Way Costs (optional)	A			\$ 550,000	
Traffic Growth Factor	B			\$ 160,000	
Capital Recovery	C	-0.35	-0.12	\$ 81,000	\$ 9,450
1. Discount Rate	PD			\$ 7,400	
2. Project Service Life (n)					
Total				\$ 9,450	

B/C = 0.00

Using present worth values,
B = \$ 9,450
C = \$ -
 See "Calculations" sheet for amortization.

B/C worksheet

Control Section	T.H. / Roadway	Location	Beginning Ref. Pt.	Ending Ref. Pt.	State, County, City or Township	Study Period Begins	Study Period Ends
	CSAH 86	Along CSAH 86 from TH 3 east 3.85 miles to its intersection with CSAH 47			Dakota Co.	1/1/2011	12/31/2013
Description of Proposed Work		Intersection of CSAH 86 and CSAH 47 - Install left turn lanes					

Accident Diagram Codes	1	2	3	5	4, 7	8, 9	Pedestrian	Other	Total

Study Period: Number of Crashes	Fatal	F							
	Personal Injury (PI)	A							
		B							
		C				1			1
	Property Damage	PD			1				1

% Change in Crashes	Fatal	F							
	PI	A							
		B							
		C				-40%			
	Property Damage	PD			-40%				

*Use FHWA cmfclearingho use for Crash Reduction Factors

Change in Crashes = No. of crashes X % change in crashes	Fatal	F							
	PI	A							
		B							
		C				-0.40			-0.40
	Property Damage	PD			-0.40				-0.40

Year (Safety Improvement Construction) **2017**

	Project Cost (exclude Right of Way)	Right of Way Costs (optional)	Traffic Growth Factor	Capital Recovery	1. Discount Rate	2. Project Service Life (n)	Total
	\$ 6,875,000		3%		4.5%	20	
Type of Crash		F	A	B	C	PD	
Study Period: Change in Crashes					-0.40	-0.40	
Annual Change in Crashes					-0.13	-0.13	
Cost per Crash		\$ 10,300,000	\$ 550,000	\$ 160,000	\$ 81,000	\$ 7,400	
Annual Benefit					\$ 10,800	\$ 987	\$ 11,787

B/C = 0.00

Using present worth values,
B = \$ 11,787
C = \$ -
 See "Calculations" sheet for amortization.

B/C worksheet

Control Section	T.H. / Roadway	Location	Beginning Ref. Pt.	Ending Ref. Pt.	State, County, City or Township	Study Period Begins	Study Period Ends
	CSAH 86	Along CSAH 86 from TH 3 east 3.85 miles to its intersection with CSAH 47			Dakota Co.	1/1/2011	12/31/2013
Description of Proposed Work		CSAH 86 Segment - widen shoulder and add by-pass lanes at T-intersections					

Accident Diagram Codes	1	2	3	5	4, 7	8, 9	Pedestrian	Other	Total

Study Period: Number of Crashes	Fatal	F							
	Personal Injury (PI)	A							
		B							
		C							
Property Damage	PD				3			3	

% Change in Crashes	Fatal	F							
	PI	A							
		B							
		C							
Property Damage	PD				-52%				

Change in Crashes = No. of crashes X % change in crashes	Fatal	F							
	PI	A							
		B							
		C							
Property Damage	PD				-1.56			-1.56	

Year (Safety Improvement Construction) **2017**

		Type of Crash	Study Period: Change in Crashes	Annual Change in Crashes	Cost per Crash	Annual Benefit
Project Cost (exclude Right of Way)	\$ 6,875,000					
Right of Way Costs (optional)		F			\$ 10,300,000	
Traffic Growth Factor	3%	A			\$ 550,000	
Capital Recovery		B			\$ 160,000	
1. Discount Rate	4.5%	C			\$ 81,000	
2. Project Service Life (n)	20	PD	-1.56	-0.52	\$ 7,400	\$ 3,848
Total					\$ 3,848	

B/C = 0.00

Using present worth values,
B = \$ 3,848
C = \$ -
 See "Calculations" sheet for amortization.

Amortizing...

Year	Crash Benefits	Present Worth Benefits	Present Worth Costs
2017	\$ 136,918	\$ 136,918	\$ 6,875,000
2018	\$ 141,026	\$ 134,953	
2019	\$ 145,256	\$ 133,016	
2020	\$ 149,614	\$ 131,106	
2021	\$ 154,102	\$ 129,224	
2022	\$ 158,725	\$ 127,369	
2023	\$ 163,487	\$ 125,541	
2024	\$ 168,392	\$ 123,739	
2025	\$ 173,444	\$ 121,963	
2026	\$ 178,647	\$ 120,212	
2027	\$ 184,006	\$ 118,487	
2028	\$ 189,527	\$ 116,786	
2029	\$ 195,212	\$ 115,110	
2030	\$ 201,069	\$ 113,457	
2031	\$ 207,101	\$ 111,829	
2032	\$ 213,314	\$ 110,224	
2033	\$ 219,713	\$ 108,641	
2034	\$ 226,305	\$ 107,082	
2035	\$ 233,094	\$ 105,545	
2036	\$ 240,087	\$ 104,030	
0	\$ -	\$ -	
0	\$ -	\$ -	
0	\$ -	\$ -	
0	\$ -	\$ -	
0	\$ -	\$ -	
0	\$ -	\$ -	
0	\$ -	\$ -	
0	\$ -	\$ -	
0	\$ -	\$ -	
0	\$ -	\$ -	
0	\$ -	\$ -	
0	\$ -	\$ -	

Totals = \$ 2,395,232 \$ 6,875,000
(B) (C)

year (n)= 1, 2, 3,....
discount rate (i) = 7%

$$\text{Crash Benefits (@ year n)} = (\text{Crash Benefits})_{n-1} \times (1 + \text{Traffic Growth Factor})$$

$$\text{Present Worth Benefits (@ year n)} = (\text{Crash Benefits})_n \times 1/(1 + \text{Discount Rate})^n$$

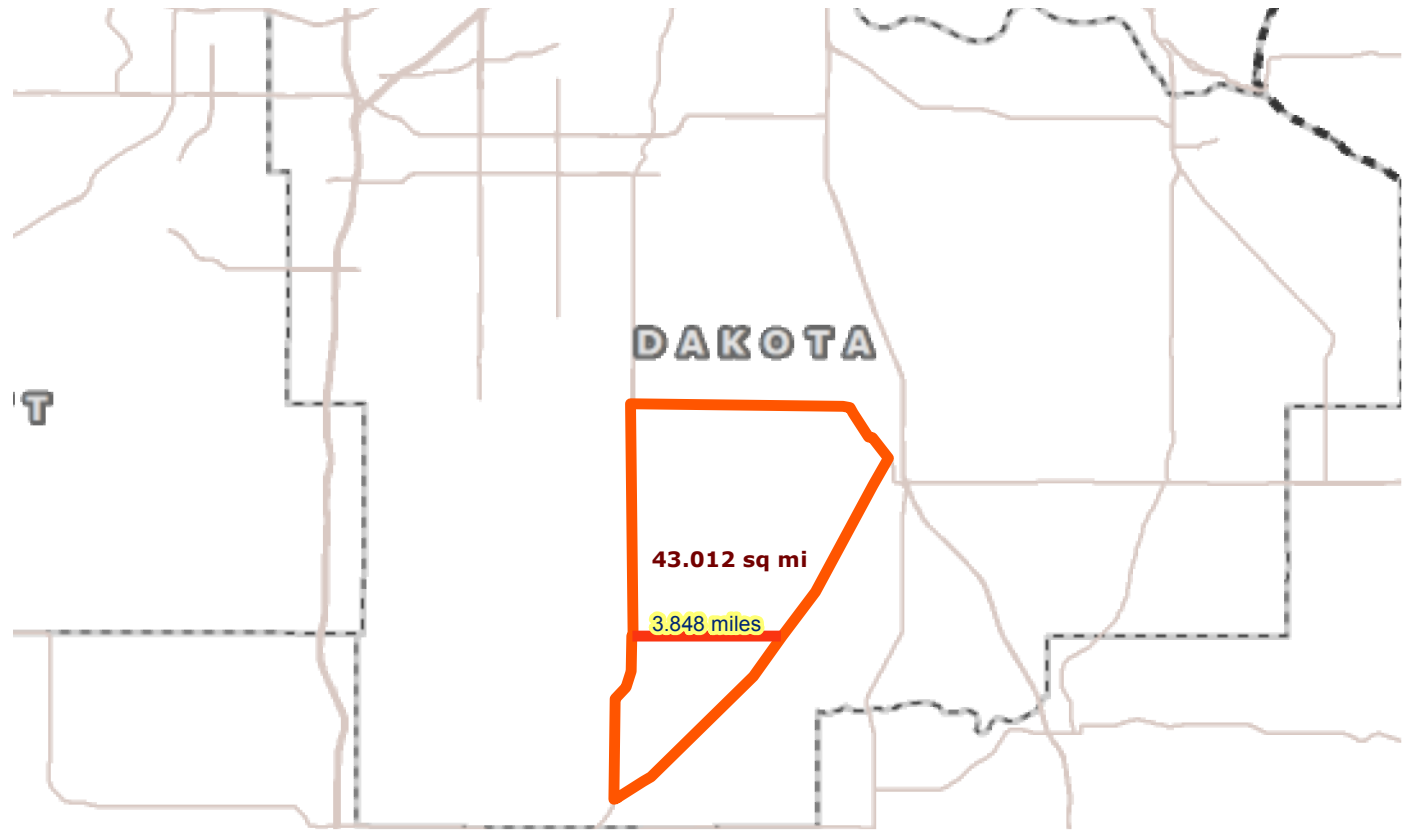

Results

Transit with a Direct Connection to project:
-- NONE --

**indicates Planned Alignments*

-  Project
-  Project Area

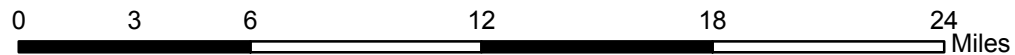

Created: 11/4/2014
LandscapeRSA3



For complete disclaimer of accuracy, please visit
<http://giswebsite.metc.state.mn.us/gissitenew/notice.aspx>

