

Typical BLRT rail corridor section

**DRAFT**  
WORK IN PROCESS







Existing composite fence at 63rd Avenue Park and Ride in Brooklyn Park

**DRAFT**  
WORK IN PROCESS







|  |                                       |
|--|---------------------------------------|
| LEGEND   |                                       |
| —  | PROP LRT ☒                            |
| —  | PLATFORM                              |
| —  | EXIST ROADWAY                         |
| —  | PROP ROADWAY                          |
| —  | EXIST ROW                             |
| —  | PROPERTY LINE                         |
| —  | EXIST FENCES                          |
| —  | EXIST FENCES IMPACTED BY CONSTRUCTION |
| —  | CONSTRUCTION LIMITS                   |
| —  | PROP PERM EASEMENT                    |
| CASE 1: NUMBER OF PROPERTIES WITHOUT FENCES  | 0                                     |
| CASE 2: NUMBER OF PROPERTIES WITH FENCES NOT IMPACTED BY CONSTRUCTION  | 3                                     |
| CASE 3: NUMBER OF PROPERTIES WITH BNSF FENCES IMPACTED BY CONSTRUCTION   | 57                                    |
| CASE 4: NUMBER OF PROPERTIES WITH RESIDENTIAL FENCES DIRECTLY ADJACENT TO BNSF FENCES IMPACTED BY CONSTRUCTION | 4                                     |
| NOTE:<br>1. ONLY COUNTS RESIDENTIAL PROPERTIES DIRECTLY ADJACENT TO CONSTRUCTION LIMITS                        |                                       |
| TOTAL RESIDENTIAL PROPERTIES ADJACENT TO CONSTRUCTION LIMITS IN CITY OF CRYSTAL                                | 64                                    |

BLUE LINE LRT EXTENSION  
EXISTING FENCING  
SEGMENT C

REV 0  
5/23/2016

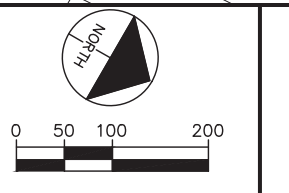

Kimley»Horn

DRAFT-WORK IN PROCESS