

Business Advisory Committee

August 8, 2023



BROOKLYN PARK | CRYSTAL | ROBBINSDALE | MINNEAPOLIS



Today's Topics

- Call to Order and Welcome
- Approval of July 11 Meeting Minutes
- Upcoming Meetings and Attendance
- Project Update
- Minneapolis Design Update
- Anti-Displacement
- Discussion and Members Feedback
- Next Steps



The public can submit written comments to Nkongo Cigolo (Nkongo.Cigolo@metrotransit.org)

Project Update



Blue Line LRT Extension

- BLRT Extension located in Hennepin County directly connecting downtown Minneapolis, Robbinsdale, Crystal and Brooklyn Park and communities in the northwest metro
- Modified route adopted in June 2022, with options
- Anti-Displacement recommendations report published for comment in May 2023
- Policy recommendation on route in Sept 2023 for inclusion in Supplemental Draft Environmental Impact Statement

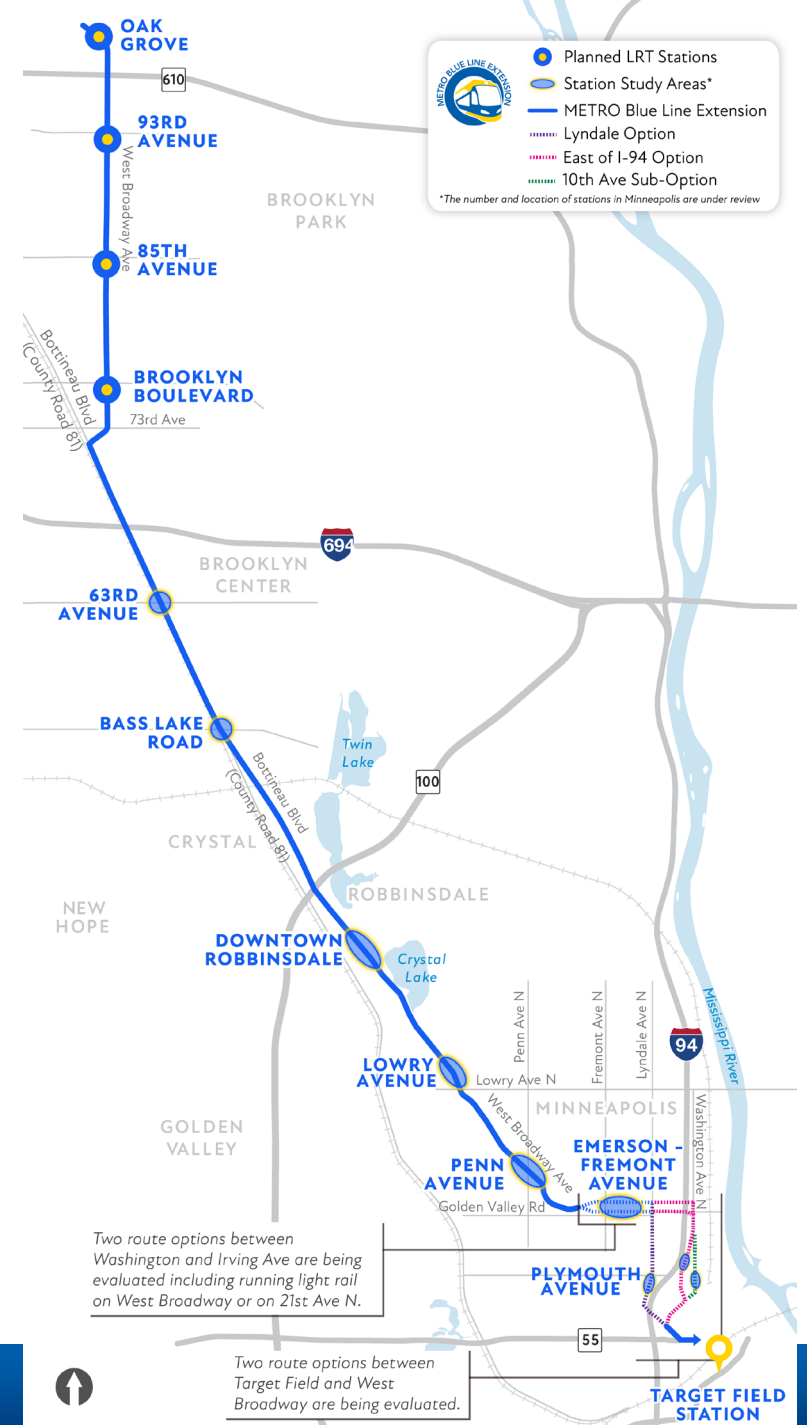

Project Schedule

Blue Line Extension Community Supported Route:

- Best meets the project Principles and Goals
- Grounded in community feedback through collaboration with stakeholders
- Supported by project corridor communities and decision-makers

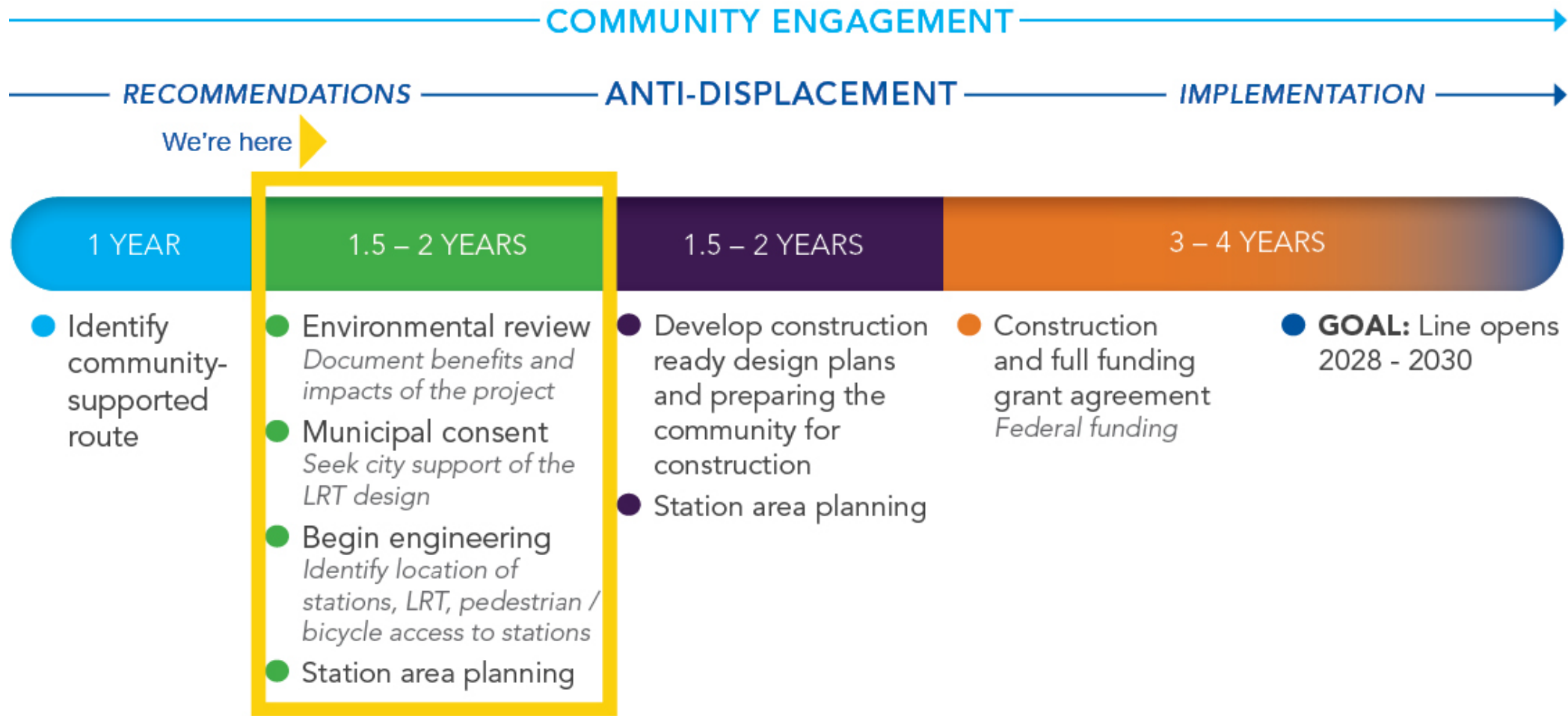

LRT projects are complex and unforeseen challenges arise. Schedules and timelines are subject to change.



Timeline to Publish SDEIS and Initiate Municipal Consent

	2023											2024								
	Feb	Mar	Apr	May	Jun	Jul	Aug	Sep	Oct	Nov	Dec	Jan	Feb	Mar	Apr	May	Jun	Jul	Aug	Sep
CMC Meeting	☑	☑	☑	☑	☑	☑														
Brooklyn Park	X			X	X															
Crystal		X		X	X															
Robbinsdale			X	X	X															
Minneapolis				X	X	X														
Anti-Displacement	X	X	X	X	X	X														
Supplemental Environmental Impact Statement									FTA Review #1		FTA Review #2		FTA Review #3		Publish SDEIS		Prepare SFEIS...			
Municipal Consent																				



Minneapolis Design Decisions for SDEIS



Minneapolis Design Decisions



1. Penn Avenue Station Area
2. West Broadway and 21st Avenue
3. 21st Avenue Extension
4. Plymouth Station on Washington Avenue
5. Transitway for a portion of 10th Avenue



1. Penn Avenue Station Area

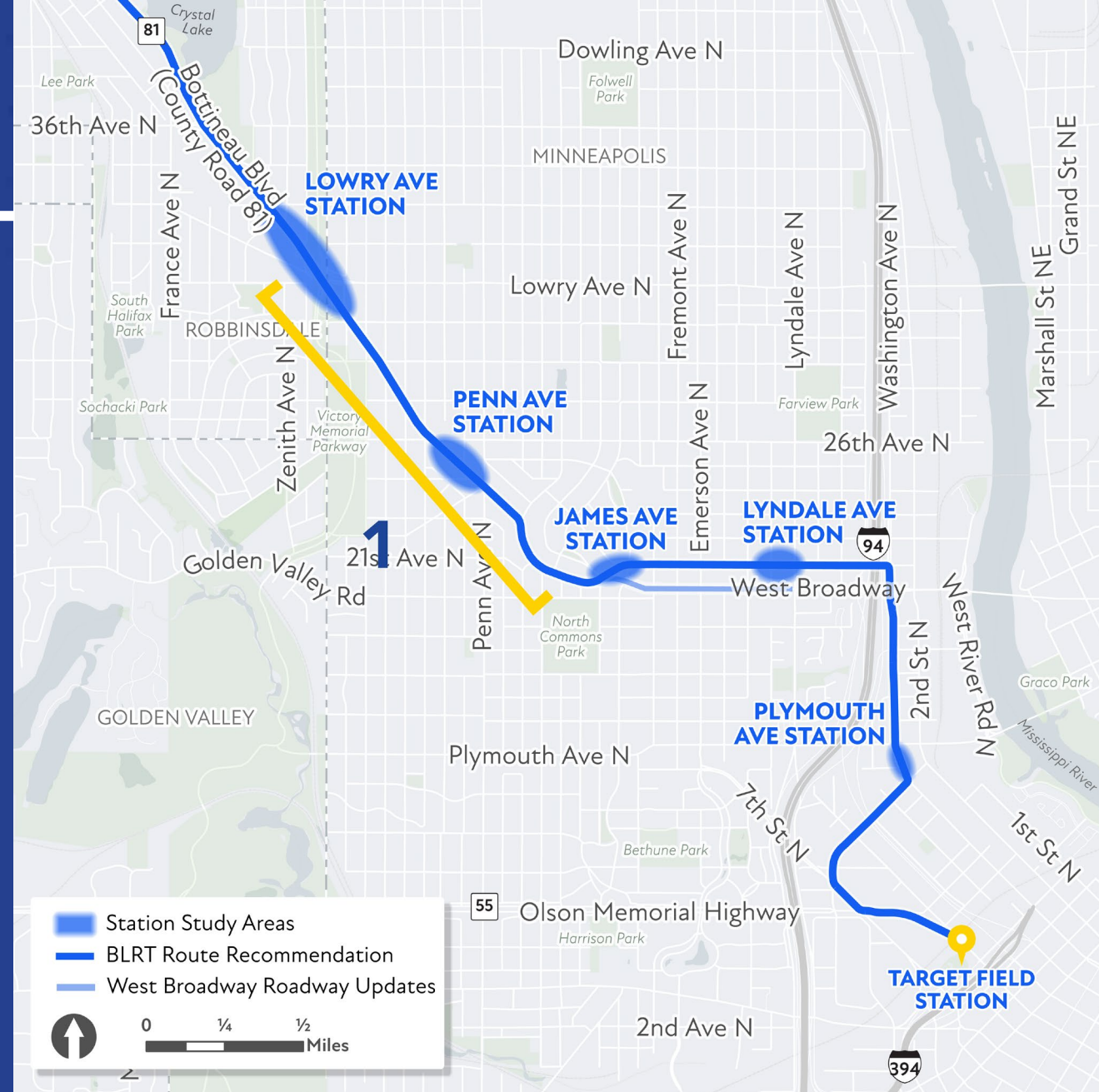





1. Penn Avenue Station Area



Tracks center running from Lowry Avenue to Irving Avenue

Penn Ave Station between 26th Ave N and Penn Ave

 Station Study Area
 BLRT Route Recommendation

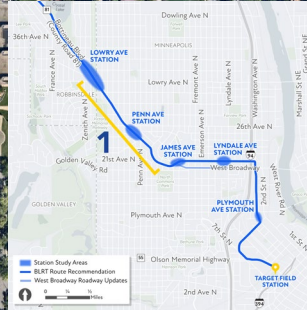

Penn Avenue Station

- METRO C Line connection
- Capri Theater
- NEON food incubator

Capri Theater

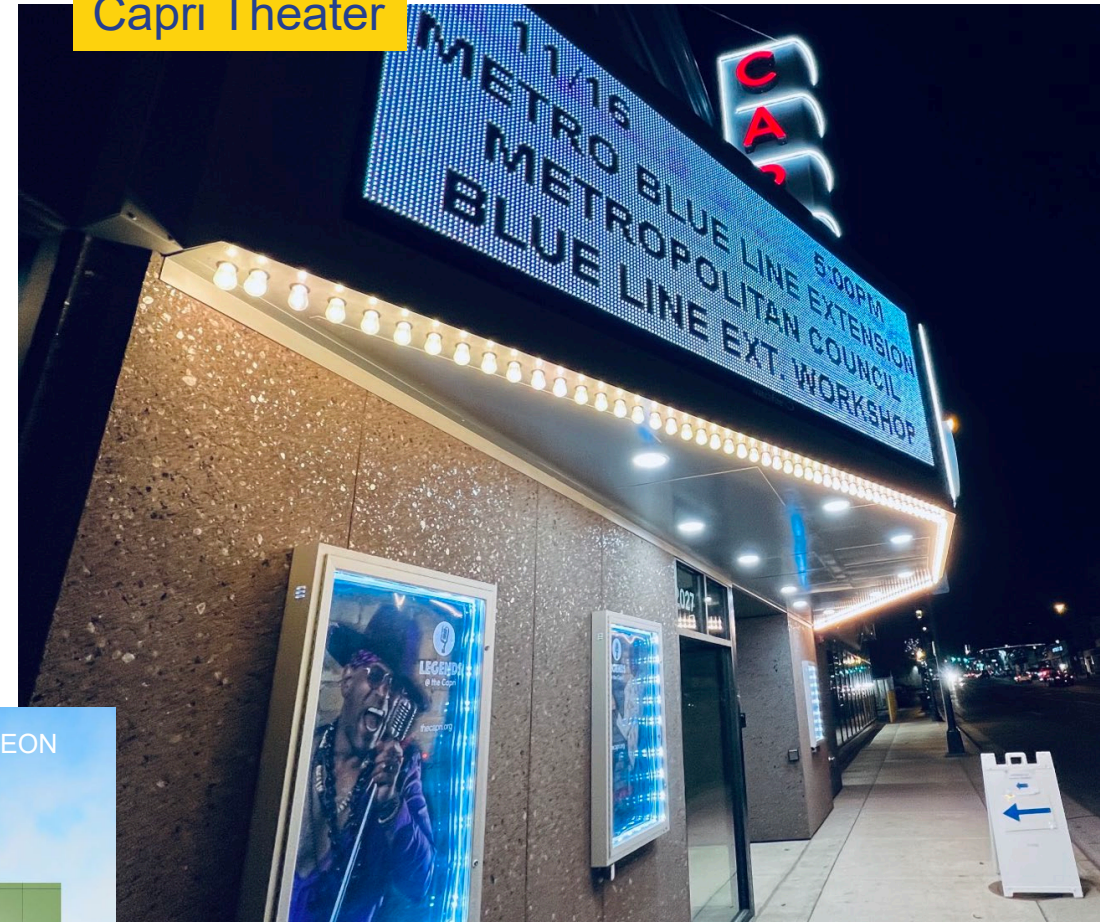

The Incubator Project*

*Photo Source: NEON

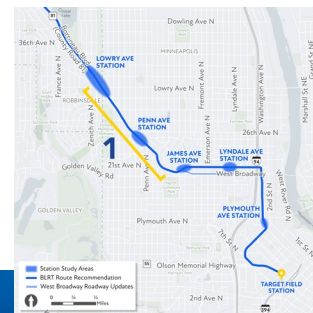



Engagement Specific to this Segment

West Broadway Business Meetings

- Parking
- Resources for businesses
- Safety and security
- Vision for West Broadway



2. West Broadway and 21st





2. West Broadway and 21st

JAMES AVE STATION

LRT Tracks on 21st

LYNDALE AVE STATION

21st Ave N

West Broadway

Golden Valley Rd

West Broadway Improvements

North Commons Park



Fremont Ave N

Emerson Ave N

Lyndale Ave N

Hall Park





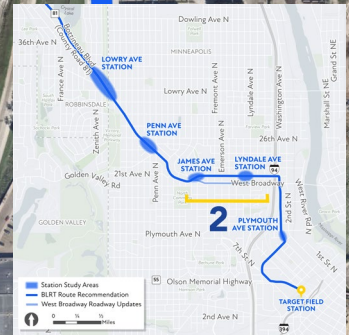

2nd St N

-  Station Area
-  LRT Tracks
-  West Broadway Roadway Updates



West Broadway and 21st Connections

LEGEND

-  WEST BROADWAY ROADWAY UPDATES (PARKING, GREEN SPACES, ETC.)
-  21ST AVE TRANSIT CORRIDOR
-  CORRIDOR STUDY AREA LINK
-  PROJECT BICYCLE CONNECTIONS
-  EXISTING BIKEWAY CONNECTIONS
-  CITY PLANNED BIKEWAY CONNECTIONS
-  METRO D LINE BRT

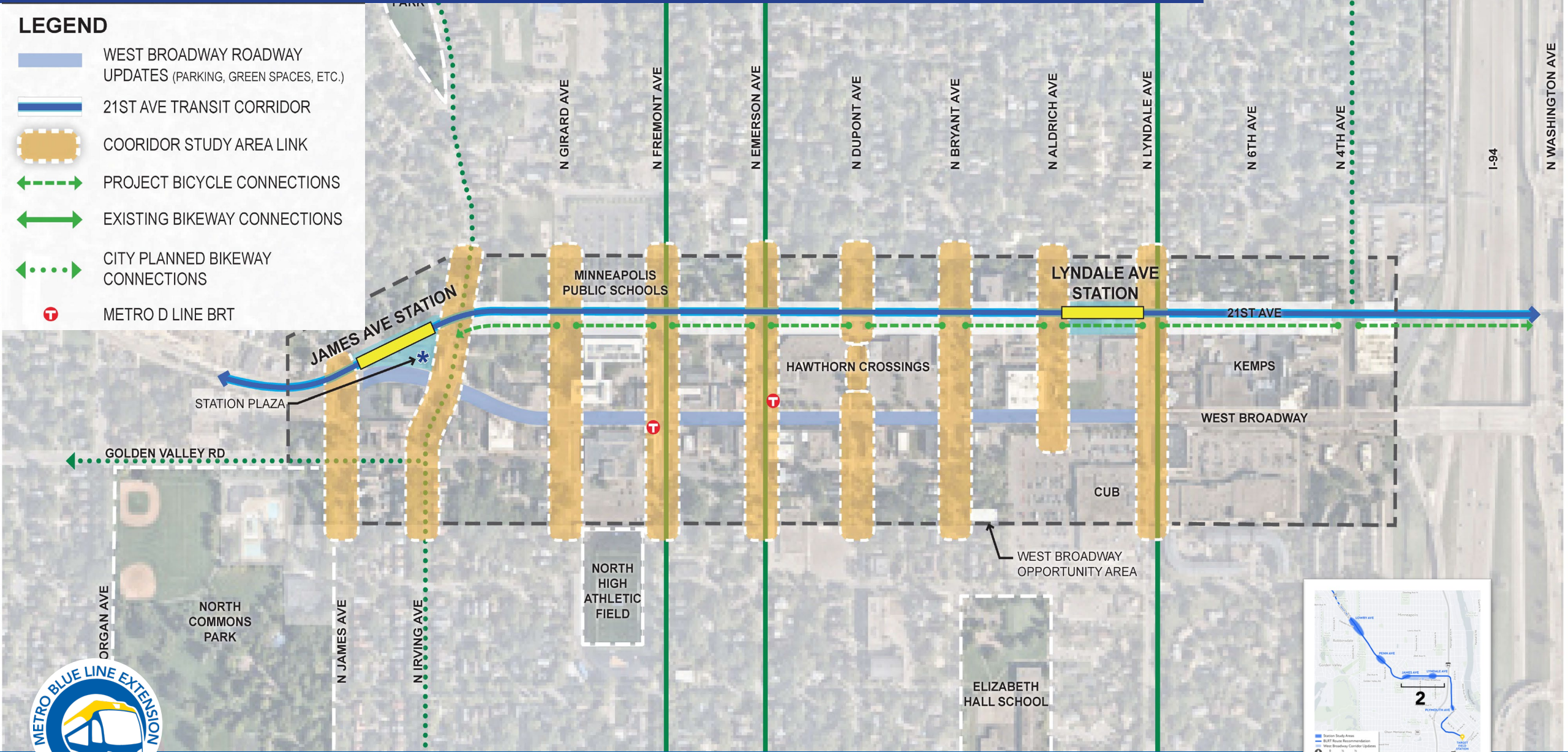

West Broadway Potential Improvements



James Ave Station

- YMCA
- Minneapolis Public Schools Davis Center
- METRO D Line Service



North Commons Park



North High Athletic Field

Photo Sources: MPRB, North High Facebook Page



Lyndale Ave Station

- Juxtaposition
- Masjid An-Nur
- Kemps
- METRO D Line



Photo sources: Northwest Conference, Foursquare





21st Ave/West Broadway Engagement Overview

Began discussions of tracks on West Broadway or 21st Avenue in summer 2021

- Workshops
- One-on-one meetings
- Driveway chats
- Door-knocking
- Phone calls/emails
- Surveys
- Listening sessions
- Business meetings



March 2023 21st and West Broadway Meetings at Cub Foods and the Capri



Engagement Summary – West Broadway/21st Avenue



Common themes for **supporting** 21st Avenue:

- Fewer impacts to environmental justice properties along West Broadway
- Less traffic impacts
- Potential for new housing
- Deter criminal activities
- West Broadway needs a new look

Common **concerns** about 21st Avenue:

- Residential building impacts
- Farther and less visible from the business destinations
- Concern about noise and safety near residential properties



Engagement Summary - Station Placement

Positives

- Provides transit connections
- Additional stops
- Business opportunities to northside communities
- Spurring new developments
- Robust anti-displacement to bridge any gaps

Concerns

- Delayed route selection impacts to business planning
- Loss of business during construction
- Loss of parking
- Building impacts
- Safety concerns and impacts on the community with various abilities



3. 21st Avenue Extension

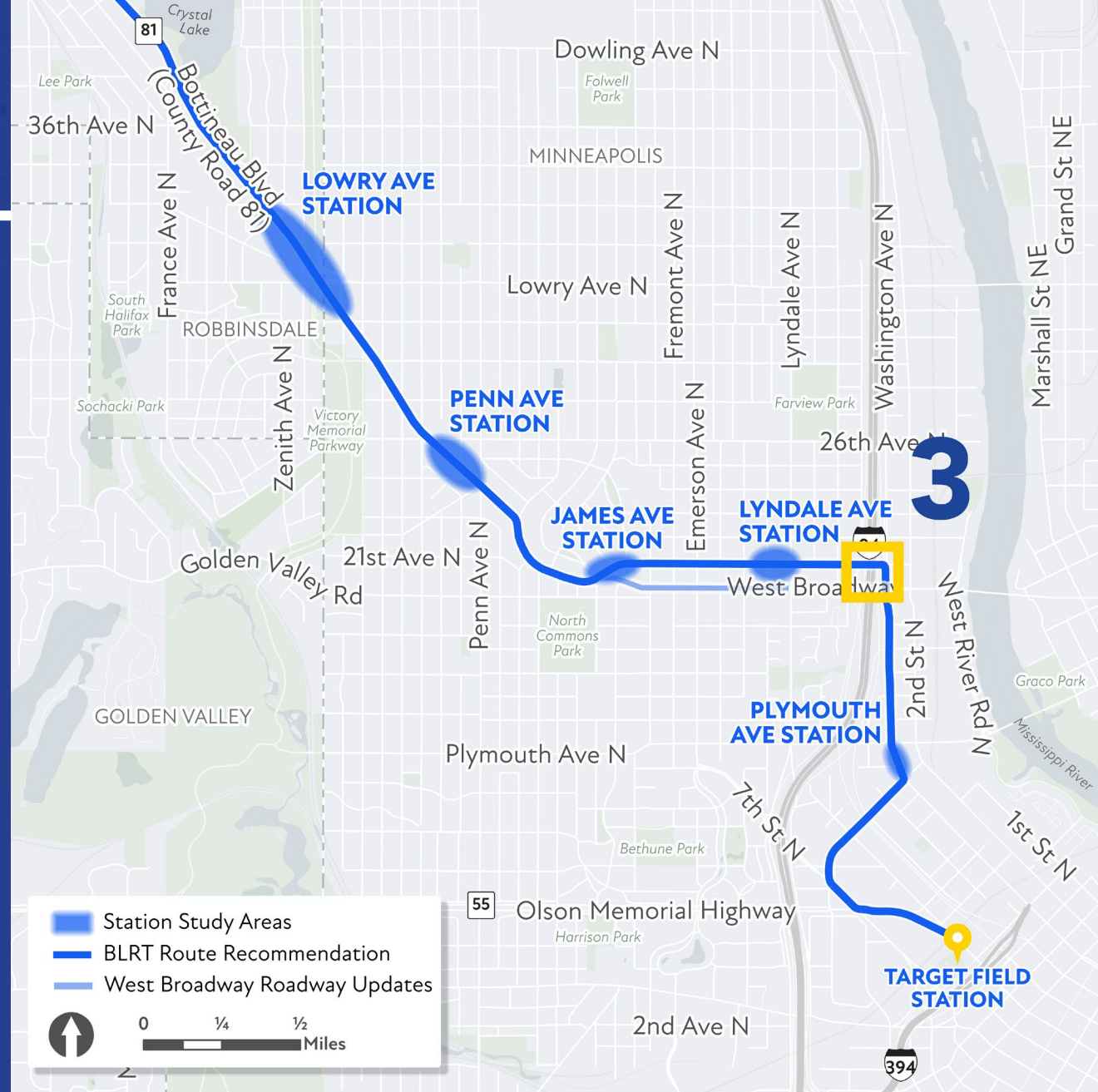

LYNDALE AVE STATION

3. 21st Avenue Extension



New connection for bikes and pedestrians

Cross I-94 on an extension of 21st Avenue



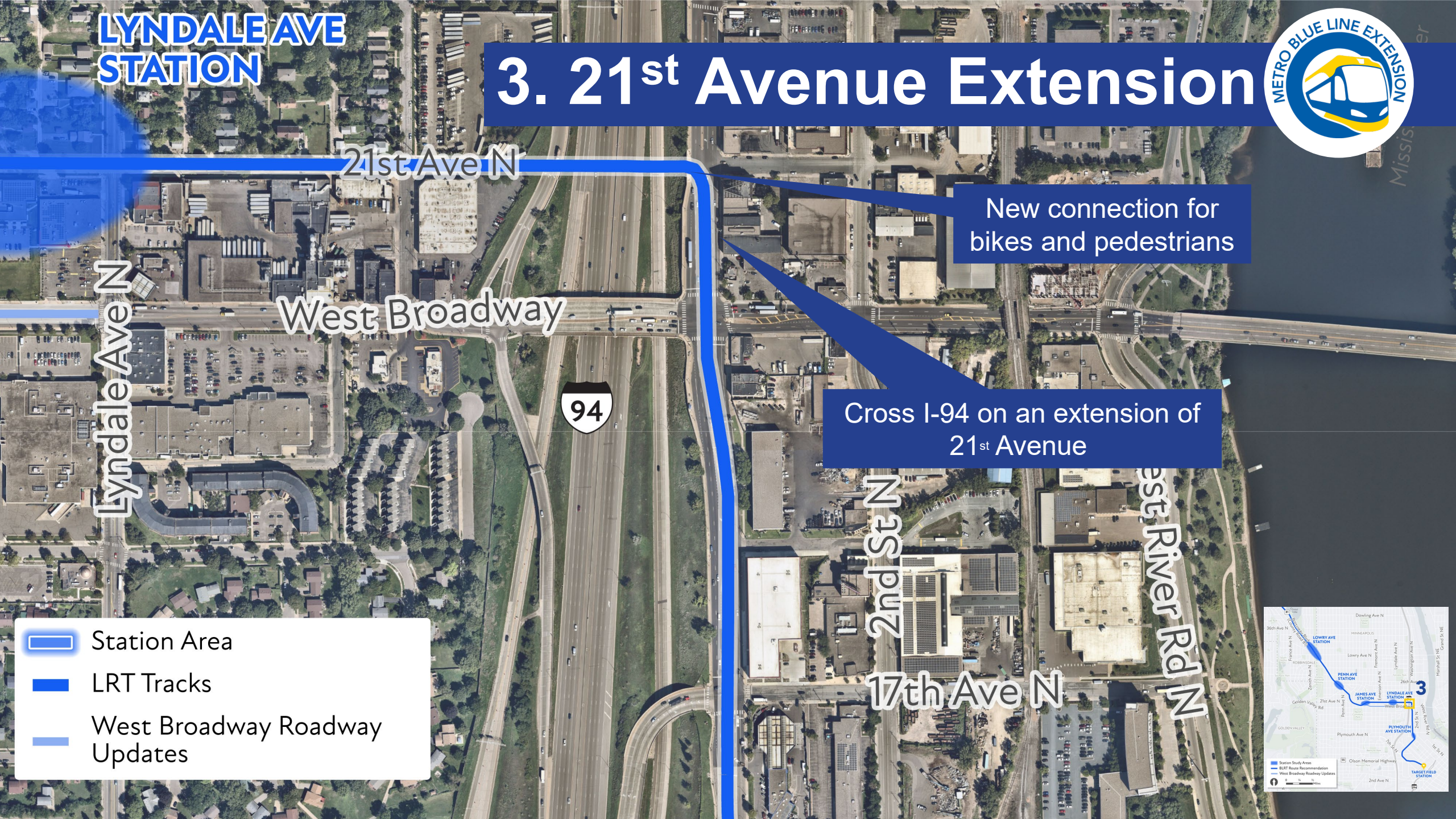
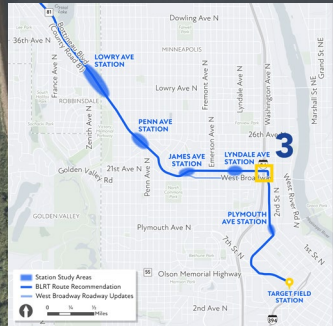

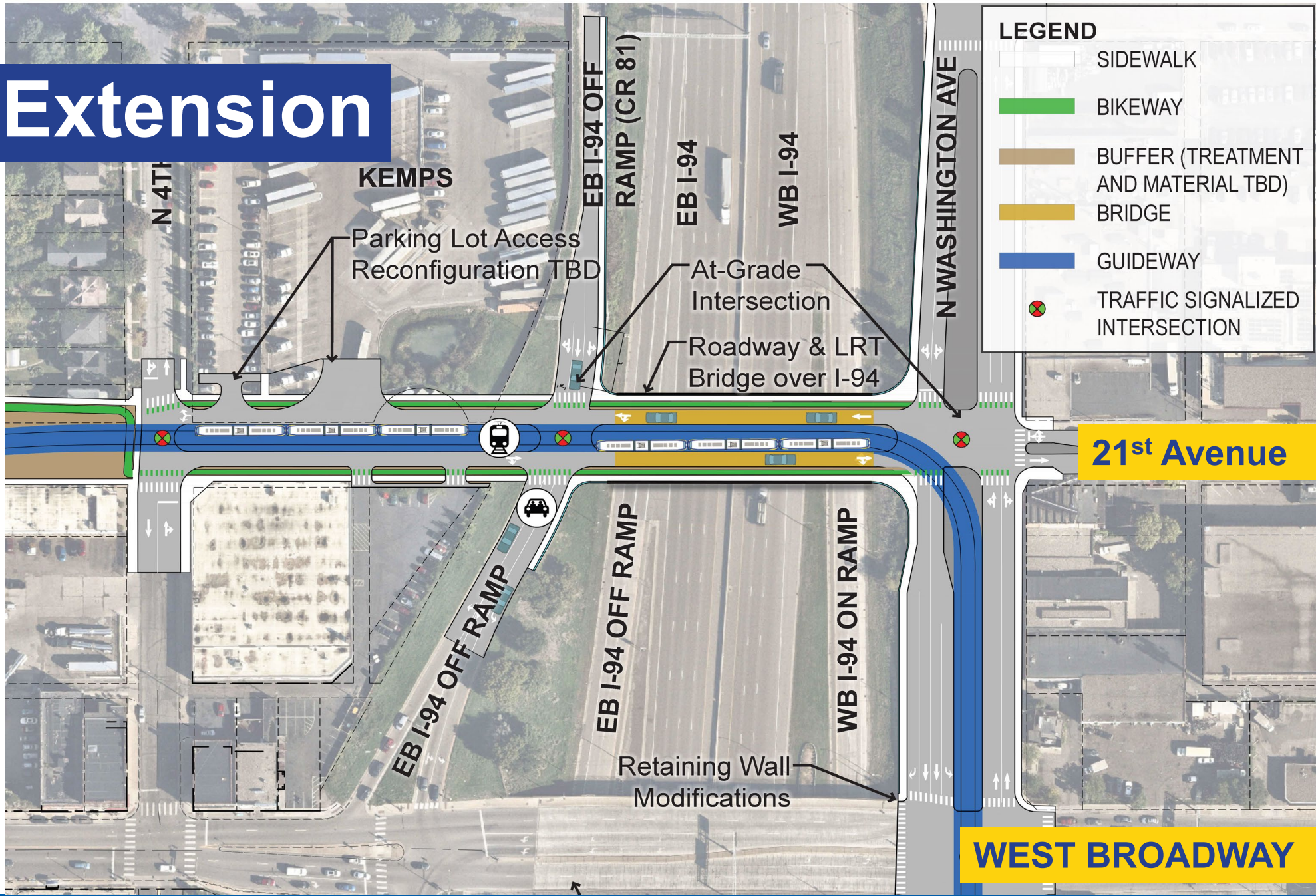

- Station Area
- LRT Tracks
- West Broadway Roadway Updates



21st Ave Extension



LEGEND

-  SIDEWALK
-  BIKEWAY
-  BUFFER (TREATMENT AND MATERIAL TBD)
-  BRIDGE
-  GUIDEWAY
-  TRAFFIC SIGNALIZED INTERSECTION

21st Avenue

WEST BROADWAY



Washington, looking South



INCLUDES SIDEWALK AND BIKE LANES

Note: Trees, landscaping, pedestrian crossings, lanes and other features are an ongoing topic of design

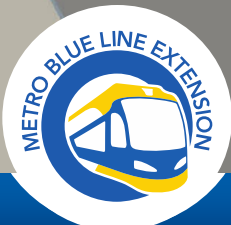
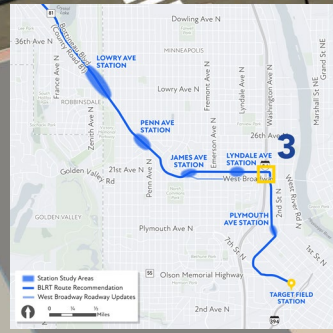

DRAFT CONCEPT

21st Ave Extension Bridge, *looking East (toward river)*

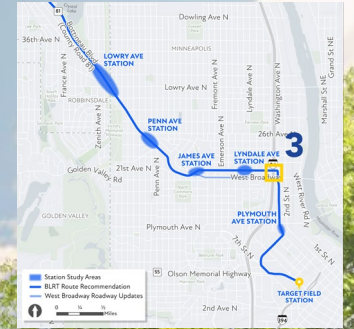

Bike, Ped, Vehicle, LRT
Crossing on 21st Avenue



DRAFT CONCEPT

4. Plymouth Station on Washington





4. Plymouth Station on Washington



V3 and other developments

Opportunity to update Washington Avenue roadway

Industrial Jobs and opportunities

River access

Transit connection opportunities

North Loop Neighborhood

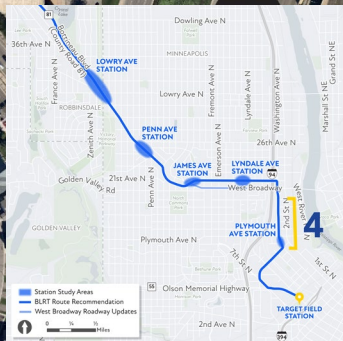

- Station Study Area
- BLRT Route Recommendation

Plymouth Station on Washington Avenue, *looking South*

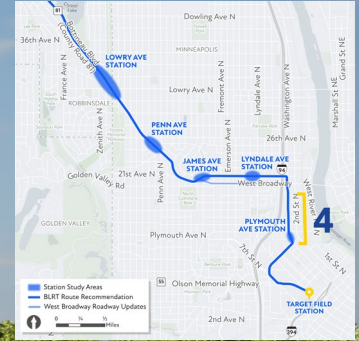

DRAFT CONCEPT

Recent East of I-94 Engagement Overview

- **In-person meetings and events:**
 - Saturday 7/22, Twin Cities International School
 - Saturday 7/22, Outdoor Summer Event
 - Tuesday 7/25, Metro Transit North Loop Garage
 - Door-knocking on 7/17 and 7/27
 - In-person meetings with businesses
- **Virtual meetings and events:**
 - Thursday 7/27
 - Phone and email outreach to businesses, residents, neighborhood groups
- **Interactive feedback map**
- **On-going online survey**



7/25
Community
Meeting
Presentation



7/22
Community
Meeting
Presentation

Recent East of I-94 Feedback

Common themes **supporting** East of I-94:

- Serves affordable housing and high-density destinations, connects residents to/from North Loop neighborhood

Common **concerns**

- Parking impacts on businesses/residents, additional traffic, safety for children around LRT

Live polling at the 7/25 Community Meeting

If light rail is advanced east of I-94 which option do you prefer: East of I-94 (east of the interstate) or East of I-94 sub-option (10th Ave)?

7/25 Community meeting at the Twin Cities International School



5. Transitway for a portion of 10th Ave



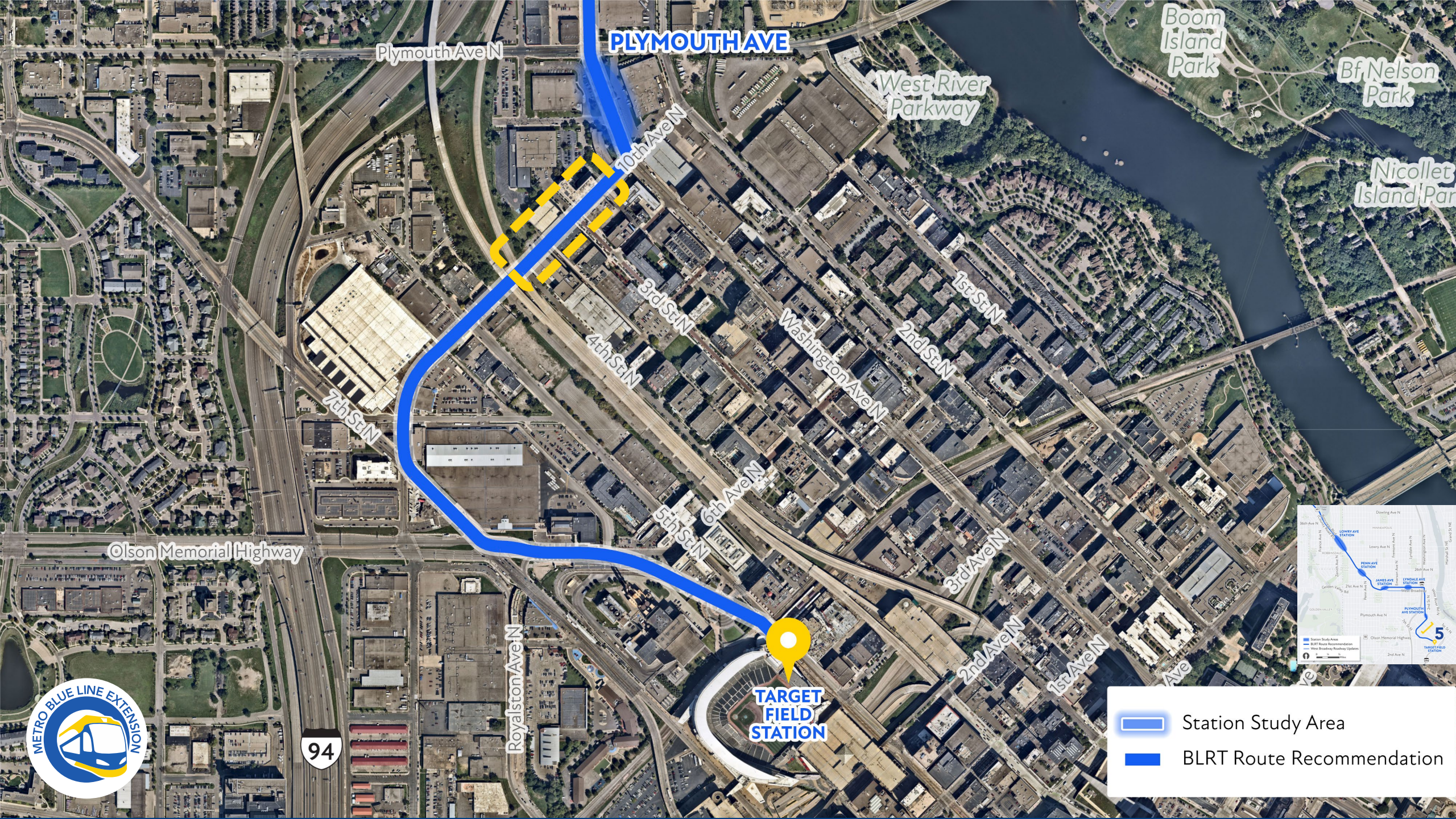

Plymouth Ave N

PLYMOUTH AVE

West River Parkway

Boom Island Park

Bf Nelson Park

Nicollet Island Park

10th Ave N

3rd St N
4th St N

Washington Ave N

1st St N
2nd St N

7th St N

5th St N
6th Ave N

3rd Ave N

2nd Ave N

1st Ave N



Olson Memorial Highway

Royalston Ave N

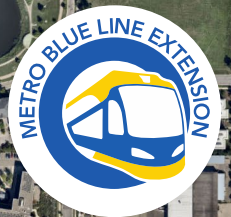
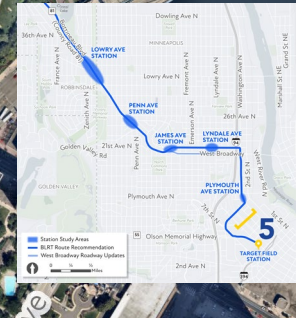
TARGET FIELD STATION



94

-  Station Study Area
-  BLRT Route Recommendation

10th Ave: Existing Conditions

Roadway includes:

- Sidewalks
- Bike lanes
- Two-way car traffic
- Some on-street parking
- Some street trees

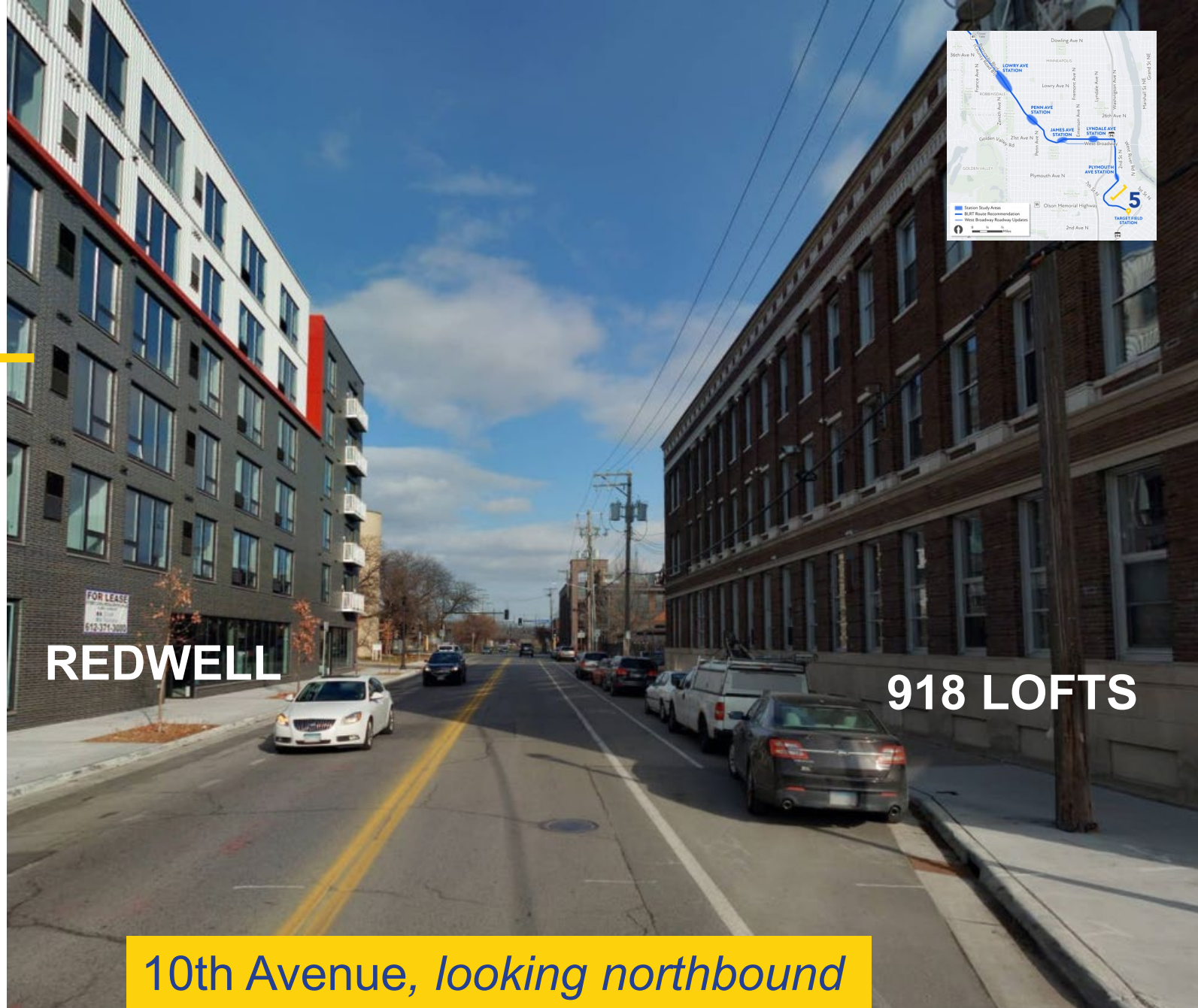

10th Avenue, looking northbound

10th Ave: Transit Mall Option



66.0' EXISTING ROW

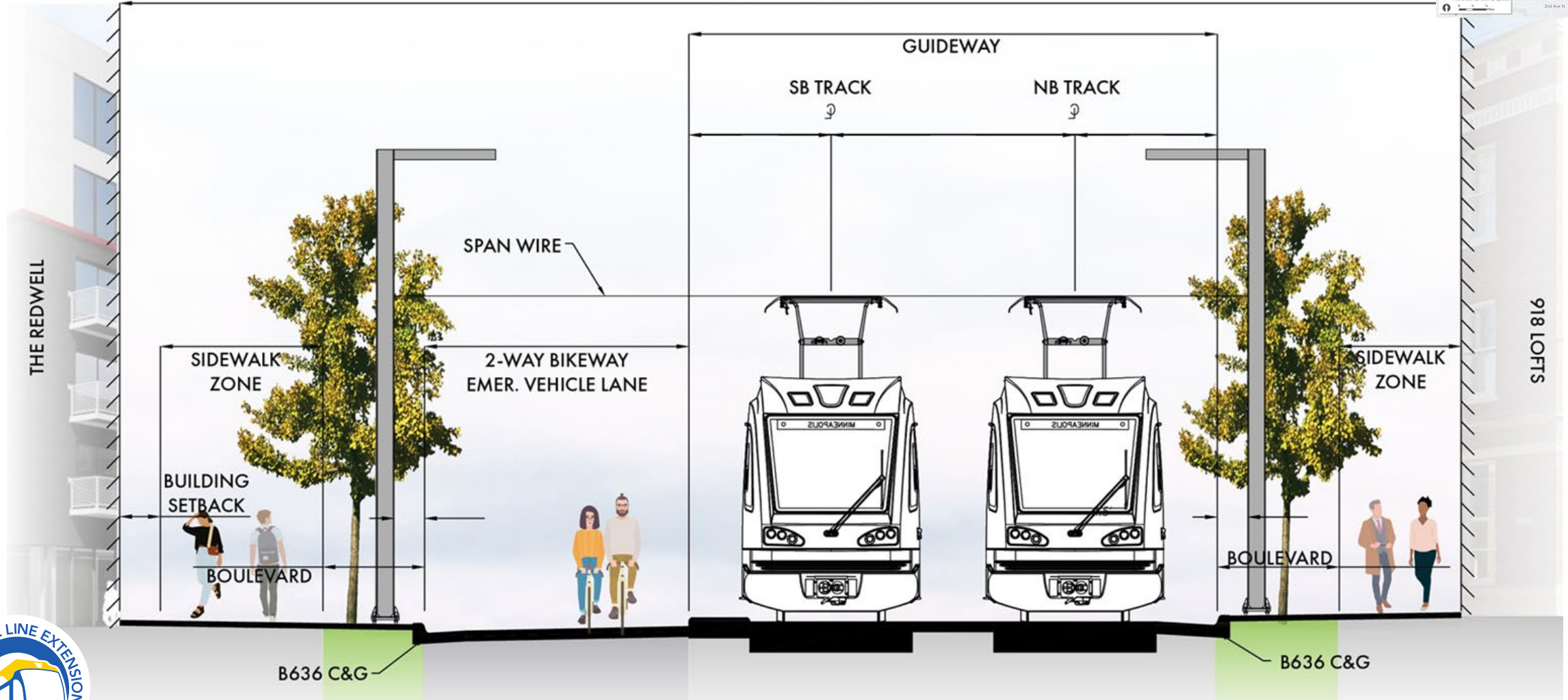

10th Ave: Transit Mall Option



66.0' EXISTING ROW

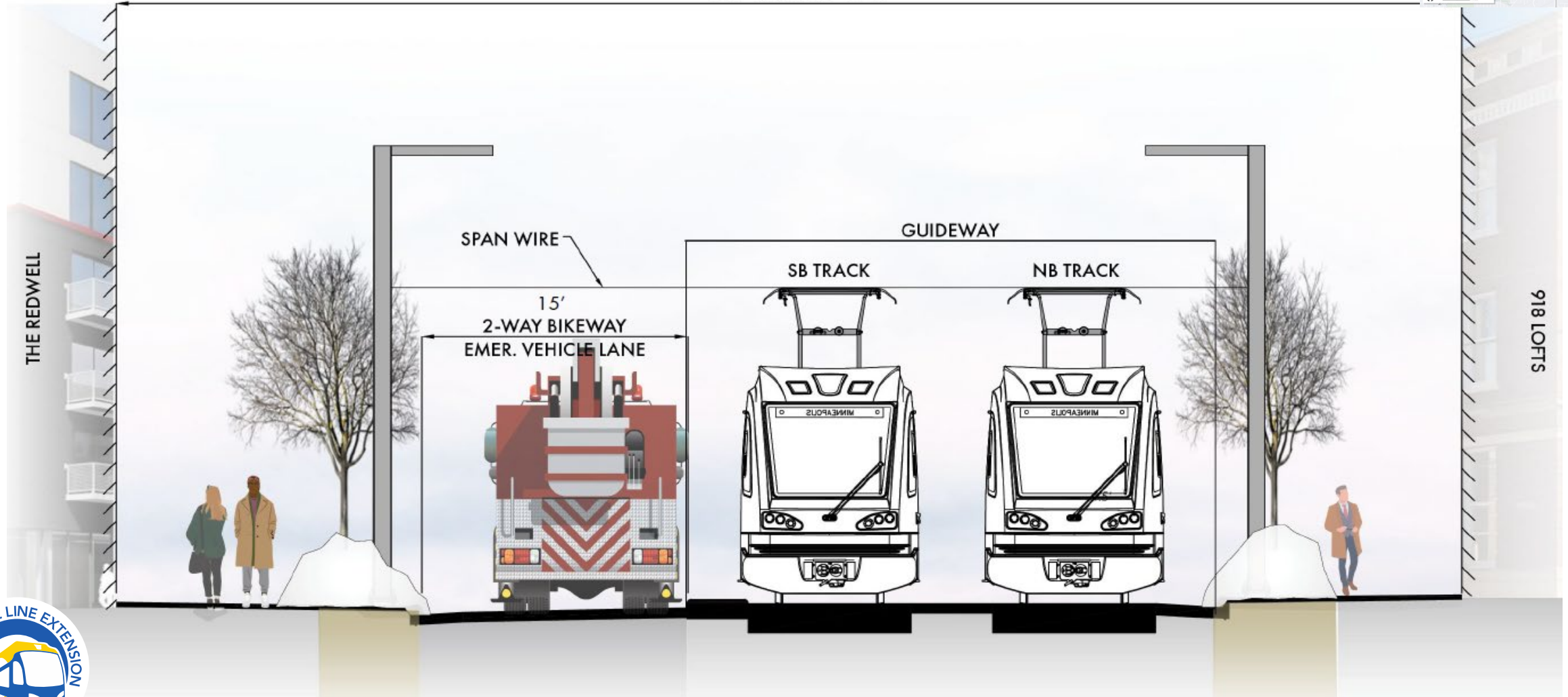

10th Ave: One-way Northbound



66.0' EXISTING ROW

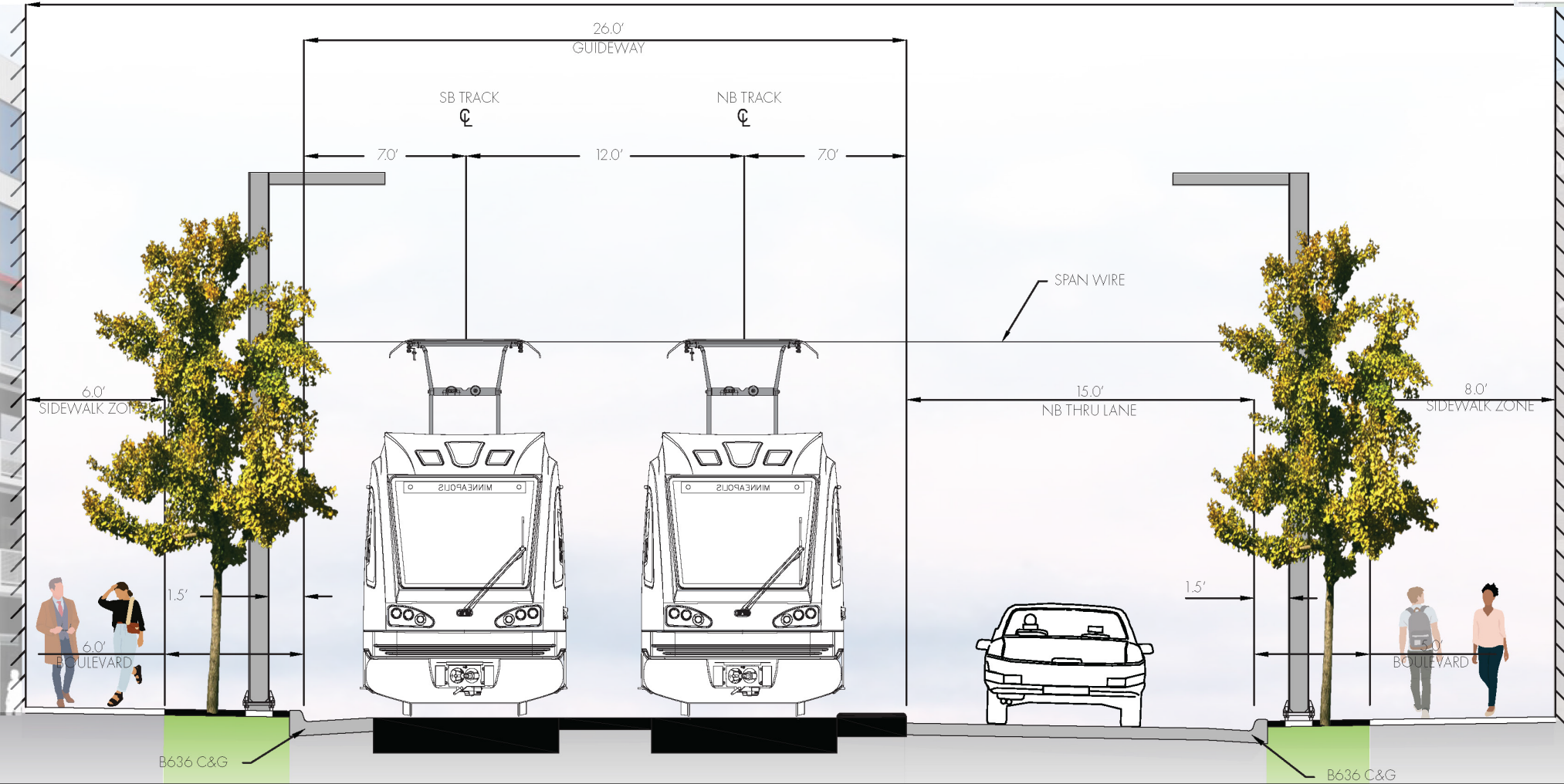

10th Ave Area: Potential Vehicle Access

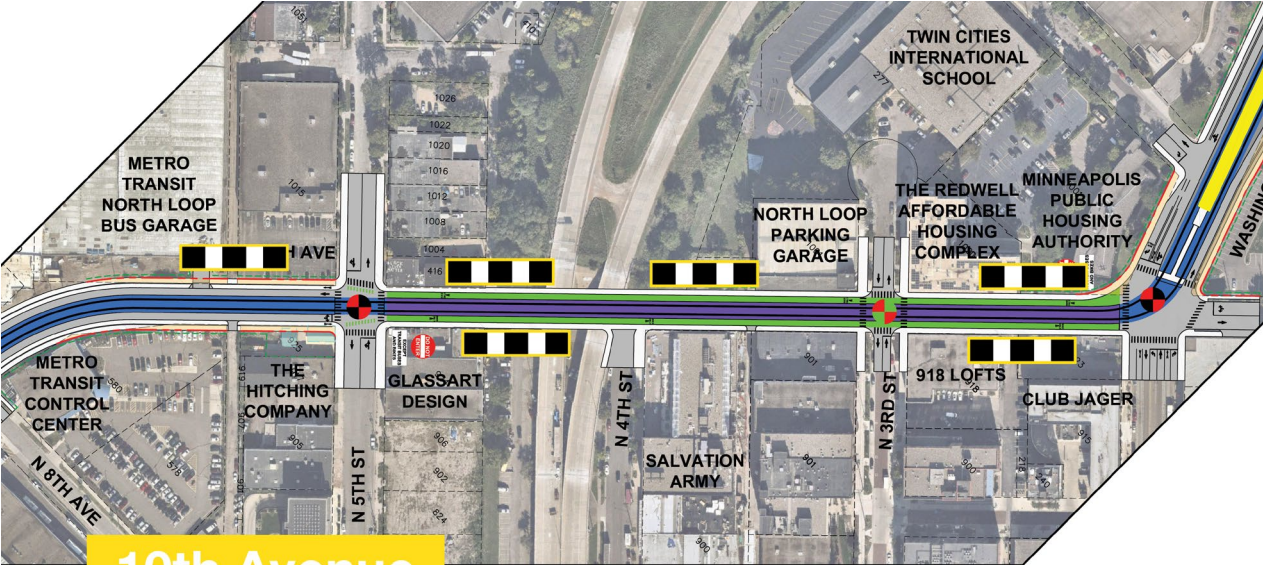

10th Avenue

LEGEND

Access Modifications

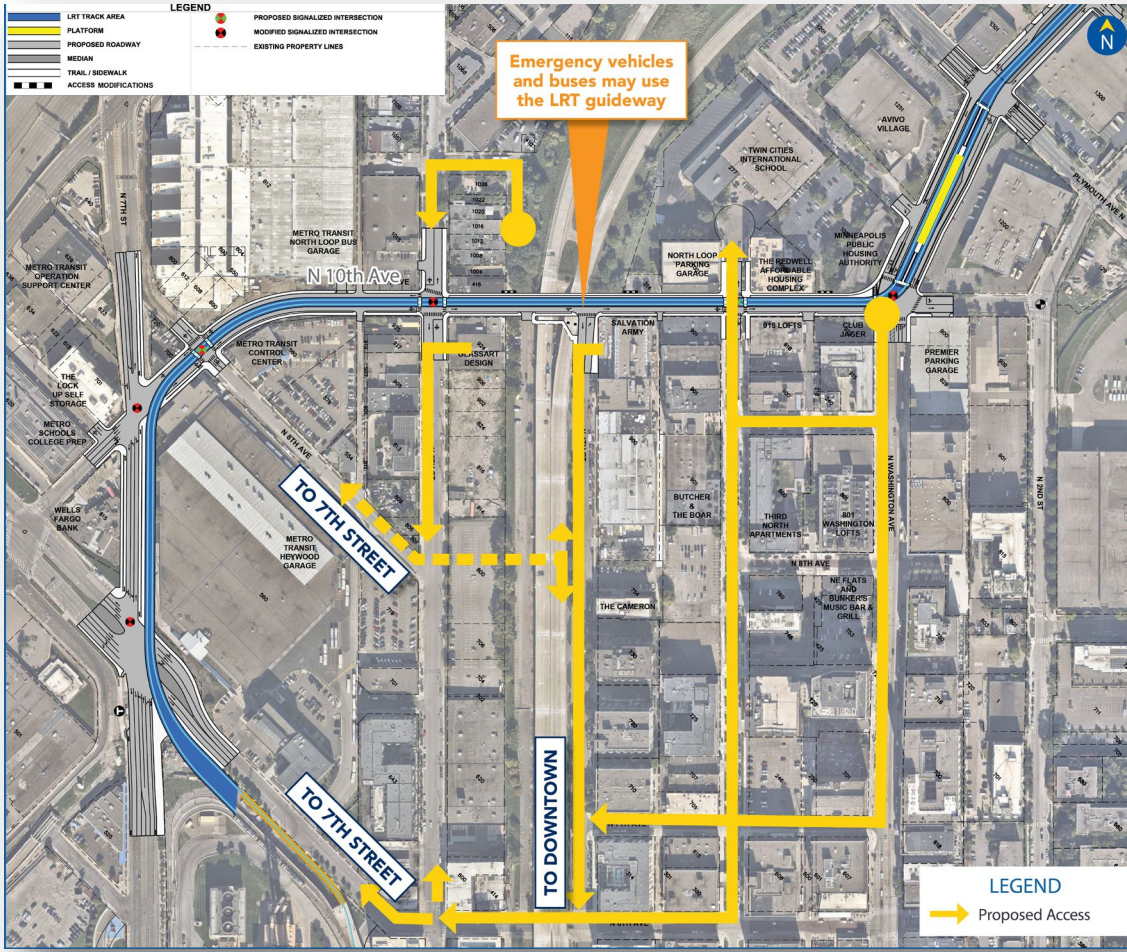

Emergency vehicles and buses may use the LRT guideway

LEGEND
Proposed Access



10th Ave Area: Continuing Engagement

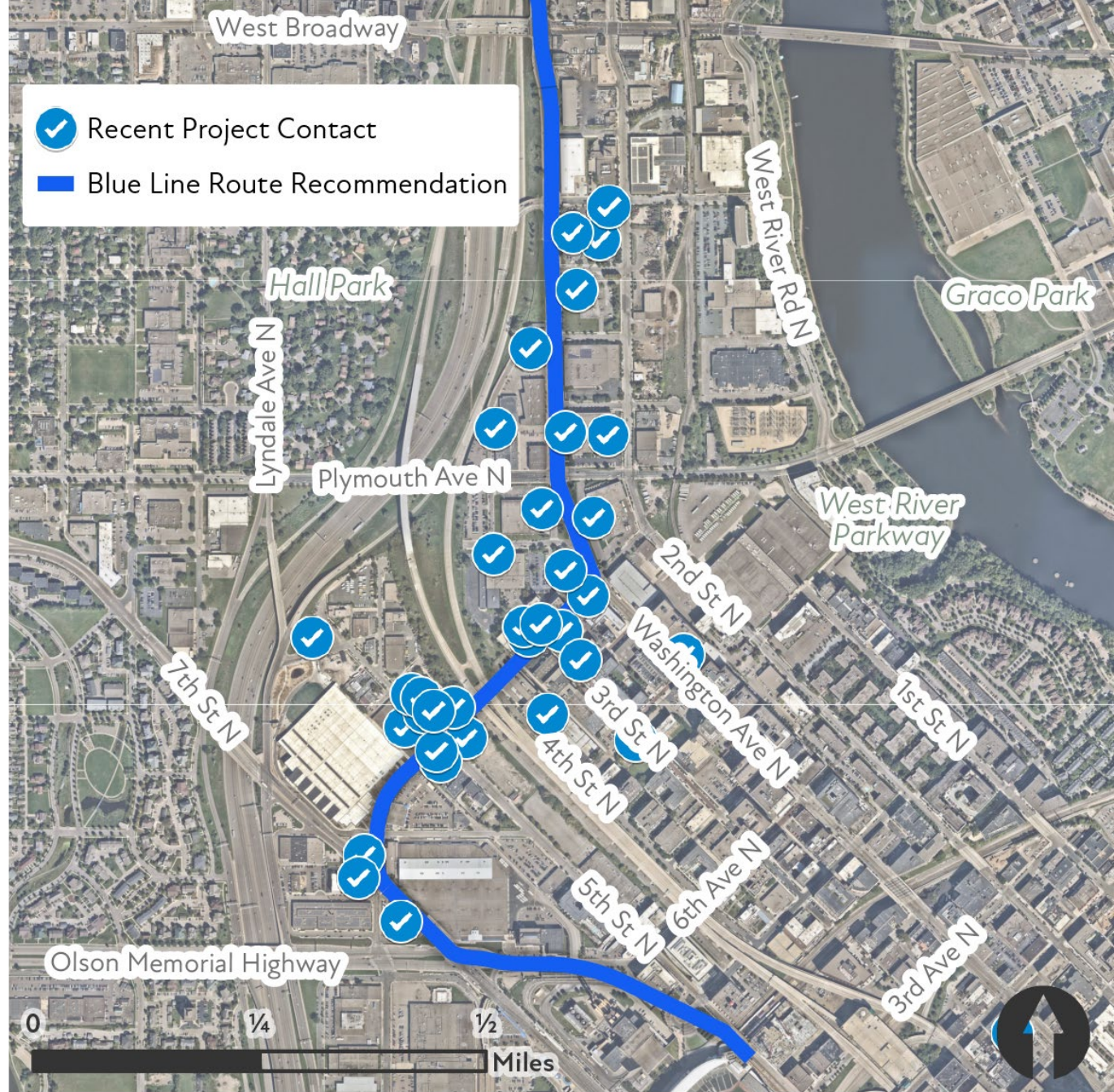

Final Minneapolis Route Recommendation

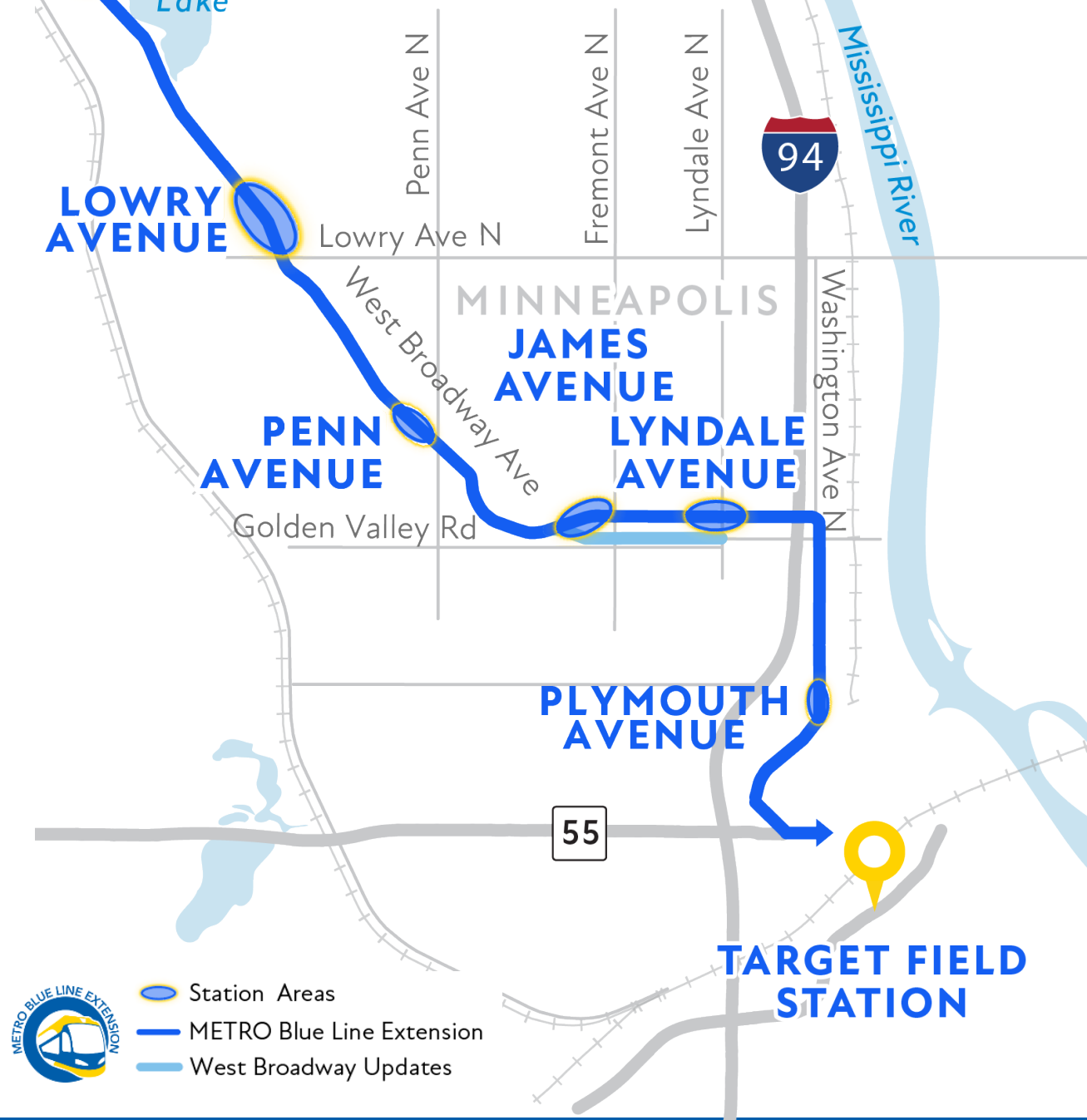

Interactive Feedback Map

54 comments from 3/19 through 7/22

Route Comments

Prefer East of I-94

- Displacement on Lyndale
- Development opportunities
- Impact on businesses (North Loop)
- Impact on residents (on Lyndale)

Prefer East of I-94 sub-option

- More accessible/serves more people

Prefer Lyndale

- Development opportunities
- Serves more people and destinations

Prefer West Broadway

- Avoids impact on residents

Prefer 21st

- West Broadway is too busy



Interactive Feedback Map

General Comments

- Concerns about displacement and project cost
- Concerns about parking
 - East of I-94 south of Plymouth
- Concerns about business impact
 - Flyover bridge south of 17th Ave
- Desire for lane reductions/lower traffic speeds on West Broadway
- Development opportunities
- Route needs to serve people and destinations

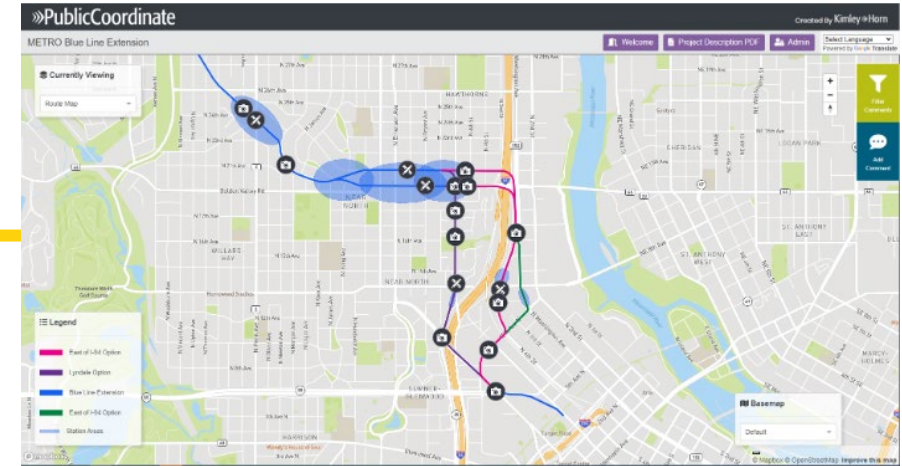

Anti-displacement Update



Anti-displacement Update

- Survey responses
- Timeline for Anti-Displacement work
- Corridor partner meeting

YourBlueLine.org/Anti-displacement

✓ 6,300 unique visits to web page

✓ Full report downloaded more than 1,000 times



Anti-displacement Survey Responses

- **Question 1: What desired outcomes of anti-displacement strategies are most important to you?**
 - Community empowerment and transparency in the decision-making process and support of residents and businesses throughout all phases of the project were the most desired outcomes of anti-displacement strategies
- **Question 2: Which anti-displacement strategies would you personally prioritize?**
 - Affordable housing preservation/development, limitation of investor purchasing/corporate ownership, and small business support were anti-displacement strategies that should be prioritized
- **Question 3: Are there other anti-displacement policies or strategies you think should be considered?**
 - Themes included commitment to community development that specifically increases safety, walkability and urban amenities in the corridor and economic renewal and opportunity to local businesses as a result of the Blue Line Extension

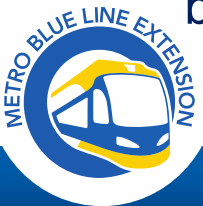

Anti-displacement Timeline

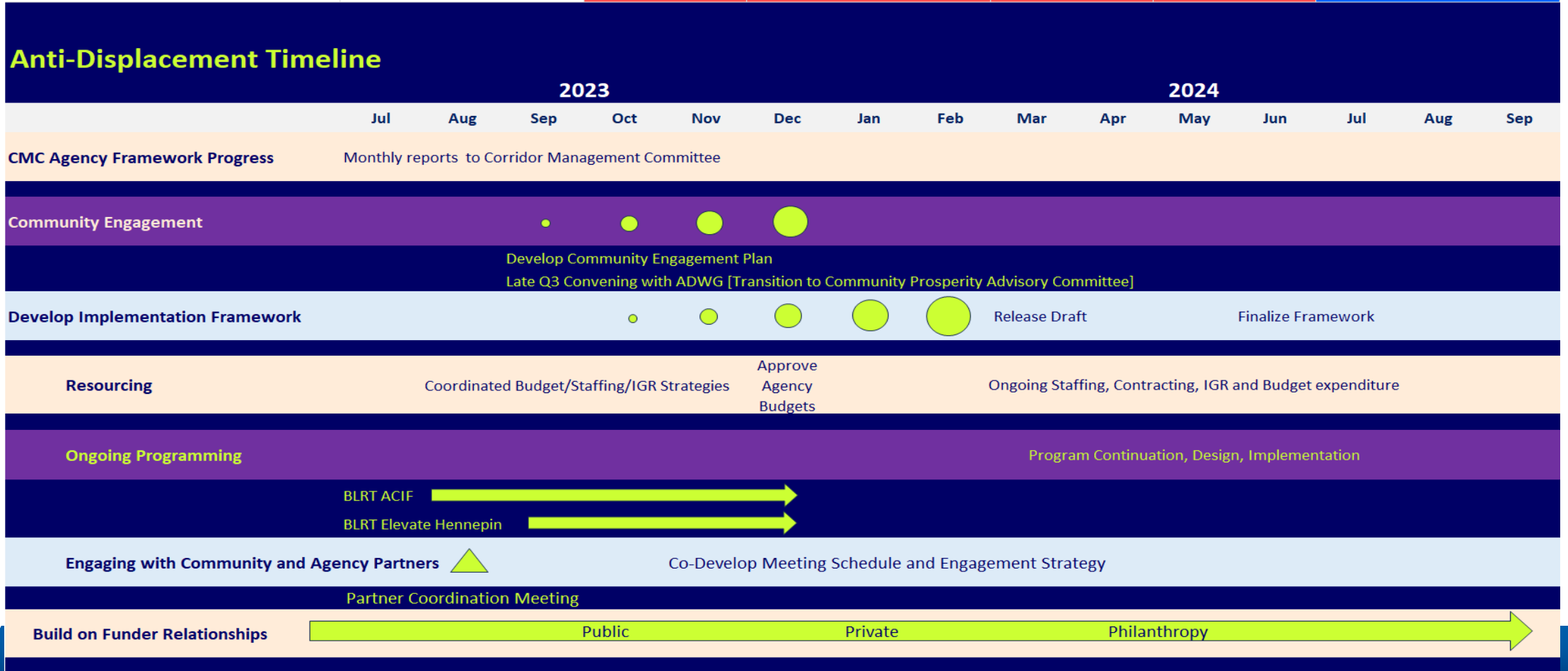
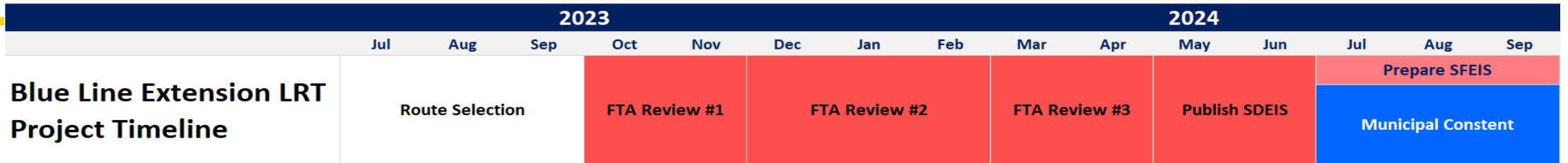

Corridor Partner Meeting

- Action per CMC Resolution:
 - Work in partnership with the project sponsors
 - Coordinate, explore, and develop a proposed framework and public engagement plan
 - With community members, public, non-profit, philanthropic, and private sector partners
 - In order for the project to attain the Report's recommended outcomes, including securing funds needed for implementation
 - For anti-displacement measures before, during and after the construction of the Blue Line Extension.



Illustrations by
Cori Nakamura Lin



Next Steps



CMC Proposed Action in September

- A proposed CMC resolution will confirm:
 - **Line** – a singular alignment for the Blue Line Extension tracks
 - **Lanes** – how the roadway system accommodates the tracks
 - **Stations** – the location for planned stations
- Guides the Supplemental Draft Environmental Impact Statement (SDEIS) development and FTA's review
- Forms the basis for ongoing development of the Municipal Consent plans



Municipal Consent in 2024

- Municipal Consent will begin Spring 2024
 - Seeks to confirm “*local approval of the preliminary design plans*”
 - Includes a public hearing
 - Triggers FTA review of the Supplemental Final EIS (SFEIS)
- Municipal Consent ~30% design plans include:
 - Tracks
 - Bridges
 - Stations
 - Roads
 - Support Structures



Stay connected

- **BlueLineExt.org**
 - For the latest project updates and to sign up for our newsletter
 - Connect with staff for your questions or schedule a presentation
- Follow us:
 - Twitter: @BlueLineExt
 - Facebook: MetroBlueLineExtension

*“Keep up the great work in improving mobility for our region!”
~ April 2022*



A service of the Metropolitan Council

COUNTIES *Transit*
Improvement
BOARD