

# 21ST AVENUE WORKSHOP

## Online Portal and Storefronts

App for affected people and businesses:

- ✓ Relocation and anti-displacement resources
- ✓ Information regarding construction related disruptions and closures
- ✓ Other available information and resources

Storefronts in Brooklyn Park and Minneapolis:

- ✓ Gather information from contractors and staff
- ✓ Find resources during construction
- ✓ Ask project related questions
- ✓ Meeting, open house, and event space

## Public Realm Improvements

- ✓ Offset impacts to community character and improve existing infrastructure
- ✓ Modernize elements to improve experience for those who walk, roll, bike, and take transit
- ✓ Informed by community input, options include:
  - ✓ Streetscape
  - ✓ Creative Design
  - ✓ Mobility Hubs
  - ✓ Sidewalk Patterns and other Design Elements
  - ✓ Park and Ride Upgrades
  - ✓ Banners
  - ✓ Lighting
  - ✓ Benches
  - ✓ Pedestrian Safety Improvements



# 21ST AVENUE WORKSHOP

## Cultural Placekeeping

- ✓ Retain and strengthen the many cultures and histories along the Route
- ✓ Cultural placekeeping design groups will guide creation of architectural, aesthetic, and visual elements
- ✓ Metropolitan Council will identify areas where visual design input can be incorporated
- ✓ Each city has its own cultural placekeeping group who will co-create a design with Met Council design teams

## Business Support During Construction

### Construction Support:

- ✓ Online hotline and updates
- ✓ Advance notice of access and utility disruptions
- ✓ Staff as liaisons for communication between businesses and contractors
- ✓ Public Informational Sessions

### Business support:

- ✓ Business advertising
- ✓ Provide wayfinding for customers

## Workforce Development

- ✓ Improve job prospects and lower indirect displacement risks by economic conditions through increased workforce development
  - ✓ Collaborating with the community
  - ✓ Guided by contractors the public and other interested parties
- ✓ Develop apprenticeships, trainings, and mentorship programs
- ✓ Hosting information sessions with subcontractors, vendors, the public, and workforce development agencies
- ✓ Creating job related events
  - ✓ Job fairs, educational opportunities
- ✓ Implement local hiring initiatives
- ✓ Support small businesses through Metropolitan Council Underutilized Business Program (MCUB)
  - ✓ Procuring items under \$25,000



Blue Line Extension staff are seeking your feedback and input on community programs and organizations to address community needs and offset impact. Place dots on your top 3 that you think the Project should prioritize.

**Down Payment Assistance**

**Home Repair Programs**

**Affordable Housing Preservation and Development**

**Business Technical and Financial Assistance**



**Housing Cost Assistance**

**What other community programs and/or organizations the Project should prioritize?**



# 4TH STREET



Existing view of 21st Ave and 4th St looking west



# LYNDALE AVENUE

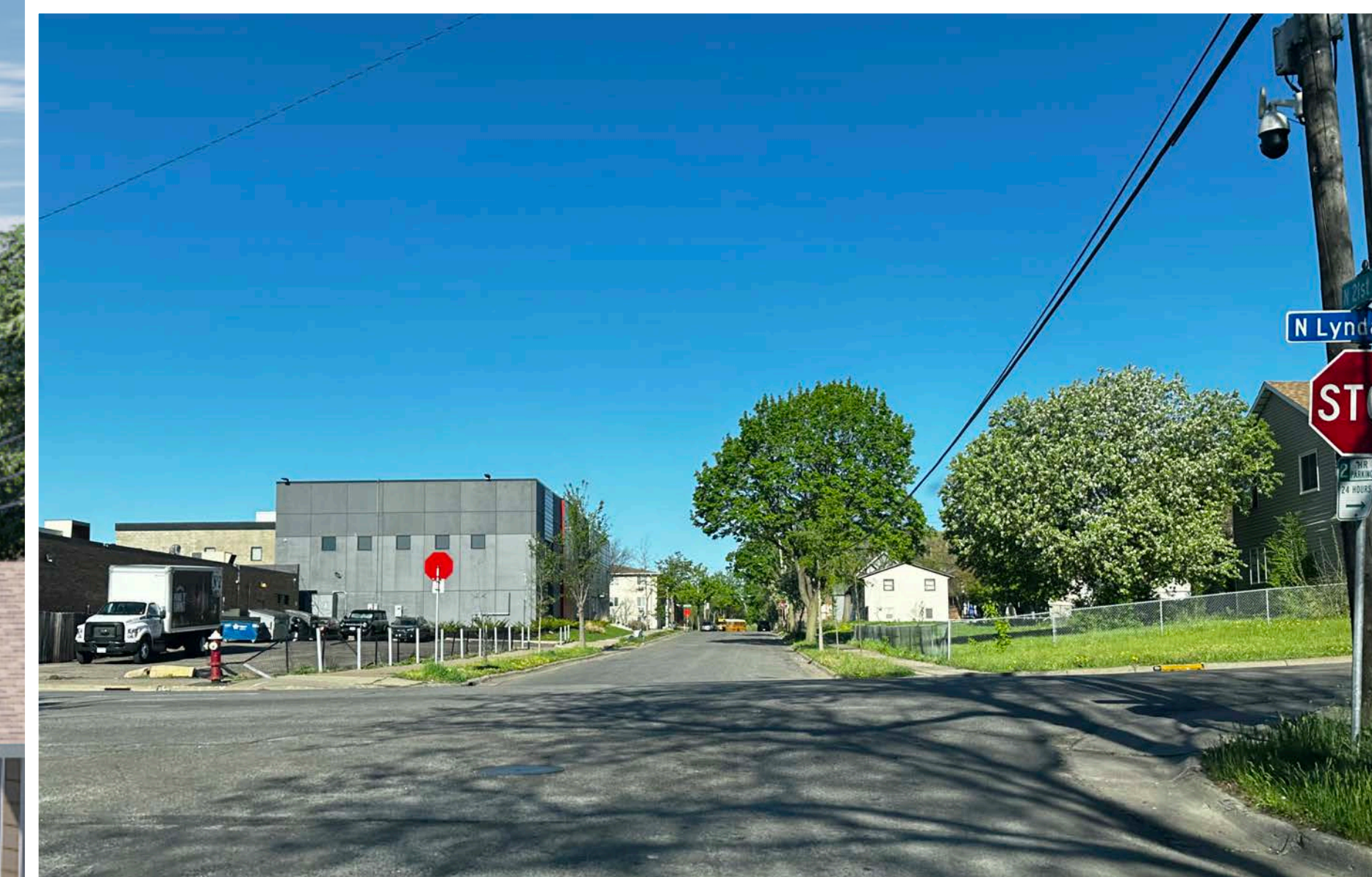

Existing view of 21st Ave and Lyndale Ave looking west



# ALDRICH AVENUE



Existing view of 21st Ave and Aldrich Ave looking west



# BETWEEN ALDRICH AVENUE & BRYANT AVENUE



Existing view of 21st Ave between Aldrich Ave and Bryant Ave looking west



# BRYANT AVENUE



Existing view of 21st Ave and Bryant Ave looking west





# DUPONT AVENUE

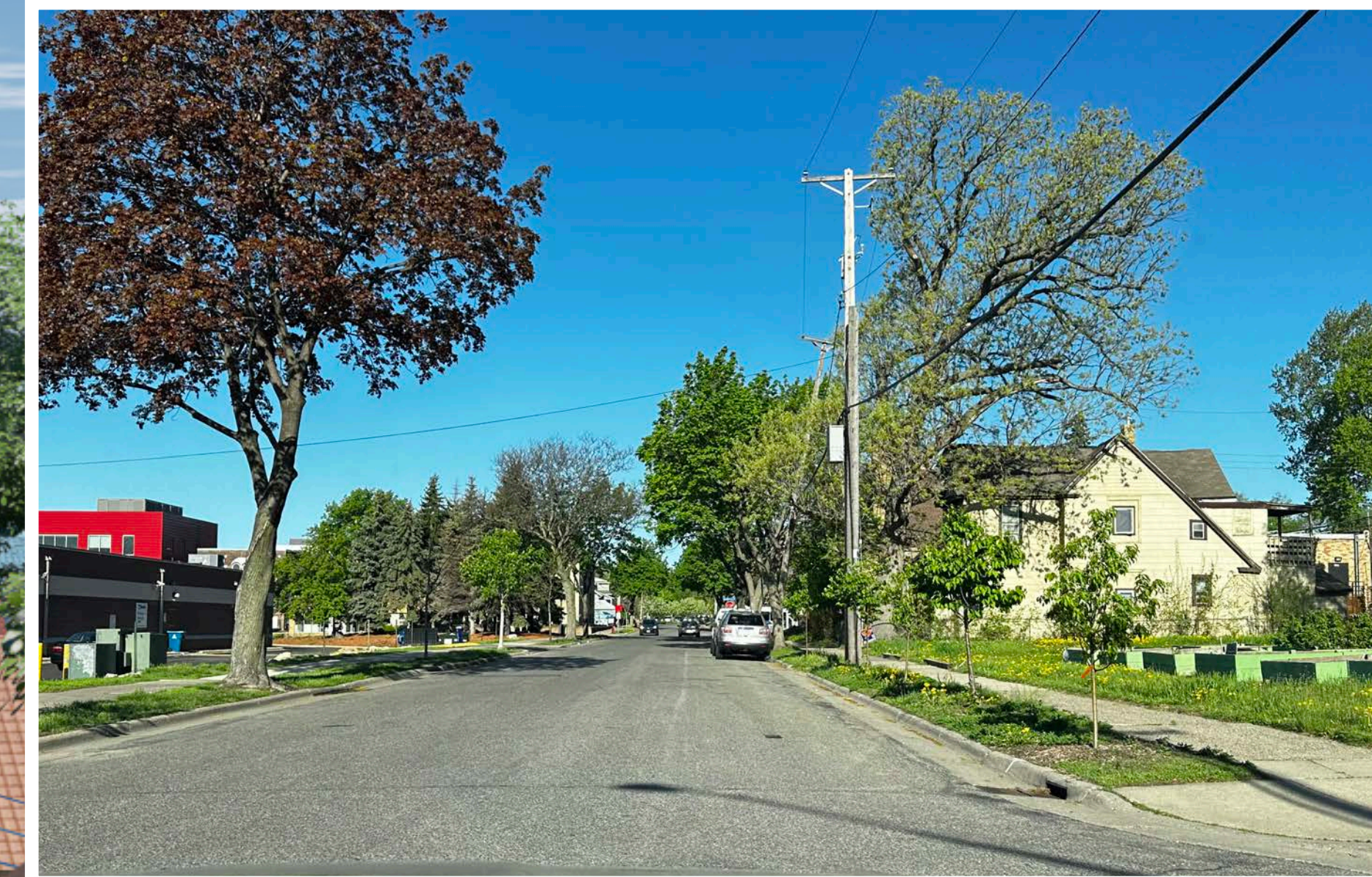

Existing view of 21st Ave and Dupont Ave looking west



# EMERSON AVENUE

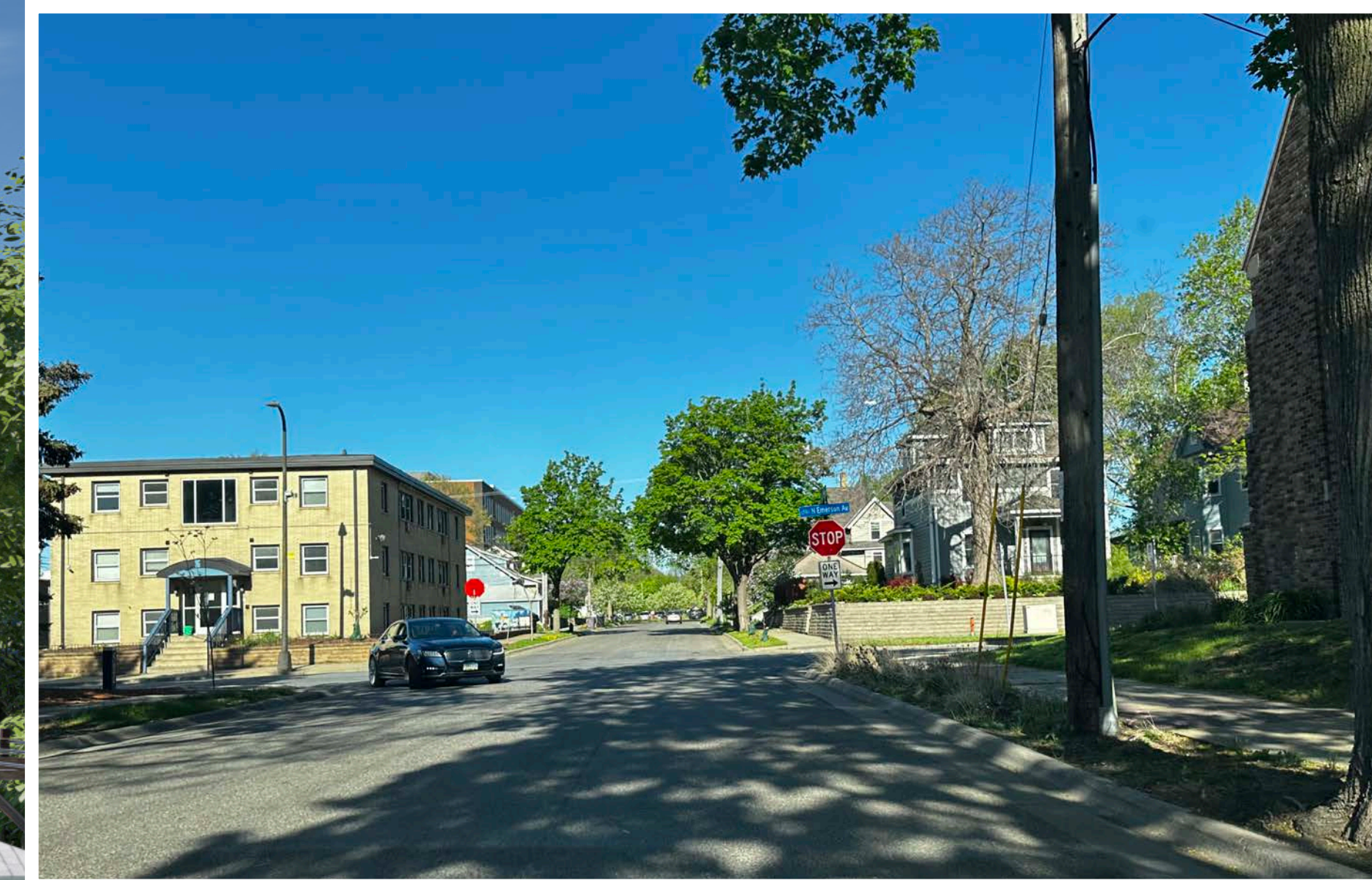
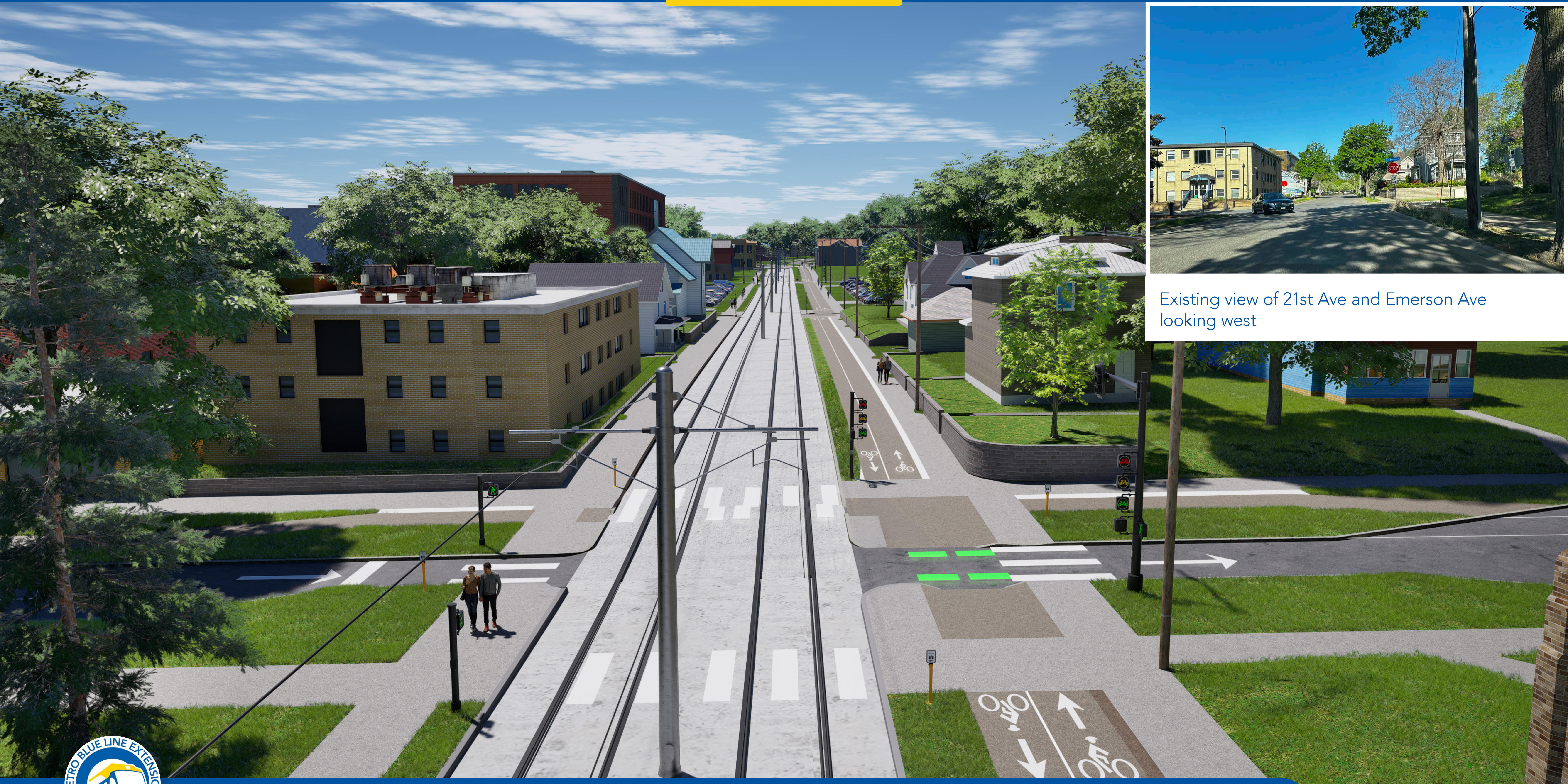

Existing view of 21st Ave and Emerson Ave looking west



# GIRARD AVENUE



Birdseye existing view of Girard Ave looking west on 21st Ave



# HILLSIDE AVENUE TO JAMES AVENUE



Birdseye existing view of Hillside Ave and James Ave looking west on 21st Ave

