

APRIL 2015

## Station Area Character

- At base of berm, east of Louisiana and Oxford intersection
- South of Cedar Lake Trail and freight rail tracks
- Proposed park-and-ride lot and passenger drop-off
- Bus connections on Louisiana Avenue South at Oxford Street
- North of Park Nicollet Methodist Hospital
- Adjacent redevelopment anticipated
- Proposed bike parking



Cedar Lake Trail looking east near station site.



Looking south at Louisiana Avenue and Oxford Street to Park Nicollet Methodist Hospital.

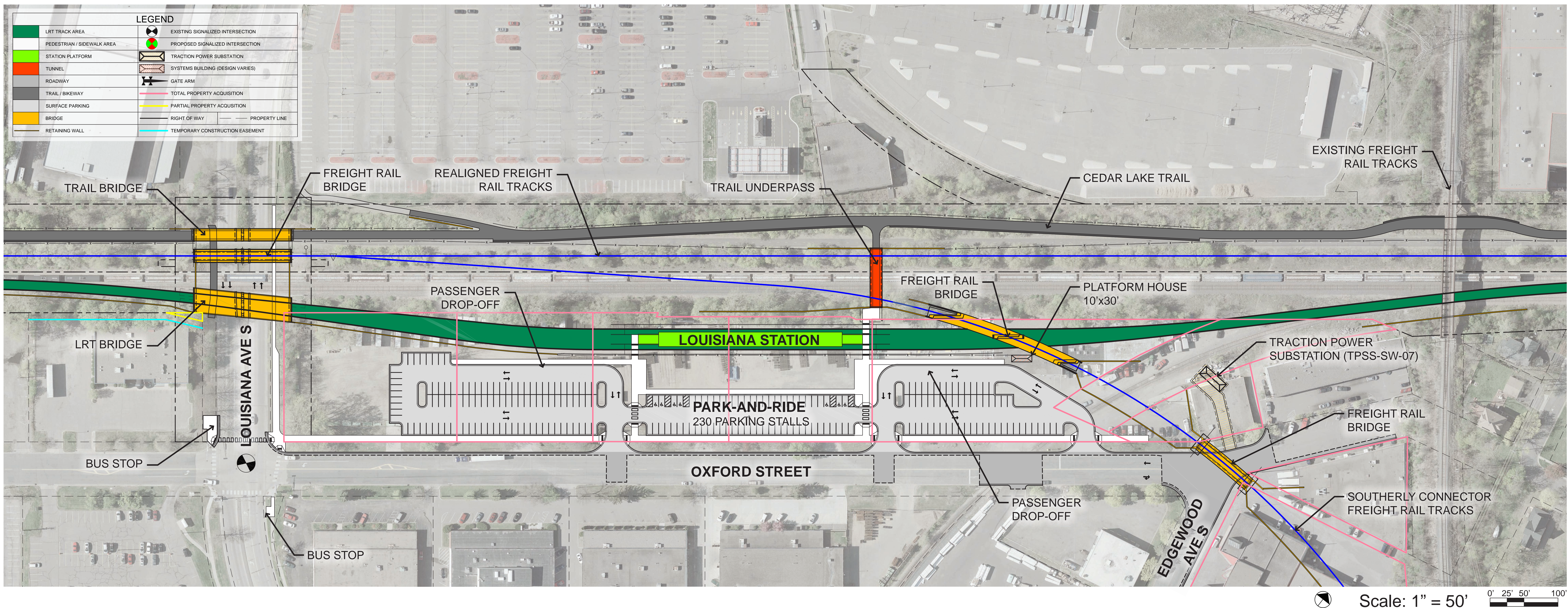



# Wooddale Station Site

ST. LOUIS PARK

APRIL 2015

## Station Area Character

- Adjacent to newer mixed-use development and established neighborhoods
- Proposed bus connections on West 36th Street at Yosemite Avenue South
- South of Cedar Lake Trail and freight rail tracks
- Adjacent redevelopment anticipated
- No park-and-ride planned
- Proposed passenger drop-off
- Proposed bike parking



Wooddale Avenue South looking east toward the station site.



Nearby apartment complex at the corner of Wooddale Avenue South and West 36th Street.

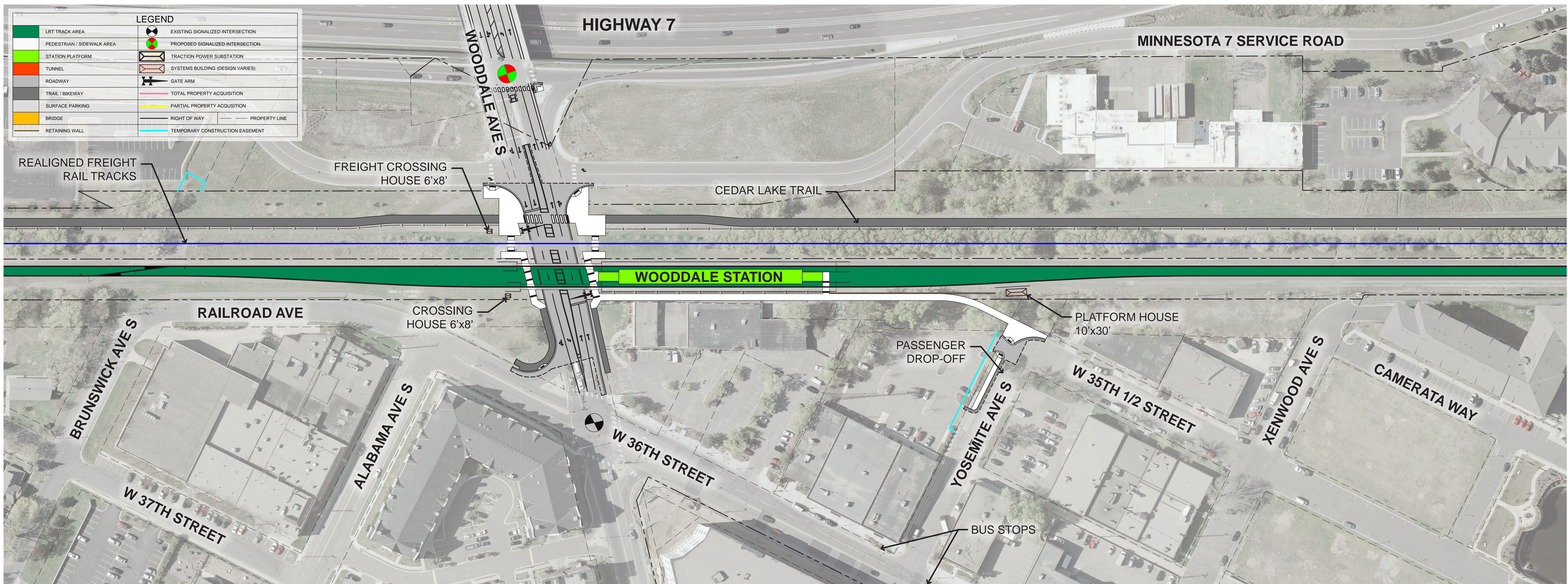

Scale: 1" = 50' 0' 25' 50' 100'



APRIL 2015

## Station Area Character

- Adjacent to multi-family, commercial, and industrial uses
- South of CSAH 25
- Proposed park-and-ride lot with opportunity for joint development
- Proposed bus connections, passenger drop-off, and bike parking near station
- South of Cedar Lake Trail and freight rail tracks
- Located near Bass Lake Preserve
- Adjacent redevelopment anticipated



Near Beltline Boulevard looking east toward the station site.



Cedar Lake Trail looking east toward Nordic Ware.

