

# Kenilworth Corridor: View North From South Portal

NOVEMBER 2015



TREES REPRESENT 25 YEARS GROWTH

**DRAFT WORK IN PROCESS**

# Kenilworth Corridor: View Towards 21st Street Station

NOVEMBER 2015



TREES REPRESENT 15 YEARS GROWTH

**DRAFT WORK IN PROCESS**

# Kenilworth Corridor: View Towards Penn Station Plan

NOVEMBER 2015



TREES REPRESENT 15 YEARS GROWTH

**DRAFT WORK IN PROCESS**



# Kenilworth Corridor: Station Architecture

NOVEMBER 2015



West Lake Station



21st Street Station

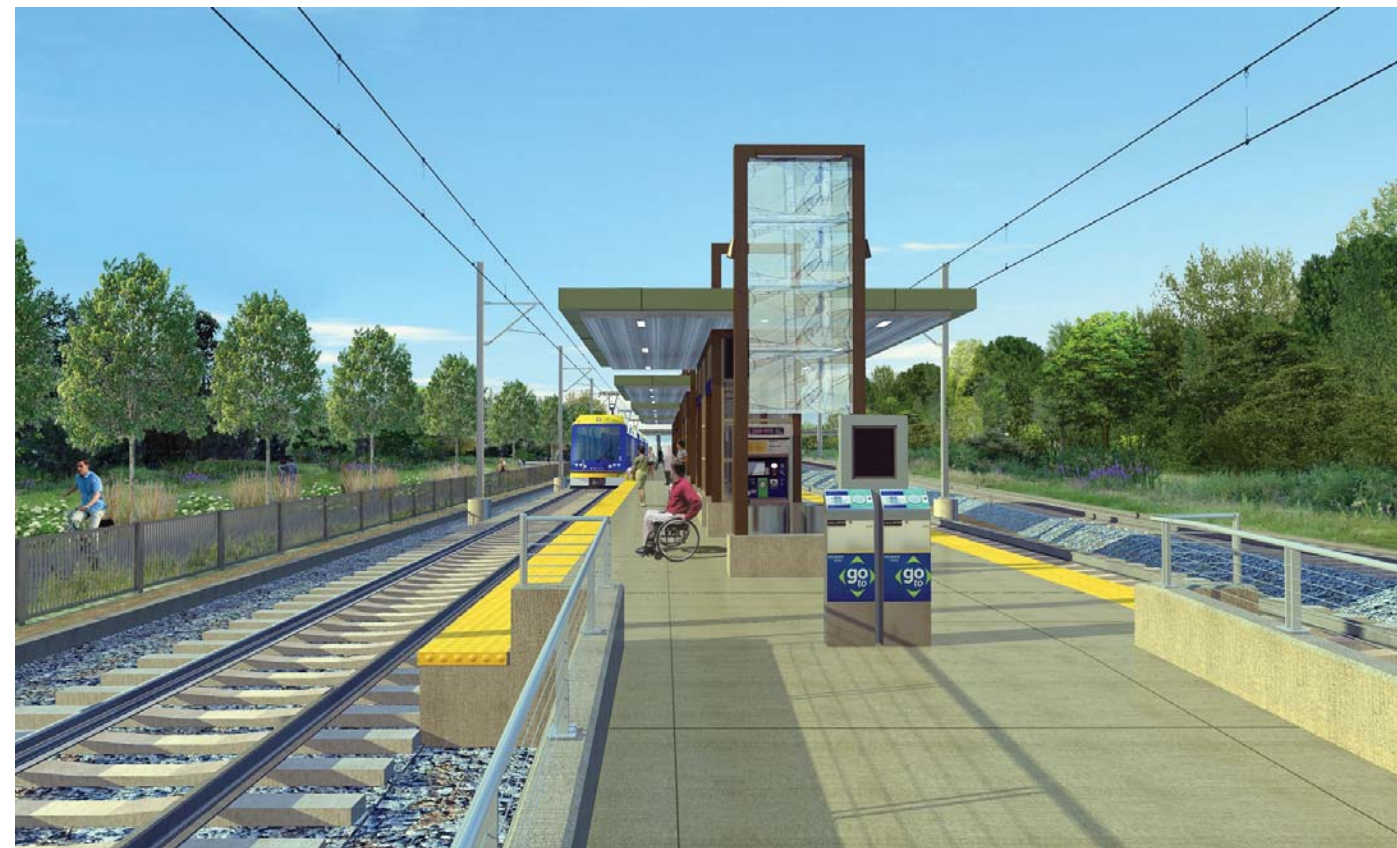

Penn Station



*\*Trees represent an approximate 15 year growth*

DRAFT WORK IN PROCESS

# Kenilworth Corridor: 21st Station Site Plan

NOVEMBER 2015

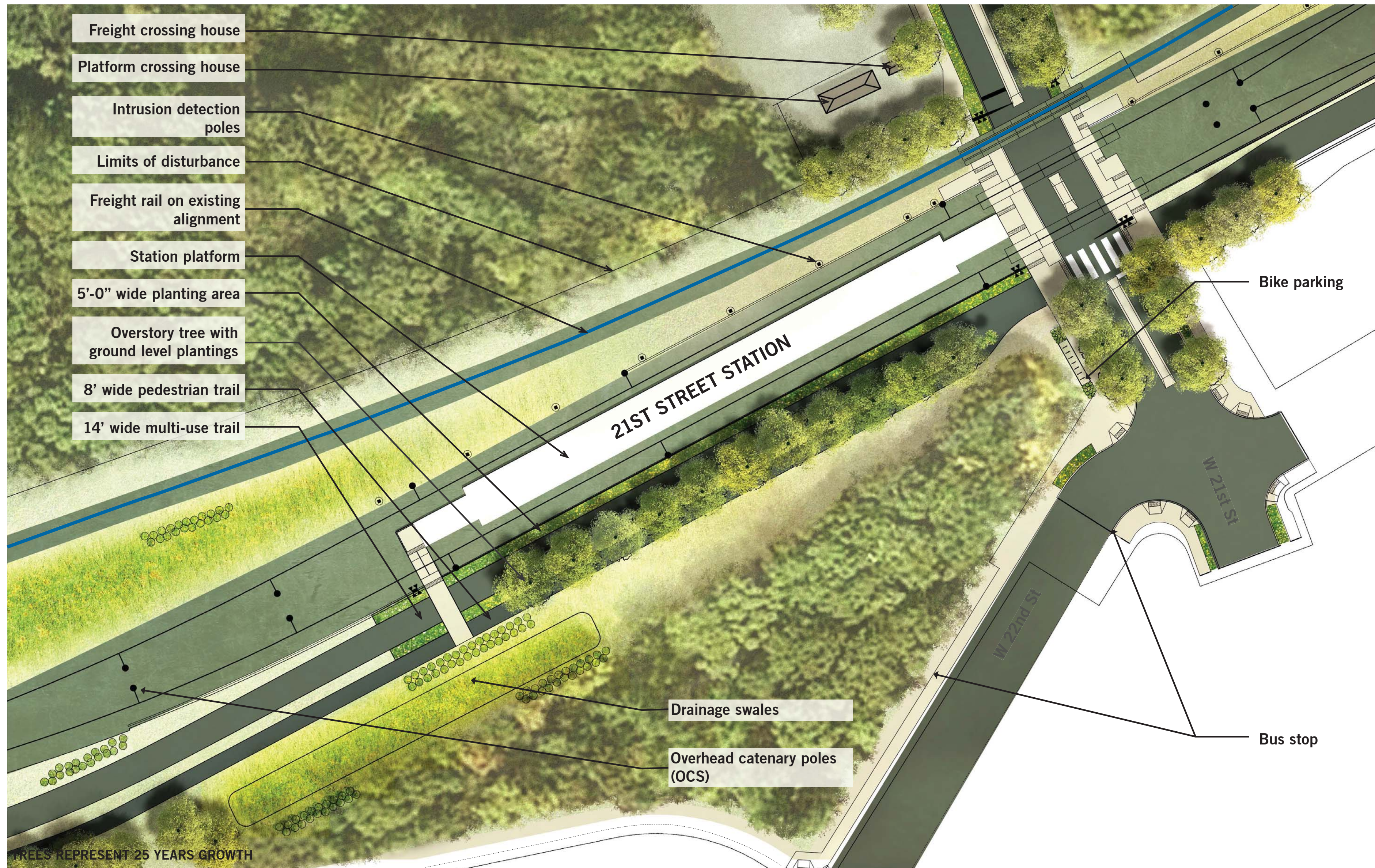

21ST STREET STATION LANDSCAPE DESIGN

SCALE: 1" = 20' 0" 10" 20" 40"

DRAFT WORK IN PROCESS

# Kenilworth Corridor: West Lake Station Site Plan

NOVEMBER 2015

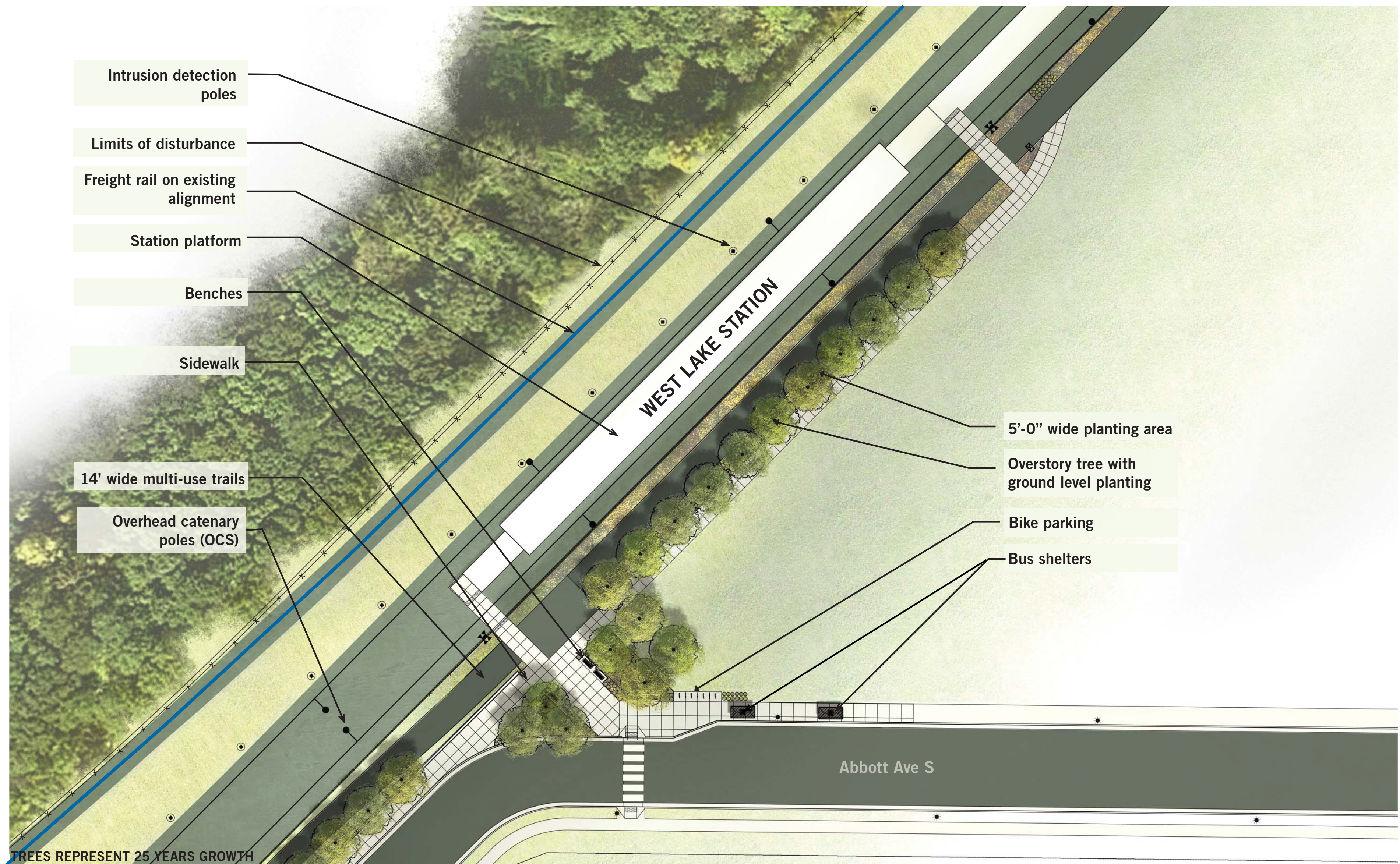

WEST LAKE STATION LANDSCAPE DESIGN

SCALE: 1" = 20' 0" 10" 20" 40"

DRAFT WORK IN PROCESS

# Kenilworth Corridor: Penn Station Site Plan

NOVEMBER 2015

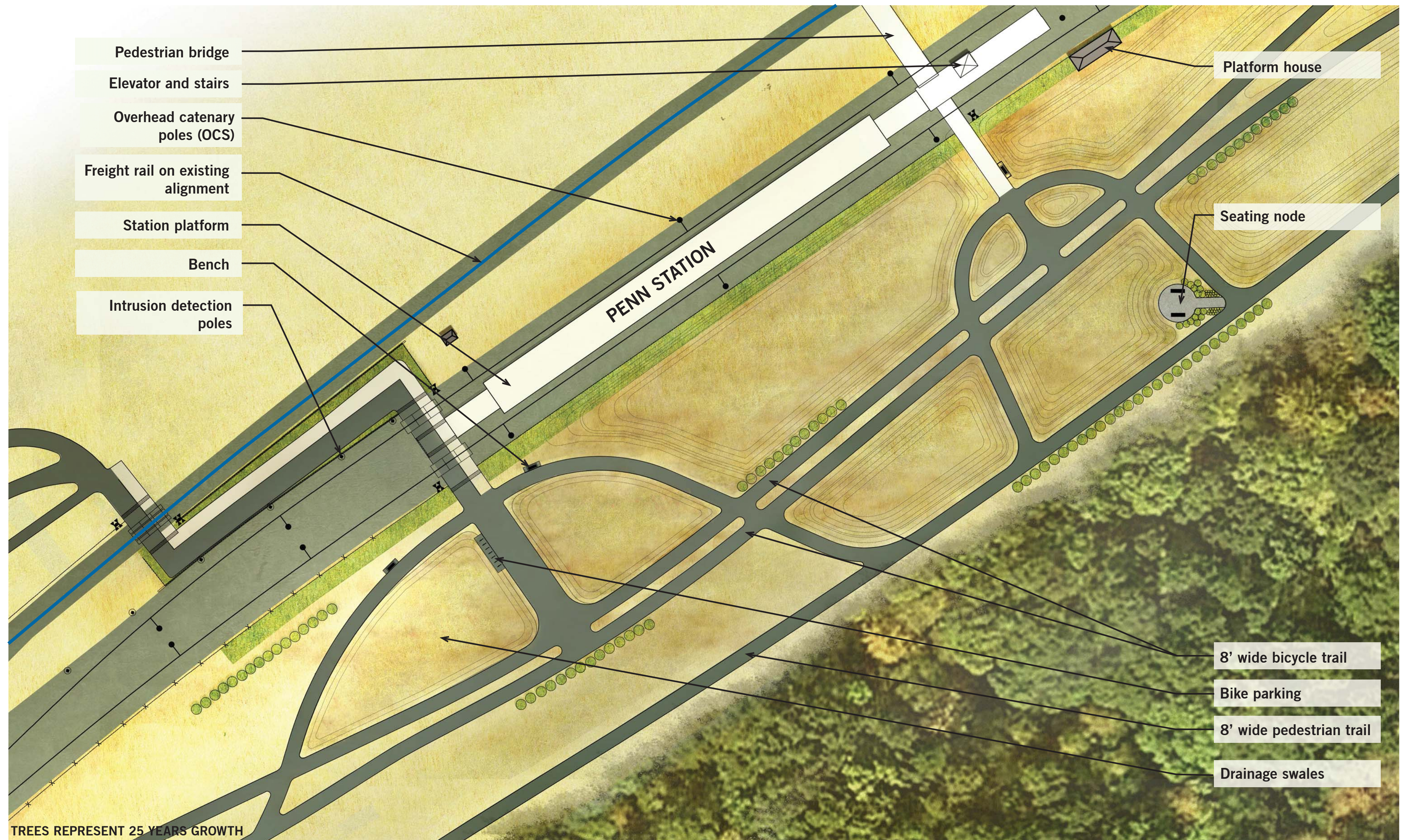

PENN STATION LANDSCAPE DESIGN

SCALE: 1" = 20' 0" 10" 20" 40"

DRAFT WORK IN PROCESS

# Kenilworth Corridor Typical Sections

NOVEMBER 2015

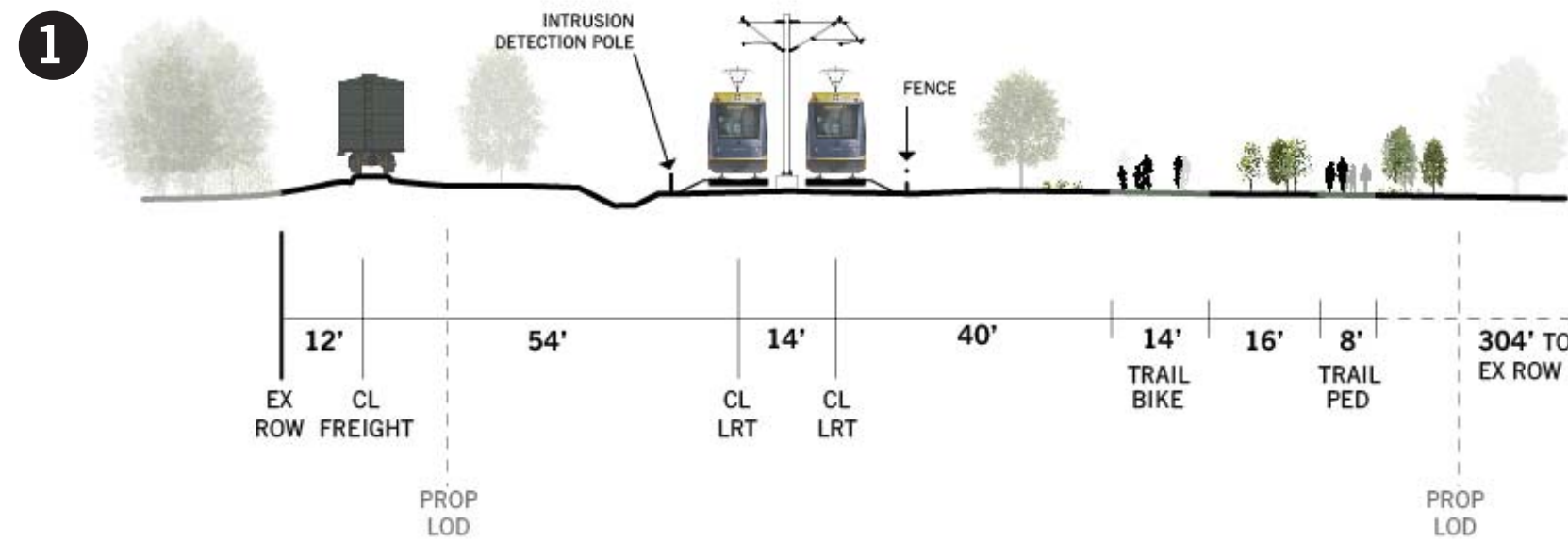

Graphic Represents Opening Day Tree Growth

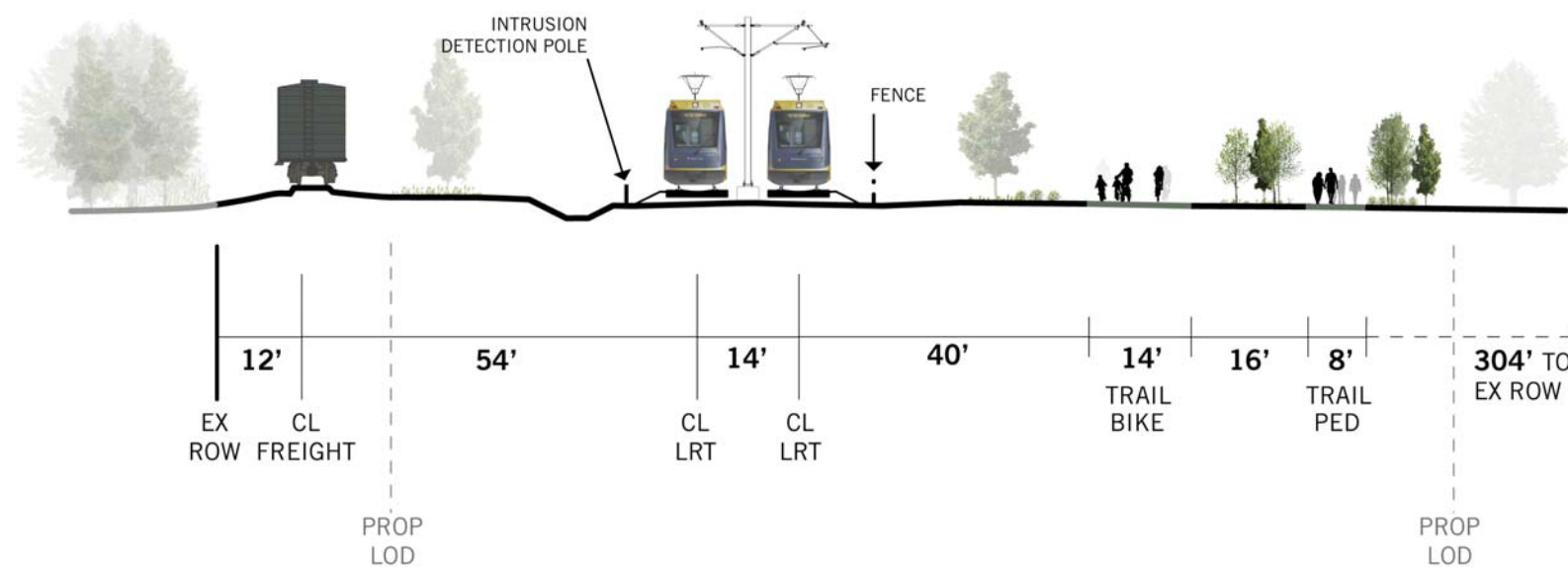

Graphic Represents 15 Year Tree Growth

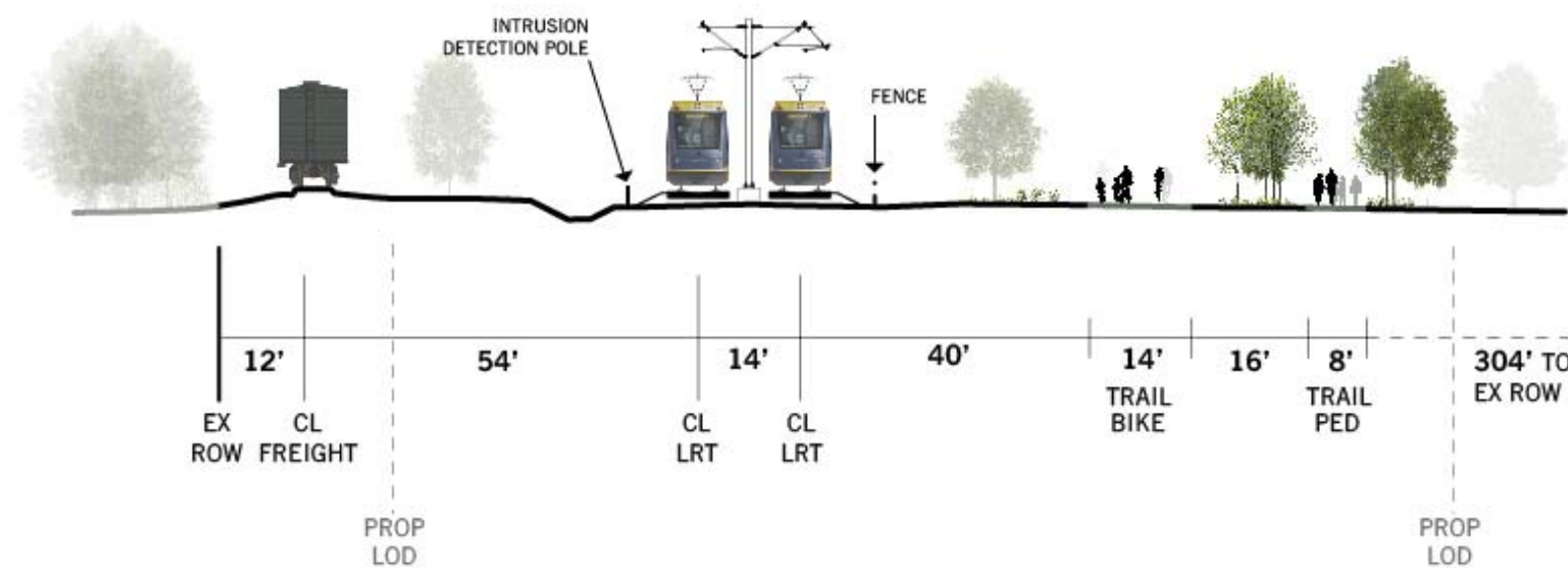

Graphic Represents 25 Year Tree Growth

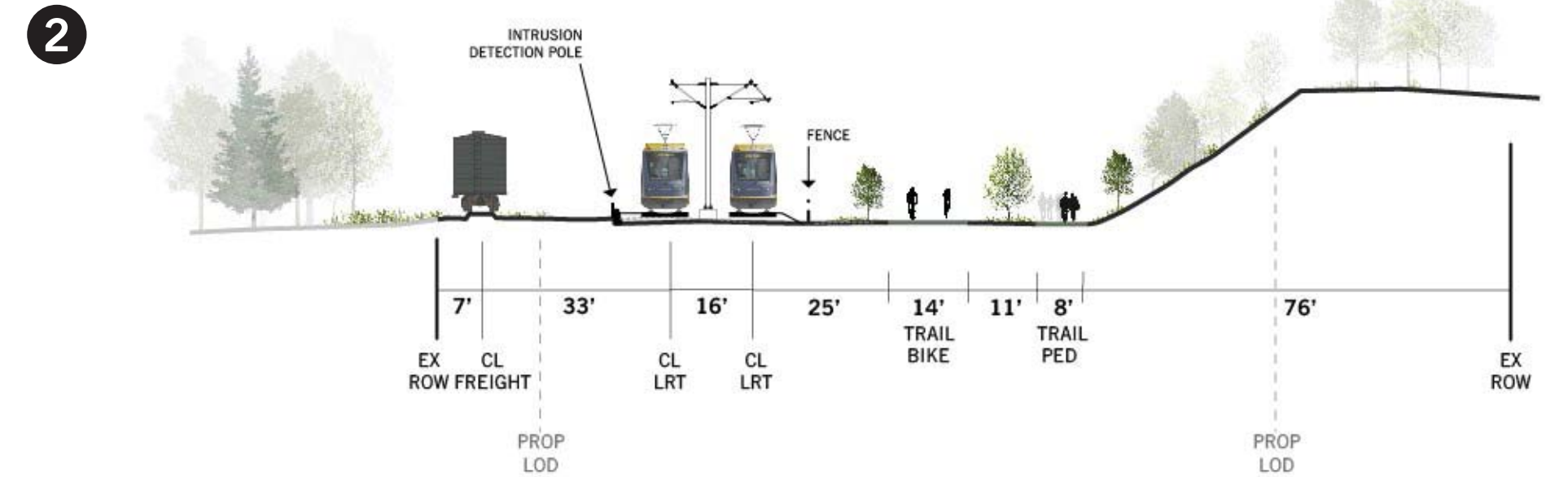

Graphic Represents Opening Day Tree Growth

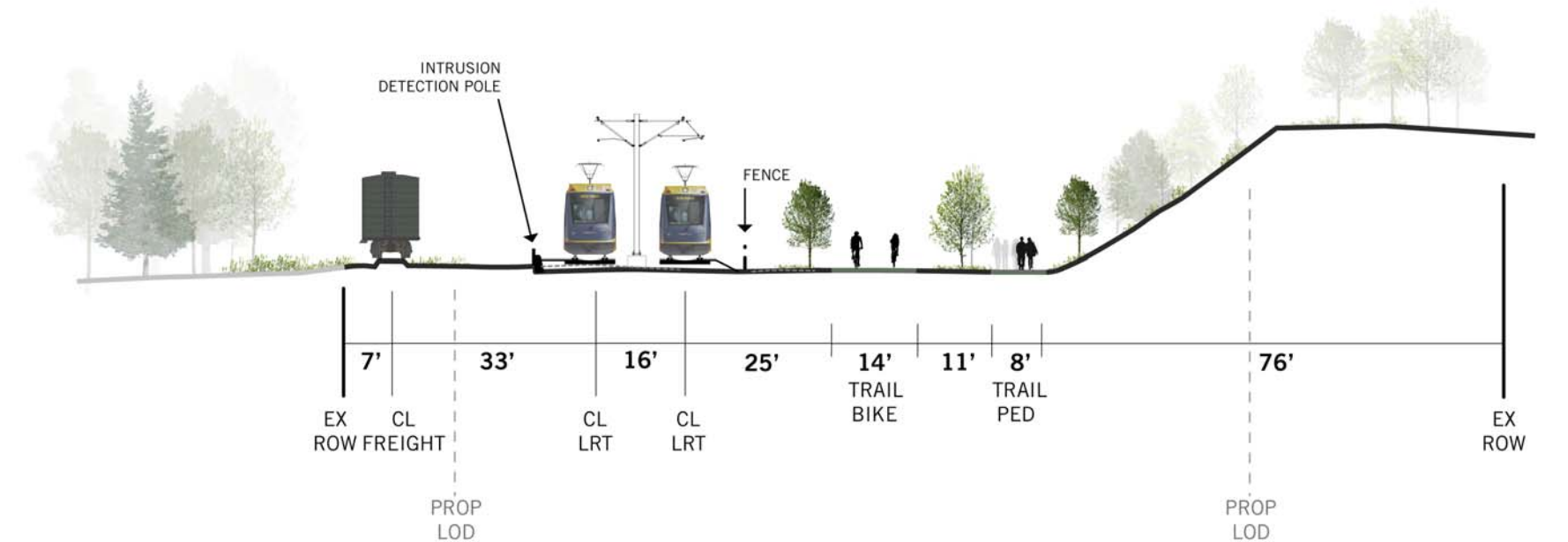

Graphic Represents 15 Year Tree Growth

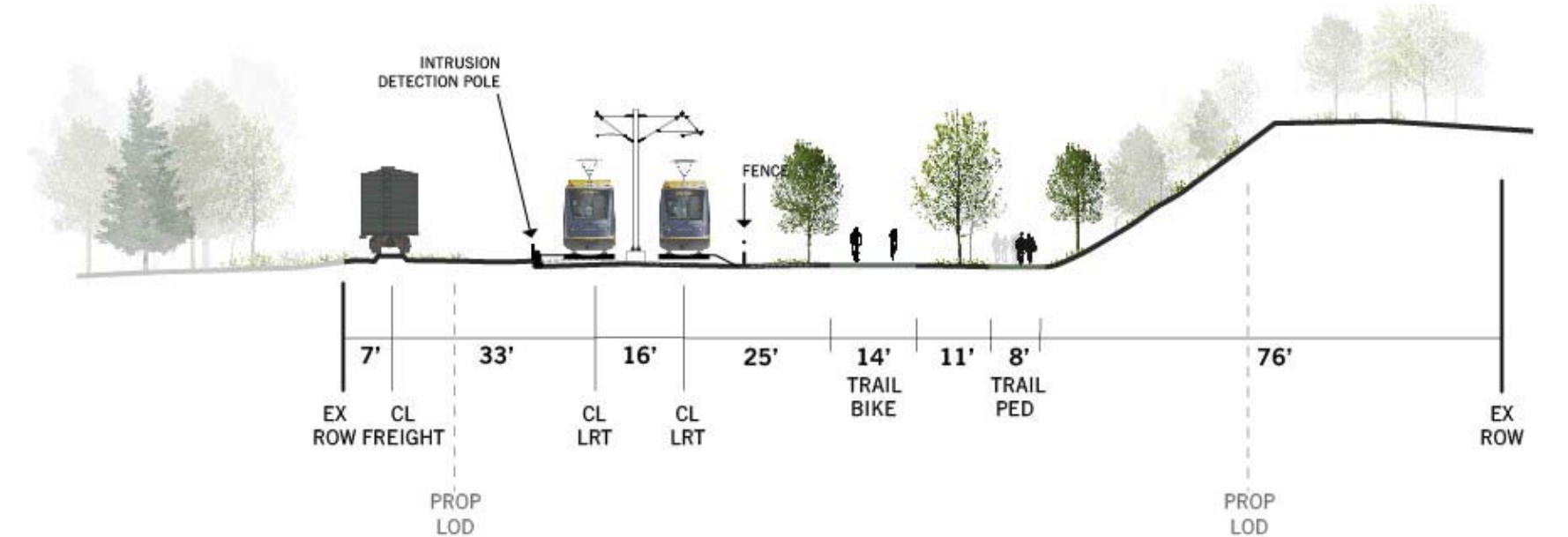

Graphic Represents 25 Year Tree Growth

**Notes:**  
All dimensions on sections are approximate.

Proposed limits of disturbance are identified as Prop. LOD in sections. LOD based on SWLRT preliminary engineering plans (Sept. 2014)

DRAFT - WORK IN PROCESS



# Kenilworth Corridor Typical Sections

NOVEMBER 2015

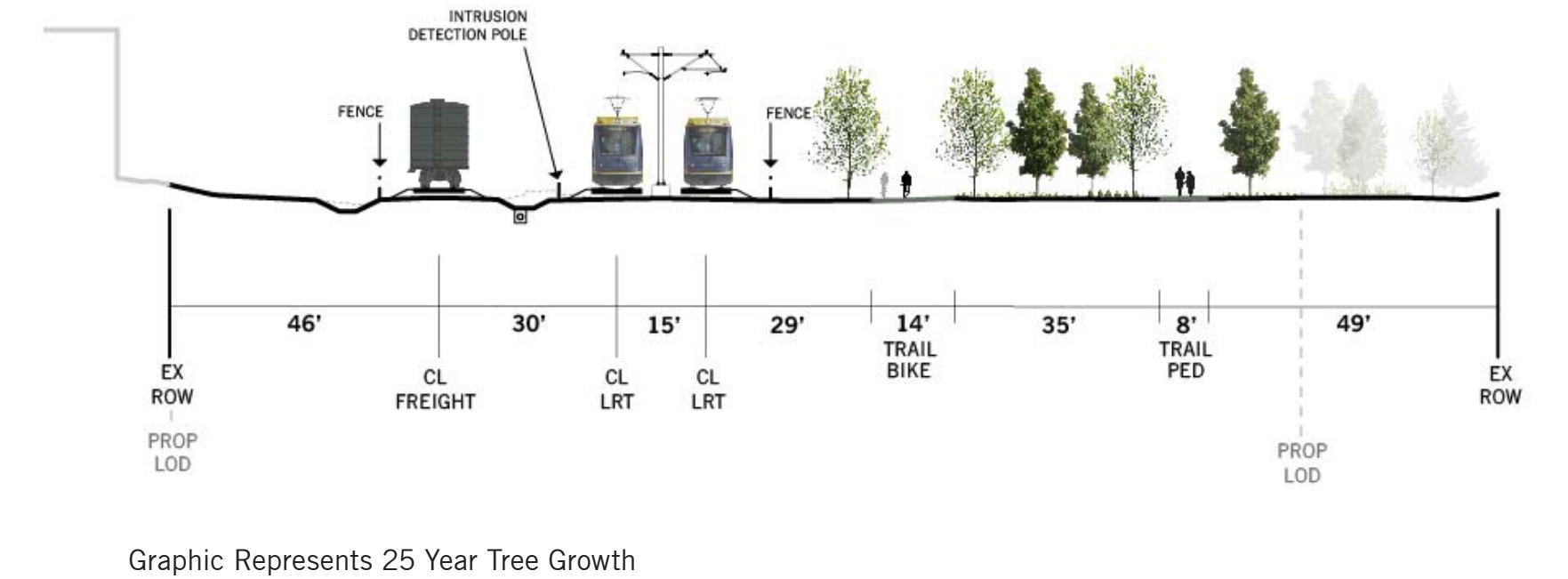
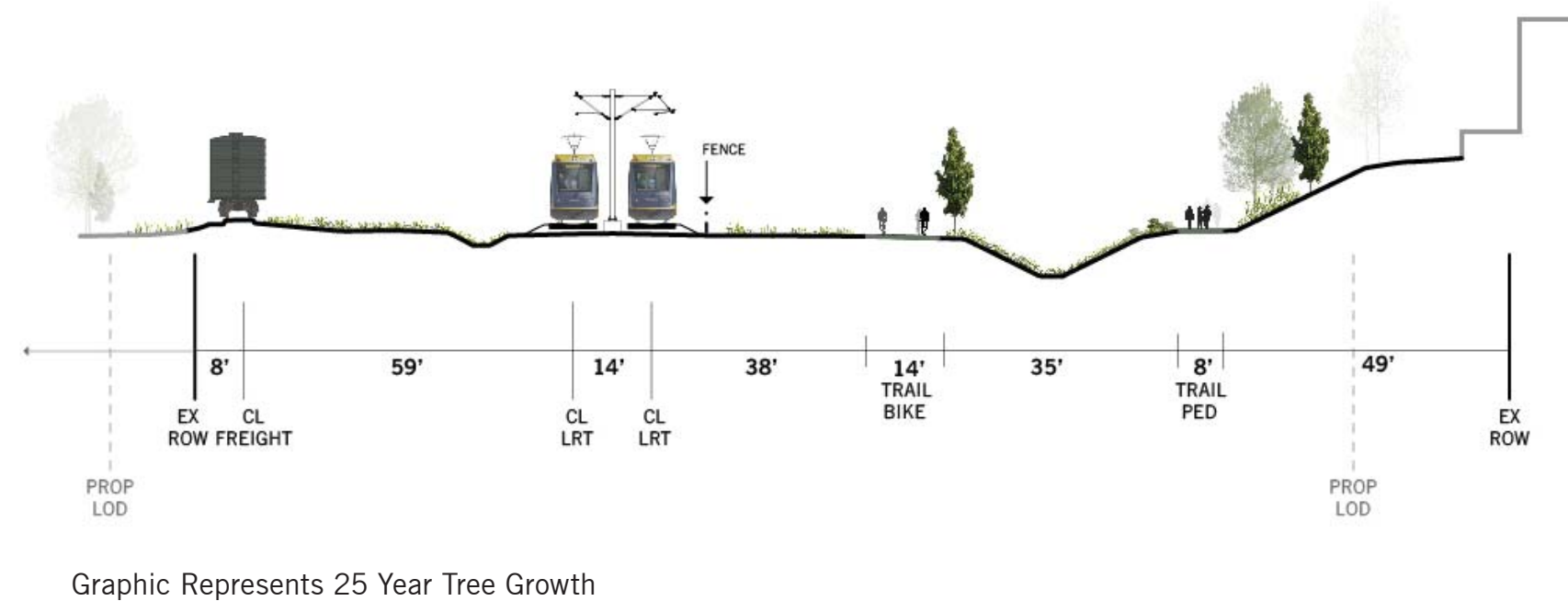
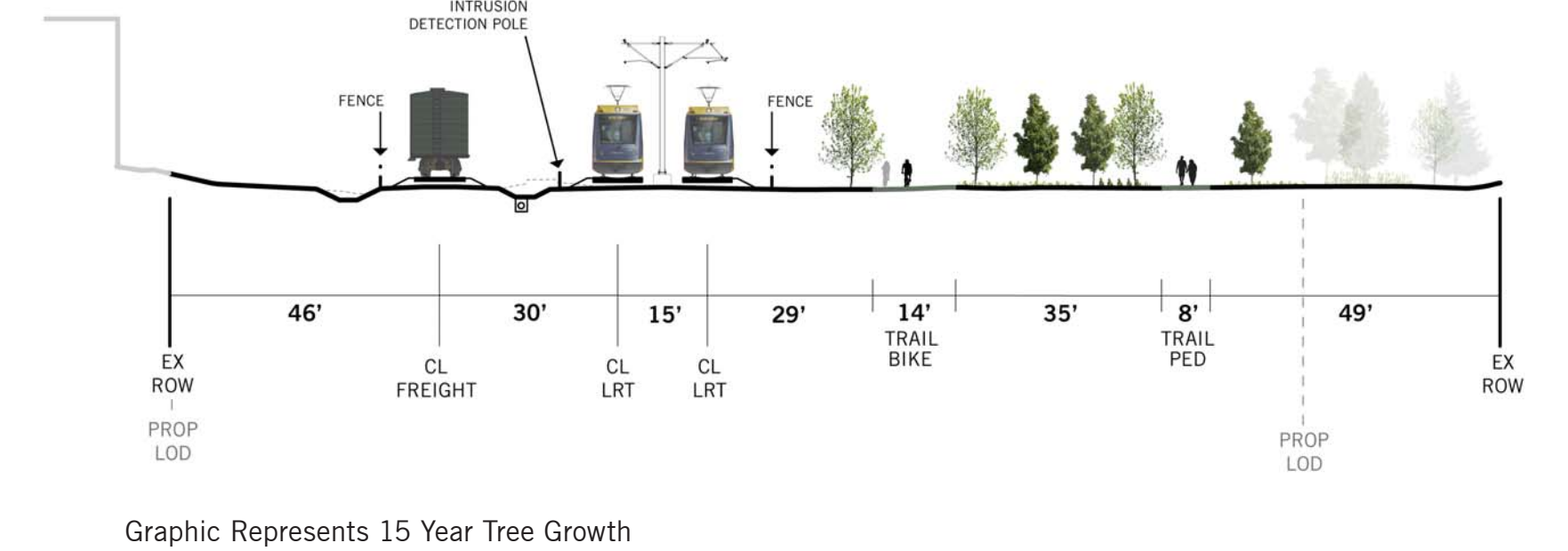
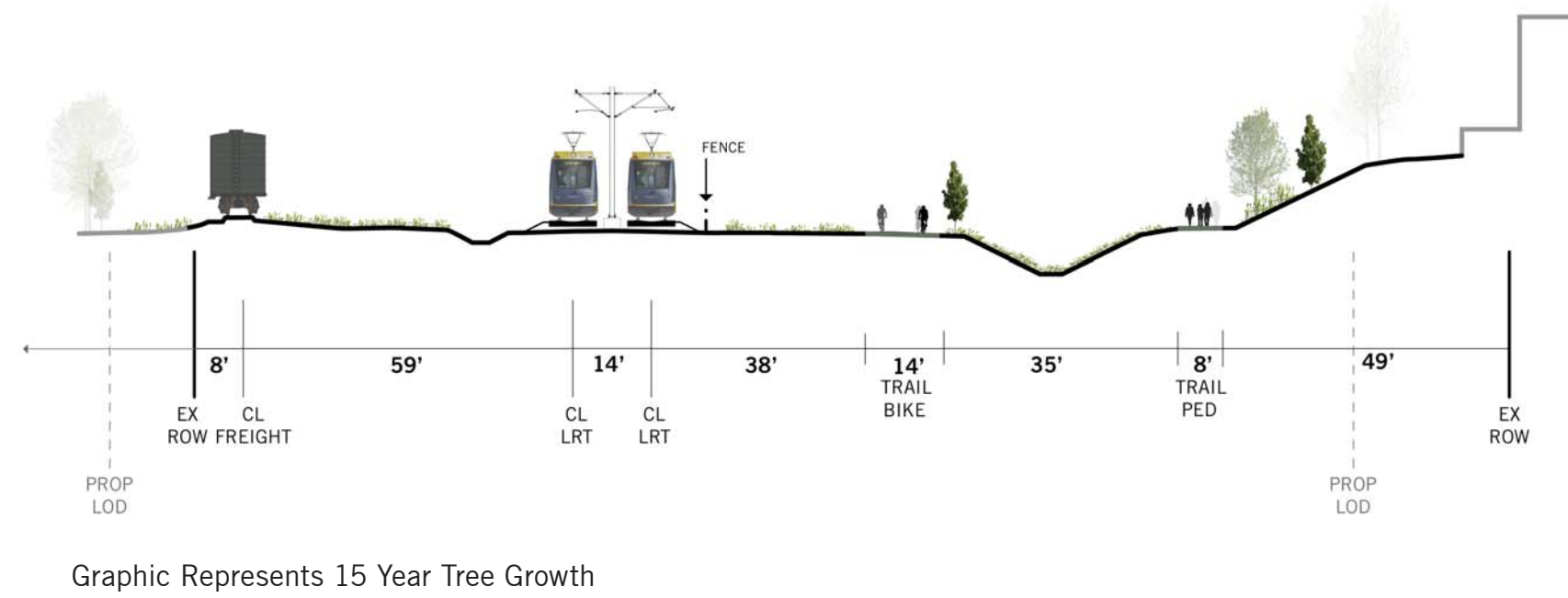
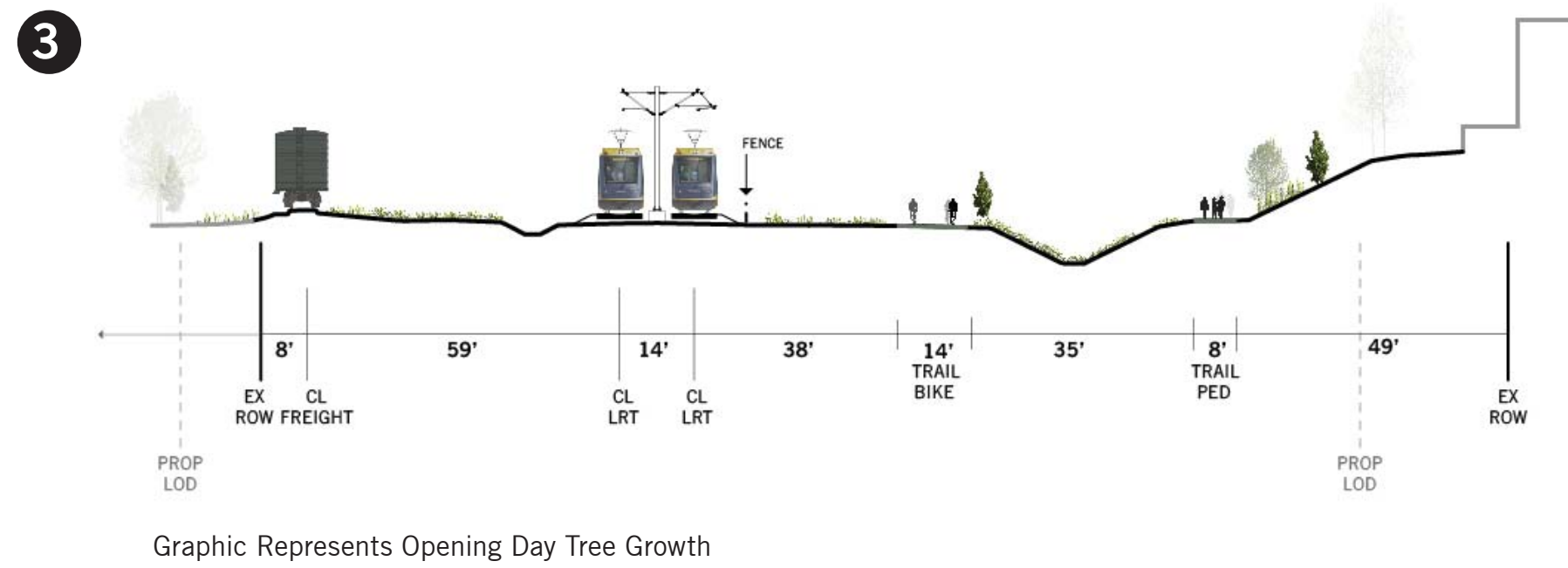

**Notes:**  
All dimensions on sections are approximate.

Proposed limits of disturbance are identified as Prop. LOD in sections. LOD based on SWLRT preliminary engineering plans (Sept. 2014)

DRAFT - WORK IN PROCESS

# Kenilworth Corridor Typical Sections

NOVEMBER 2015



5

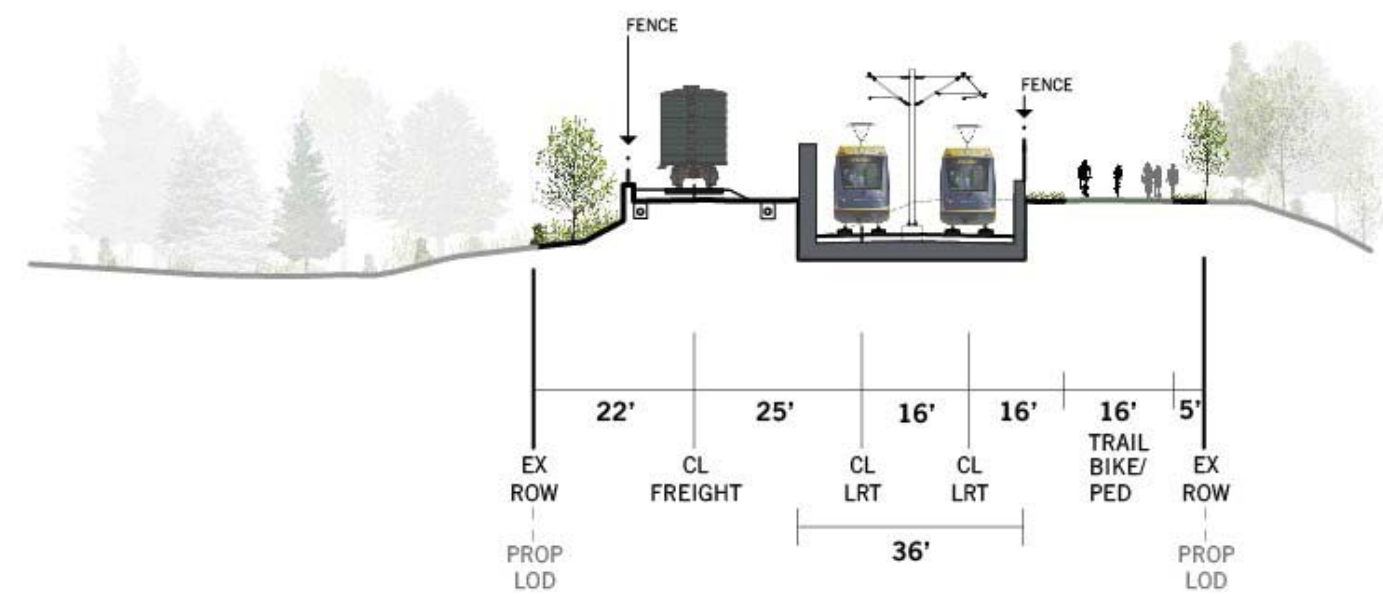

Graphic Represents Opening Day Tree Growth

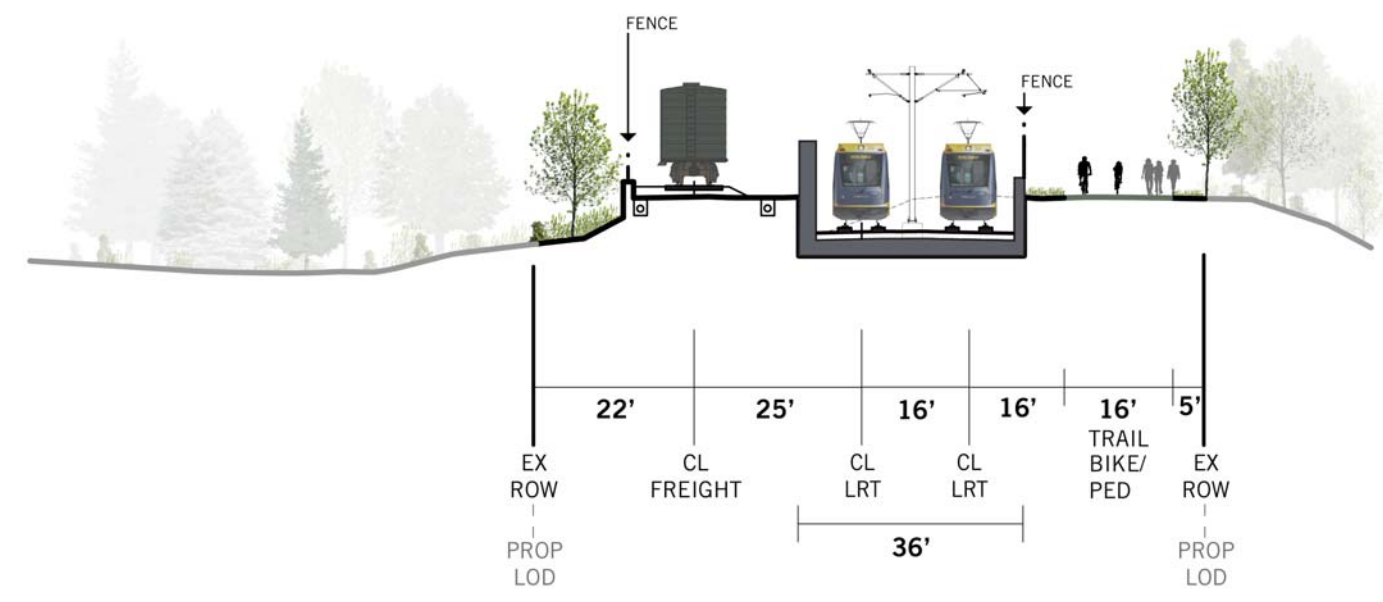

Graphic Represents 15 Year Tree Growth

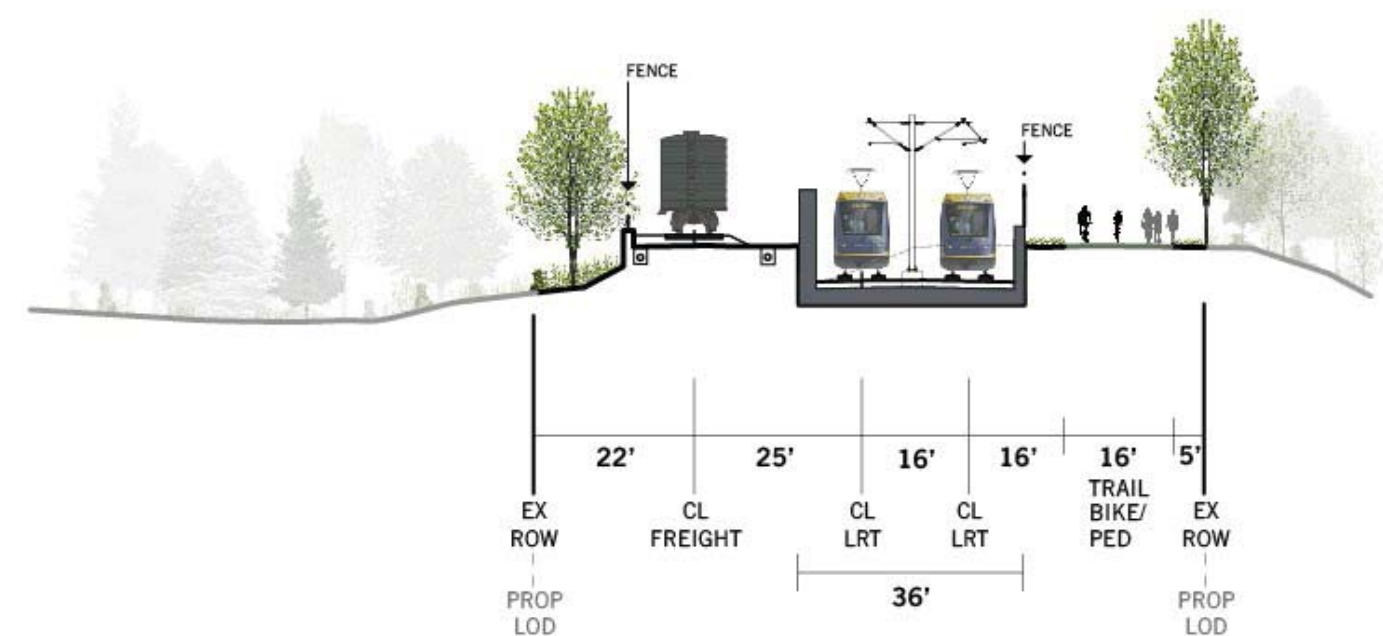

Graphic Represents 25 Year Tree Growth

6

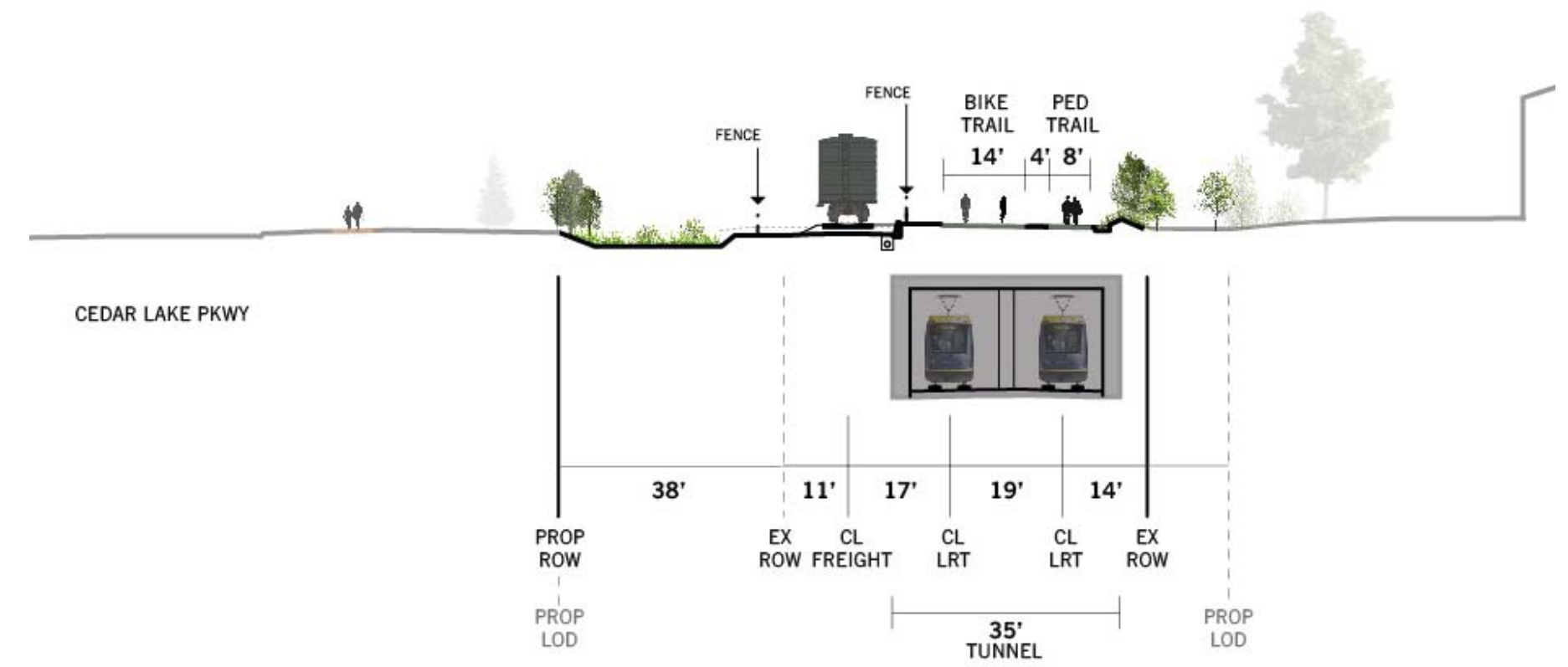

Graphic Represents Opening Day Tree Growth

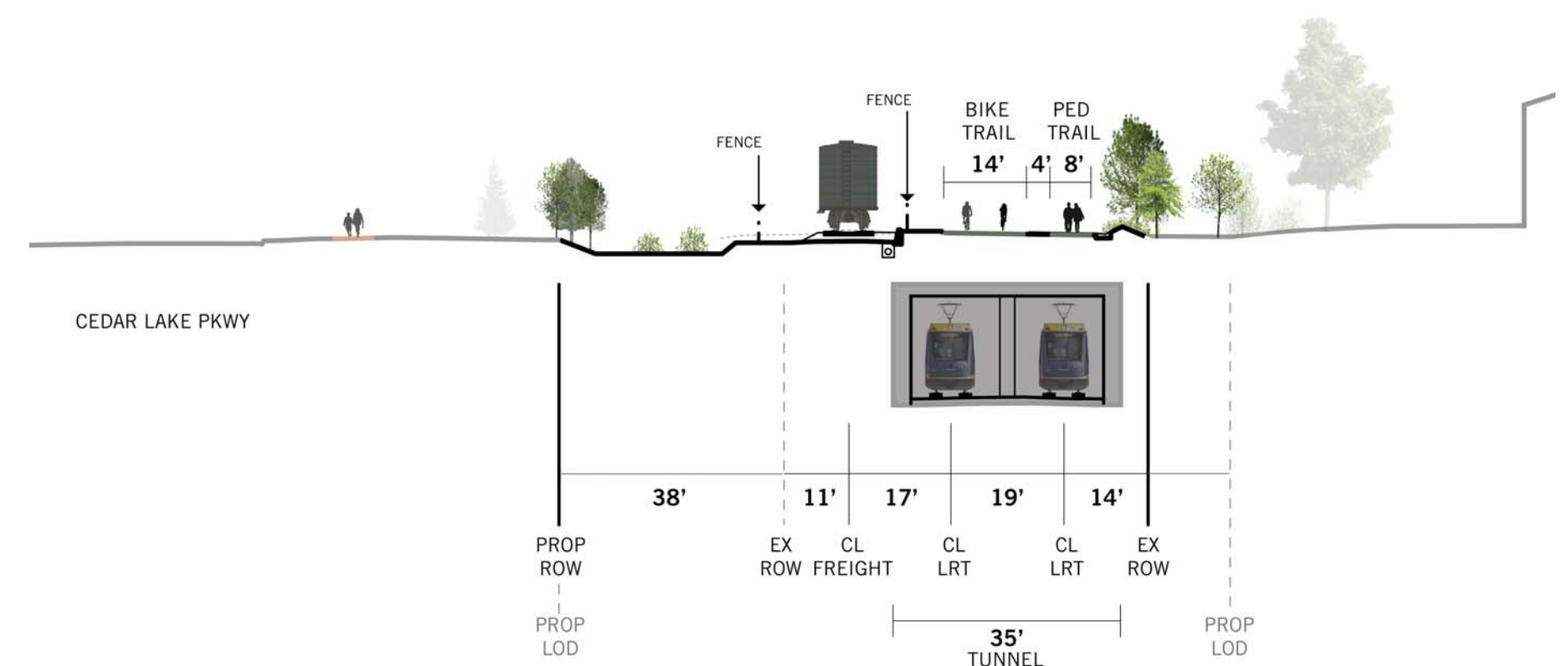

Graphic Represents 15 Year Tree Growth

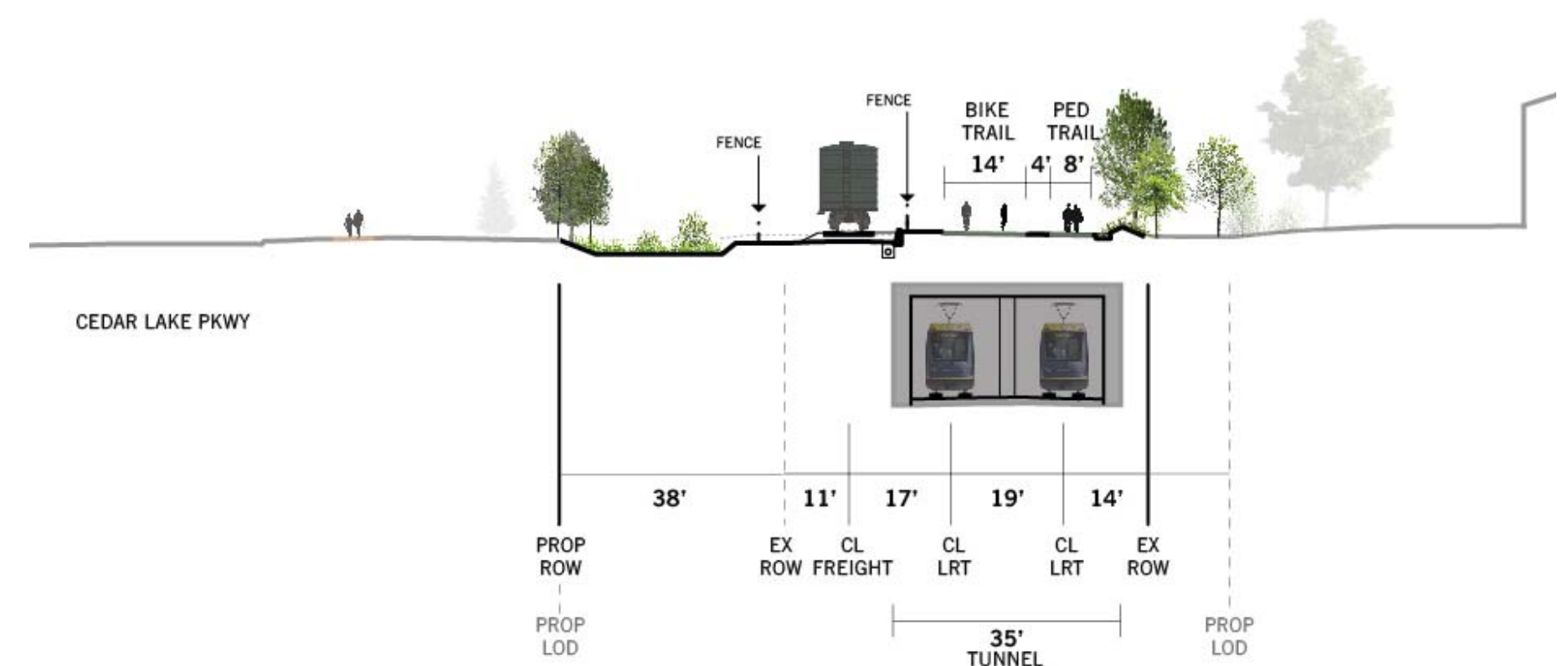

Graphic Represents 25 Year Tree Growth

**Notes:**  
All dimensions on sections are approximate.

Proposed limits of disturbance are identified as Prop. LOD in sections. LOD based on SWLRT preliminary engineering plans (Sept. 2014)

DRAFT - WORK IN PROCESS

# Kenilworth Corridor Typical Sections

NOVEMBER 2015

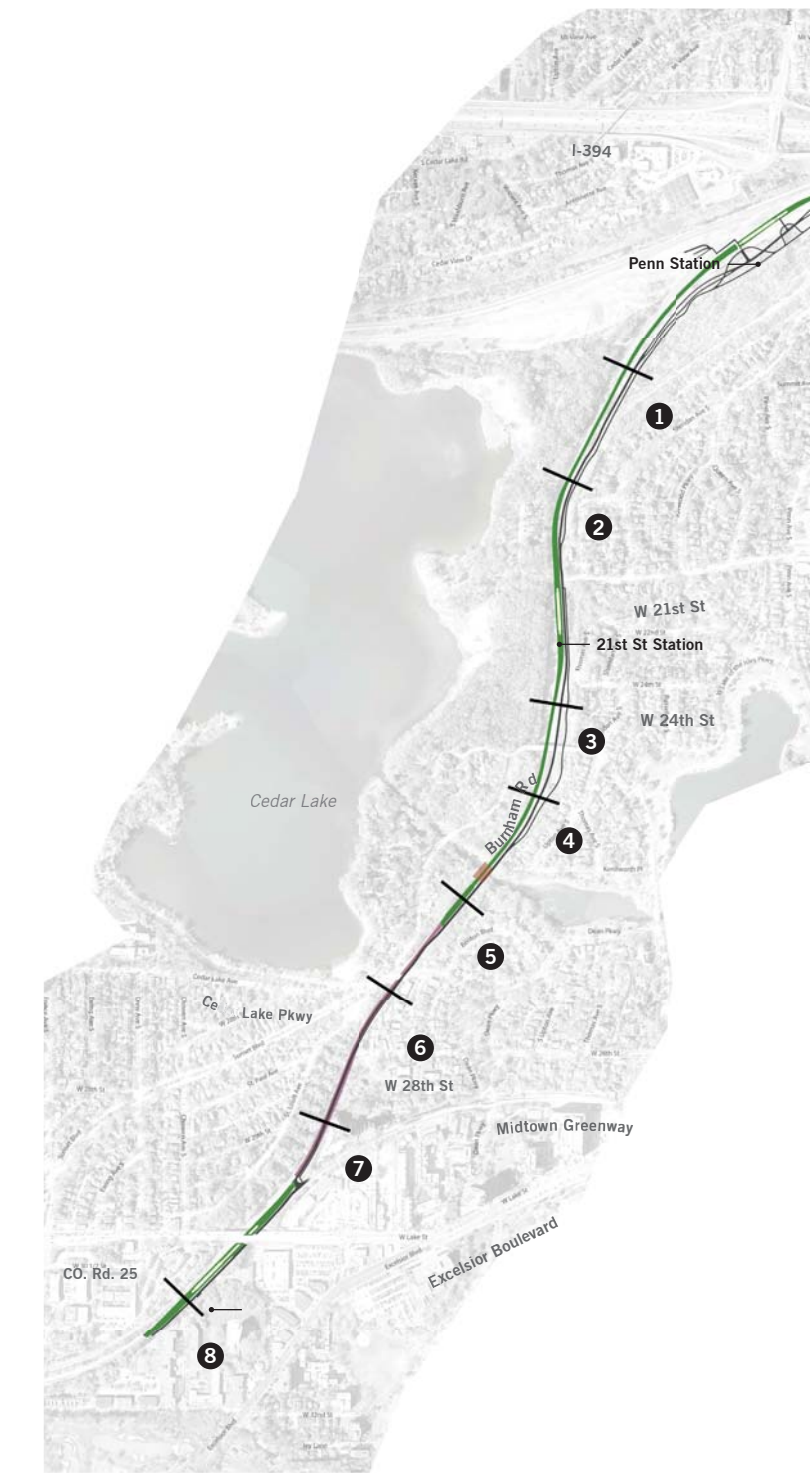

7



Graphic Represents Opening Day Tree Growth

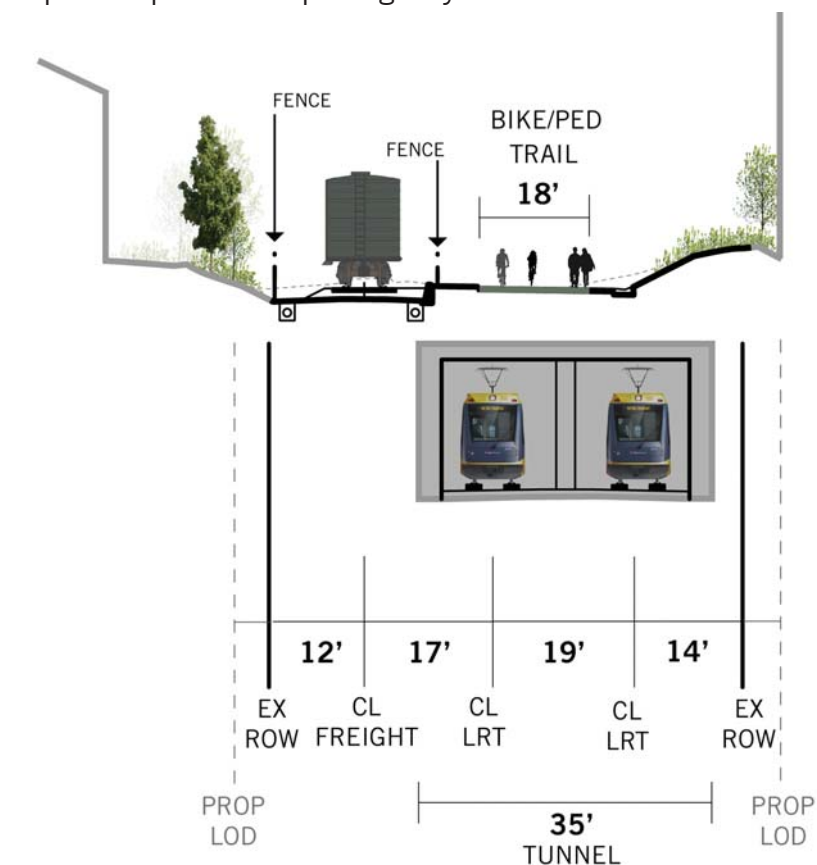

Graphic Represents 15 Year Tree Growth

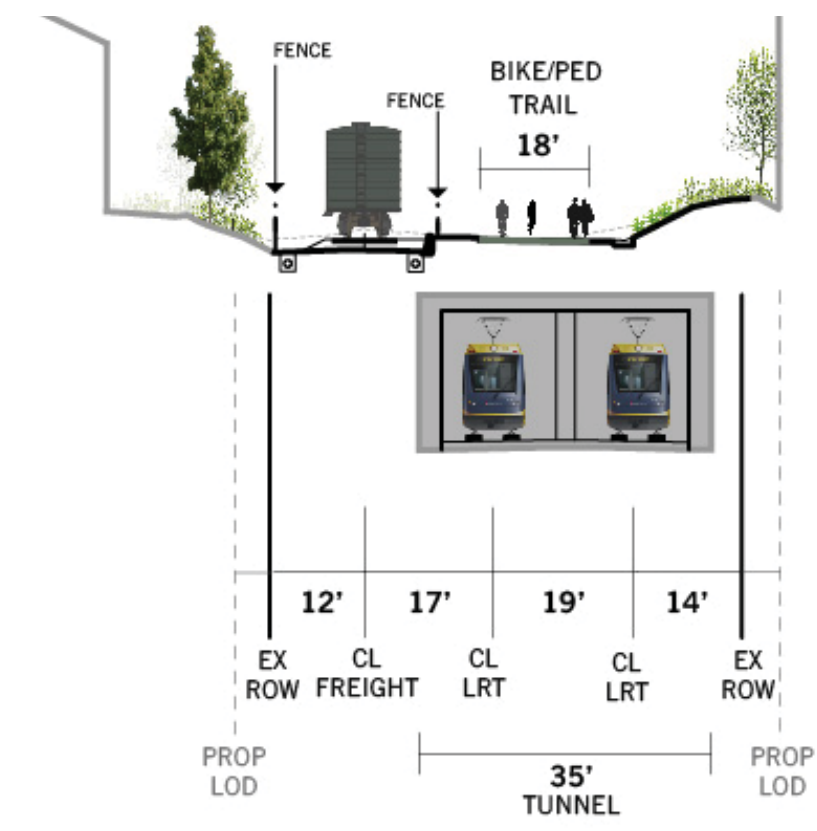

Graphic Represents 25 Year Tree Growth

8

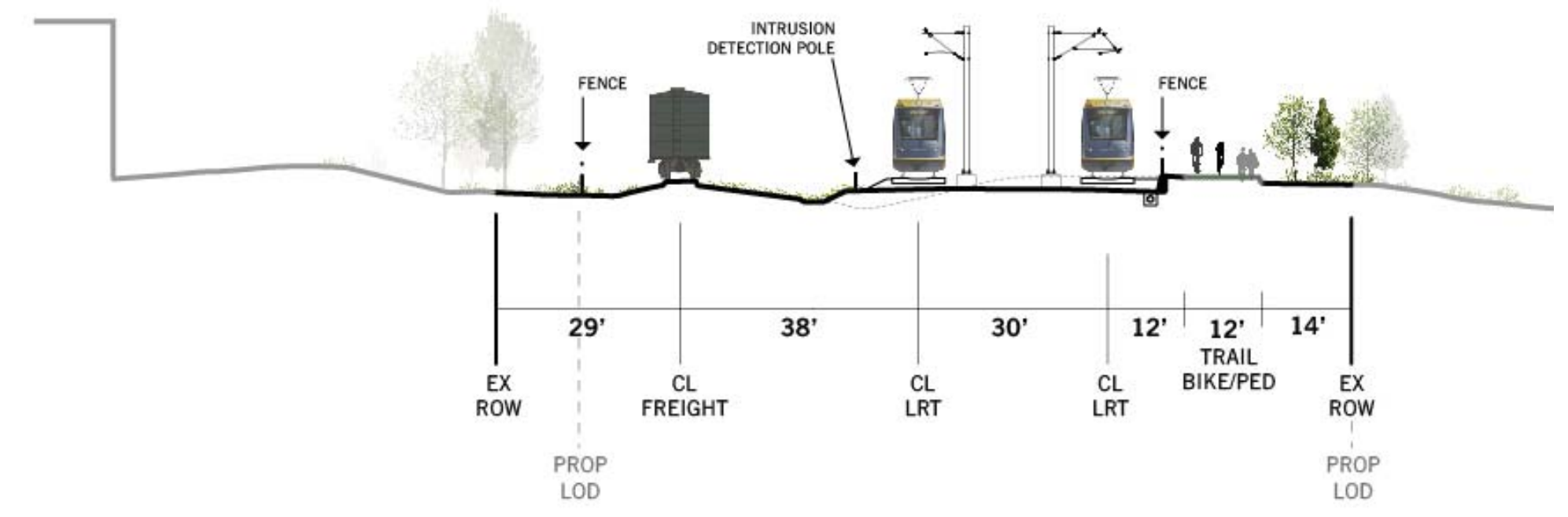

Graphic Represents Opening Day Tree Growth

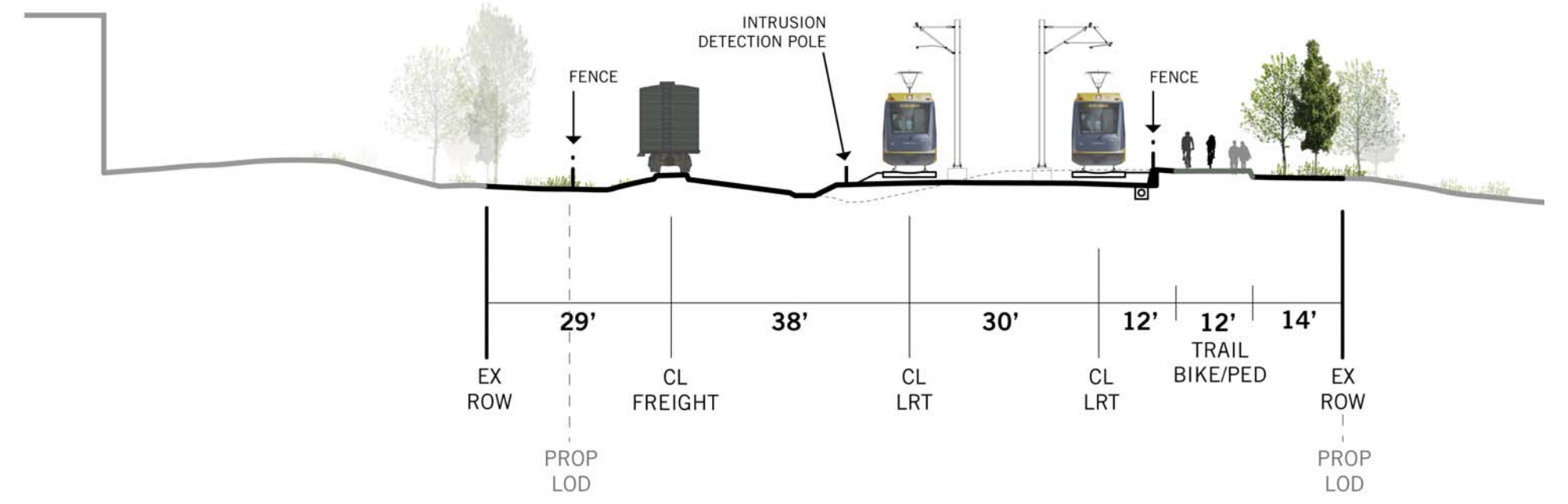

Graphic Represents 15 Year Tree Growth

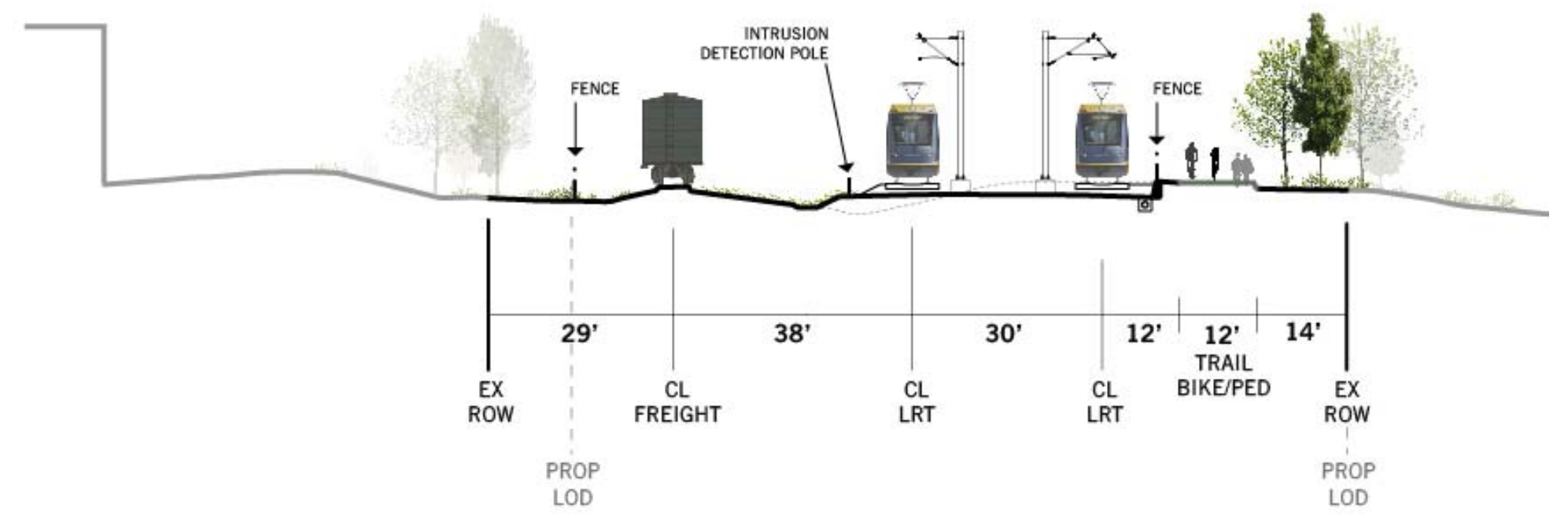

Graphic Represents 25 Year Tree Growth

**Note:**  
Restoration outside of  
LOD to be confirmed  
with property owners

**Notes:**  
All dimensions on sections are  
approximate.

Proposed limits of disturbance are  
identified as Prop. LOD in sections.  
LOD based on SWLRT preliminary  
engineering plans (Sept. 2014)

DRAFT - WORK IN PROCESS

# Kenilworth Corridor South Viewing Portal

NOVEMBER 2015

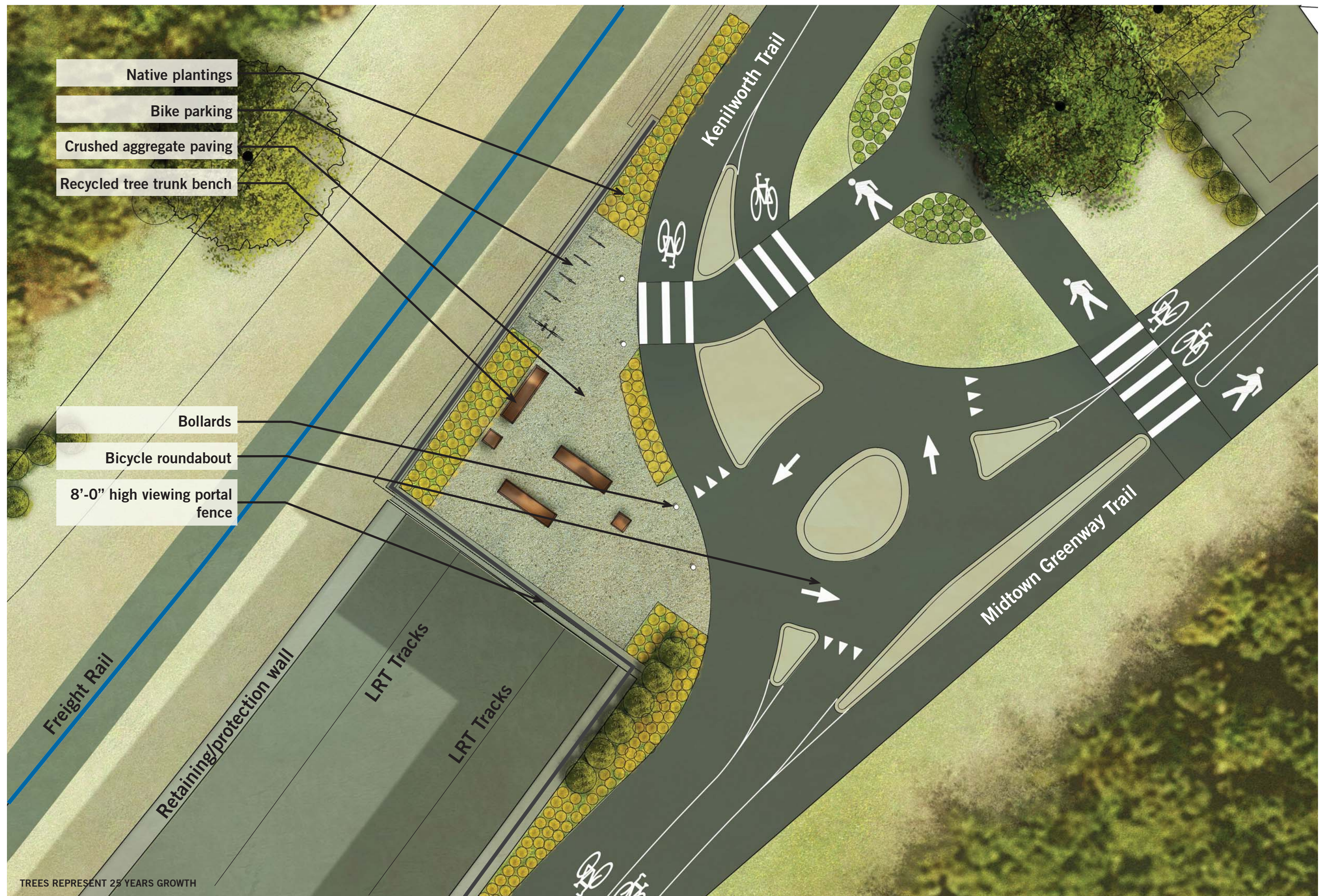

SOUTH PORTAL VIEWING AREA LANDSCAPE PLAN  
SCALE: 1" = 5'

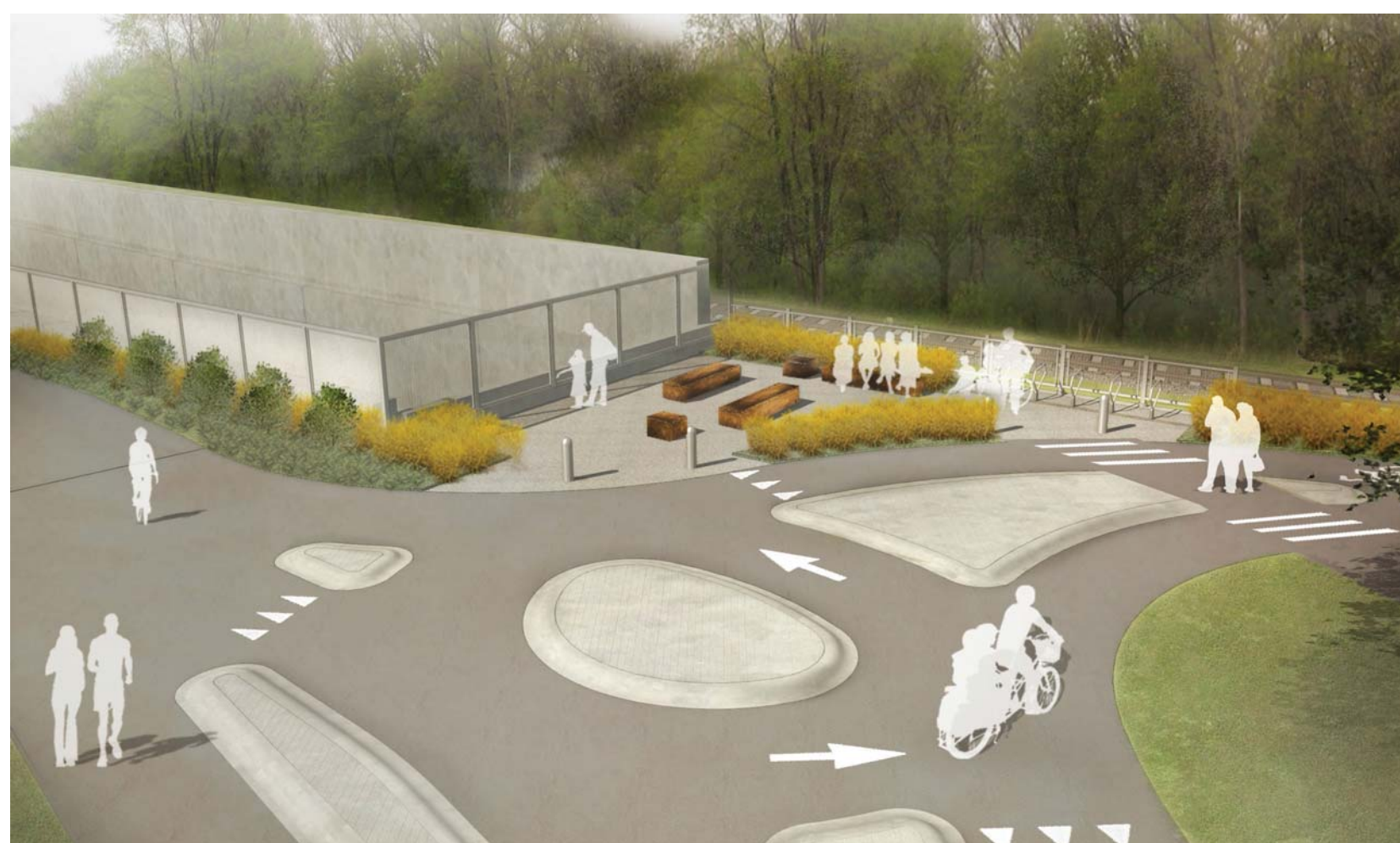

SOUTH PORTAL VIEWING AREA BIRD'S EYE VIEW LOOKING WEST



SOUTH PORTAL VIEWING AREA PERSPECTIVE VIEW LOOKING SOUTH WEST

DRAFT WORK IN PROCESS

# Kenilworth Corridor North Viewing Portal

NOVEMBER 2015

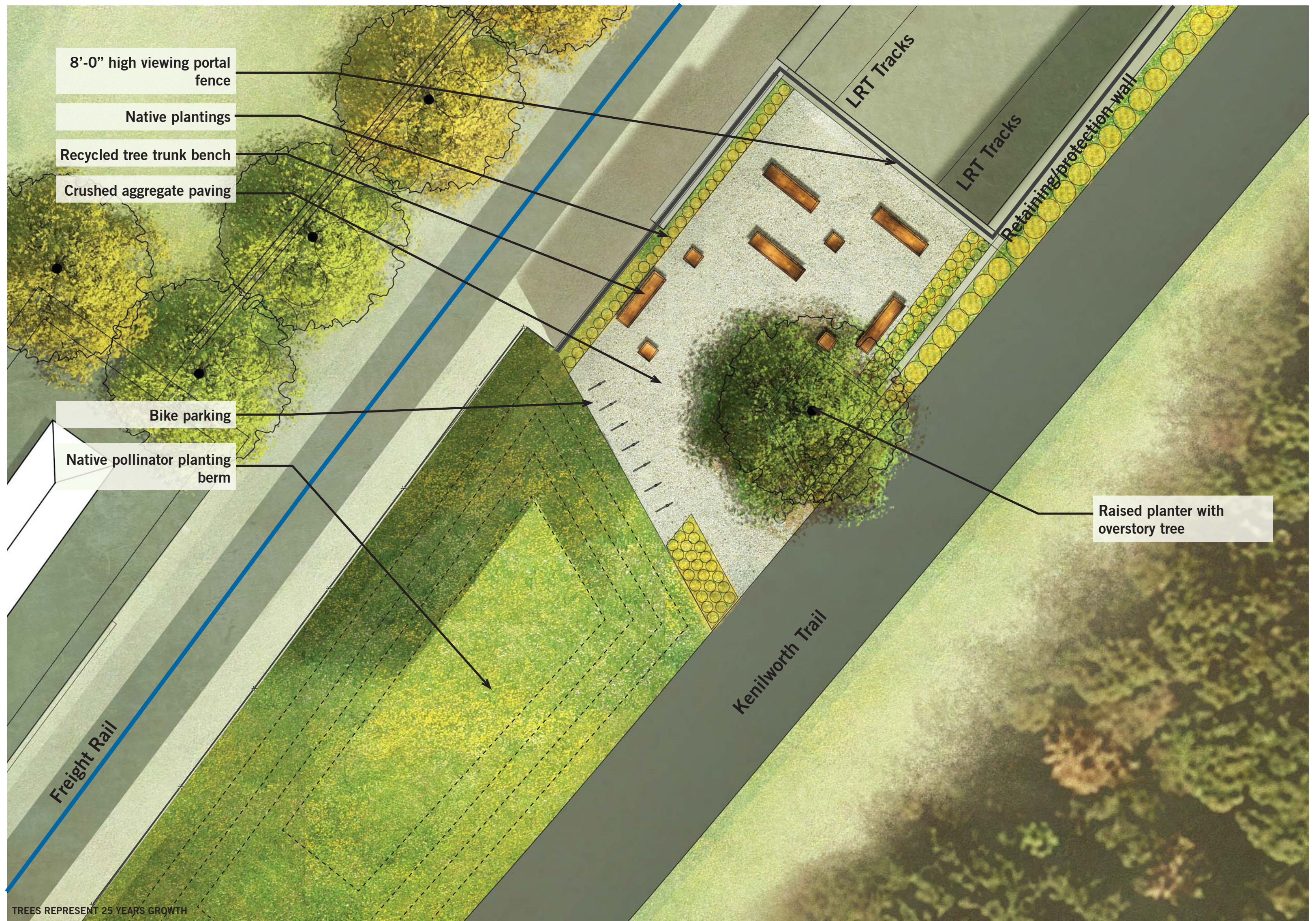

NORTH PORTAL VIEWING AREA LANDSCAPE PLAN

SCALE: 1" = 5'



NORTH PORTAL VIEWING AREA BIRD'S EYE VIEW LOOKING NORTHWEST



NORTH PORTAL VIEWING AREA PERSPECTIVE VIEW LOOKING NORTH

DRAFT WORK IN PROCESS

# Kenilworth Corridor Seating Areas

NOVEMBER 2015

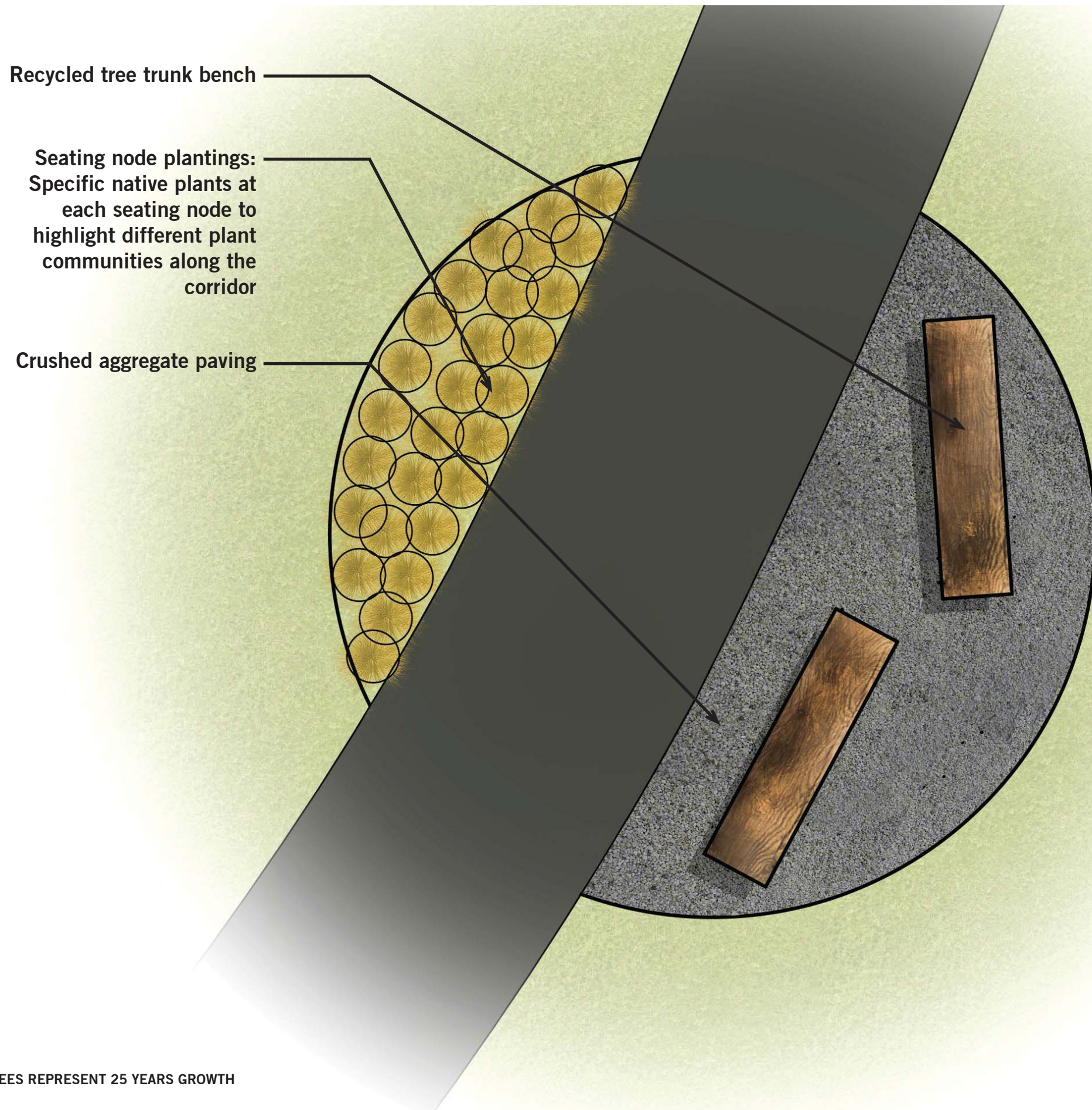

TREES REPRESENT 25 YEARS GROWTH

TYPICAL SEATING NODE  
SCALE: 1" = 10'



PERSPECTIVE VIEW OF SEATING NODE

**DRAFT WORK IN PROCESS**

# Kenilworth Corridor: Screening Concepts of Systems Elements

NOVEMBER 2015

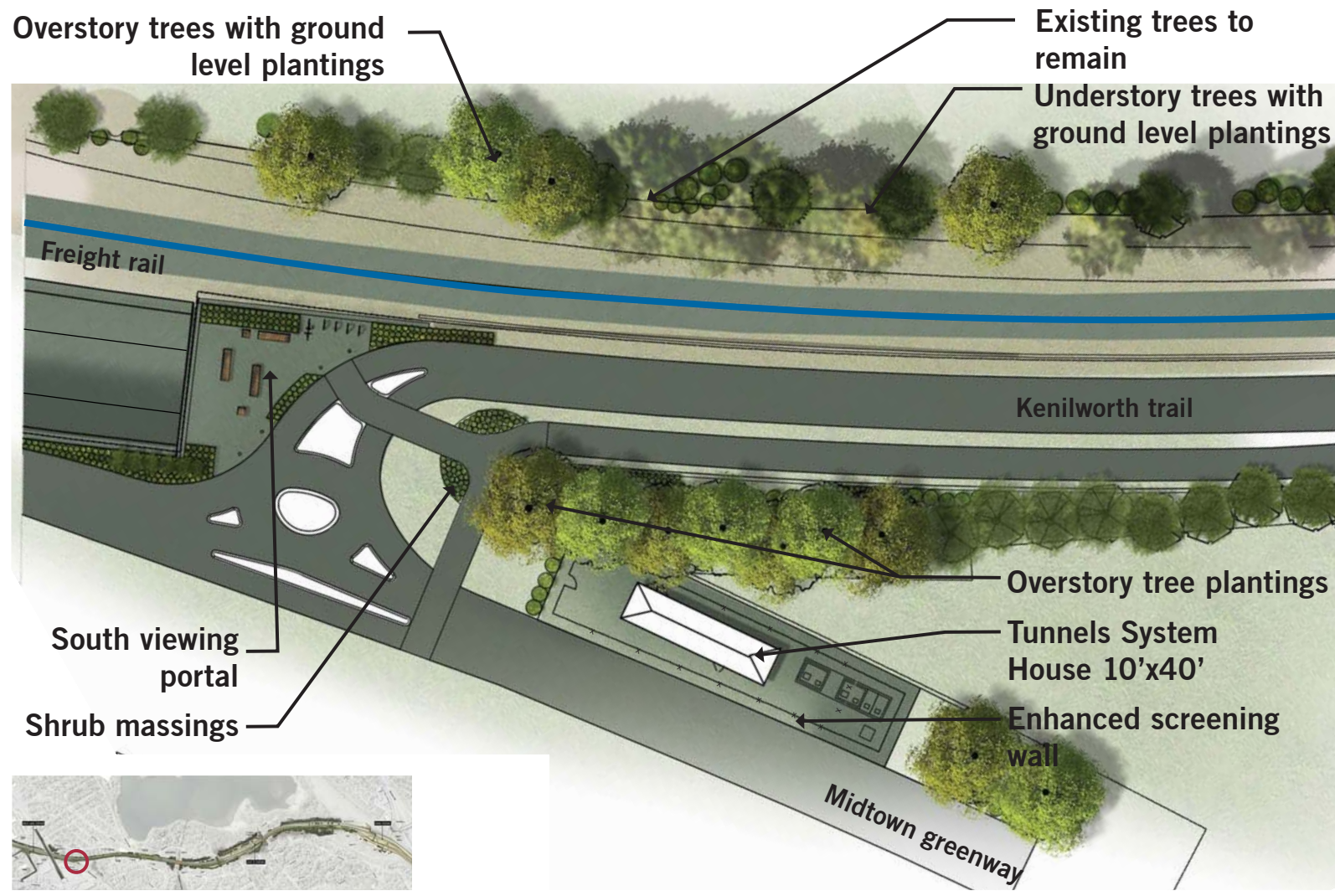

**TUNNEL SYSTEMS HOUSE**  
GRAPHIC REPRESENTS 25 YEAR TREE GROWTH

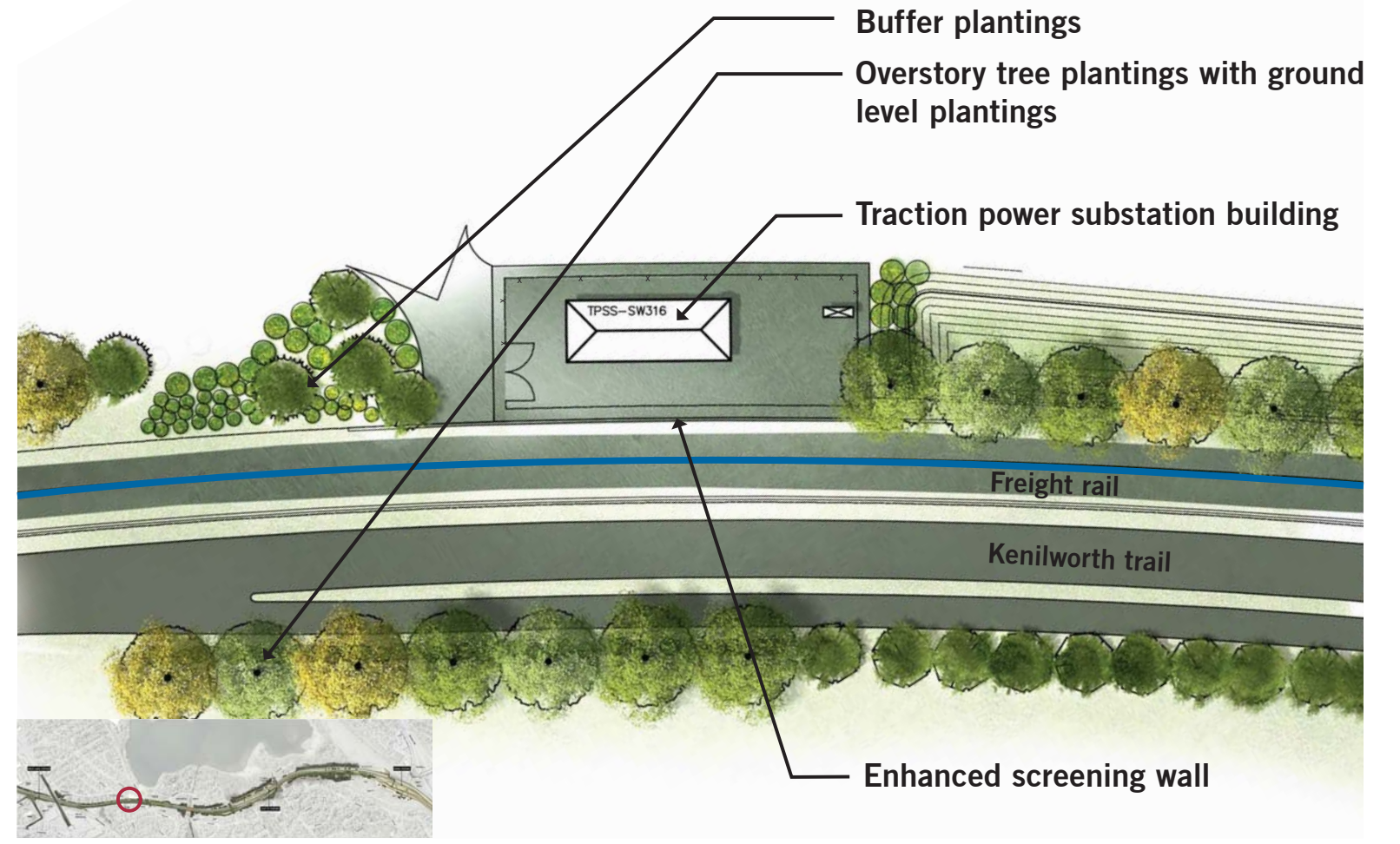

**TRACTION POWER SUBSTATION**  
GRAPHIC REPRESENTS 25 YEAR TREE GROWTH

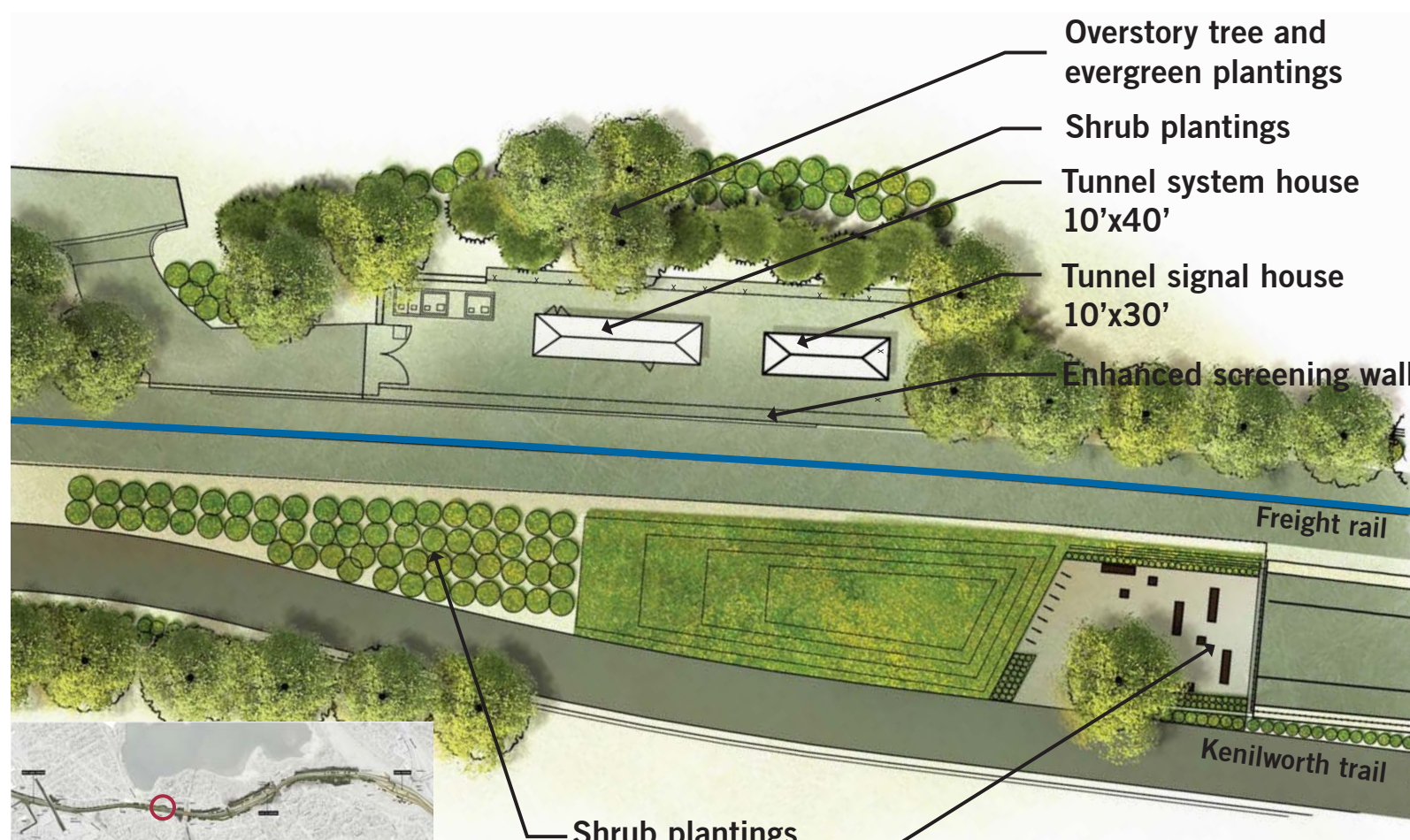

**TUNNEL SYSTEMS HOUSE**  
GRAPHIC REPRESENTS 25 YEAR TREE GROWTH

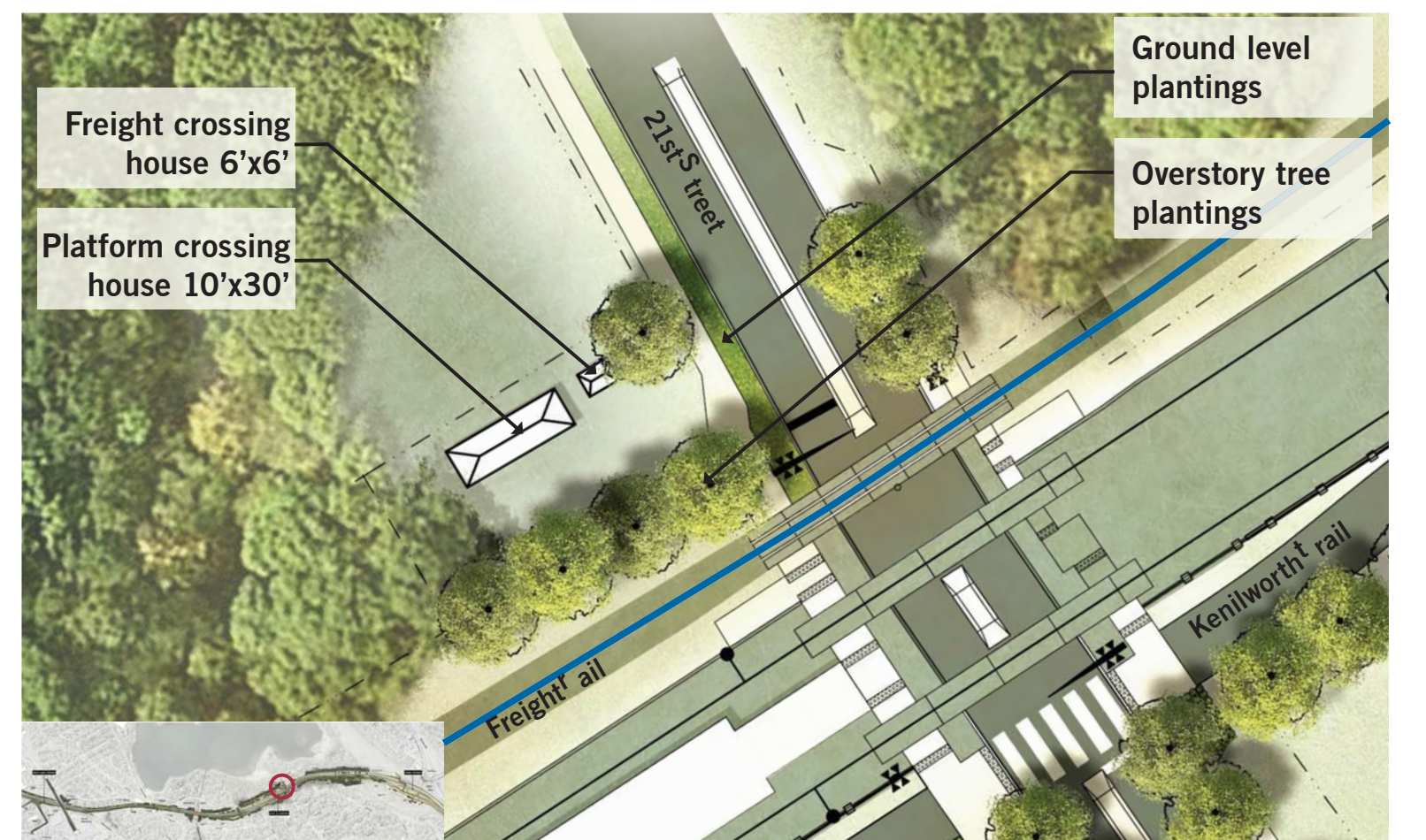

**FREIGHT CROSSING HOUSE AND PLATFORM CROSSING HOUSE**  
GRAPHIC REPRESENTS 25 YEAR TREE GROWTH

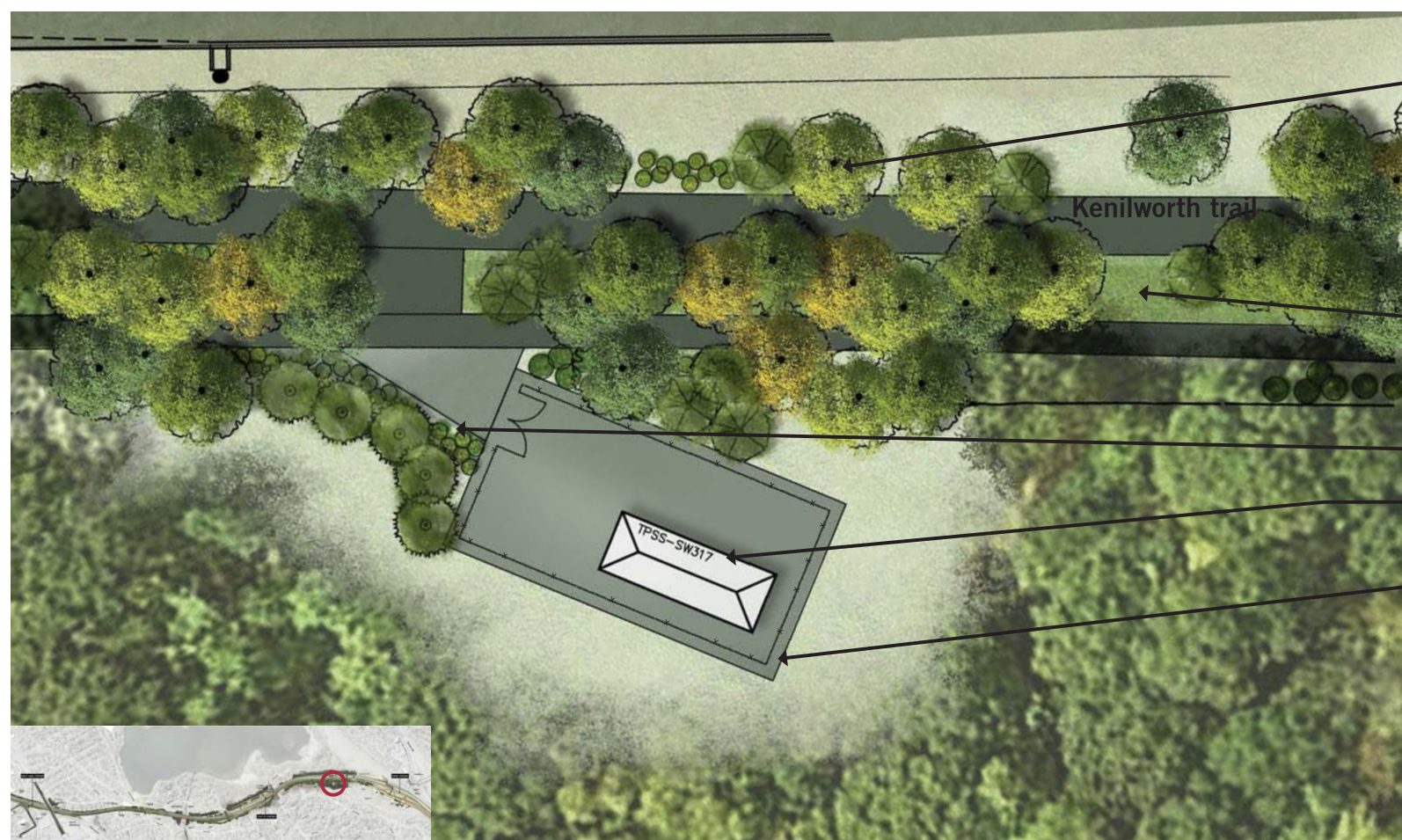

**TRACTION POWER SUBSTATION**  
GRAPHIC REPRESENTS 25 YEAR TREE GROWTH

**LEGEND**

-  New overstory tree
-  Planted areas
-  Freight rail

**DRAFT WORK IN PROCESS**

## EXISTING CONDITIONS

## PROPOSED DESIGN

*FREIGHT BRIDGE: 5-SPAN CONCRETE THIN DECK*  
*LRT BRIDGE: SINGLE-SPAN CONCRETE ARCH*  
*TRAIL BRIDGE: SINGLE-SPAN CONCRETE ARCH*

Existing Conditions | View 1



Proposed Design | View 1



Existing Conditions | View 2

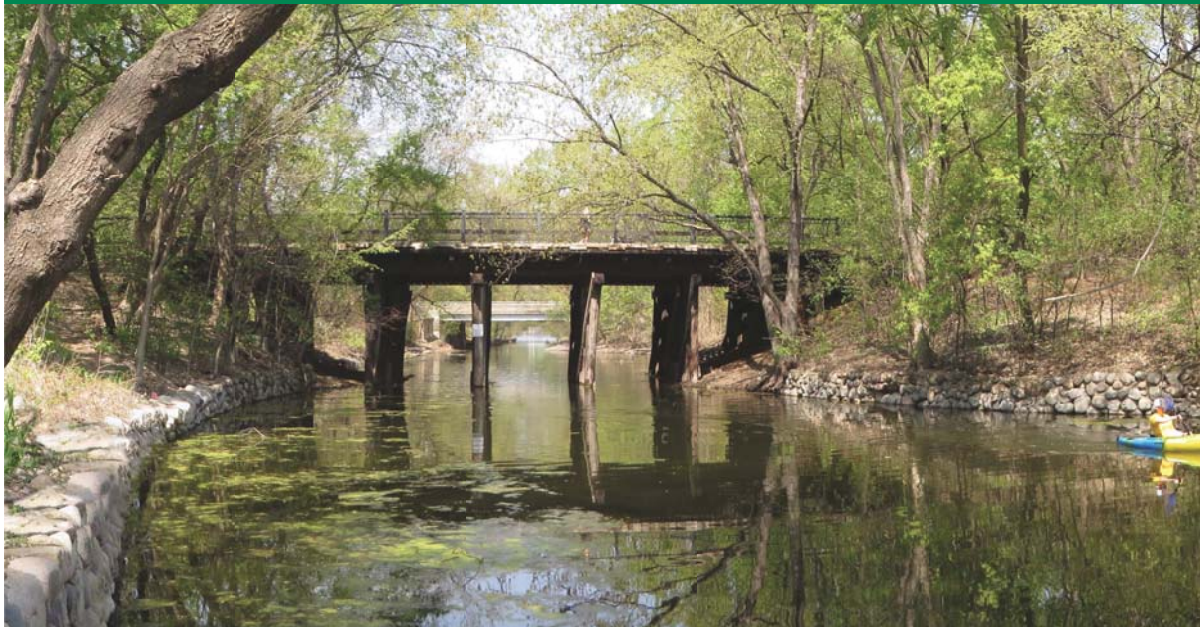

Proposed Design | View 2



Existing Conditions | View 3



Proposed Design | View 3



Existing Conditions | View 4

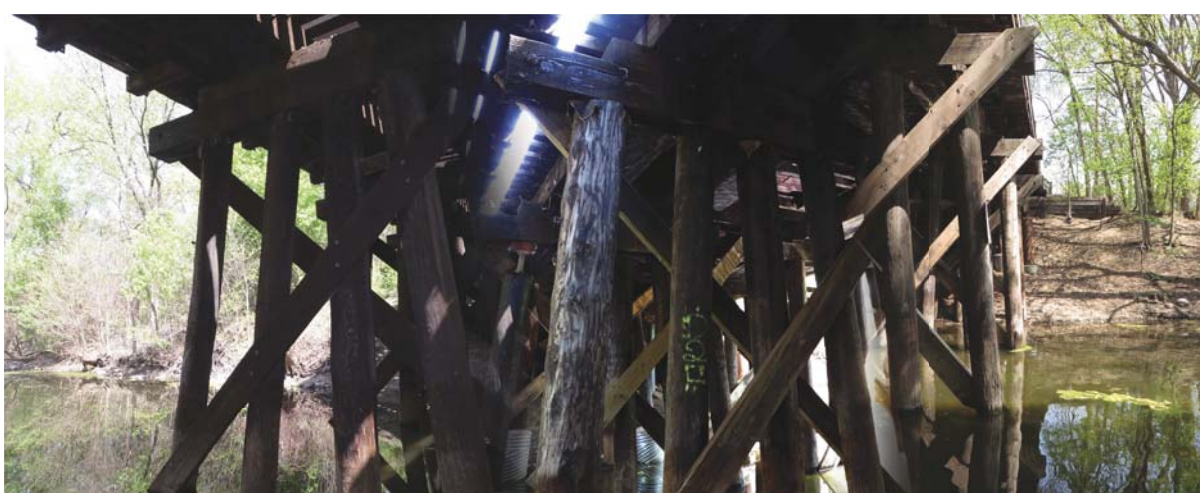

Proposed Design | View 4



Existing Conditions | View 5



Proposed Design | View 5

