

MCES East Isles Sewer Improvements Project



60% Design Virtual Public Meeting
August 25, 2020



Minneapolis
Park & Recreation Board



Meeting Presenters

- ◆ Chad Davison, Metropolitan Council Environmental Services (MCES) Principal Engineer
- ◆ Angela Klein, Zan Associates (MCES Project Communications)
- ◆ Rachel Kranz, Foth (MCES Design Team Lead)
- ◆ Lisa Goddard, City of Minneapolis Professional Engineer
- ◆ Colleen O'Dell, Minneapolis Park and Recreation Board (MPRB) Senior Planner

East Isles Sewer Improvements

Summary

- ◆ 2021 Construction
- ◆ 24" dual sanitary sewer pipe installation on The Mall and Humboldt Avenue
- ◆ 48" storm sewer pipe replacement on Humboldt Avenue to reduce flooding on Humboldt Avenue
- ◆ Water main replacement
 - ▶ Humboldt Avenue from The Mall to mid-block north of the Midtown Greenway
 - ▶ Humboldt Avenue at W 27th Street
- ◆ Abandonment of the sanitary sewer pipe on Irving Avenue and W 27th Street

East Isles Sewer Improvements



Southwest Service Area Master Plan

SW PARKS PLAN

What is it?

- ◆ The last of five master plans to guide the future of all neighborhood parks in Minneapolis
- ◆ Southwest has **43 parks** south of I-394 and west of I-35W, including **The Mall Park**
- ◆ Collected public input at over 170 events
- ◆ 18-member Community Advisory Committee held 16 public meetings, 4 work groups, and 3 subcommittees before making park recommendations

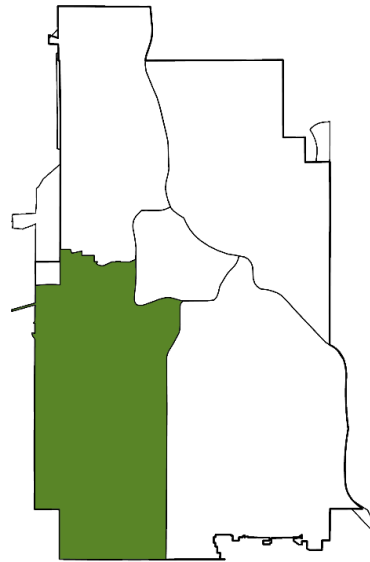

Timeline

May 2018 – project started

Summer 2018 – engagement & visioning

Fall 2018 – concept plans developed

2019 – feedback and plans refined

Feb 2020 – final draft released, COVID

August 2020 – public comment closed

September 2020: staff tabulating comments and plan updates

October 2020: anticipated date for public hearing at Planning Committee, Board review for adoption



Southwest Service Area Master Plan

THE MALL PARK

Refined concept as of October 3, 2019

PROPOSED DESIGN FEATURES

1. PLAZA WITH PLANTINGS (design based on proposed Hennepin County plan)
2. PLAY AREA (with option for small play spots to be incorporated along The Mall)
3. MIDTOWN GREENWAY TRAIL CONNECTION
4. SHARED USE WOONERF/FLEXIBLE MARKET STREET (potential temp. road closures, permeable surface, vehicles and parking accommodated but guided by urban design features focused on pedestrians)
5. ENHANCED STEWARDSHIP GARDENS AND PEDESTRIAN CROSSINGS (north-south and east-west crossings)
6. COMMUNITY GARDEN/URBAN AGRICULTURE (work with Hennepin County to explore opportunity to engage with Midtown Greenway)
7. NATIVE PLANTINGS AND/OR RAINGARDENS (in collaboration with Hennepin County)
8. ENHANCED PEDESTRIAN CROSSING TO CHAIN OF LAKES REGIONAL PARK & TRAILS
9. FORESTED AND OPEN GREEN SPACE
10. RELOCATED PATH
11. PRESERVE THROUGH-ALLEYS (preserve one-way through-alleys)



EXISTING FEATURES

- A. ONE-WAY ROAD CONFIGURATION WITH ON-STREET PARKING
- B. TREE CANOPY

**Draft released for public
comment on 2/14/20**

Southwest Service Area Master Plan | minneapolisparcs.org/sw



Minneapolis
Park & Recreation Board

Flood Area 63 Improvements – Storm sewer

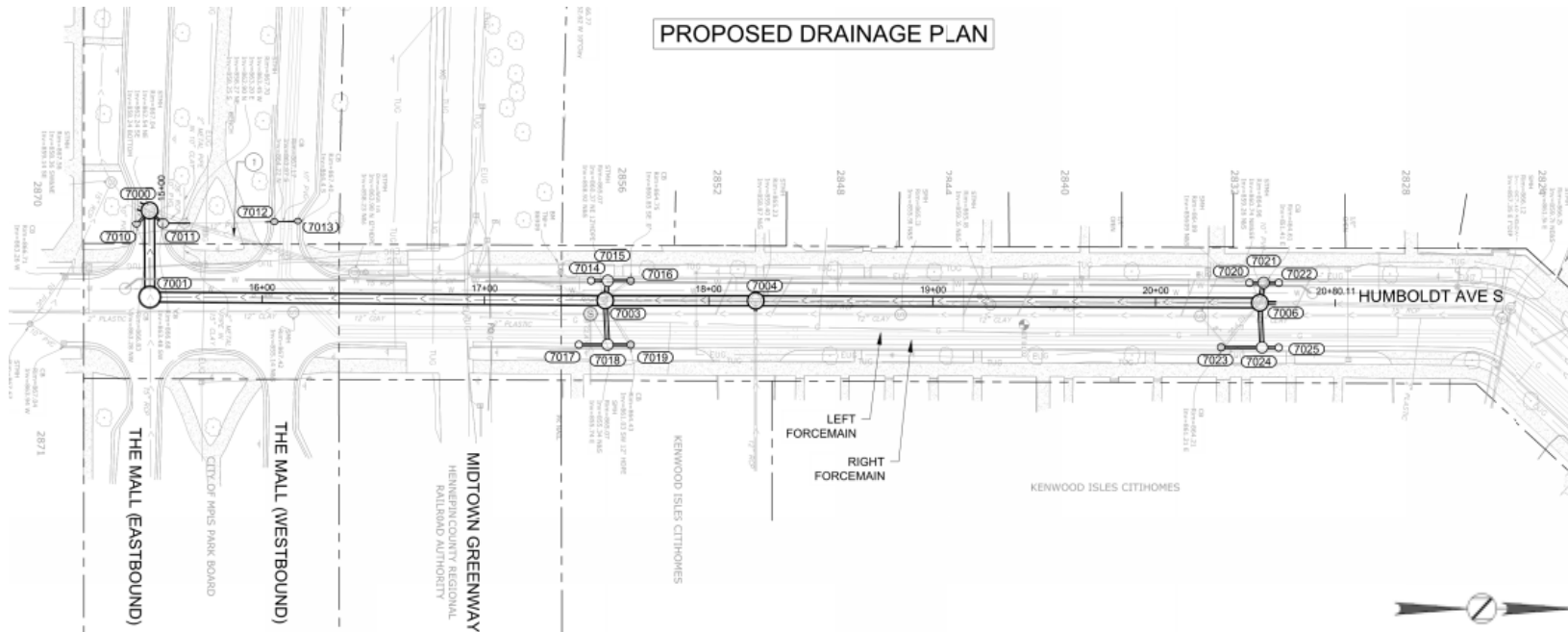

- ◆ Phase I of flood mitigation project implementation by City of Minneapolis Surface Waters & Sewers
- ◆ Replaces 15" storm sewer with 48" diameter
- ◆ Adds eight (8) catch basins for improved inlet capacity

- 

Sanitary Sewer - Installation & Abandonment



Project Impacts - The Mall

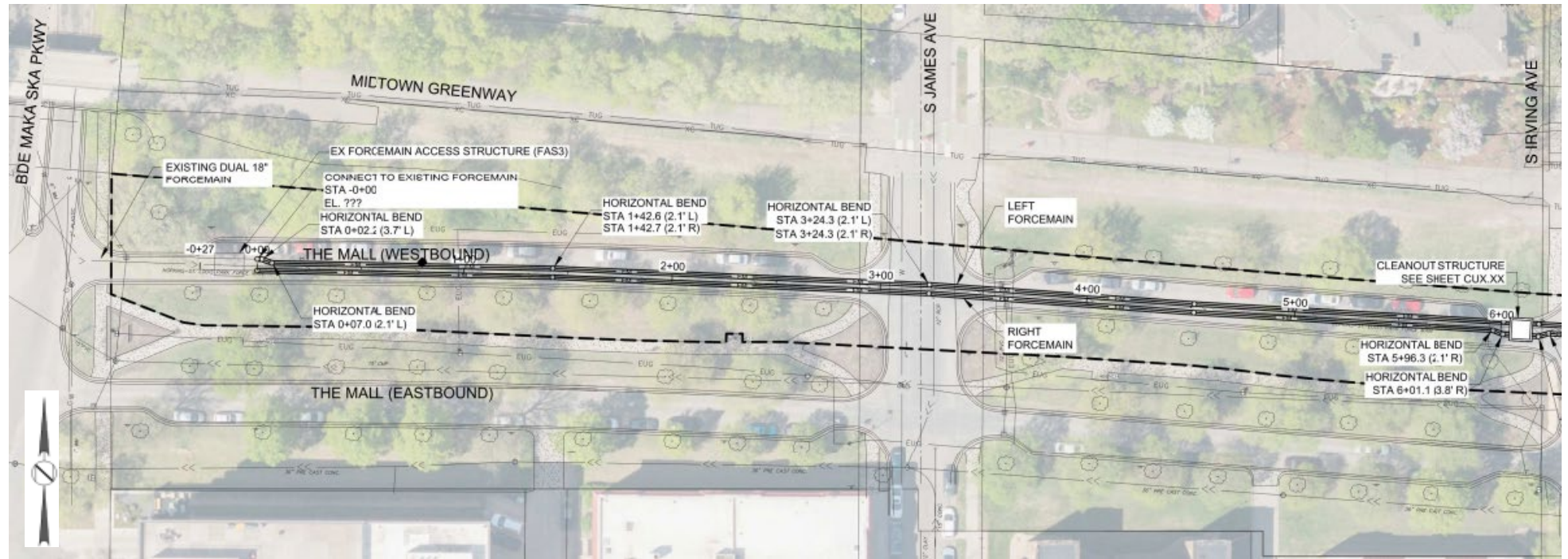

- ◆ 6" water main crossing (James Avenue)
- ◆ 12" storm sewer crossing (James Avenue)
- ◆ Temporary sanitary sewer conveyance piping
- ◆ Final restoration per MPRB Southwest Master Plan Approval

Project Impacts - The Mall

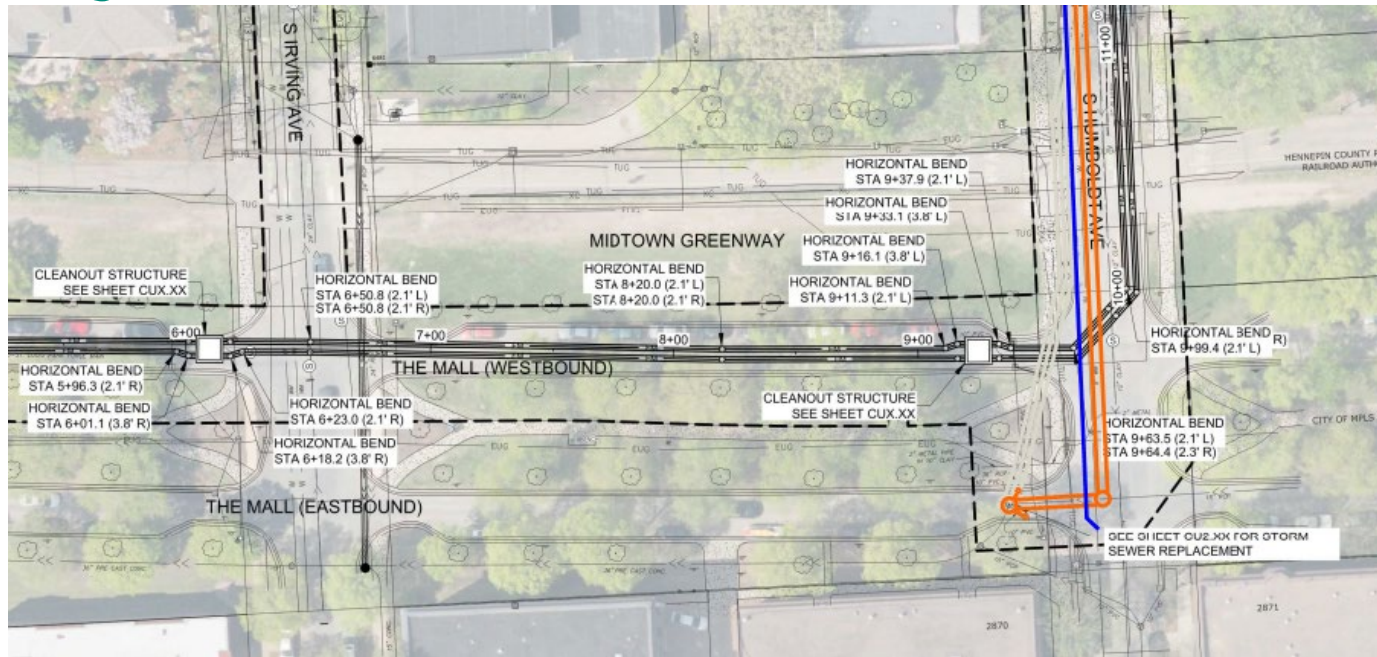

- ◆ 6" and 24" water main crossings (Irving Avenue)
- ◆ 12" and 24" storm sewer crossing (Irving Avenue)
- ◆ Temporary sanitary sewer conveyance piping
- ◆ Storm sewer replacement and connection at The Mall (eastbound)
- ◆ Replace roadway in kind

Project Impacts – Humboldt Avenue

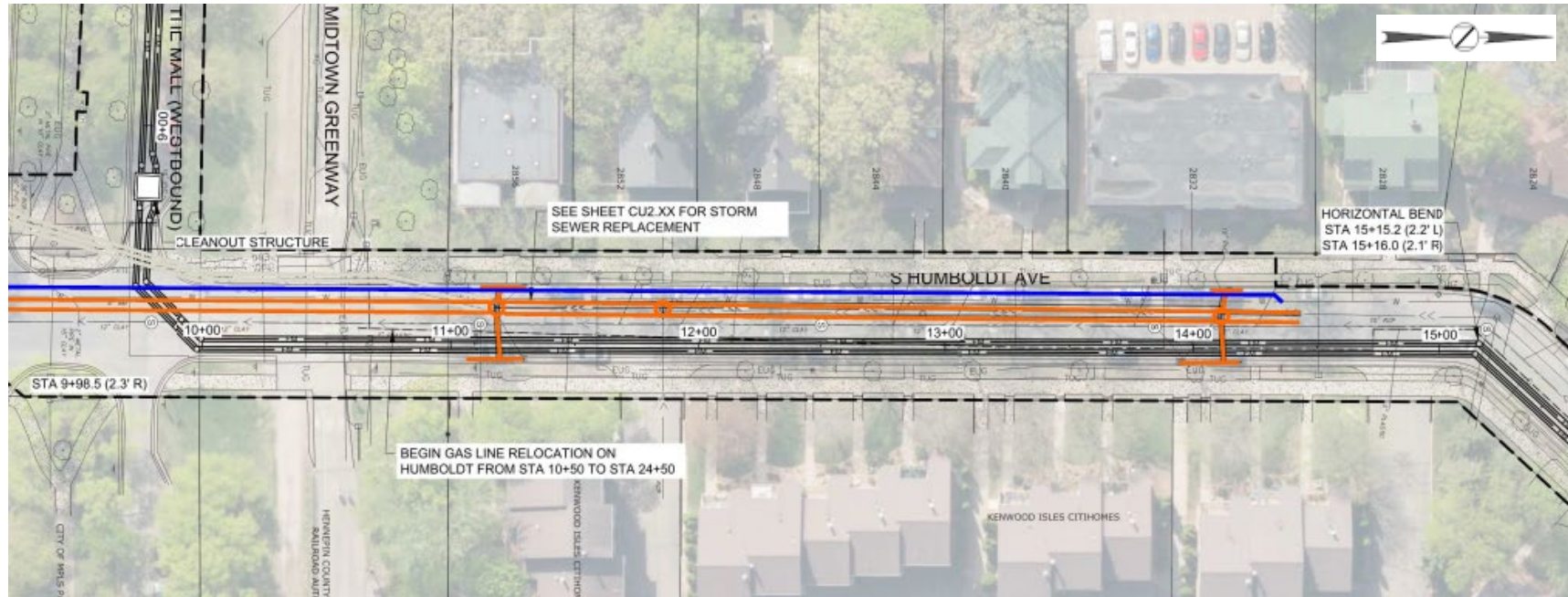

- ◆ Sanitary service crossings (east side of Humboldt Avenue)
- ◆ Gas main relocation (CenterPoint Energy)
- ◆ Remove and replace concrete curb and asphalt pavement
- ◆ Tree removal and replacement (west side)
- ◆ Temporary water service

Project Impacts – Humboldt Avenue

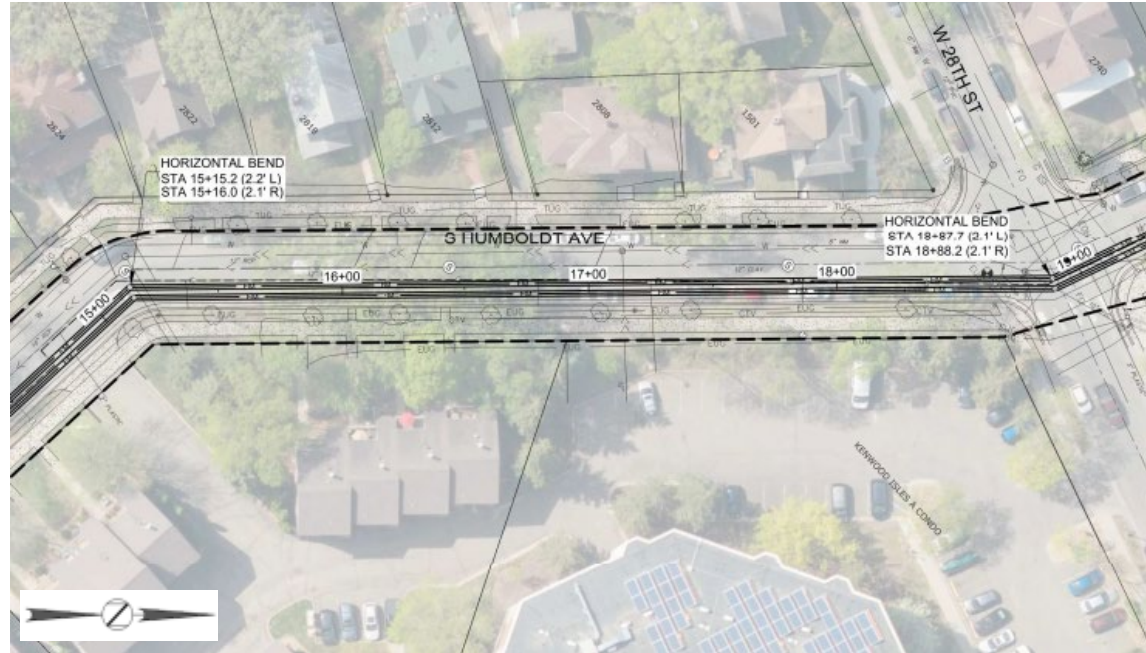

- ◆ Sanitary service crossings (east side of Humboldt Avenue)
- ◆ Gas main relocation (CenterPoint Energy)
- ◆ Remove and replace east curb
- ◆ Replace pavement in kind

Project Impacts – Humboldt Avenue



- ◆ Sanitary service crossings (east side of Humboldt Avenue)
- ◆ Water service crossings (east side of Humboldt Avenue)
- ◆ Storm lateral removal and replacement
- ◆ Gas main relocation (CenterPoint Energy)
- ◆ Remove and replace curb
- ◆ Replace pavement in kind

Impacts – Temporary Conveyance



- ◆ Temporary wastewater conveyance of existing sanitary flow around the Humboldt Avenue & 27th Street intersection
 - ▶ Aboveground temporary wastewater conveyance pipes installed on W 27th Street

Impacts – Road Closures



Proposed Project Schedule



Next Steps

- ◆ Propose & approve vehicle, bicycle, and pedestrian detour routes
 - ▶ Follow City of Minneapolis guidelines
 - ▶ Feedback from local agencies, organizations, & advocacy groups
- ◆ Community event coordination
- ◆ Final design & bidding process completed early 2021
- ◆ 2nd Public meeting (prior to construction)
- ◆ Construction anticipated to begin spring 2021

Stay Informed



Email: info@eastislessewerproject.com



Phone: 612-439-5225



Website:

www.metrocouncil.org/sewerconstruction/eastisles