



Construction Update: March 6, 2020

Web: swlrt.org

Twitter: [@SouthwestLRT](https://twitter.com/SouthwestLRT)

Construction Hotline: 612-373-3933

Concrete Work: What to Expect

With the weather getting warmer, concrete work will be the focus of construction activities in many areas. Expect to see an increase in vehicles moving concrete throughout the corridor. Concrete can only be left in trucks for a limited amount of time and for some structures, all the concrete for a specific element need to be placed at the same time. That means certain project elements will need extended hours to complete concrete work. We will highlight these activities.

Weekly Construction Photo: Downtown Hopkins Station



Can you see yourself walking up to the station to catch the train? We can! Structural steel work has been completed for the Downtown Hopkins Station. Station work activities will pick up as the weather gets nicer.

Highlights

- Beginning on March 13, Beltline will be closed for up to two days to set bridge trusses. The roadway will be closed to vehicle traffic, which will be detoured to Highway 100. Pedestrians and bikers will be flagged through the work area. However, pedestrians and bikers may encounter extended wait times if you arrive as they are placing the trusses.
- The inside lanes (one in each direction) on Prairie Center Drive, between Technology Drive and Singletree Lane in Eden Prairie is closed for LRT bridge pier construction (**a map with the roadway impacts is included below**). Utilities will be relocated in the area and then the LRT bridge pier will take about six weeks to construct.
- Tree removal between the freight rail tracks and the trail is complete for the area between France Avenue in St. Louis Park and West Lake Street in Minneapolis. Work continues in the area but currently will not impact the South Cedar Lake Trail. Once utility work is complete the trail will be paved and shifted to its new permanent location.

On-going Activities Update

Eden Prairie

SouthWest Station Area

SouthWest Transit bus riders continue to use the new temporary facility (**see pedestrian detour map below**). Utilities have been disconnected in the former facility and demolition activities will be more noticeable in early March.

Pier work, including pile driving, for the new LRT bridge that wraps around the SouthWest Station park-and ride structure will continue into Spring 2020. Sidewalks along Prairie Center and Technology Drive remain closed, please follow local signage to ensure your safety. The right-turn lane on the eastbound Highway 212 ramp to Prairie Center Drive remains closed until Spring 2020, to accommodate the completion of retaining wall work. The retaining wall is nearly complete, crews are backfilling the wall and will then remove sheeting.

Traffic is routed to the HOV lane for the eastbound Highway 212 entrance from Prairie Center Drive as streetlight installation work has started. Lighting work will be ongoing into mid to late-March. Once the lighting work is completed the crane will be “walked” back across the entrance ramp.

Prairie Center Drive

On the west side of Prairie Center Drive, near Purgatory Creek Park, excavation and installation of supports for excavation and pile driving for the LRT bridge pier has begun. The inside lanes (one in each direction) on Prairie Center Drive, between Technology Drive and Singletree Lane is closed as crews work to build an LRT bridge pier in the median. Utilities need to be relocated in the area and then the pier will take about six weeks to construct **(a map with the roadway impacts is included below)**. Additional lane closures will be needed in the spring as work for piers advances.

Eden Road Area

Retaining wall work has concluded for the winter; backfilling will resume in the spring. Expect activity in the work zone as crews prep for major spring construction.

LRT Bridge at I-494/Flying Cloud Drive

Crews are working on both the south and north abutments. Sheeting to support excavation and foundation piles are being installed. Pile driving activities are wrapping up on the north abutment and will continue into March on the south abutment. Traffic control barriers continue to be in place. The I-494 eastbound ramp to Highway 212 remains closed for the next month, depending on temperatures. **See detour map below.**

Valley View Road/Flying Cloud Drive

The lane restriction on the ramp from Valley View Road to Highway 212 continues. Traffic is being diverted onto the HOV lane and will remain in this configuration through the winter. Crews are constructing multiple piers for the new LRT bridge. The piers are at different stages of completion, with crews working on pile supports and formwork. In mid to late-March, overnight road closures on Valley View Road to set bridge girders (support beams) are upcoming. A date has not yet been set; we will give notice at least seven days in advance. **See the upcoming detour map below.**

In March, Flying Cloud Drive between Eden Road and Valley View Road will have four phases of different traffic impacts, specifically lane reductions and closures, as crews build LRT infrastructure along the north/west side of the Flying Cloud Drive. These four phases will last the duration of the 2020 construction season. This work will also have impacts on connecting roadways at various times. The initial phase, which will begin late March and will last for about a month, will close the two inside lanes and traffic will be reduced to one lane in each direction on Flying Cloud Drive. The west bound exit from Highway 494 to Flying Cloud Drive will also close for the 2020 construction season. **See the upcoming traffic map below.**

Nine Mile Creek

Pile driving for the LRT bridge structure and abutments at Nine Mile Creek will continue through the winter. Crews are working on the south abutment and piers continue to take shape. The sidewalk on the west side of Flying Cloud Drive is closed; pedestrians should use the east side.

Golden Triangle Station

Piling is ongoing in the area for LRT bridge work as crews make progress on piers. Crews are also advancing concrete work on the piers.

Shady Oak Road/Flying Cloud Drive

Storm sewer work will resume in area after other utility conflicts are cleared. Expect minor traffic impacts on the east side of the Shady Oak/Highway 212 intersection. Overall storm sewer work will take four months.

Minnetonka

Highway 62

The traffic lanes have been shifted to the south side of the highway corridor to accommodate LRT tunnel construction which is underway on the north side of the highway. This traffic configuration will be in place through 2020. Crews continue excavation and sheet piling work for the LRT tunnel. In early-March crews will begin laying the bottom leveling slab of the north tunnel section.

Red Circle Drive and Yellow Circle Drive

Yellow and Red Circle Drives have been reconfigured. Yellow Circle Drive is temporarily dead ended with a cul-de-sac where it connects to Red Circle Drive, and Yellow Circle has temporarily become a two-way roadway in the area south of Blue Circle Drive. A temporary by-pass road has also been completed on Red Circle Drive. This roadway configuration will allow for ongoing tunnel construction on Highway 62 and will be in place until Fall 2020. **See a map of the roadway changes below.**

Opus Station Area

Earthwork continues in this area. Retaining wall work is ongoing, north of the station area.

Smetana Road

Smetana Road from Feltl Road to Nolan Drive is closed through 2020. A temporary bypass is in place west of the intersection of Smetana and Feltl roads to accommodate traffic in this area. **See detour maps below.** Watermain and sanitary sewer work will continue in the area.

Hopkins

Minnetonka-Hopkins Bridge Area

Preparation work including tree clearing and ground cover removal for the Minnetonka-Hopkins Bridge continues. Crews will start clearing work closest to the railroad line and will move south. Crews have started to build an access road.

Downtown Hopkins Station

Work is complete on the station's structural steel elements that support the walls and roof canopy. Other station work activities will pick up as the weather gets nicer.

Excelsior Boulevard Area

Crews continue to work on the LRT bridge and underground utilities in the area. Piers continue to take shape and work on both bridge abutments is ongoing with pile driving and sheeting work.

Blake Road

Crews continue constructing a cut and cover tunnel for the regional trail on the west side of Blake Road. Southbound traffic will continue to be diverted to the east side of the road, with one lane in each direction, through the spring.

St. Louis Park

Minnehaha Creek

Work on the new freight and trail bridges will continue in this area. The abutments are complete. With warmer weather in the forecast, crews will begin backfilling retaining walls in the next few weeks. Work will also pick up in the spring to set bridge girders

Louisiana Avenue

This spring crews will begin work to place bridge beams over the roadway, two overnight closures are anticipated but not yet scheduled. East of Louisiana Avenue, crews are working on the pedestrian/bike tunnel to

the station. Piling driving for the tunnel that will extend under the freight tracks to the station is underway. Shoring and sheeting work for the southerly railroad connection, that will replace the current wye track, along Oxford Street is beginning next week.

Wooddale Avenue

Wooddale Avenue between West 36th Street and Highway 7, in the immediate vicinity of the Southwest Project, is reduced to one lane in each direction. Pedestrian access is maintained. Crews are constructing the west approach for the regional trail tunnel. A full road closure will be needed for 30 days, anticipated in late spring, more details to follow. Utility work also continues in the area, with roadway impacts to the southwest.

Highway 100

The project will be re-positioning the existing freight rail bridge and will build a new LRT bridge over Highway 100 later this year. Bridge abutment work is ongoing.

Beltline Boulevard

Beginning on March 13, Beltline will be closed for up to two days to set bridge trusses. The roadway will be closed to vehicle traffic, which will be detoured to Highway 100. Pedestrians and bikers will be flagged through the work area. However, pedestrians and bikers may encounter extended wait times if you arrive as they are placing the trusses.

Minneapolis

Kenilworth Area Construction

Sheet piling for the Kenilworth tunnel continues. One of the press-in-pilers will continue working south from 28th Street. The second press-in-piler is moving north from 28th Street on the freight rail side. It will stop short of Cedar Lake Parkway and return south, working towards Lake Street. Sheeting installation is expected to last until Summer 2020.

Tunnel excavation is anticipated to begin Spring 2020. For more information about tunnel construction, see the [tunnel FAQ](#) information under the construction tab of our webpage: swlrt.org. A short [video](#) of the press-in-piler construction technique is also available.

In preparation for future tunnel work, a Metropolitan Council Environmental Services sanitary sewer force main needs to be temporarily relocated, with crews working around 28th Street. Xcel is moving a conflicting electrical

pole from the area. After this work is complete, Dean Court will become a two-way roadway and will remain in this configuration for six to eight weeks. We anticipate the roadway reconfiguration will be implemented in mid-to late March. We will provide updates as work progresses.

Cedar Lake (Kenilworth) Channel and Works Progress Administration (WPA)

Piling for the final freight bridge abutment on the north is expected to be completed in the next two weeks. Following this activity, temporary sheeting will be removed from the channel. This activity also generates vibration. Then focus will switch to concrete work, bridge spans and utility work.

21st Street

Earthwork has begun in the area between Burnham Road Bridge and 21st Street in Minneapolis. Expect earthmoving equipment such as excavators and dump trucks that will be removing and bringing in soil. Crews are working to make soils suitable for the LRT track foundation.

Bryn Mawr Station Area

Crews continue earthwork in the Bryn Mawr Station area in Minneapolis. Activities include excavating unsuitable soil followed by placing a surcharge consisting of soil brought into the area. Overall, the surcharge will remain for five months to consolidate the underlying soil to provide a suitable foundation for the station.

Glenwood Avenue

Glenwood Avenue between Lyndale Avenue North and 11th Street North is closed until mid-2021. The roadway is closed to vehicle, pedestrian, and bicycle traffic as the bridge has been removed. **See detour map below.** Local access to businesses continues to be maintained. Crews have made significant progress on utility work and retaining walls in the area. Work on the west abutment for the new roadway bridge continues.

Royalston Avenue

Work on the LRT bridge piers on the east side of Royalston Avenue is ongoing and will continue through the spring. Expect pile driving activities in this area. Northbound Royalston Avenue is reduced to one lane and southbound Royalston Avenue is closed between Border Avenue and 5th Avenue until Summer 2021. Southbound travel on Royalston Avenue, south of 5th Street, is anticipated to close on March 30. **See the roadway impact map below.**

Regional Trails

Minnesota River Bluffs Regional Trail

The Minnesota River Bluffs Regional Trail in Hopkins is closed between Shady Oak Road and 5th Avenue South.

See detour map below.

- The section between Shady Oak Road and 11th Avenue South is closed due to storm sewer construction activities. This portion of the trail is closed until Summer 2020.
- The section between 11th Avenue South and 5th Avenue South is closed until Fall 2021.

South Cedar Lake LRT Trail

The South Cedar Lake Trail from just east of the North Cedar Lake Trail connection in Hopkins to France Avenue in St. Louis Park is closed until Fall 2021. The South Cedar Lake Trail will remain open between France Avenue in St. Louis Park and Kenilworth Trail/Midtown Greenway intersection in Minneapolis. The Midtown Greenway will remain open. Currently, cross streets remain open to automobiles, bikes and pedestrians, with separate closures of roadways upcoming at various dates. **See detour maps below.**

In the **Chowen Avenue to Lake Street** area, storm sewer and watermain work continues on the side of the trail.

Kenilworth Trail Closure

The Kenilworth Trail is closed in Minneapolis at the intersection with the Midtown Greenway to just south of West 21st Street until Summer 2022. Access for automobiles, bikes and pedestrians remains open at Cedar Lake Parkway and at West 21st Street. **See detour map below.**

North Cedar Lake Trail in Minneapolis

The North Cedar Lake Trail in Minneapolis from Linden Yards located west of Van White Boulevard to east of Royalston Avenue is closed until mid-2021. **See detour maps below.**

Crews constructed a temporary trail bypass in the area where the North Cedar Lake Trail connects to the Kenilworth Trail. Signage is in place to direct trail users onto this newly constructed segment. This work is in preparation for station construction in Spring 2020.

Please note, construction vehicles cross the trail as they enter and exit staging areas. Construction vehicles yield to trail users but please be aware that you may encounter construction traffic in this area. Anticipate flaggers in this area as earthwork activities begin in the Bryn Mawr Station area in the next few months.

Workforce Opportunities

- Lunda Construction Company and C.S. McCrossan Joint Venture (LMJV), along with their subcontractors, community-based organizations, and unions are holding a Southwest Light Rail Transit Construction Career Fair to discuss potential trade positions within their organizations. The event will be held March 26, 2020 from 8:00 AM to 12:00 PM at the Minneapolis Urban League, 2100 Plymouth Avenue North, Minneapolis. Questions can be directed to Sannyang Vang at: svang@lundaconstruction.com or 952-209-2123 ext. 246.

SouthWest Transit Station Pedestrian Detour in Eden Prairie

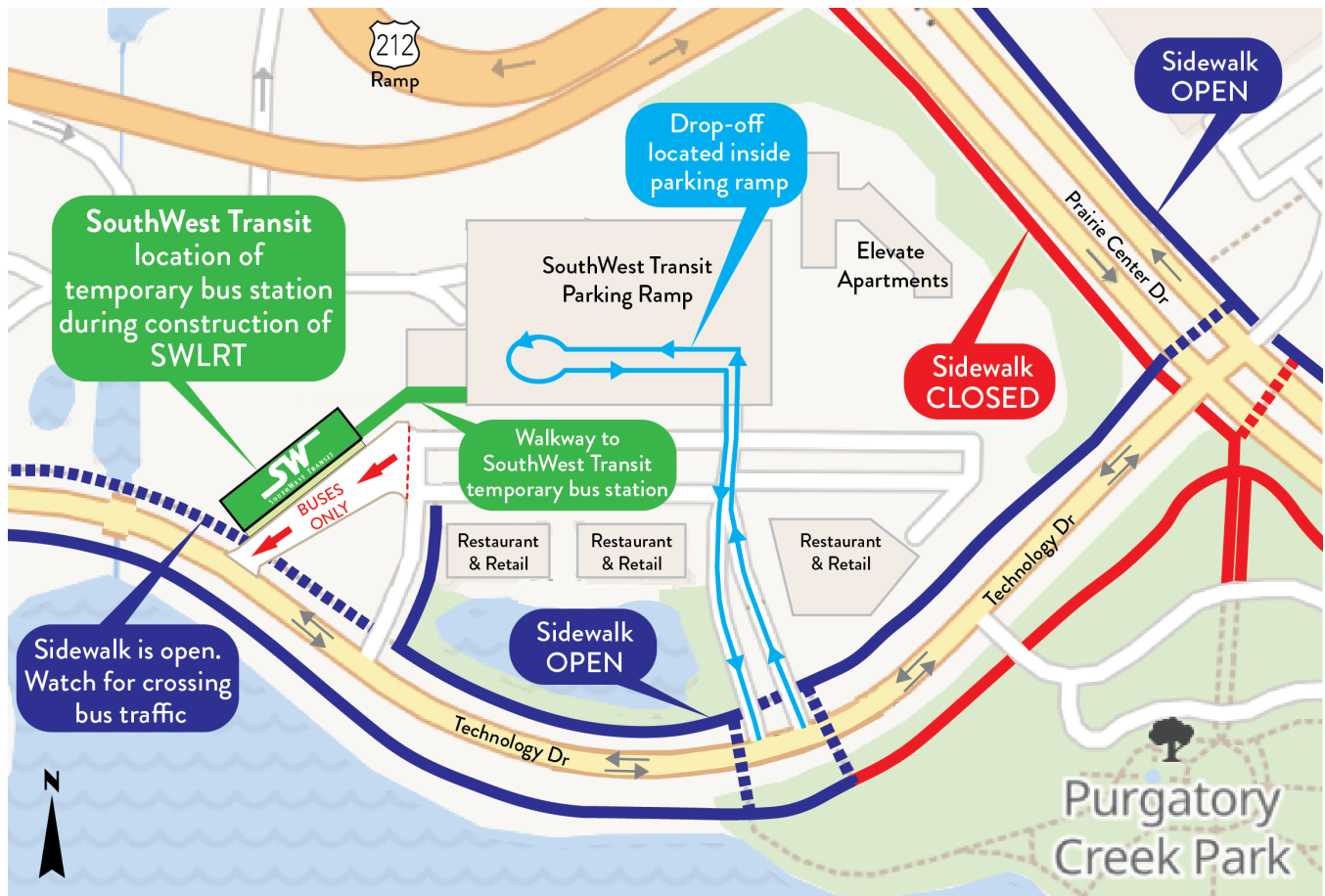

Prairie Center Drive Lane Reductions



Northbound I-494 to Eastbound TH 212 Detour

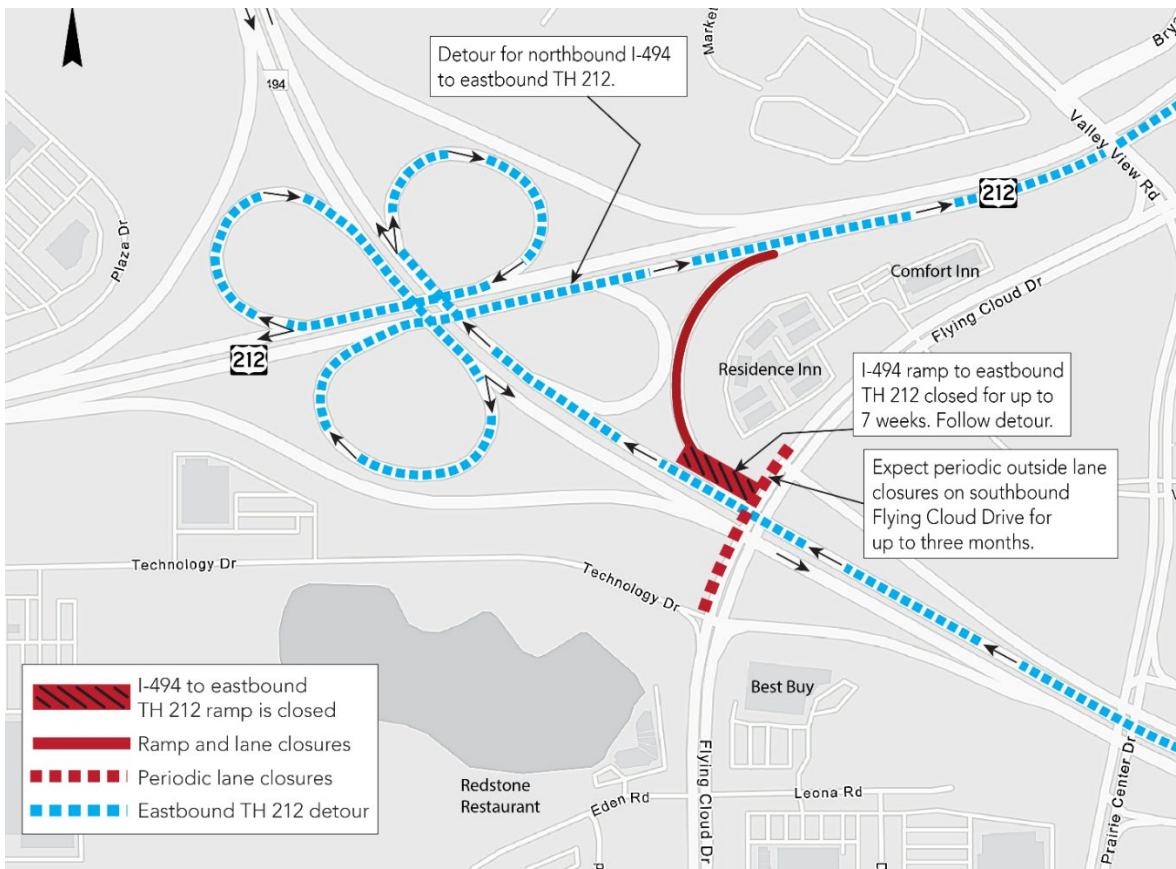

Upcoming: Flying Cloud Drive in Eden Prairie



Upcoming: Valley View Road/Flying Cloud Drive in Eden Prairie. Seven day notice of the closure will be given.

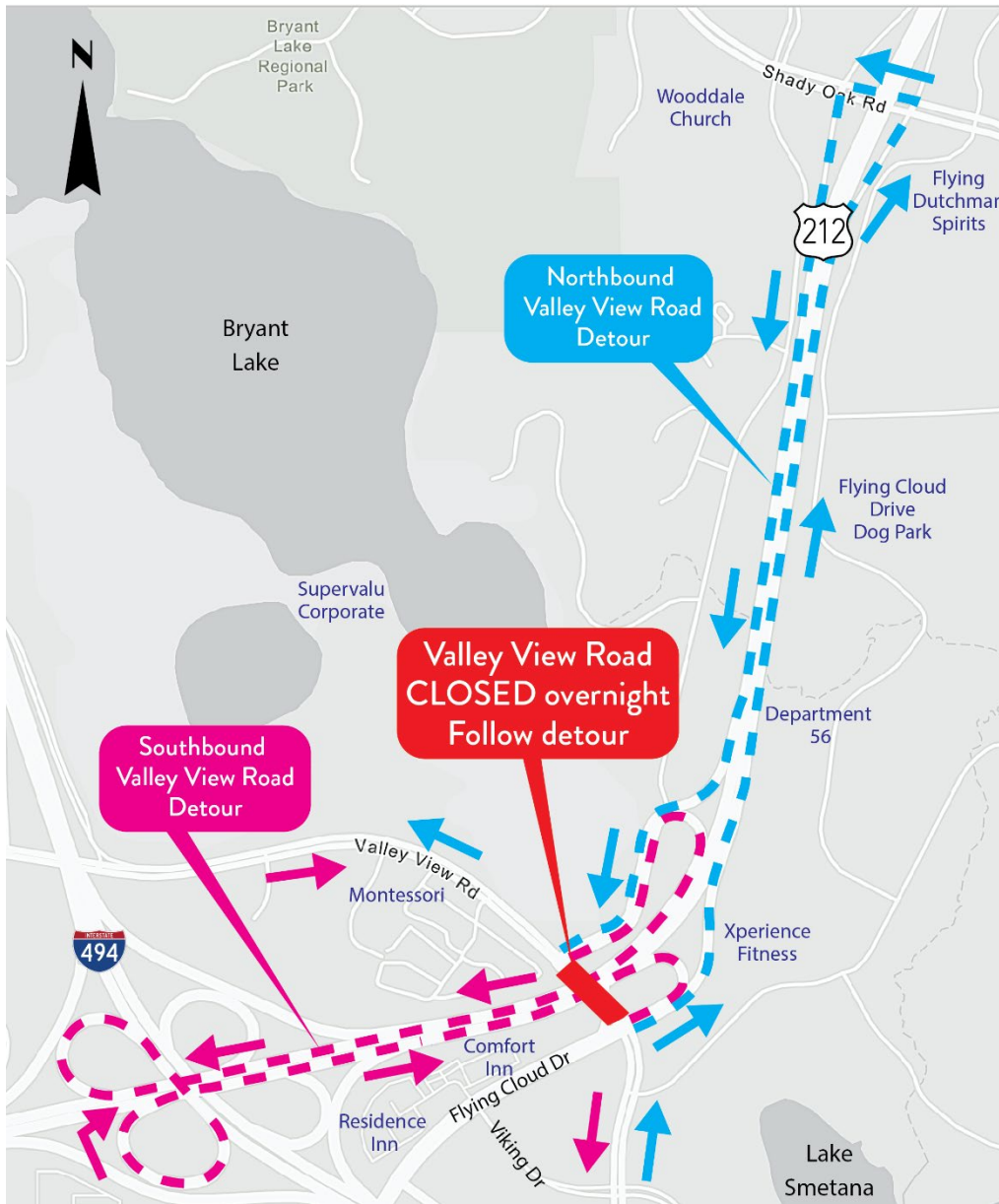

Yellow Circle Roadway Changes in Minnetonka



Smetana Road in Minnetonka and Hopkins Detour



Minnesota River Bluff Trail from Shady Oak Road to 5th Avenue Detour

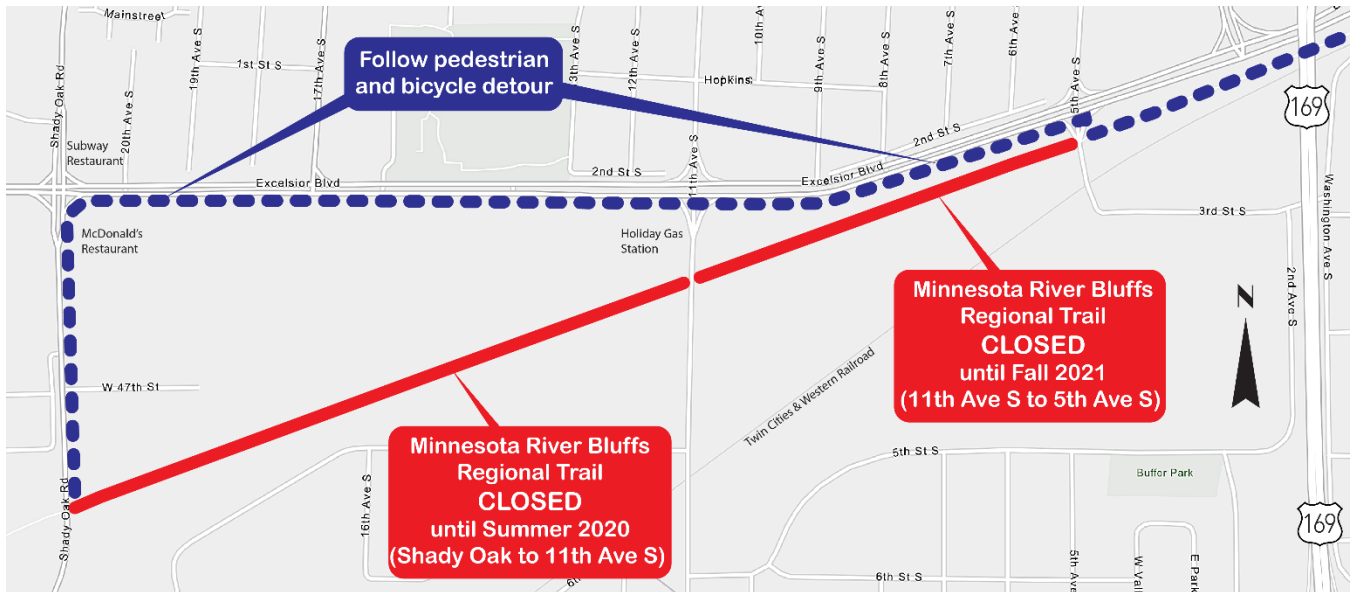

TRAIL DETOUR

MORE DETAILS: SWLRT.ORG

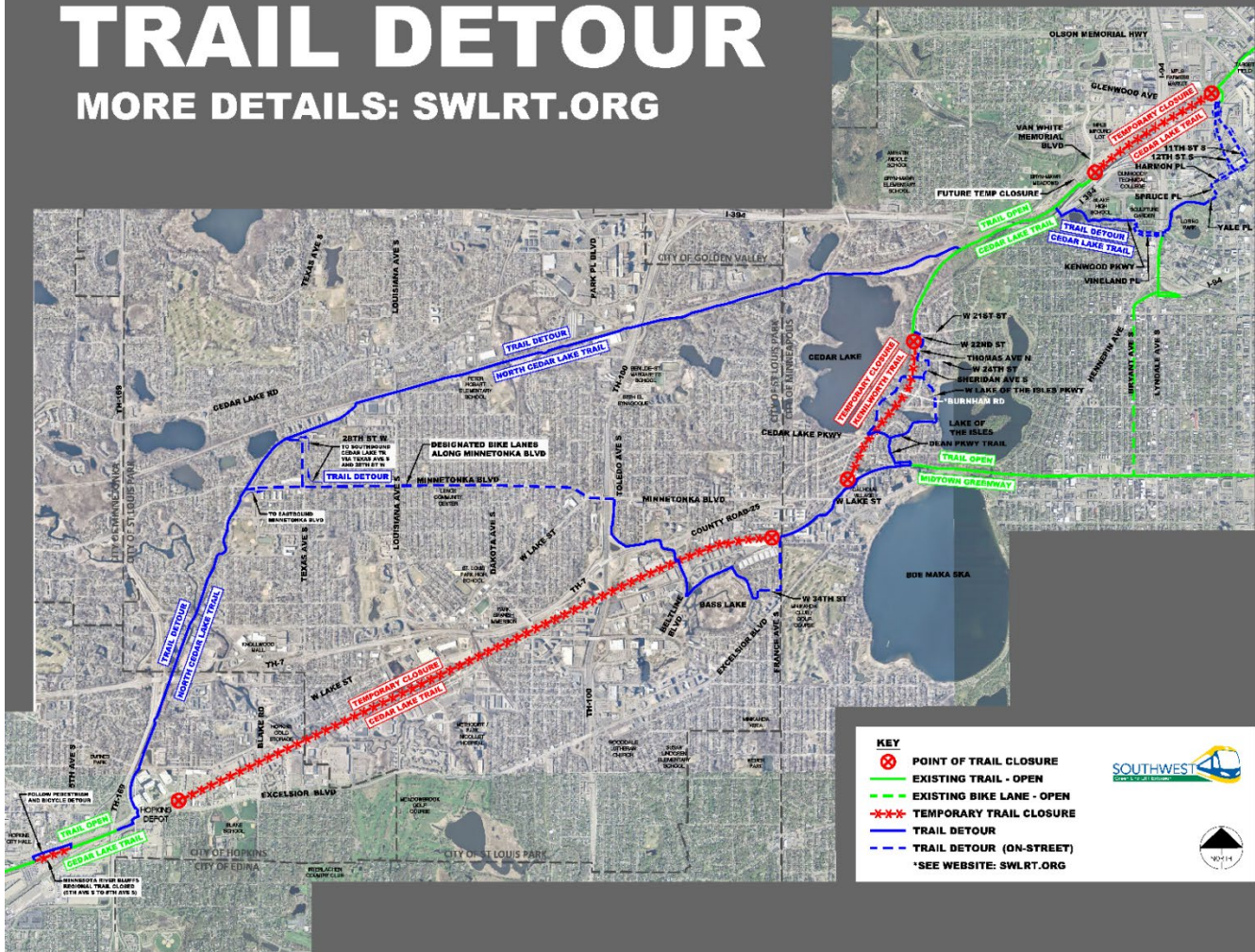

Beltline Boulevard in St. Louis Park Vehicle Detour



Glenwood Avenue in Minneapolis Detour

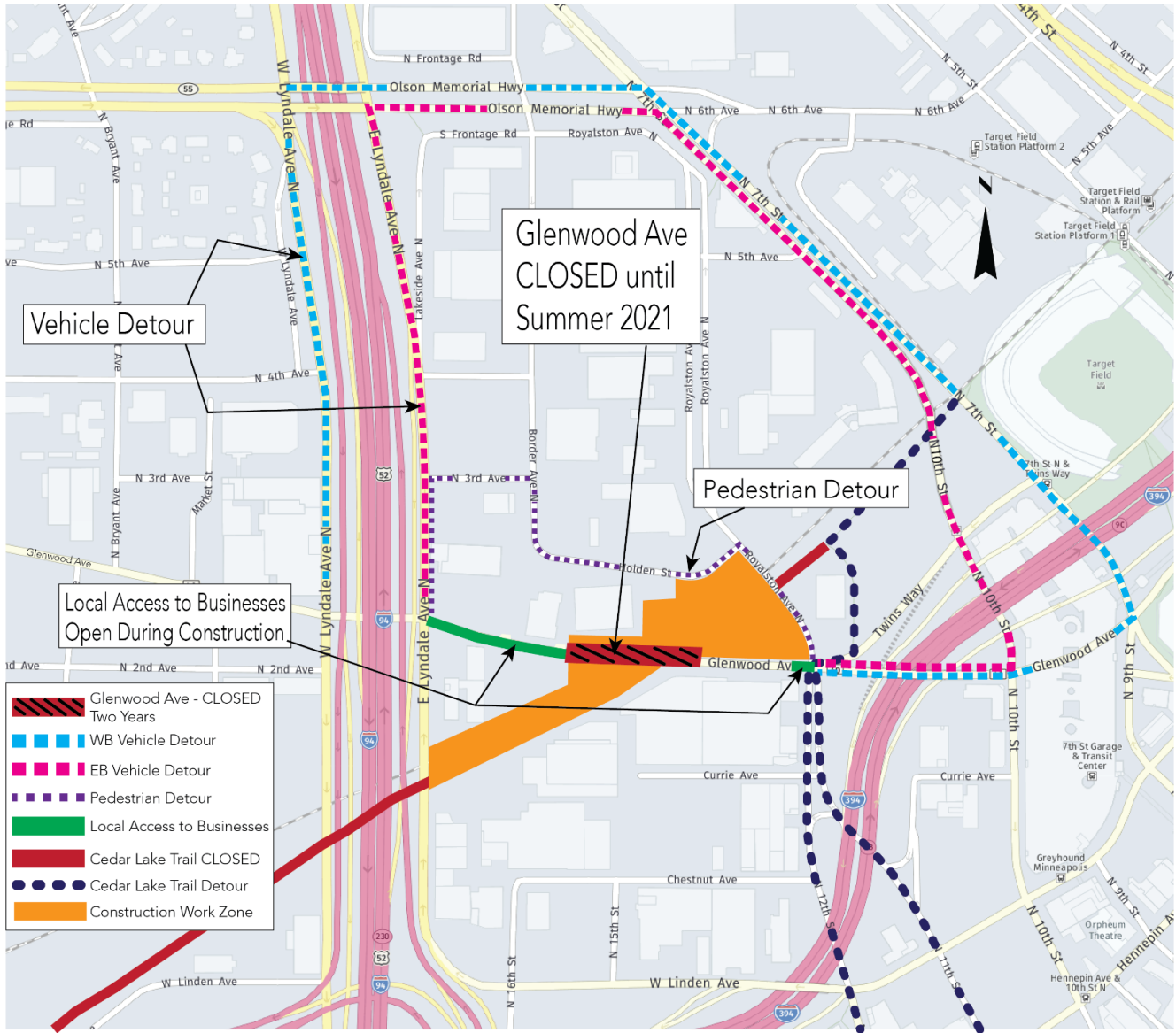

Royalston Avenue in Minneapolis: Upcoming

