



Business Advisory Committee

December 12, 2017



Today's Topics

- Bassett Creek Storm Sewer Construction Update
- 90% Design Plans and Next Steps
- Station Design: 63rd & Bass Lake Road
- 2018 BAC Meeting Schedule



Bassett Creek Storm Sewer Construction Update



Bassett Creek Storm Sewer Construction

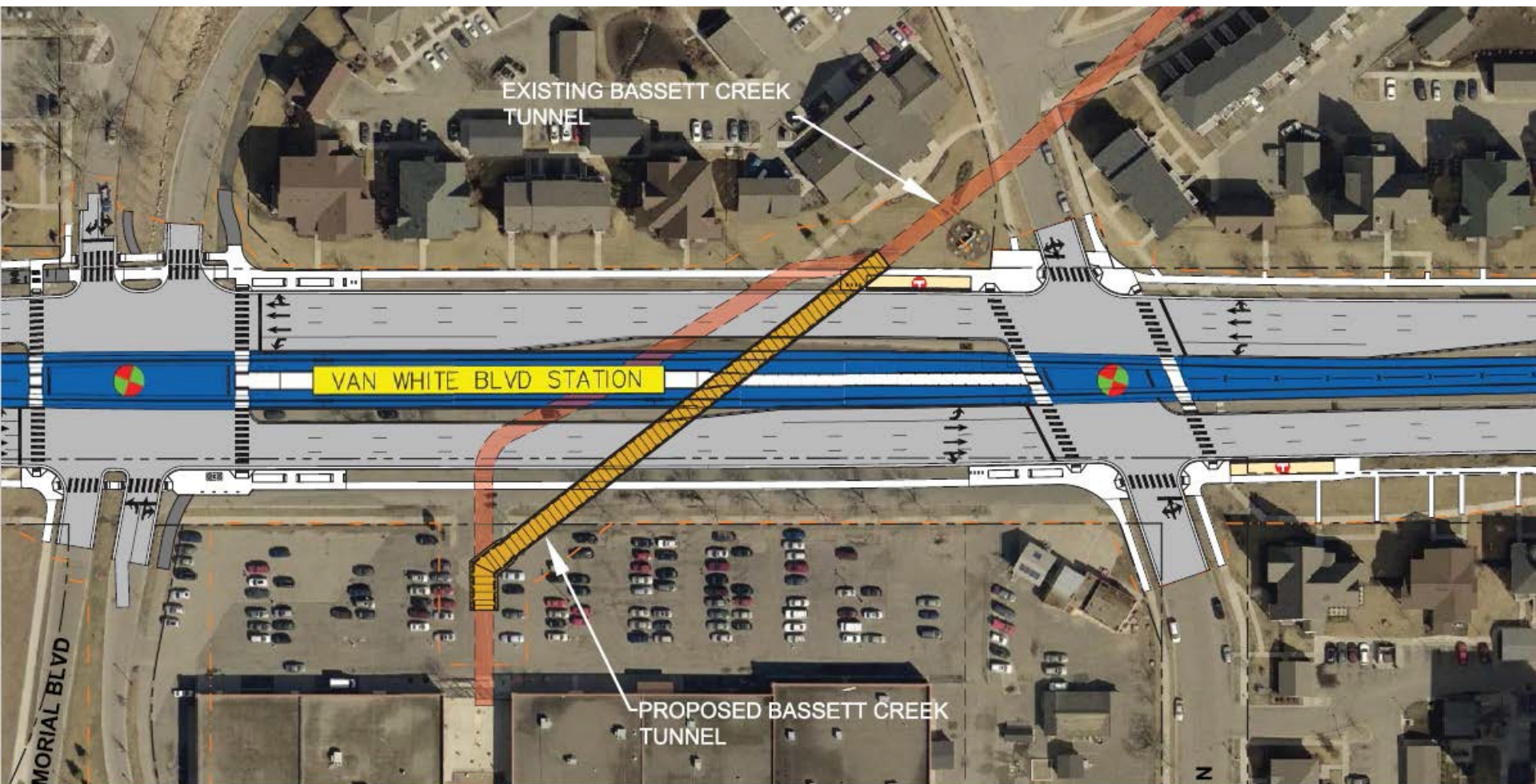

Bassett Creek Storm Sewer

- Over a year of coordination with project partners proves successful!

- § Coordination of work and traffic control

- MnDOT, County, City, MC Environmental Services

- § Public outreach and media campaign

- Mobile friendly web mapping tool
 - Construction video
 - Community radio/newspapers
 - Door-knocking
 - Neighborhood meetings
 - Twitter
 - Press release
 - Email blasts
 - Variable message signs
 - Project newsletter



October 10 Open House



Bassett Creek Storm Sewer

- Contractor began mobilization week of Oct 23
- 12 day closure of Olson Memorial Highway (OMH) began Oct 30 after morning rush hour
- Contractor worked 24 hour days during closure
- OMH back open to traffic on Nov 11
- Connection to south end tunnel will take place over the winter
- Restoration Spring 2018



Road Closure 10/30 @ 9:00 am



Excavation Begins 10/30 @ 9:01 am



Pavement Removal



Tunnel Excavation



North End Tunnel Connection



Bassett Creek Storm Sewer Connection



Night Work



Moving Iron



Box Tunnel Placement



New Tunnel (Lt) / Old Tunnel (Rt)



Bypass Connection Points



Installed Pipe Sections



Winter Work



Pedestrian Access



Paving



Buses and Traffic Back on OMH: November 11



Opening Storm Tunnel on South Side



South Tunnel Connection Point



Removing Top of Sanitary Pipe



90% Design Plans and Next Steps



Civil Construction Packages

- Civil 1: Target Field Station thru CSAH 81 flyover bridge
- Civil 2: Jolly Lane to Operations & Maintenance Facility
- Packages include:
 - § Roadway, bridges, retaining walls
 - § Utilities
 - § LRT guideway
 - § Freight rail
 - § Stations
 - § Park-and-rides

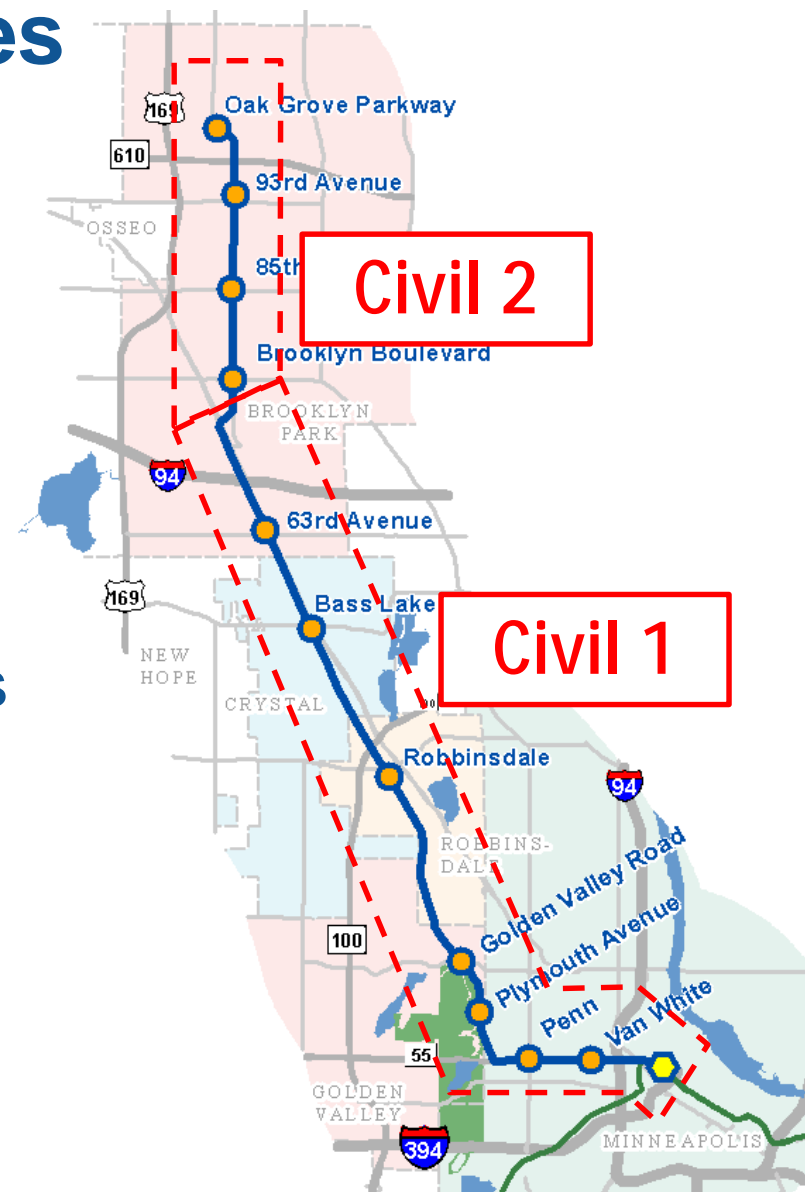

90% Design Plans

- Civil 1 and Civil 2 completed and delivered on November 17, 2017
- Civil plans have been shared with project partners for review and comment
- Comments will be addressed and changes will be included in final plans



90% Design Plans

- Mid-December:
 - § Civil 90% specifications due
 - § 90% Systems and OMF plans due
- Mid-January: Systems and OMF 90% specifications due



Q1 2018 Design Activities

- Olson Memorial Highway design advancement
 - § Median landscape and signage design
 - § Detail storm water design
 - § Private utility coordination
 - § TPSS Screening
- West Broadway design advancement
 - § Landscape and signage design
 - § Detail storm water design
 - § Private utility coordination
- Oak Grove Parkway parking structure
- Advanced Design Packages
 - § Floodplain mitigation/MCES forcemain
 - § Theodore Parkway Bridge



Q1 2018 Design Activities

- Freight Rail Corridor

- § Document current design assumptions for negotiations team
- § Document BNSF impact mitigation
- § Design support during negotiations



Station Design Advancement: 63rd Avenue & Bass Lake Road



Station Design Advancement

- 63rd Avenue Station
 - § Access via elevator/stair tower and from at-grade entrance, both serving existing park and ride
- Bass Lake Road Station
 - § Access via surface park and ride and from at-grade entrance at Bass Lake Road



63rd Avenue Station



63rd Avenue Station



Looking northwest



63rd Avenue Station



Looking northwest

63rd Avenue Station



Looking north

63rd Avenue Station



DRAFT-WORK IN PROCESS



63rd Avenue Station



Looking southeast

Bass Lake Road Station



Bass Lake Road Station



Looking south

Bass Lake Road Station



Looking northwest

Bass Lake Road Station



2018 BAC Meeting Schedule



2018 Meeting Schedule

- Monthly, Tuesday before CMC meeting: 8:00–9:00 AM
- Held at Blue Line LRT Extension Project Office:
 - § January 9
 - § February 6
 - § March 6
 - § April 10
 - § May 8
 - § June 12
 - § July 10
 - § August 7
 - § September 11
 - § October 9
 - § November 6
 - § December 11



More Information



The screenshot shows the METRO website's navigation bar with links: About Us, News & Events, Data & Maps, Publications, Doing Business, Council Meetings, Contact Us, and Employment. Below the navigation bar is a menu with categories: COMMUNITIES, PARKS, TRANSPORTATION (highlighted), WASTEWATER & WATER, HOUSING, and PLANNING. The main content area features a large photo of a blue and yellow METRO bus with 'MINNEAPOLIS' and 'METRO' branding, with several people standing in front of it. Below the photo is a section titled 'METRO BLUE LINE EXTENSION' with a dropdown arrow. To the right of this section is a detailed description of the project, titled 'METRO BLUE LINE EXTENSION Bottineau Transitway – Minneapolis & Northwestern Communities'. The description states: 'The METRO Blue Line Extension (LRT) will operate northwest from downtown Minneapolis through north Minneapolis, Golden Valley, Robbinsdale, Crystal and Brooklyn Park, drawing riders northwest of Brooklyn Park. The proposed alignment is primarily at-grade and will have up to 11 new stations in addition to Target Field Station and about 1.3 miles of double track. The line will interline with the METRO Blue Line and connect Minneapolis and the region's northwest suburbs with existing LRT on the METRO Green Line, future LRT on the METRO Green Line Extension, bus rapid transit on the METRO Red Line, the Northstar commuter rail line and local and express bus routes.' Below the description is a 'Latest News' section with the headline 'Feds: Met Council can begin designing METRO Blue Line Extension' and a 'Route' section with the text 'Click on the map below for more information'.

About Us | News & Events | Data & Maps | Publications | Doing Business | Council Meetings | Contact Us | Employment

COMMUNITIES | PARKS | **TRANSPORTATION** | WASTEWATER & WATER | HOUSING | PLANNING

METRO BLUE LINE EXTENSION

Route

Stations

Environmental

Timeline

Project Partners

METRO BLUE LINE EXTENSION

Bottineau Transitway – Minneapolis & Northwestern Communities

The METRO Blue Line Extension (LRT) will operate northwest from downtown Minneapolis through north Minneapolis, Golden Valley, Robbinsdale, Crystal and Brooklyn Park, drawing riders northwest of Brooklyn Park. The proposed alignment is primarily at-grade and will have up to 11 new stations in addition to Target Field Station and about 1.3 miles of double track. The line will interline with the METRO Blue Line and connect Minneapolis and the region's northwest suburbs with existing LRT on the METRO Green Line, future LRT on the METRO Green Line Extension, bus rapid transit on the METRO Red Line, the Northstar commuter rail line and local and express bus routes.

Latest News

Feds: Met Council can begin designing METRO Blue Line Extension

Route

Click on the map below for more information

Website: BlueLineExt.org

Email: BlueLineExt@metrotransit.org

Twitter: [@BlueLineExt](https://twitter.com/BlueLineExt)

