



# Corridor Management Committee

March 7, 2012





# Today's Topics

- SWLRT Project Office Update
- Engineering Services Procurement Update
- Legislative Leadership Tour
- Annual New Starts Report
- Update on Proposed FTA Rule Making
- CCLRT 2011 Lessons Learned
- Advisory Committees Update
  - Committee Flow Chart
- Communications Update



# Southwest LRT Project Office



# Project Office Timeline

- Lease executed – 2/16/12
- Begin demolition of interior – 2/23/12
- Build out and finishes – March
- Move in – April



# Project Office

## Park Place West

6465 Wayzata Blvd., St. Louis Park





# Southwest Project Office (SPO)

Park Place West, 6465 Wayzata Blvd., St. Louis Park







# Southwest Project Office (SPO)





# Engineering Services Procurement



# Engineering Services Schedule

Major Milestones	Tentative Dates
Entry into PE	September 2, 2011
Advertise RFP	October 21, 2011
Pre-Proposal Conference	November 8, 2011
Response to Questions	November 23, 2011
Proposals Due	December 16, 2011
Interview Proposers	January 23 & 25, 2012
Award Contract	March 2012
Sign Contract / Issue LNTP	March 2012



# Legislative Leadership Tour

## 2/24/12



# Annual New Starts Report



# Peer "New Starts" PE Projects out of 100+ Applicants (February 2012 Status)

- Medium-High - 6
- Medium - 4

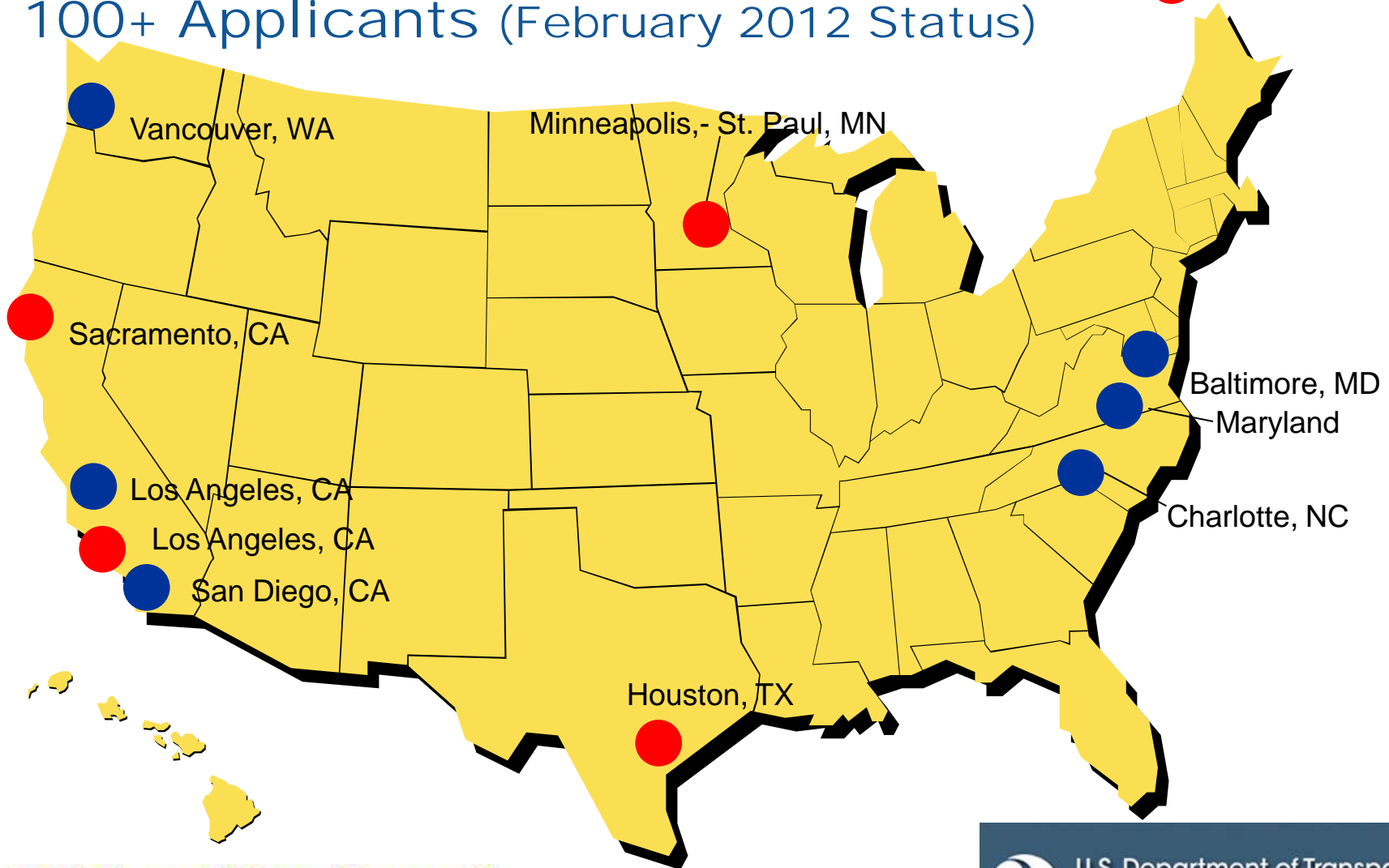

## FTA 2013 Project Rating

<b>Local Financial Commitment</b>	<b>Medium</b>
New Starts Share	Medium
Capital Plan	Medium
Operating Plan	Medium High
<b>Project Justification</b>	<b>Medium</b>
Environmental Benefits	Medium
Operating Effectiveness	Medium
Mobility Improvements	Medium
Cost Effectiveness	Medium-Low
Economic Development	Medium-High
Land Use	Medium
<b>Overall Project Rating</b>	<b>Medium</b>





# Proposed FTA Rule Making Update



# Hiawatha Light Rail Transit







# Northstar Commuter Rail





# Central Corridor Light Rail Transit

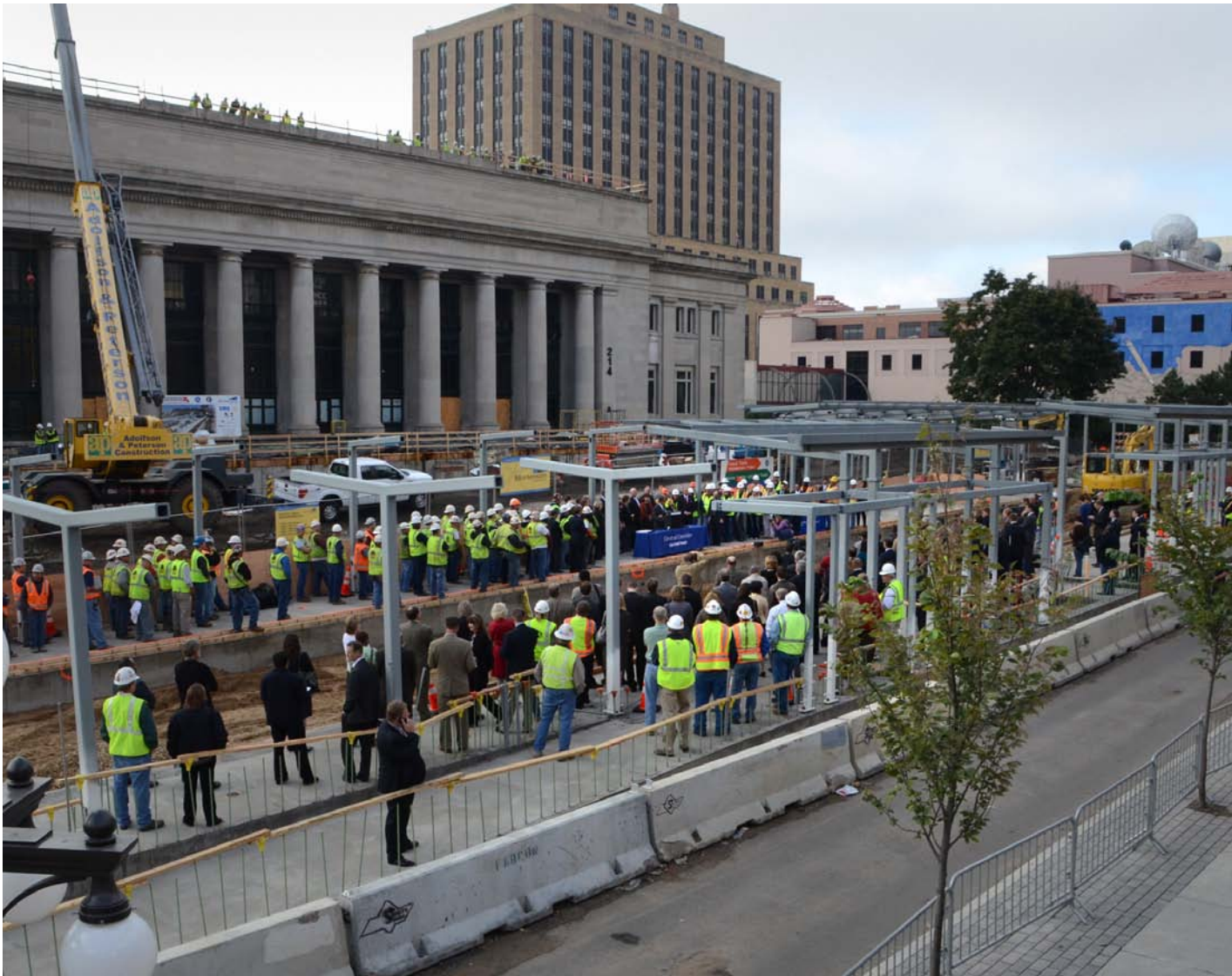



# Federal Funding Participation



Hiawatha: \$413 million  
Northstar: \$162 million  
Central: \$478 million  
**Total: \$1.053 billion**



 **Metropolitan Council**



U.S. Department of Transportation  
Federal Transit Administration





# 2030 Transitway Map

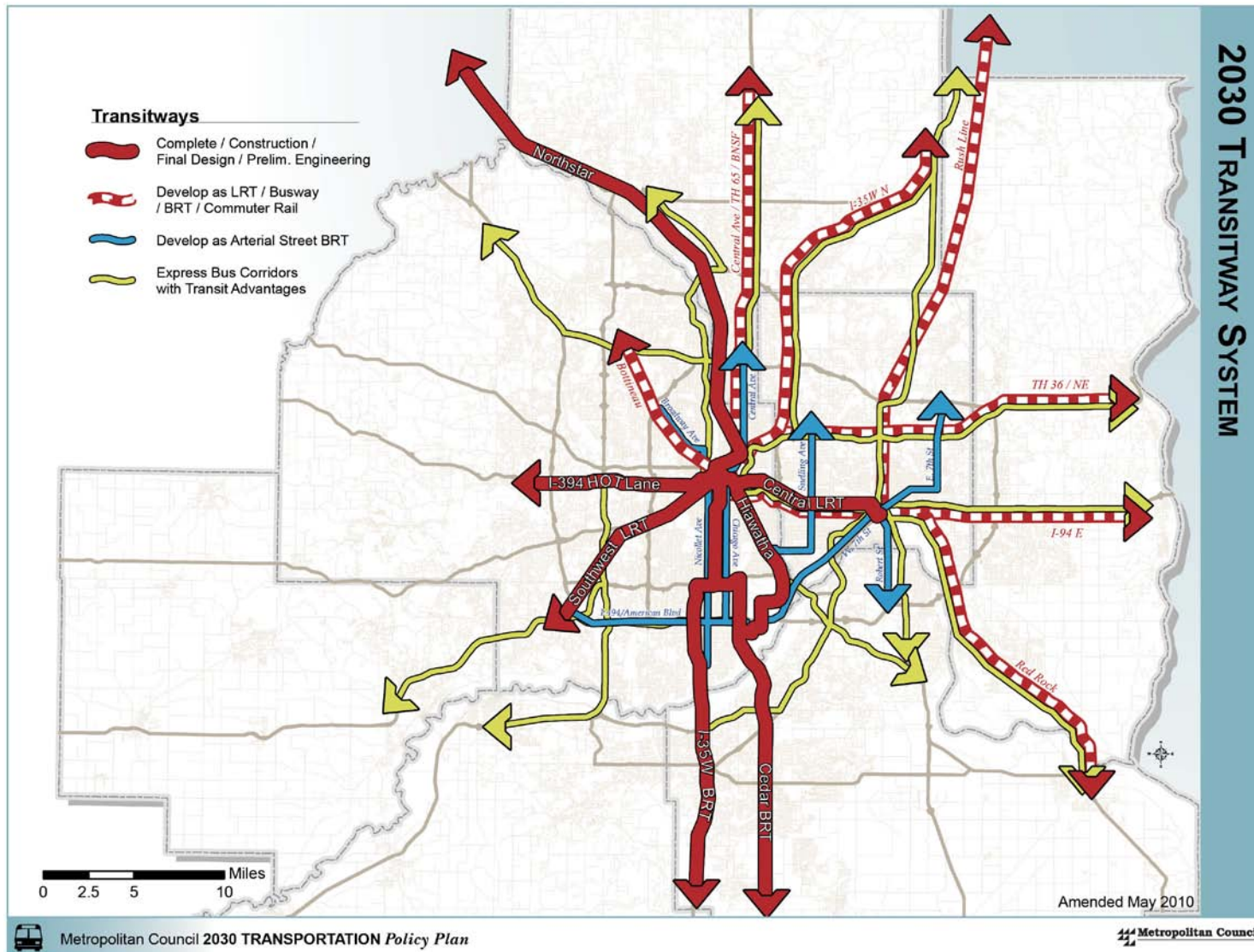



# New Starts Statutory Evaluation and Rating Framework

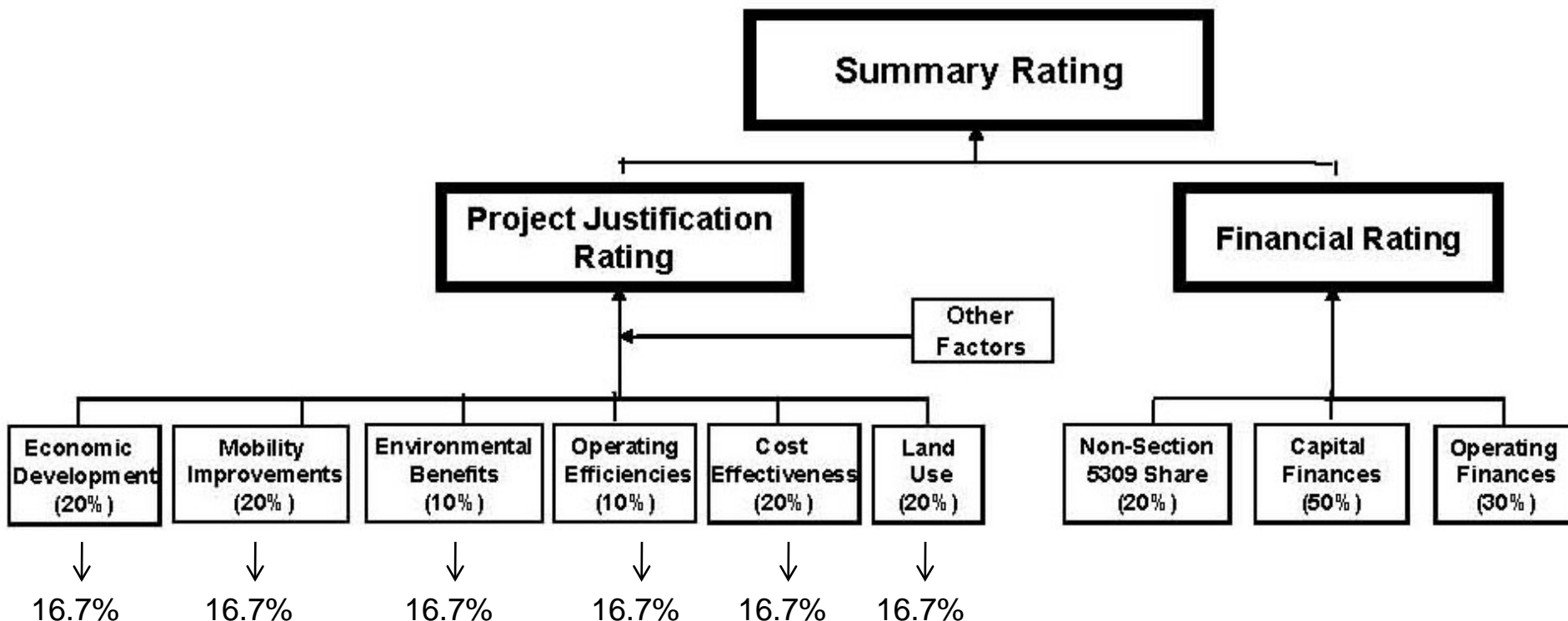



# Small Starts Evaluation and Rating Framework

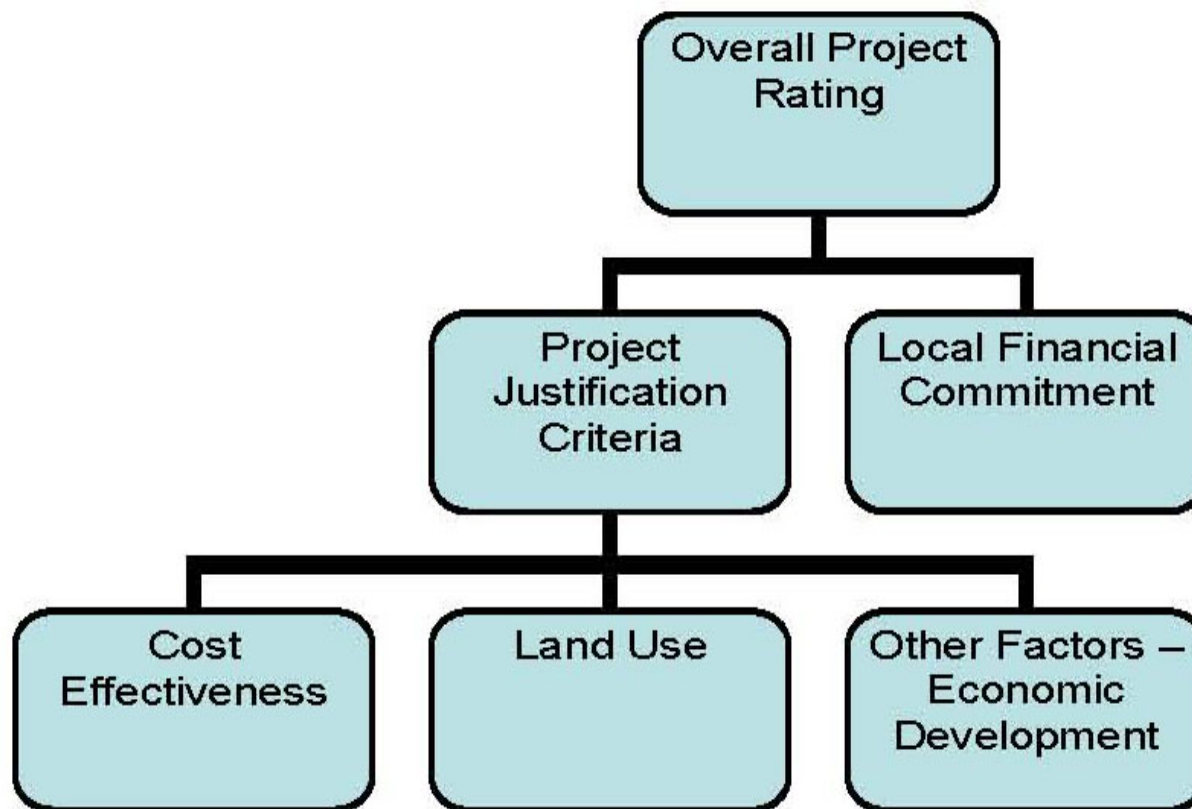

# Cost Effectiveness

## Abolish:

- Baseline alternative
- Transportation system travel time saved concept

## Propose:

- Comparing build to no build in current year or 10 year horizon
- Cost equals annualized capital and annual operating
- Transit ridership equals trips
- Transit dependent trips 2x

# Economic Development

## Continue:

- Likelihood to enhance TOD
- Transit supportive plans and policies

## Propose:

- Policies supportive of affordable housing
- VMT reductions resulting from changes in development patterns
- Number of jobs created by project design, construction and operation



# Land Use

## Continue:

- Corridor and station area population
- Existing land use
- Existing parking with one-half mile

No new proposals

# Environmental Benefits

## Abolish:

- Simplistic rating based on attainment status

## Propose:

- Benefits from reduced vehicle emissions
- Benefits from reduced greenhouse gas emissions
- Benefits from increased safety
- Benefits from increased public health
- Capture reductions in Vehicle Miles Traveled and monetize benefits

# Mobility Improvements

## Abolish:

- Baseline alternative
- Transportation system user benefits concept

## Propose:

- FTA develop national model to calculate passenger trips for projects
- Transit dependent transit trips
  - Zero car households
  - Lowest income bracket households
- Transit dependent trips 2x
- Current year or 10 year horizon or both weighted 50%

# Operating Efficiencies

## Abolish:

- Difference in system wide operating cost per passenger mile between project and baseline

## Propose:

- Difference in operating and maintenance cost per “place mile” compared to:
  - Existing transit system in current year
  - Existing system and no-build system in 10 year horizon

# What does the FTA NPRM mean for Future Transitways Success?

- Ridership, Ridership, Ridership
- Supportive plans and policies, emphasize affordable housing and station area TOD
- Transit dependent trips are counted twice
- Environmental benefits



## Next Steps

- Late Feb - Gather more technical detail from FTA
- Early March - Draft comments
- Mid March - Align comments
- March 26 - Submit comments to FTA



# CCLRT 2011 Lessons Learned

## Central Corridor Light Rail Transit



## Vehicle Traffic and Access

# Issue: North/South Lane Restrictions

- Phased intersection construction to maintain through traffic
- 2-3 month impact to intersections





# Action: Full Closure of Select Intersections

- Expedite work over 2-4 weeks
- Use variable message signs to provide detour directions
- Provide maps showing detours

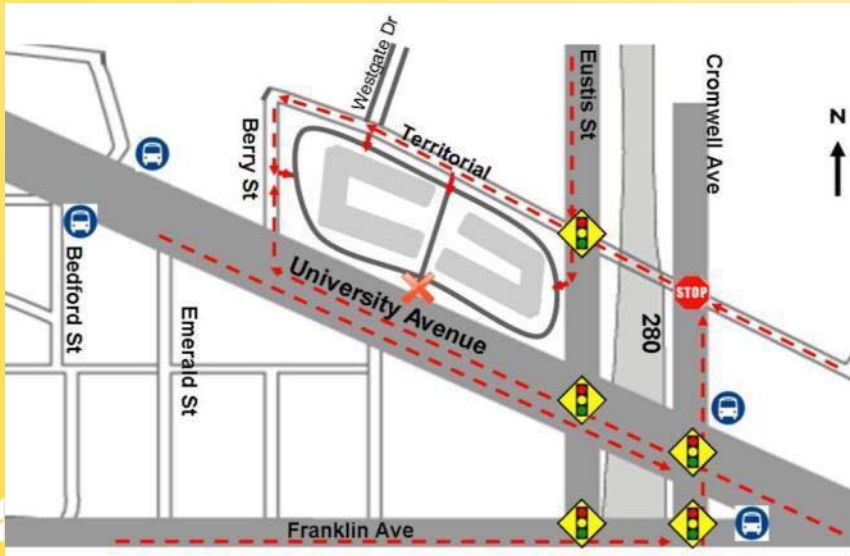

# Issue: Length of Work Zones

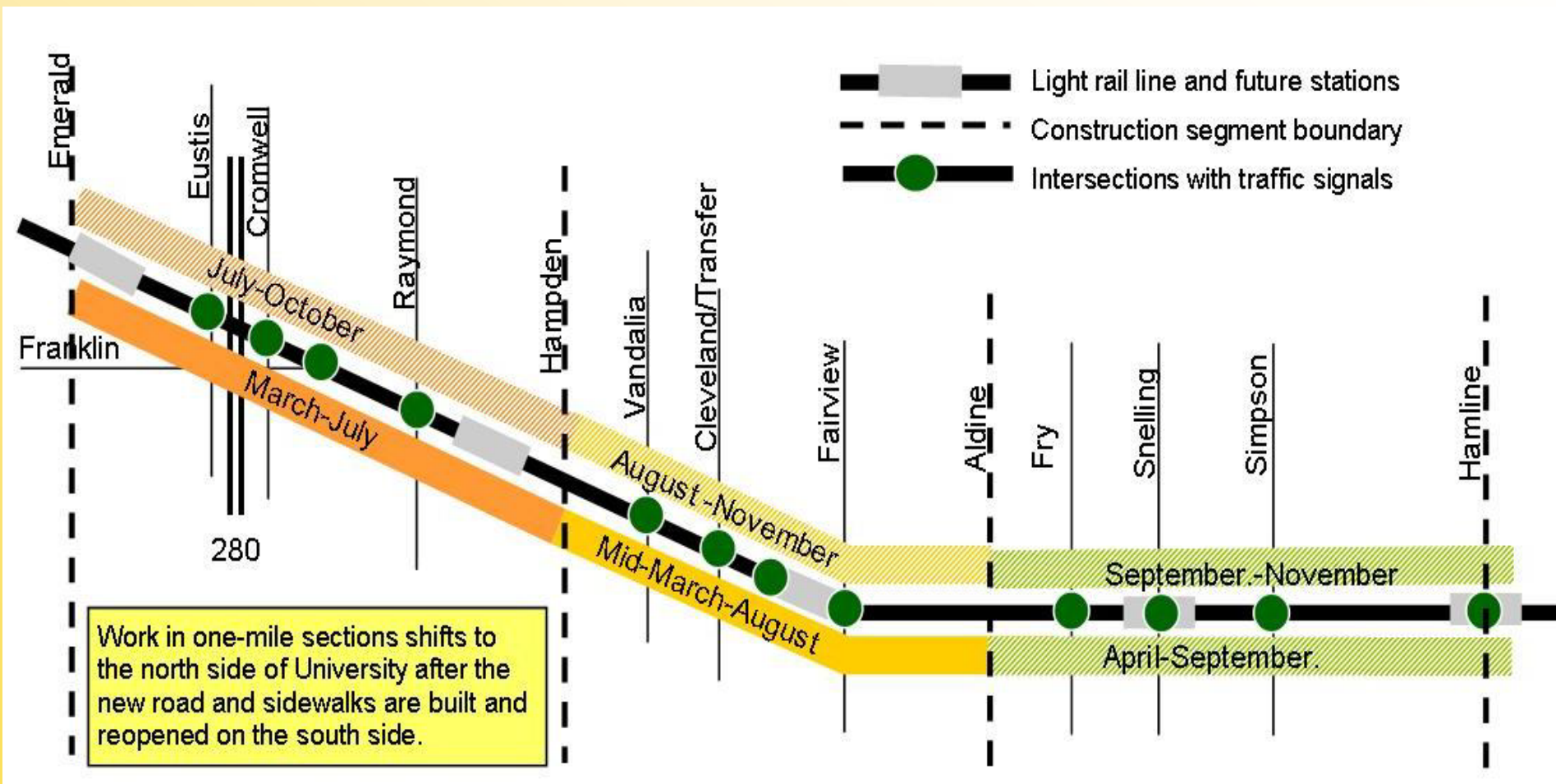



# Issue: Idle work zones (CE)



# Action: New Workers Added By Month

**2011**

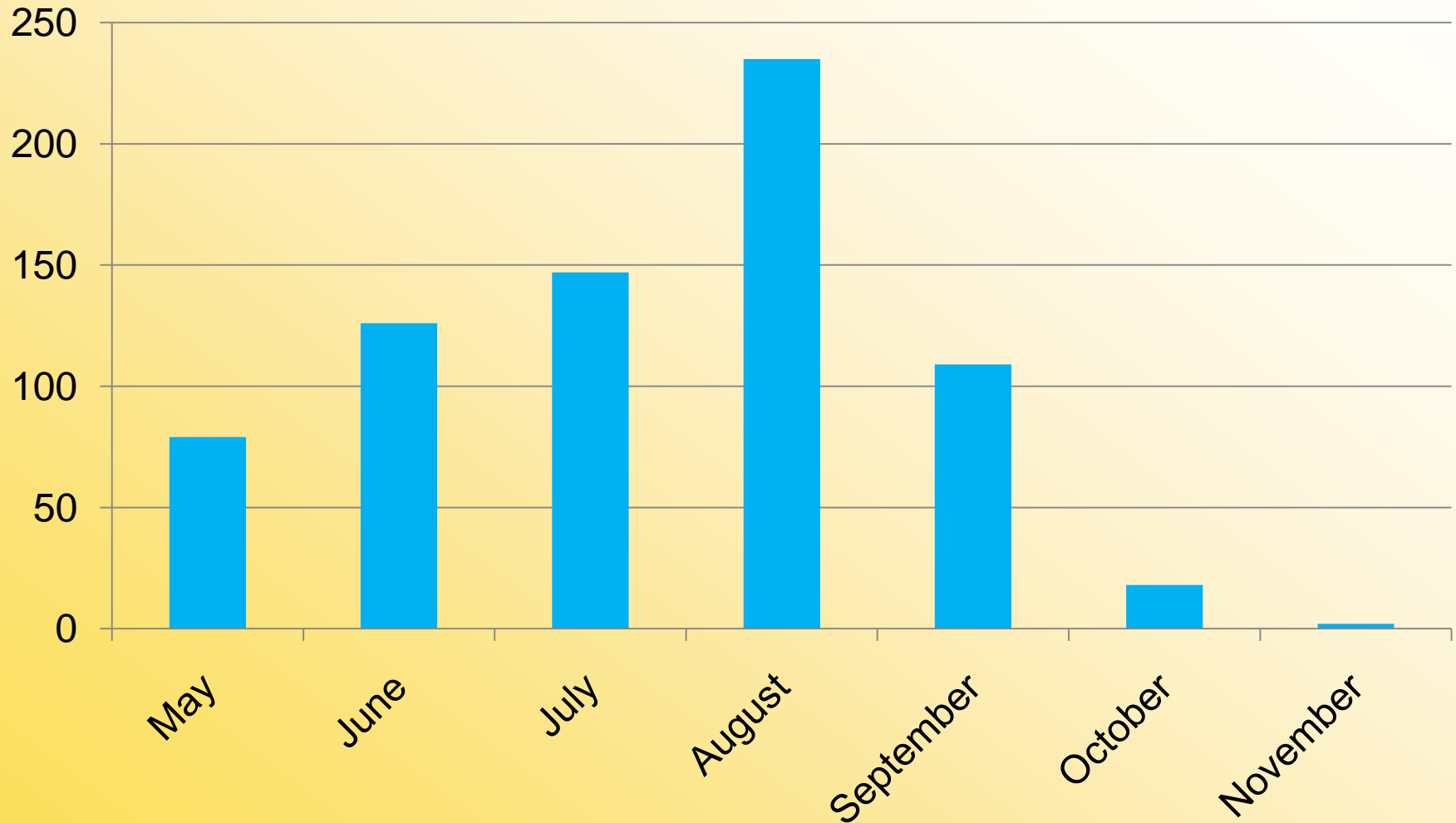



# Action: Link construction zone size with crew resources (CE)



Action: Continue to have inspectors track issues;  
add CCPO staff





## Central Corridor Light Rail Transit



## Pedestrian Access

# Issue: No Accessible Ramp to Bus Stop





Action: Temp bus stop with ramp and protective railings, barriers and trash cans



# Issue: Utility installation and sidewalk replacement affected ped access

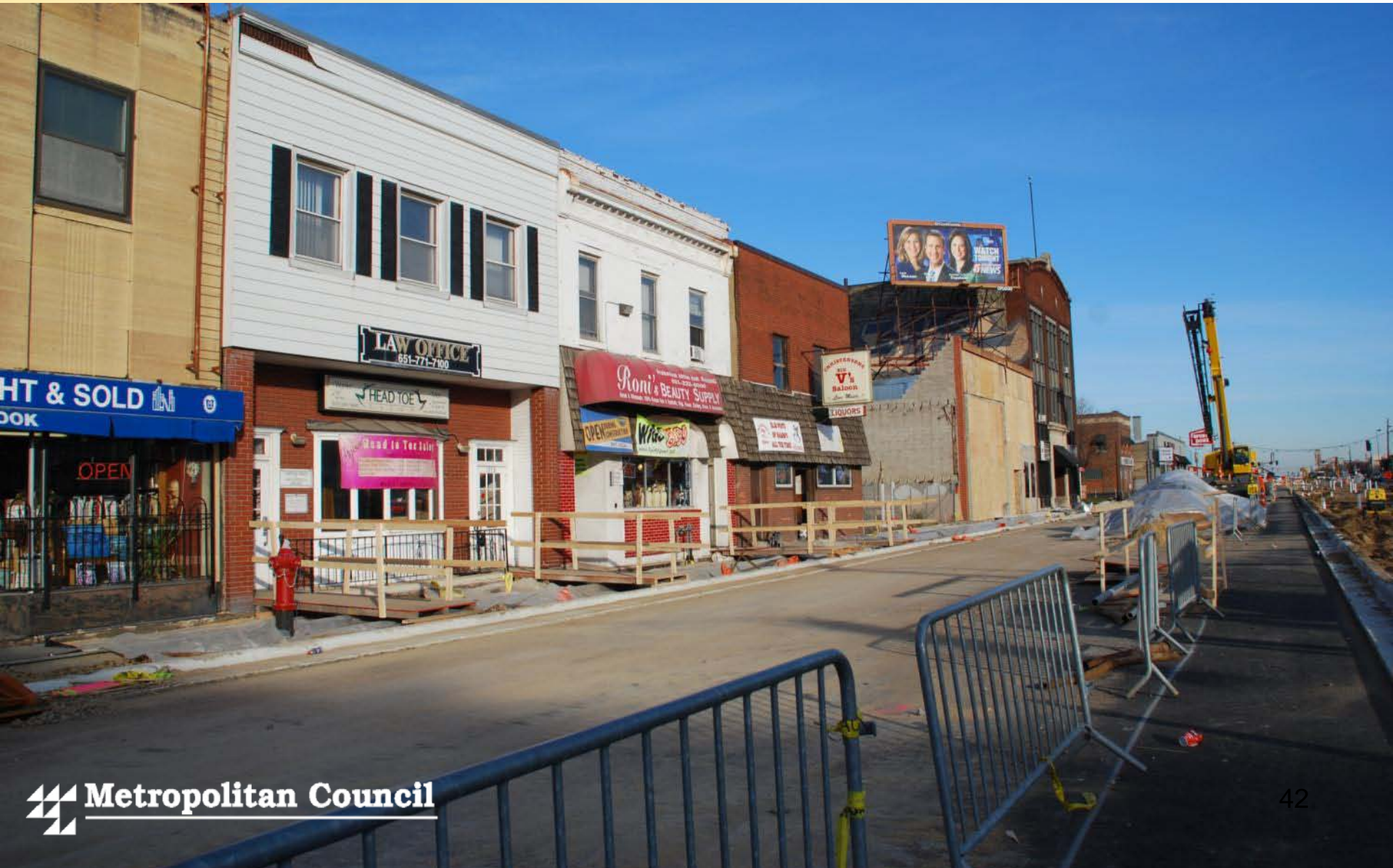



Action: Use ADA temp bridges to provide ped access during sidewalk construction





# Issue: Confusing signage





# Action: Use proper signage





# Issue: Maintaining Temporary Sidewalks and Access (CE)





# Action: Conduct ADA Field Checks

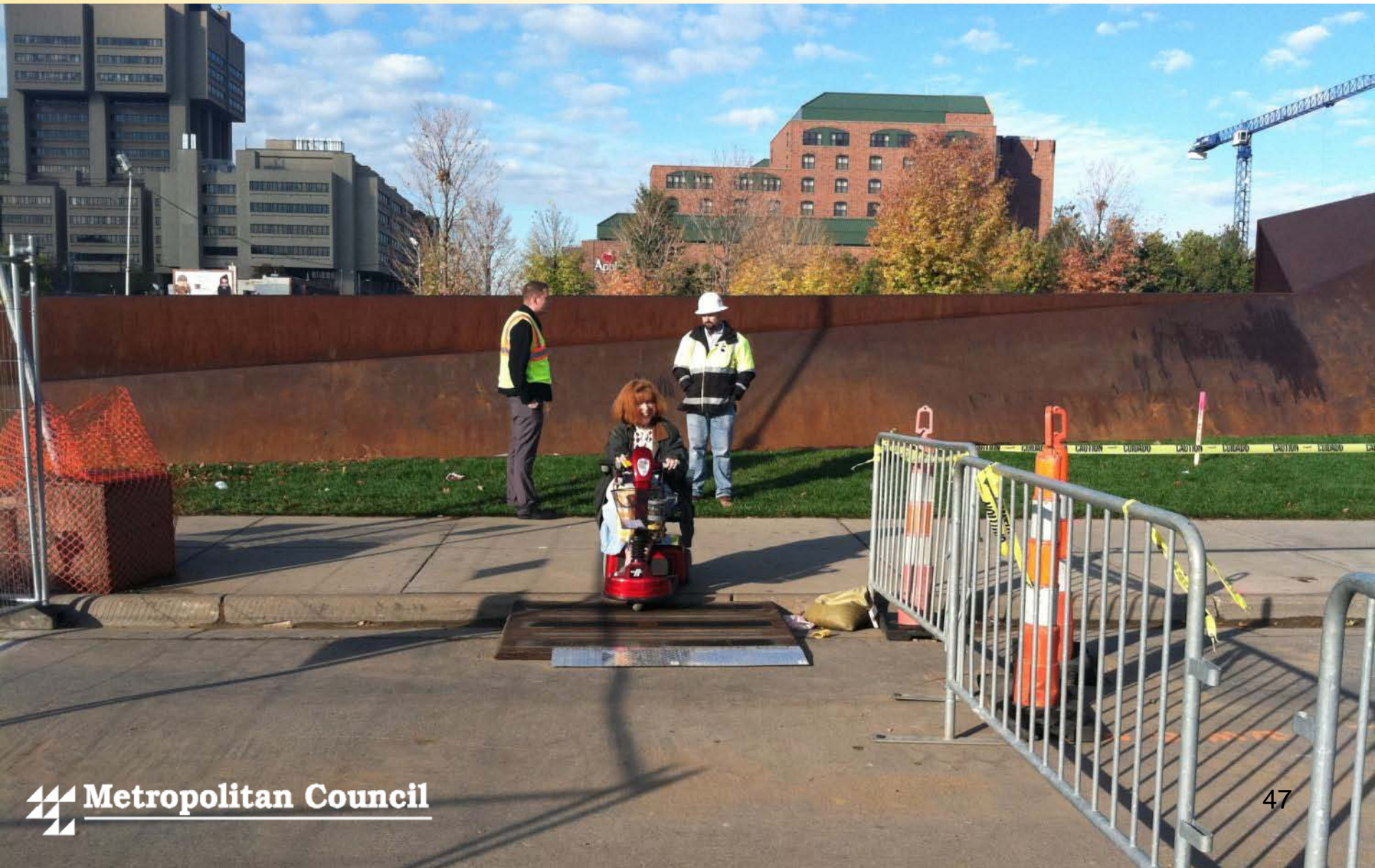

# Central Corridor Light Rail Transit



## Outreach



# 24-hour Hotline

- Over 100 signs posted throughout the corridor



# Weekly Construction Updates

## Central Corridor Light Rail Transit

### St. Paul - University Avenue West Construction Update

April 16-22, 2011



#### Support corridor businesses: Dine out and catch a show



Dan Simonson (left) and James Thissen of Caffè Biaggio want passers-by to know that they can still dine at the Italian restaurant at 2356 University Ave. W. in St. Paul despite LRT construction on the street in front of them

For more ideas, go to: [www.discovercentralcorridor.com](http://www.discovercentralcorridor.com) or [www.twitter.com/discovercdlt](http://www.twitter.com/discovercdlt)

#### Highlights and Upcoming Work

- Snelling is reduced to one lane in each direction between Spruce Tree and Sherburne; lanes shifted to west side of Snelling
- University at Snelling reduced to one lane in each direction on the south side of the road.
- Construction preparation along University between Aldine and Syndicate will start the week of April 18 and construction is anticipated to begin starting the week of April 25.
- Highway 280 will be closed April 29-May 2 for bridge work.
- Crews start work on retaining wall on south side of University between Prior and Cleveland; sidewalk on south side of University closed. Use sidewalk on the north side of University as alternate route.

## University Avenue St. Paul West June 4-June 10

University Avenue: Fry to Hamline  
150 day clock started on south side: April 21  
Remaining: 108 days on south side



- Road Closed
- Sidewalk or crosswalk closed
- Lanes closed to traffic, follow detours for business access
- Lanes open to thru traffic, watch for lane shifts
- Bus stop location (all other locations temporarily closed during construction)
- Signalized Intersections

#### Traffic details

- Crews continue paving and working on the intersections of University with Berry, Eustis, Cromwell, and Franklin; watch for delays.
- Snelling between Spruce Tree and Sherburne reduced to one lane each way.
- Utility work begins on the east side of Hamline at the intersection with University; watch for lane shifts.
- Construction crews continue to work on east side of Raymond between University and Wabash; impacts include lane shifts and removal of on-street parking.
- University between Emerald and Hamline traffic shifted to north side of University onto three lanes: one eastbound, one westbound lane and a shared center lane for left turns.
- Twelve cross streets in the construction zone are signalized for full traffic movements: Eustis, Cromwell, Franklin, Raymond, Vandalia, Cleveland, Prior, Fairview, Fry, Snelling, Simpson and Hamline. These streets will be reduced to one lane each way at the intersection with University and some on-street parking will be removed to allow for lane shifts. All other cross streets south of University closed; signage directs vehicles to alternative access to businesses.
- Access to the Midway Shopping Center maintained from St. Anthony via Pascal, from University via Simpson and driveways off of Snelling and Hamline.





# Locations of Construction Posters

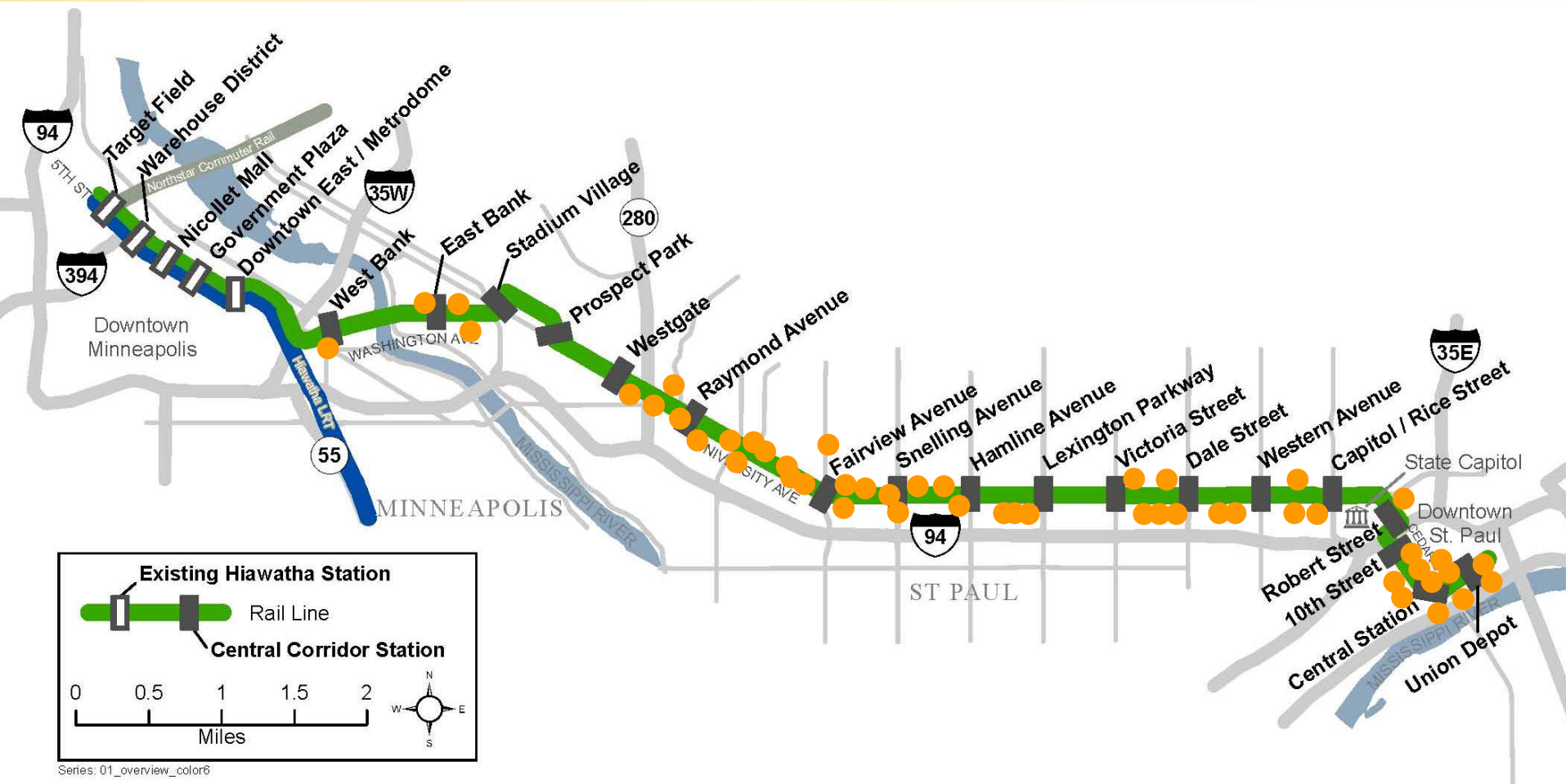

# Working with businesses on access plans





# “Open For Business” Signs

- Placement
- Durability





# Communications / Outreach Update





## More Information

Online:

[www.SWLRT.org](http://www.SWLRT.org)

Email:

[southwestLRT@metc.state.mn.us](mailto:southwestLRT@metc.state.mn.us)

