



Corridor Management Committee

September 14, 2017



Today's Topics

- New Starts Update
- Environmental Update
- Bassett Creek Storm Sewer Update
- West Broadway Stations



New Starts Update



New Starts Update

- Project received Medium-High rating in the FY 2018 FTA New Starts Annual Report
 - Based on New Starts application submitted September 2016
- Project submitted updated New Starts application on September 7, 2017
 - FY 2019 FTA New Starts Annual Report
 - Anticipate a Medium-High rating



New Starts Rating Components: Financial

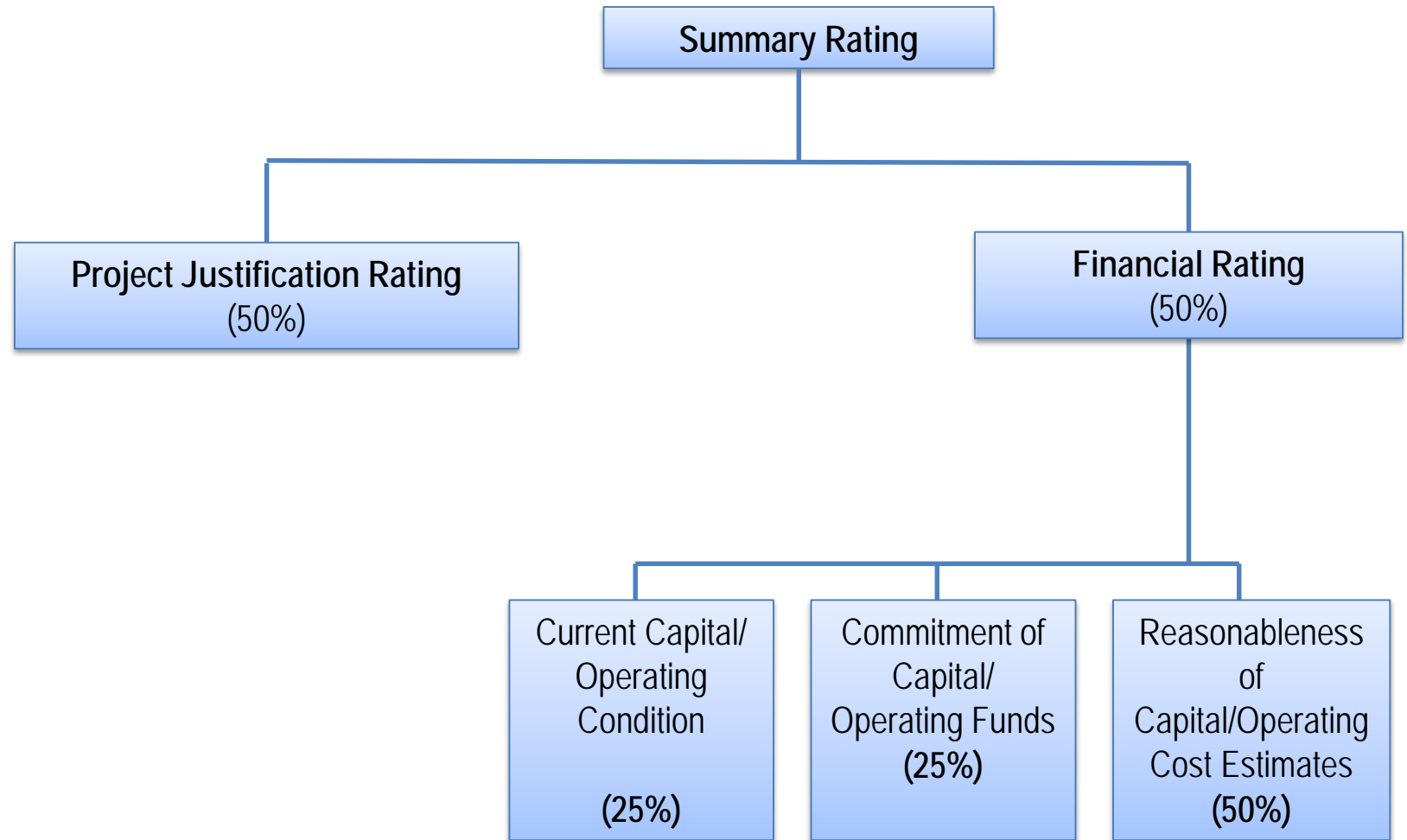

New Starts Rating Components: Project Justification

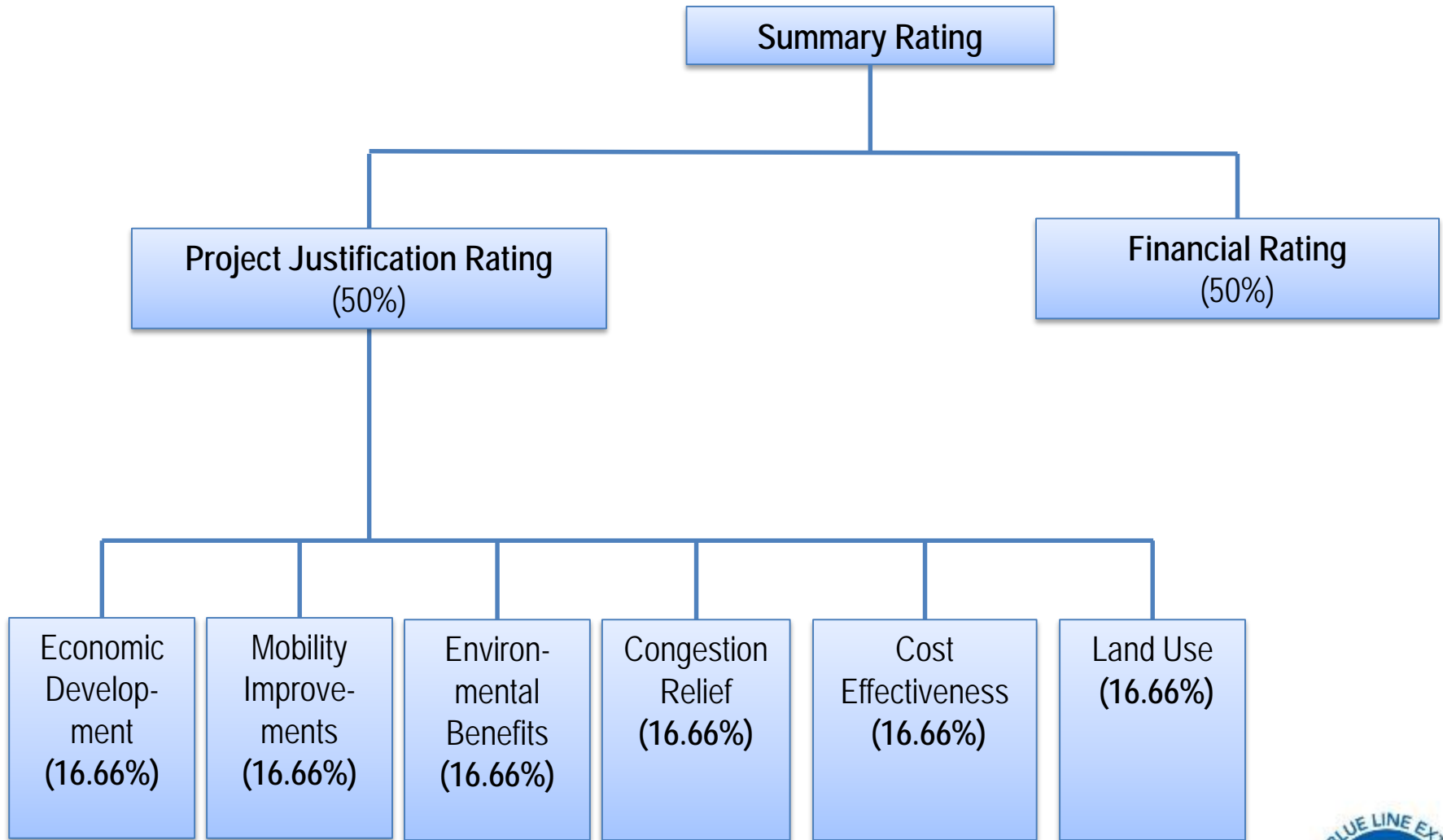

2017 New Starts Submittal Changes

- Land Use and Economic Development
 - Discusses advancements since 2016
- Financial Management Plan
 - CTIB dissolution
 - Full local funding commitment
- Revised project schedule
 - Shift FFGA application from September 2017 to May 2018
- Ridership adjusted for reduction of Robbinsdale Park-n-Ride
 - 550 spaces to 400 spaces



Environmental Update



Historic Properties

- Section 106 MOA implementation in process
 - Draft Interpretive Plan
 - Additional architecture/history fieldwork
 - Consultation on design for compatibility with historic properties



Environmental Site Assessment (ESA) Overview

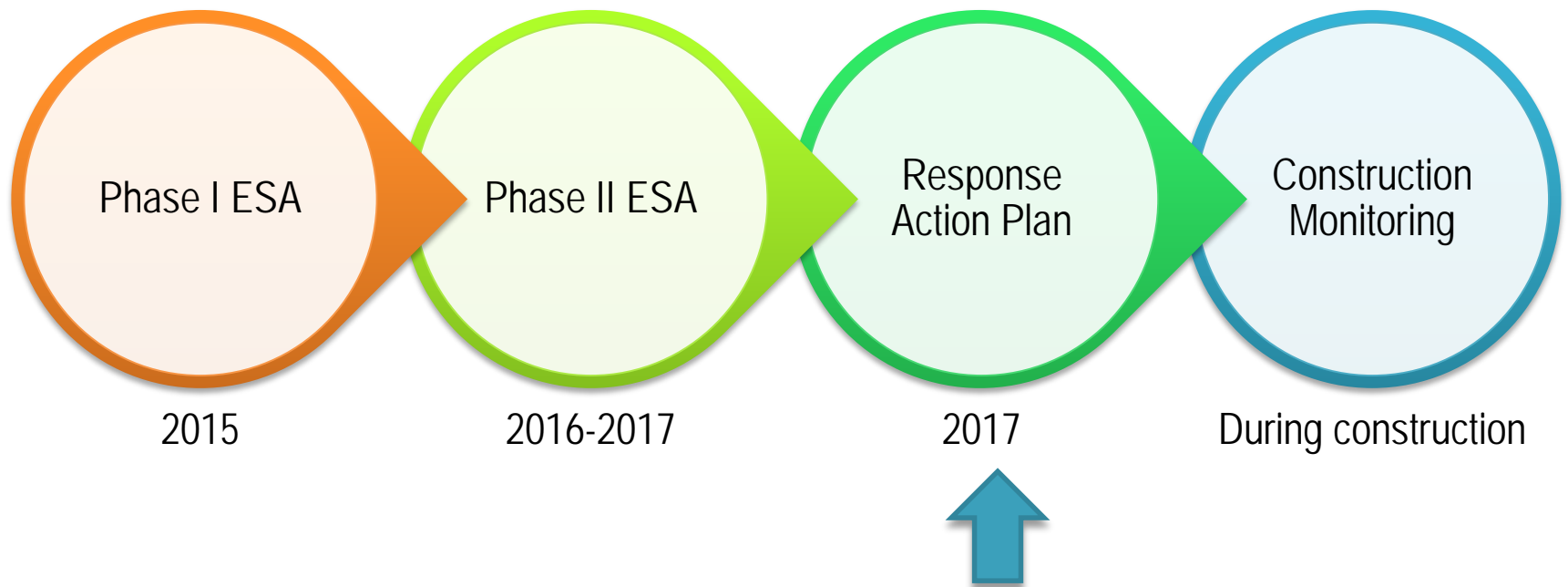

Phase II ESA Background

- Testing for soil and ground water contamination
- Information used for:
 - Design considerations
 - Protecting human health and the environment during construction
- Fieldwork
 - 382 borings and test pits completed



Soil sampling equipment mounted on a truck.

Phase II ESA - Results

- Key areas from fieldwork investigation

Crystal

Robbinsdale

Floodplain Mitigation Site

TH 55/HERC

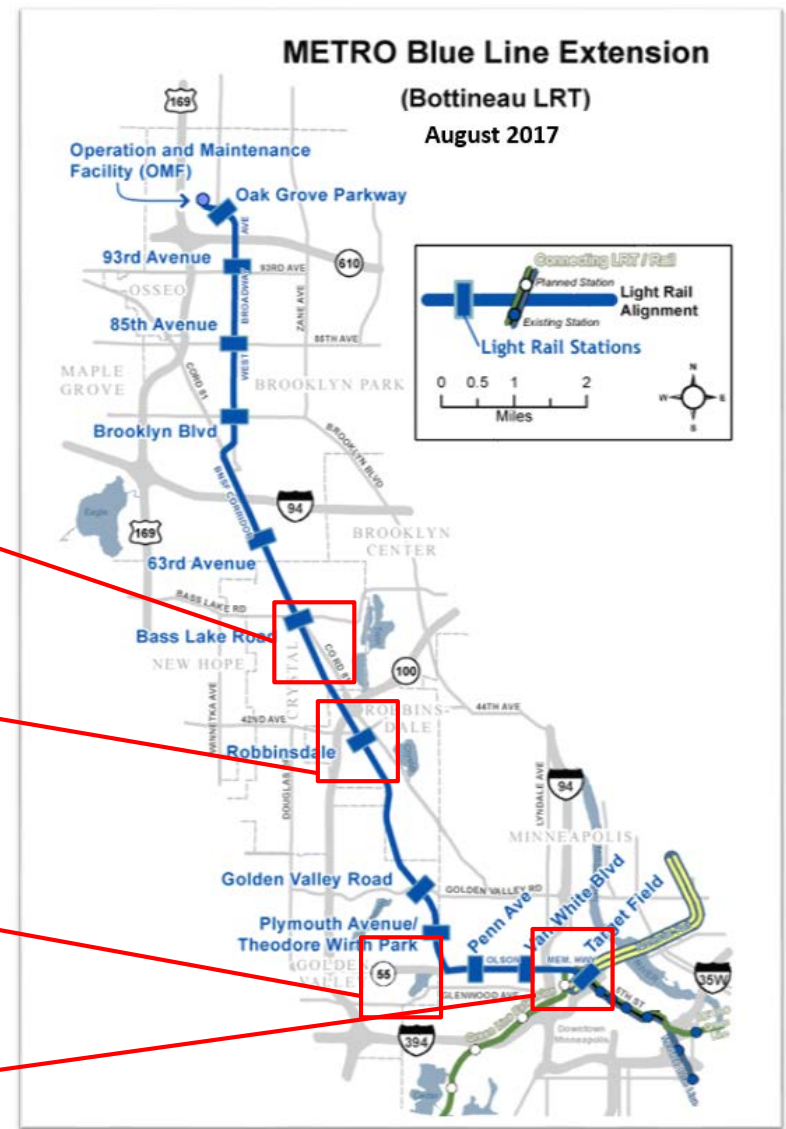

Response Action Plan (RAP)

- Management of contaminated materials during construction
- Advanced Construction RAP
 - Approved by MPCA in May 2017
- Corridor-wide RAP
 - In process: anticipated Q4 2017
- Construction Monitoring
 - Implementation of RAP



Bassett Creek Storm Sewer Update



Bassett Creek Storm Sewer Overview

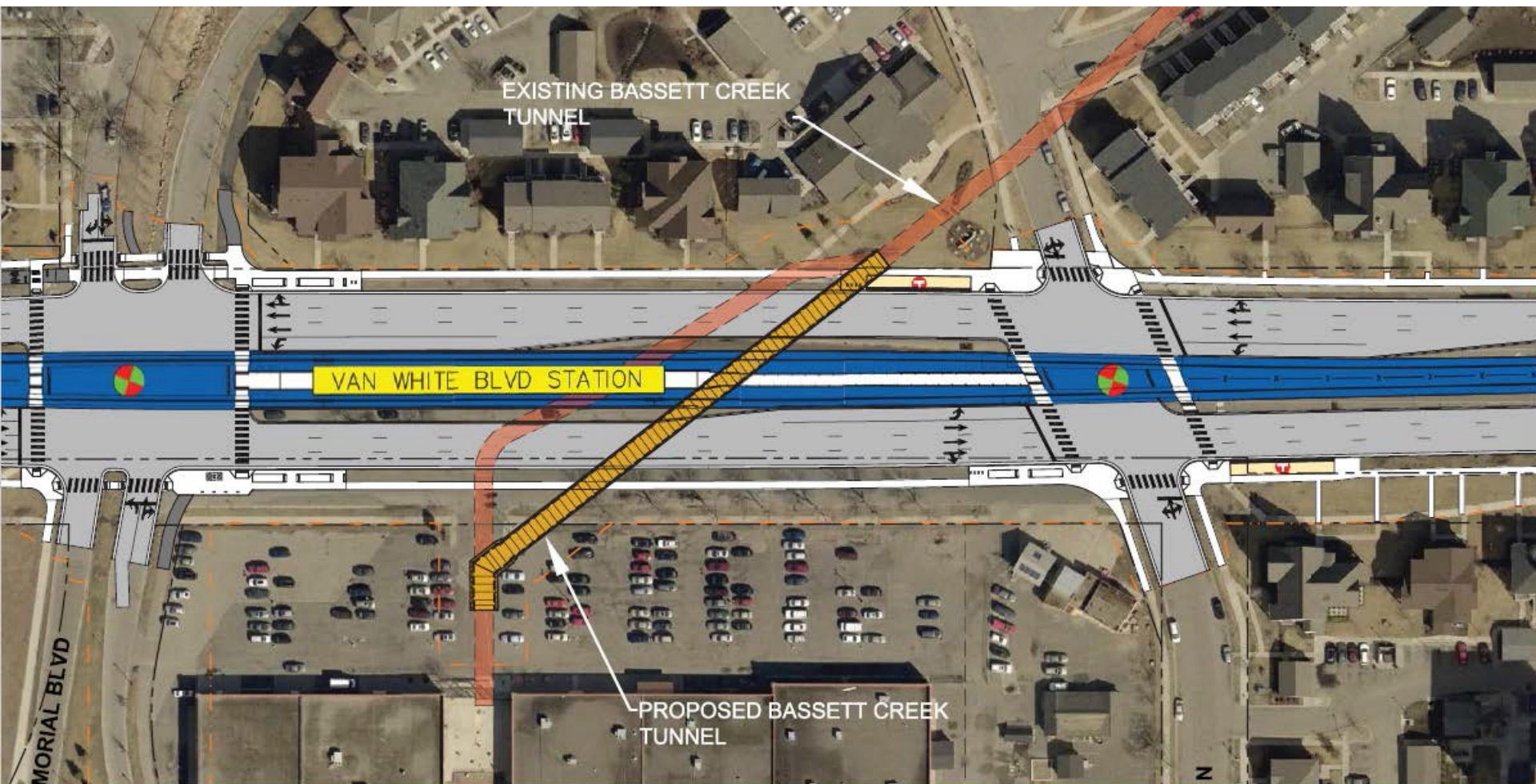

Construction Overview

- Two bid packages:
 - Material procurement
 - Tunnel construction
- July 31, 2017: Material procurement contract awarded to Max Steininger, Inc.
- August 25, 2017: Tunnel construction awarded to Minger Construction Companies, Inc.



Construction Overview

- Fall 2017: Utility installation across Olson Memorial Highway (OMH)
 - Precast box culvert
 - 2 – 42” MCES conveyance pipes
 - Closure of OMH to start after Oct 27, 2017 allowing completion of I-94 work
 - Closure date(s) have been coordinated with MnDOT, Hennepin County and City of Minneapolis
 - Up to 12 day closure of OMH between West Lyndale Avenue and Van White Memorial Boulevard
 - Minger anticipates working 24 hours a day / 7 days a week during the closure of OMH



Detour Routes

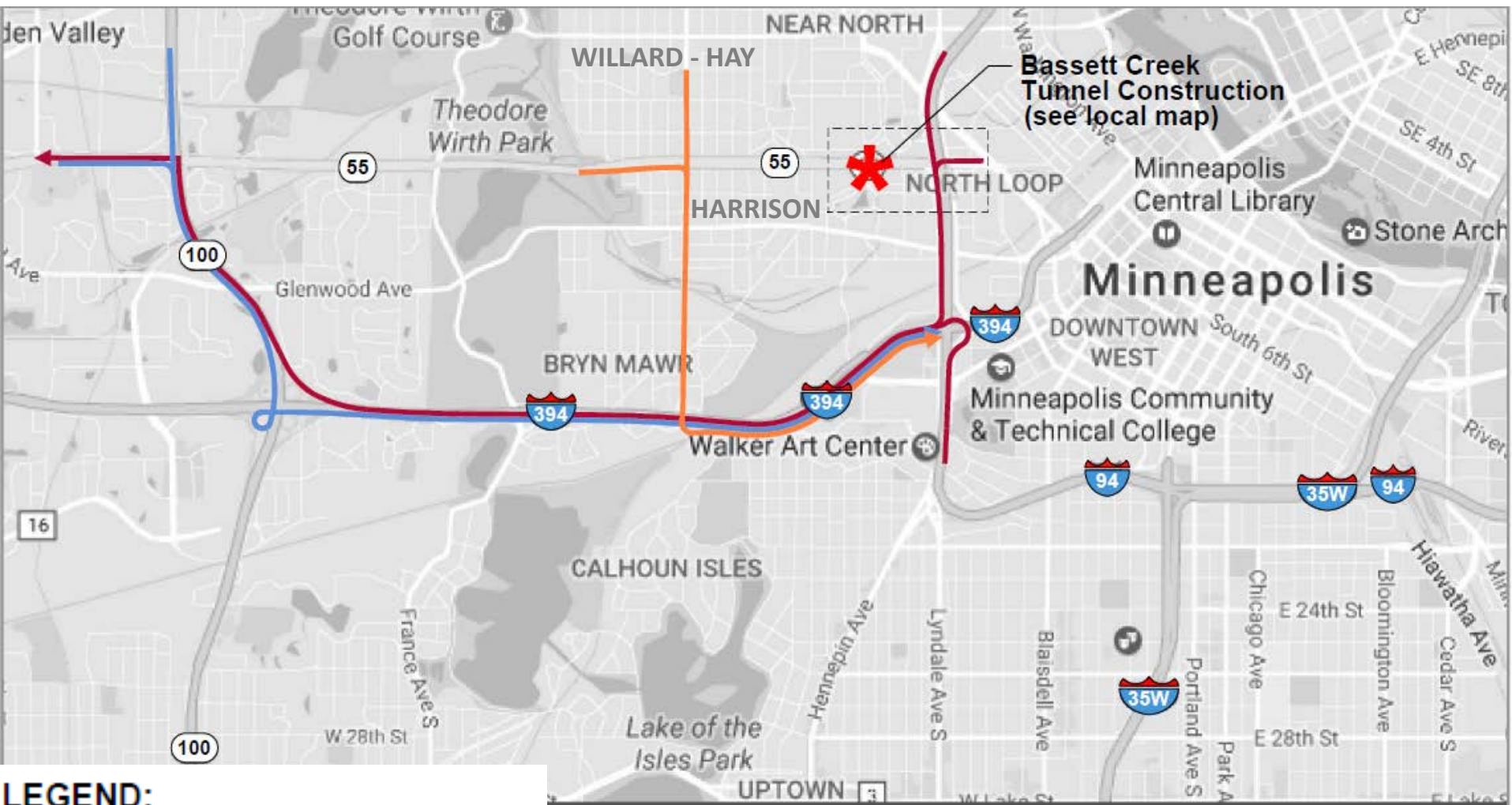

LEGEND:

- Westbound Detour
- Eastbound Detour
- Eastbound Local Detour



Construction Overview

- Winter 2017 / 2018: Cast in place concrete and in-place lining of MCES sewer
 - North closure concrete placement between OMH and Heritage Park townhomes occurring with lane closures on OMH
 - South closure concrete placement requires helical pile installation in the Summit OIC parking lot
 - MCES lining includes 36" pipe installed within existing egg shaped sanitary sewer
- Spring 2018: Cleanup and restoration



Public Outreach and Communications

- Key outreach & communication messages
 - Project description
 - Duration of construction
 - Detours for vehicles, trail users, bus riders
 - Where to get more information
 - Who to contact if you have any questions



Public Outreach and Communications

- Coordination/information sharing meetings with
 - MnDOT
 - Metro Transit
 - County/Cities
- Media
 - Traditional: TV, cable access, radio, newspapers
 - Social media: MC Facebook, Twitter, Nextdoor
- Bassett Creek Storm Sewer video

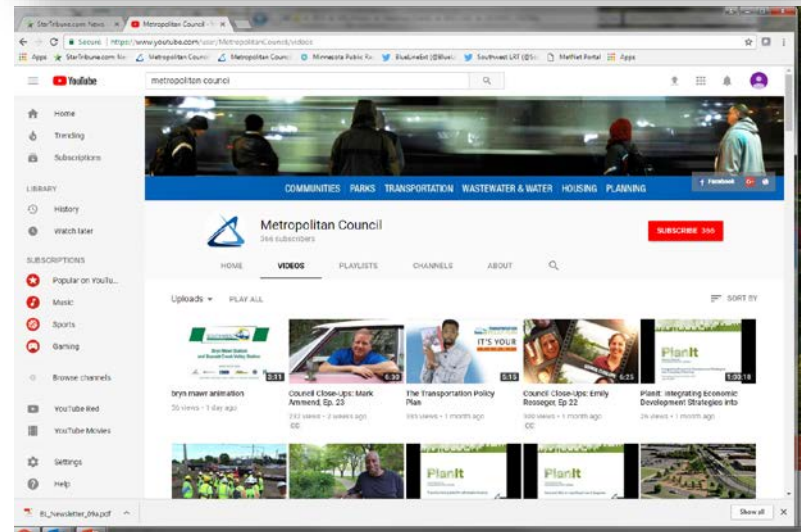

Public Outreach and Communications

- Neighborhood/community communications
 - Neighborhood/community briefings
 - Community open house: early October
 - Leave behind/poster: project one-pager
 - Project website and newsletter
 - Variable message signs
 - GovDelivery

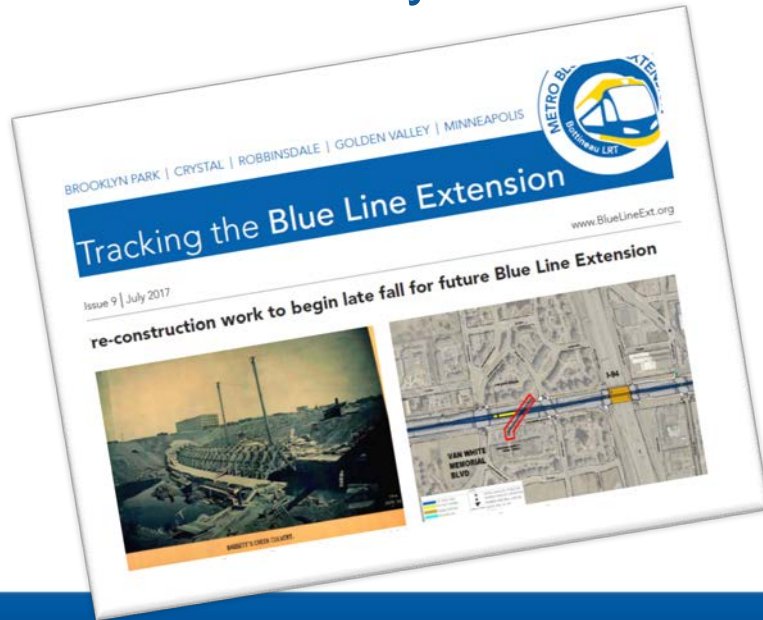

West Broadway Stations



West Broadway Stations

- Station design established in 30% plans
 - Center platforms consistent on all BLRT station platforms
 - Layout of shelters, ticket equipment, signage same on all platforms
 - Stations along West Broadway center running
- Station design advancing towards 90% plans
 - Finalizing material choices, including color
 - Finalizing details, such as lighting or other unique design elements
 - Finalizing station area, including access



93rd Avenue Station Site Plan



93rd Avenue Station

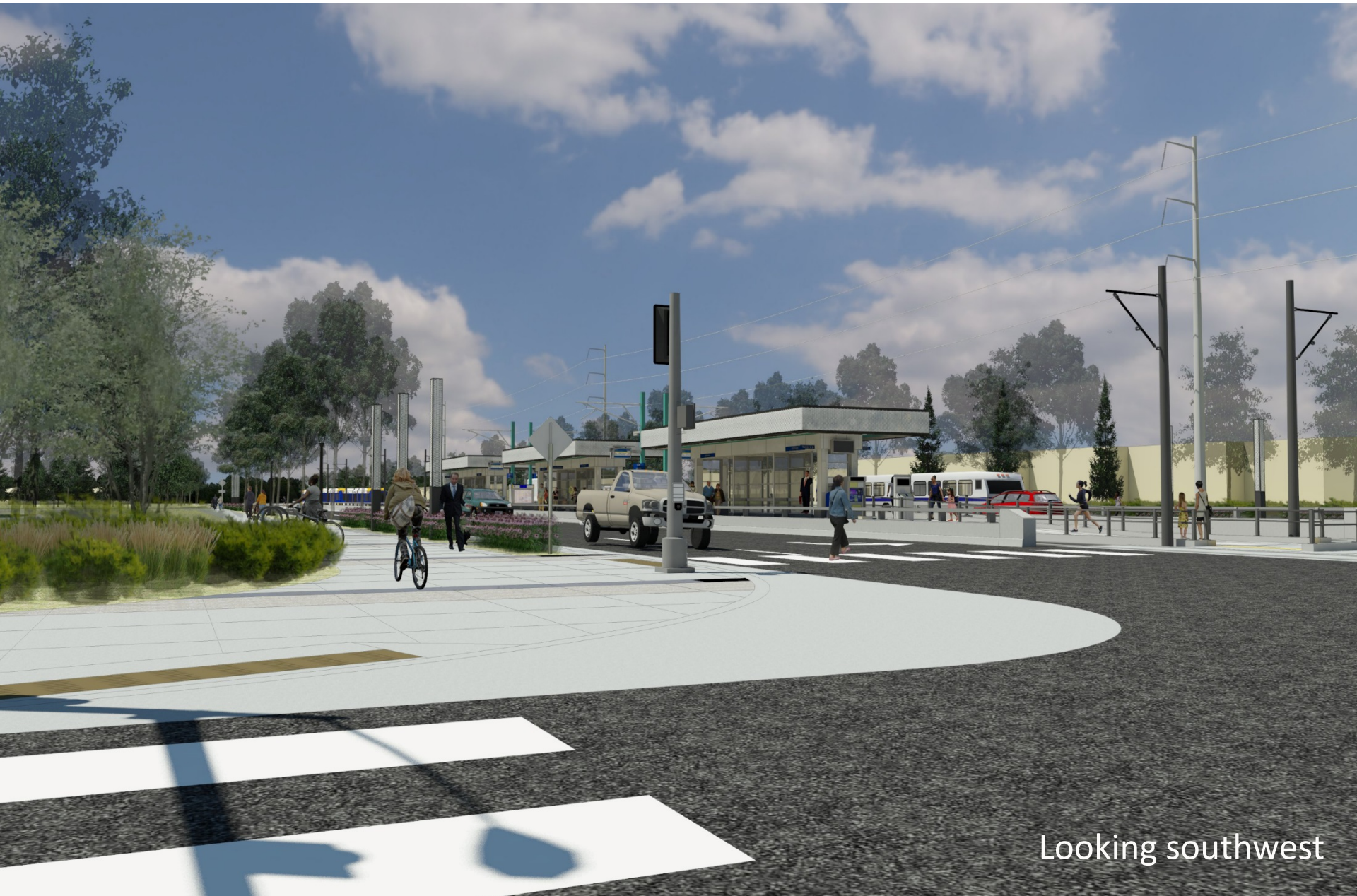

Looking southwest

93rd Avenue Station



Looking northwest

93rd Avenue Station



Looking north

85th Avenue Station Site Plan

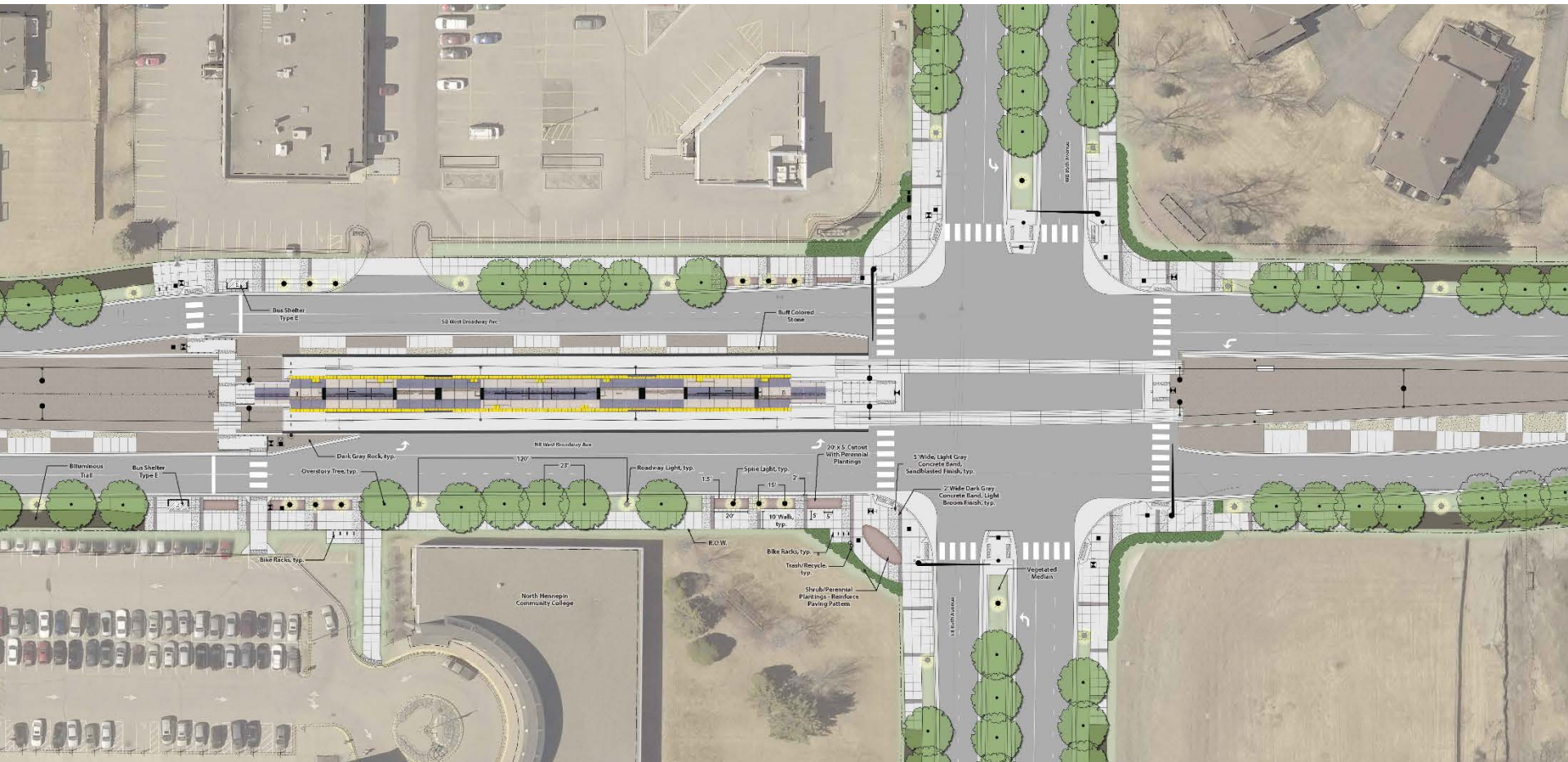

N →



85th Avenue Station



Looking southeast

85th Avenue Station



Looking northwest

85th Avenue Station



Looking north

Brooklyn Boulevard Station Site Plan



Brooklyn Boulevard Station



Looking southwest

Brooklyn Boulevard Station



Looking northwest

Brooklyn Boulevard Station



Looking north

More Information

About Us | News & Events | Data & Maps | Publications | Doing Business | Council Meetings | Contact Us | Employment

COMMUNITIES | PARKS | **TRANSPORTATION** | WASTEWATER & WATER | HOUSING | PLANNING

METRO BLUE LINE EXTENSION

Route
Stations
Environmental
Timeline
Project Partners

METRO BLUE LINE EXTENSION

Bottineau Transitway – Minneapolis & Northwestern Communities

The METRO Blue Line Extension (LRT) will operate northwest from downtown Minneapolis through north Minneapolis, Golden Valley, Robbinsdale, Crystal and Brooklyn Park, drawing riders northwest of Brooklyn Park. The proposed alignment is primarily at-grade and will have up to 11 new stations in addition to Target Field Station and about 1.3 miles of double track. The line will interline with the METRO Blue Line and connect Minneapolis and the region's northwest suburbs with existing LRT on the METRO Green Line, future LRT on the METRO Green Line Extension, bus rapid transit on the METRO Red Line, the Northstar commuter rail line and local and express bus routes.

Latest News
Feds: Met Council can begin designing METRO Blue Line Extension

Route
Click on the map below for more information

Website: BlueLineExt.org

Email: BlueLineExt@metrotransit.org

Twitter: [@BlueLineExt](https://twitter.com/BlueLineExt)

