



# Corridor Management Committee

December 14, 2017



# Today's Topics

- Chair's Update
- Bassett Creek Storm Sewer Construction Update
- 90% Design Plans and Next Steps
- Station Design: 63<sup>rd</sup> & Bass Lake Road
- 2018 CMC Meeting Schedule



# Chair's Update



# Bassett Creek Storm Sewer Construction Update





# Bassett Creek Storm Sewer Construction

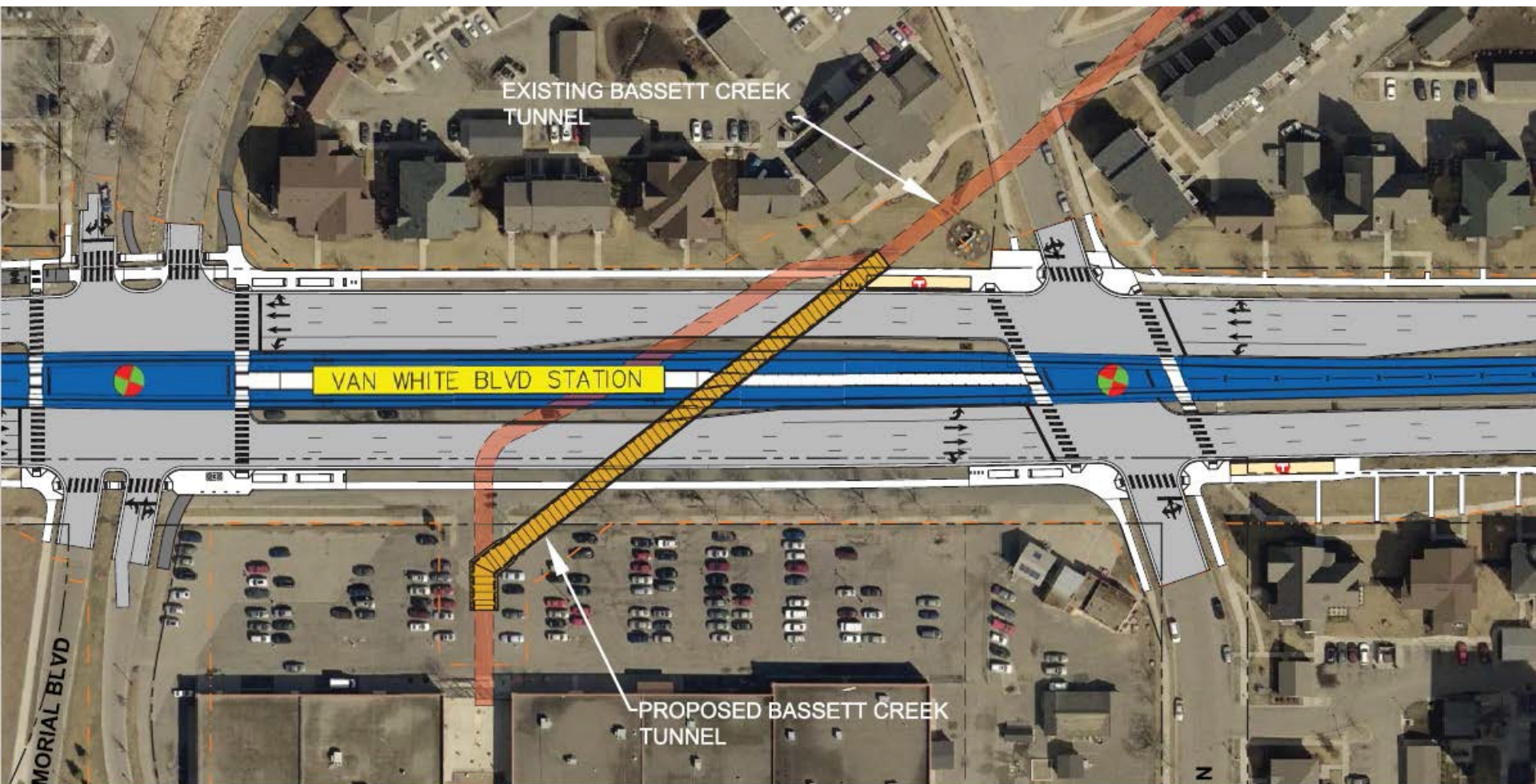

# Bassett Creek Storm Sewer

- Over a year of coordination with project partners proves successful!

- § Coordination of work and traffic control

- MnDOT, County, City, MC Environmental Services

- § Public outreach and media campaign

- Mobile friendly web mapping tool
  - Construction video
  - Community radio/newspapers
  - Door-knocking
  - Neighborhood meetings
  - Twitter
  - Press release
  - Email blasts
  - Variable message signs
  - Project newsletter



# October 10 Open House





# Bassett Creek Storm Sewer

- Contractor began mobilization week of Oct 23
- 12 day closure of Olson Memorial Highway (OMH) began Oct 30 after morning rush hour
- Contractor worked 24 hour days during closure
- OMH back open to traffic on Nov 11
- Connection to south end tunnel will take place over the winter
- Restoration Spring 2018





# Road Closure 10/30 @ 9:00 am



# Excavation Begins 10/30 @ 9:01 am





# Pavement Removal



# Tunnel Excavation





# North End Tunnel Connection





# Bassett Creek Storm Sewer Connection





# Night Work



# Moving Iron





# Box Tunnel Placement



# New Tunnel (Lt) / Old Tunnel (Rt)





# Bypass Connection Points





# Installed Pipe Sections





# Winter Work



# Pedestrian Access





# Paving





# Buses and Traffic Back on OMH: November 11



# Opening Storm Tunnel on South Side





# South Tunnel Connection Point





# Removing Top of Sanitary Pipe



# 90% Design Plans and Next Steps





# Civil Construction Packages

- Civil 1: Target Field Station thru CSAH 81 flyover bridge
- Civil 2: Jolly Lane to Operations & Maintenance Facility
- Packages include:
  - § Roadway, bridges, retaining walls
  - § Utilities
  - § LRT guideway
  - § Freight rail
  - § Stations
  - § Park-and-rides

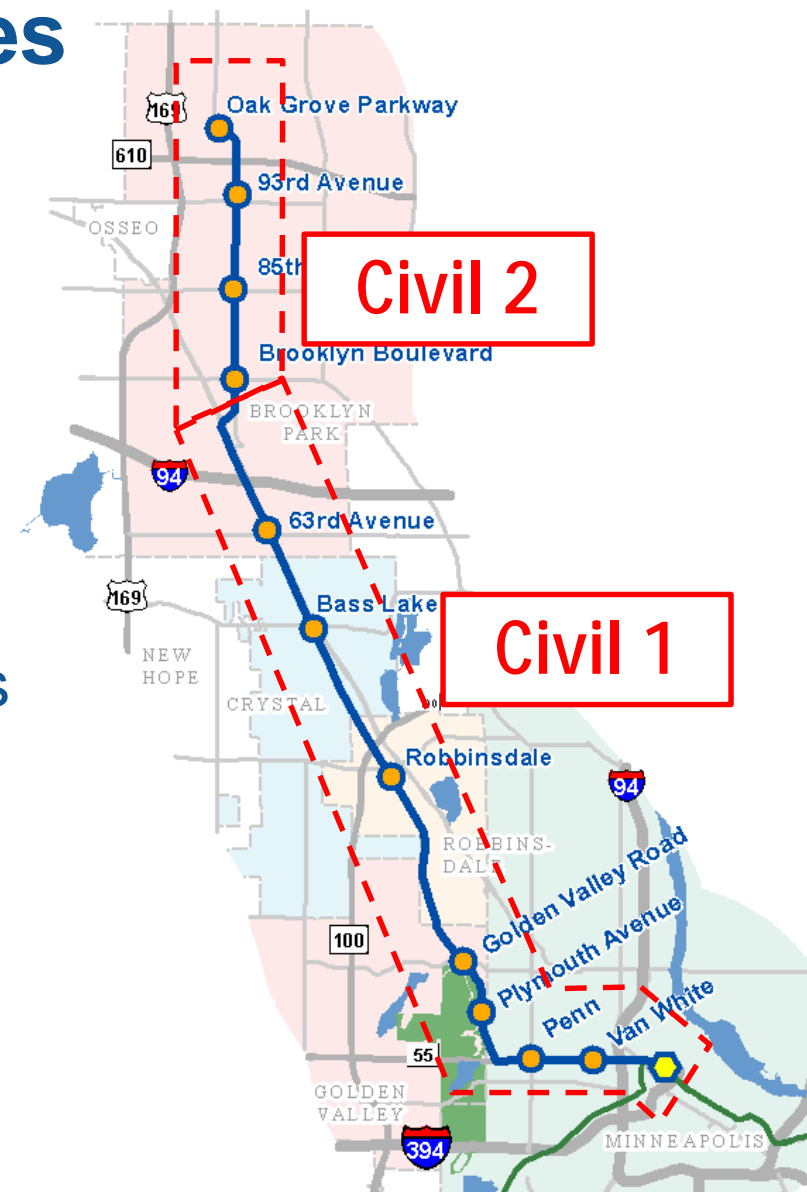

# 90% Design Plans

- Civil 1 and Civil 2 completed and delivered on November 17, 2017
- Civil plans have been shared with project partners for review and comment
- Comments will be addressed and changes will be included in final plans





# 90% Design Plans

- Mid-December:
  - § Civil 90% specifications due
  - § 90% Systems and OMF plans due
- Mid-January: Systems and OMF 90% specifications due



# Q1 2018 Design Activities

- Olson Memorial Highway design advancement
  - § Median landscape and signage design
  - § Detail storm water design
  - § Private utility coordination
  - § TPSS Screening
- West Broadway design advancement
  - § Landscape and signage design
  - § Detail storm water design
  - § Private utility coordination
- Oak Grove Parkway parking structure
- Advanced Design Packages
  - § Floodplain mitigation/MCES forcemain
  - § Theodore Parkway Bridge





# Q1 2018 Design Activities

- Freight Rail Corridor
  - § Document current design assumptions for negotiations team
  - § Document BNSF impact mitigation
  - § Design support during negotiations



# **Station Design Advancement: 63<sup>rd</sup> Avenue & Bass Lake Road**





# Station Design Advancement

- 63<sup>rd</sup> Avenue Station
  - § Access via elevator/stair tower and from at-grade entrance, both serving existing park and ride
- Bass Lake Road Station
  - § Access via surface park and ride and from at-grade entrance at Bass Lake Road



# 63<sup>rd</sup> Avenue Station





# 63<sup>rd</sup> Avenue Station



Looking northwest



# 63<sup>rd</sup> Avenue Station



Looking northwest



# 63<sup>rd</sup> Avenue Station



Looking north



# 63<sup>rd</sup> Avenue Station



DRAFT-WORK IN PROCESS



# 63<sup>rd</sup> Avenue Station



Looking southeast



# Bass Lake Road Station





# Bass Lake Road Station



Looking south

# Bass Lake Road Station



Looking northwest



# Bass Lake Road Station





# 2018 CMC Meeting Schedule



# 2018 Meeting Schedule

- Second Thursday of the month: 1:30 to 3:00 PM
- Held at Hennepin County Rockford Library (Crystal):
  - § January 11
  - § February 8
  - § March 8
  - § April 12: **Brooklyn Park Library**
  - § May 10
  - § June 14
  - § July 12
  - § August 9
  - § September 13
  - § October 11
  - § November 8
  - § December 13





# More Information

About Us | News & Events | Data & Maps | Publications | Doing Business | Council Meetings | Contact Us | Employment

COMMUNITIES | PARKS | **TRANSPORTATION** | WASTEWATER & WATER | HOUSING | PLANNING

**METRO BLUE LINE EXTENSION**

Route  
Stations  
Environmental  
Timeline  
Project Partners

## METRO BLUE LINE EXTENSION

### Bottineau Transitway – Minneapolis & Northwestern Communities

The METRO Blue Line Extension (LRT) will operate northwest from downtown Minneapolis through north Minneapolis, Golden Valley, Robbinsdale, Crystal and Brooklyn Park, drawing riders northwest of Brooklyn Park. The proposed alignment is primarily at-grade and will have up to 11 new stations in addition to Target Field Station and about 1.3 miles of double track. The line will interline with the METRO Blue Line and connect Minneapolis and the region's northwest suburbs with existing LRT on the METRO Green Line, future LRT on the METRO Green Line Extension, bus rapid transit on the METRO Red Line, the Northstar commuter rail line and local and express bus routes.

#### Latest News

Feds: Met Council can begin designing METRO Blue Line Extension

#### Route

[Click on the map below for more information](#)

Website: [BlueLineExt.org](http://BlueLineExt.org)

Email: [BlueLineExt@metrotransit.org](mailto:BlueLineExt@metrotransit.org)

Twitter: [@BlueLineExt](https://twitter.com/BlueLineExt)

